

GSX-201

8038 Package 32.768kHz Watch Crystal

- Compatible with Citizen CM200, Epson Toyocom MC-306, KDS DMX-26S, FSRLF, E1WS, SMQ32SL, RSM200S etc
- Low profile plastic moulded package
- Industrial temperature range



CONFIGURABLE OPTIONS

Parameter	Option Code
Calibration tolerance	
±20ppm	
±10ppm	
±5ppm	
Circuit condition	
Any	
12.5pF	
9pF	
6pF	D

SPECIFICATIONS

Frequency	32.768kHz
Dimensions	7.9 x 3.7 x 2.5mm
Temperature stability	-50ppm (-10 to +60°C) -130ppm (-30 to +80°C)
Operating temperature range	-40 to +85°C
Storage temperature range	-55 to +125°C
Turnover temperature (T ₀)	+25°C ±5°C
Frequency / temp coefficient	-0.034±0.006ppm/°C ² typ
Static capacitance (C ₀)	1.35pF typ
Motional capacitance (C ₁)	3.0fF typ
Equivalent series resistance	50kΩ max @ 25°C
Ageing	±3ppm max first year
Drive level	1.0μW typ
Shock resistance	±5ppm max
Soldering conditions	260°C, 10sec max
Net mass	130mg

PACKAGE DRAWING

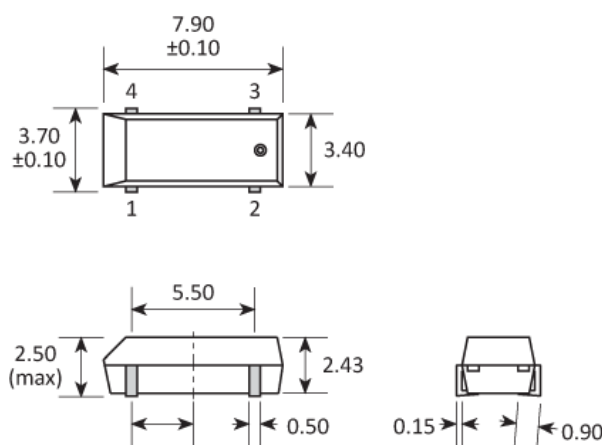

SOLDER PAD LAYOUT

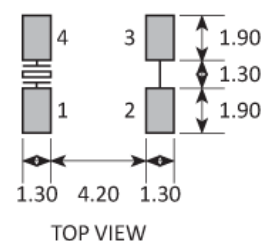

Dimensions in mm

ORDERING INFORMATION

To request a quotation for the GSX-201 please use the configurable options form to choose the options you require and then submit your configured product to our team. Our expert advisers are always happy to help with your requirements and can be contacted on +44 1460 256 100 or at sales@golledge.com.

Following product selection you will be issued with a seven character Golledge part number. Your Golledge part number is the internationally accepted Golledge manufacturing part number (MPN) that should be used for all project documentation, including bills of materials (BoMs) and purchase orders.

If you have any queries regarding any of our documentation our dedicated sales team will be happy to help.

SOLDERING PROFILE

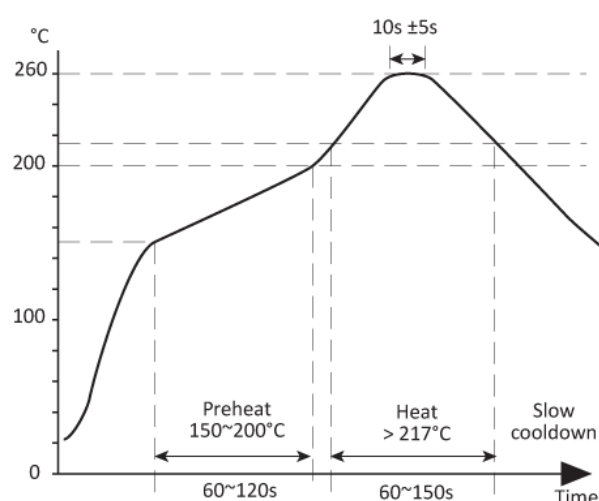

Lead free solderability limits: 260°C ±5°C x 10s ±5s x 2.

TAPE & REEL SPECIFICATION

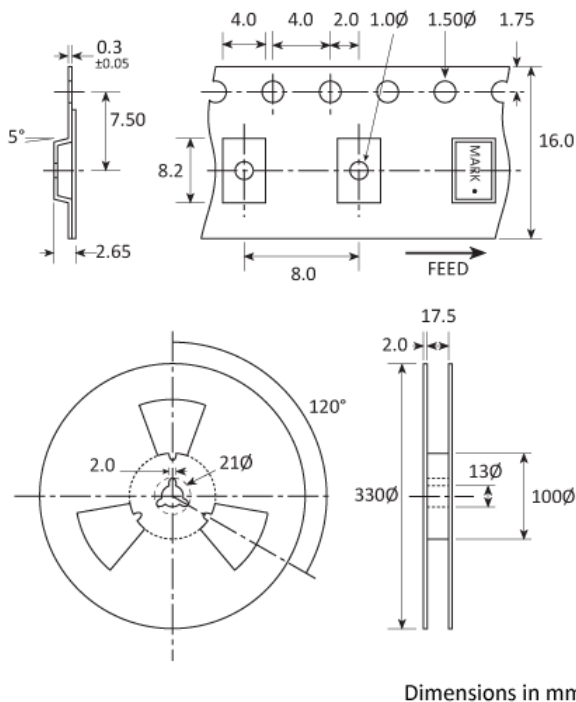

HANDLING & STORAGE



Human Body Model (HBM) 1A (250V to <500V)



Moisture Sensitivity Level (MSL): 1 (or not applicable)

CONSTRUCTION

Plastic moulded surface mount package

Industry standard package

COMPLIANCE

Please refer to our **DOCUMENTS** section for more information.



RoHS compliant with no exemptions.



REACH compliant.



Free of conflict minerals.



Free from halogens.



Free from ozone-depleting substances.