

SAW Filter 2655 MHz
Part No: MP08939

Model: TA1847B
Rev No: 1

Electrostatic Sensitive Device (ESD)

A. MAXIMUM RATING:

1. Input Power Level: 10 dBm
2. DC Voltage: +/- 5 V
3. Operating temperature range: -40 °C to +85 °C
4. Storage temperature range: -55 °C to +125 °C
5. Moisture Sensitivity Level: Level 3 (MSL 3)
6. ESD: 50V(MM) 100V(HBM)

B. ELECTRICAL CHARACTERISTICS:

Terminating source impedance: $Z_s = 50 // 5.1nH \Omega$ (Single-ended)

Terminating load impedance: $Z_L = 50 // 5.1nH \Omega$ (Single-ended)

Parameters Description		Unit	Min.	Typ.	Max.
Center Frequency F_c		MHz	-	2655	-
Insertion Loss(*1) (2620~2690 MHz) IL		dB	-	2.5	3.0
Amplitude Ripple (2620~2690 MHz)		dB	-	0.8	1.5
VSWR	Input (2620~2690 MHz)	-	-	1.6	2.0
	Output (2620~2690 MHz)	-	-	1.8	2.2
Attenuation (Reference level from 0 dB)					
1~2400 MHz		dB	30	36	-
45 MHz		dB	50	65	-
2400~2500 MHz		dB	32	37	-
2500~2570 MHz		dB	35	38	-
2570~2600 MHz		dB	2	4	-
2775~6000 MHz		dB	15	30	-
7620~7830 MHz		dB	15	25	-
7860~8000 MHz		dB	15	24	-

C. MEASUREMENT CIRCUIT:

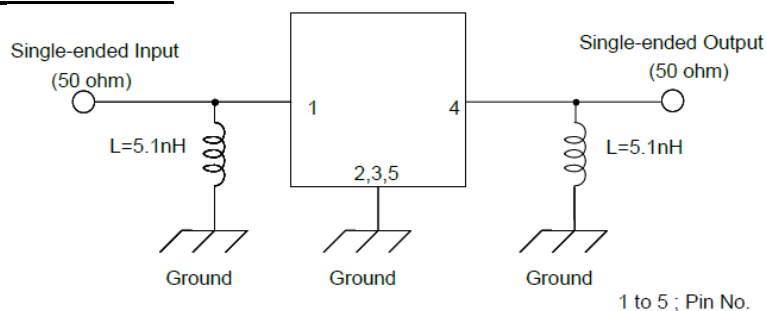

SAW Filter 2655 MHz
Part No: MP08939

Model: TA1847B
Rev No: 1

D. FREQUENCY CHARACTERISTICS:

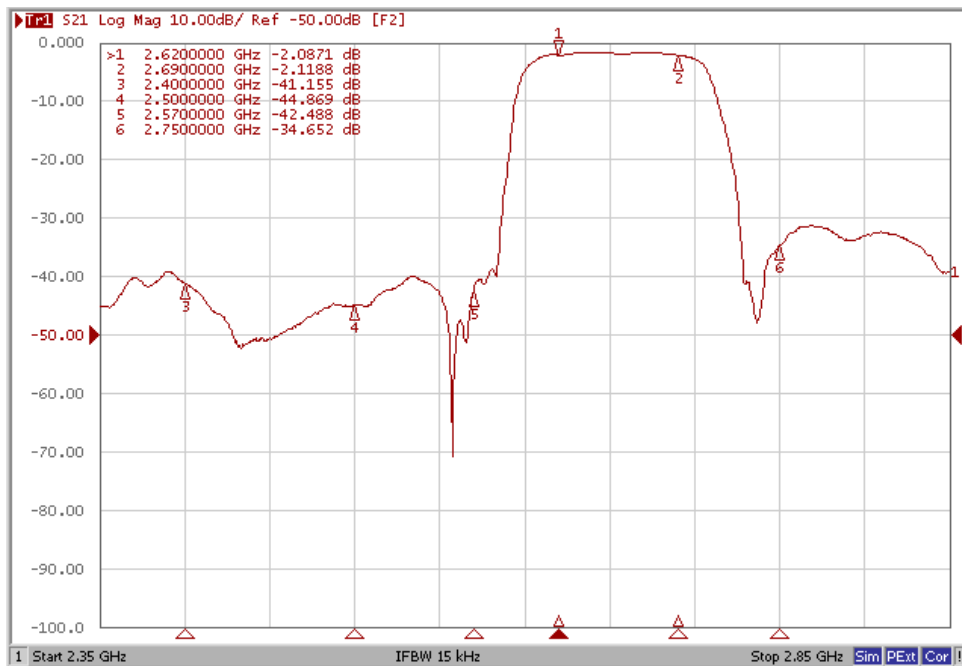

SAW Filter 2655 MHz
Part No: MP08939

Model: TA1847B
Rev No: 1

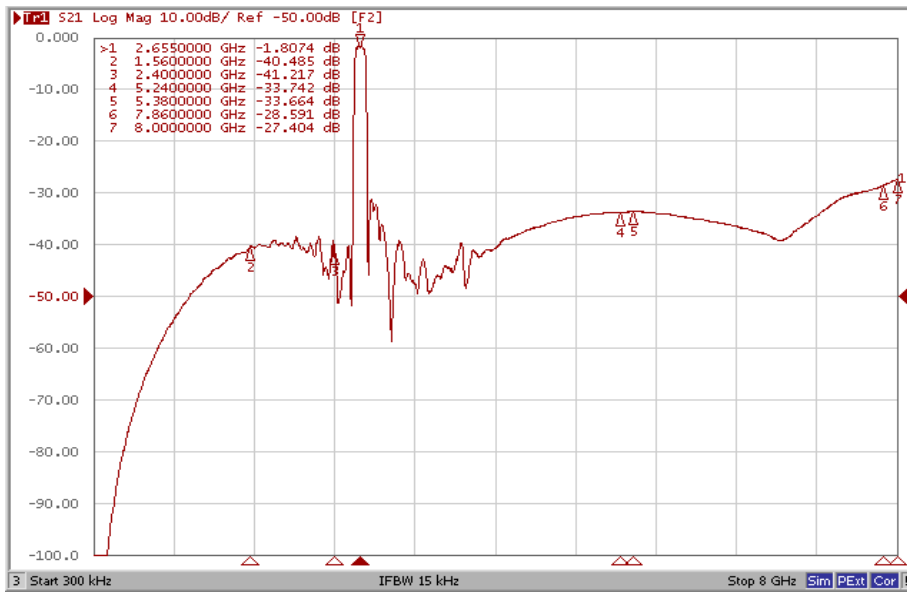

Reflection Functions:

VSWR

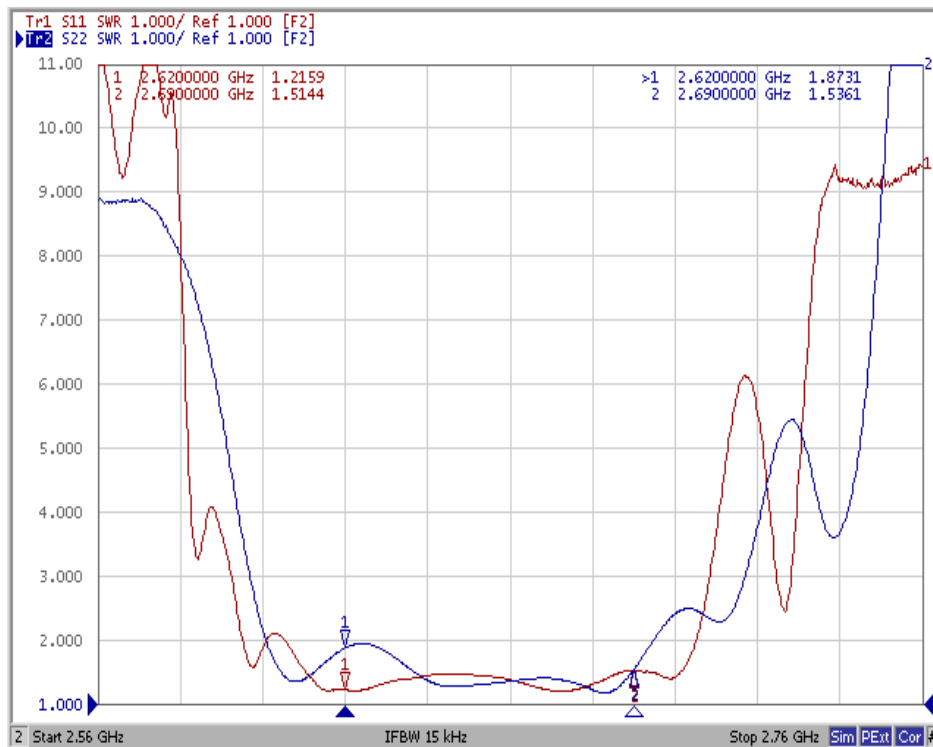

SAW Filter 2655 MHz
Part No: MP08939

Model: TA1847B
Rev No: 1

Smith Chart

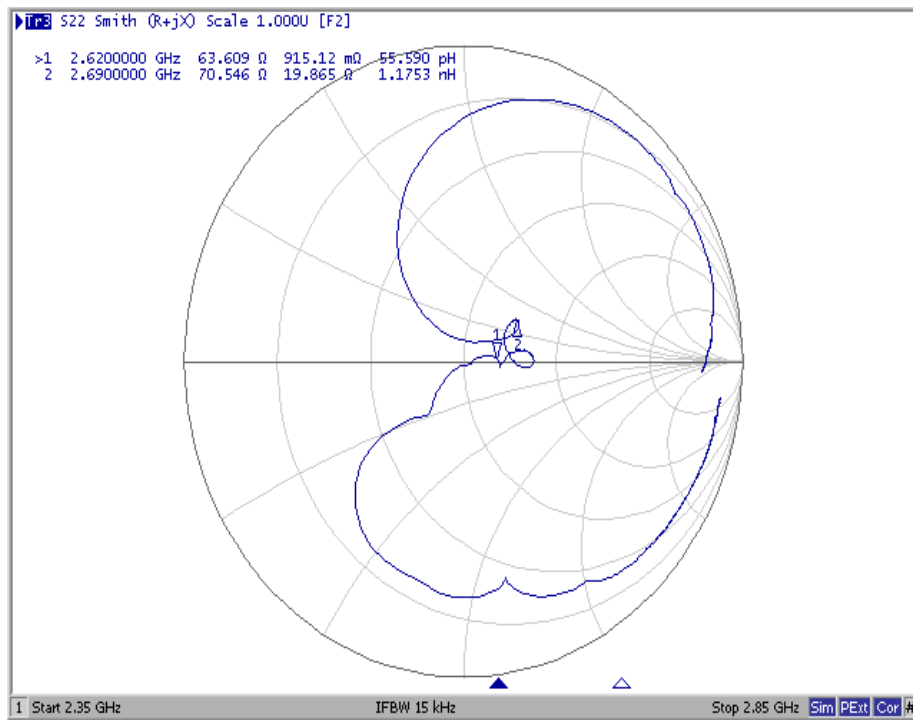
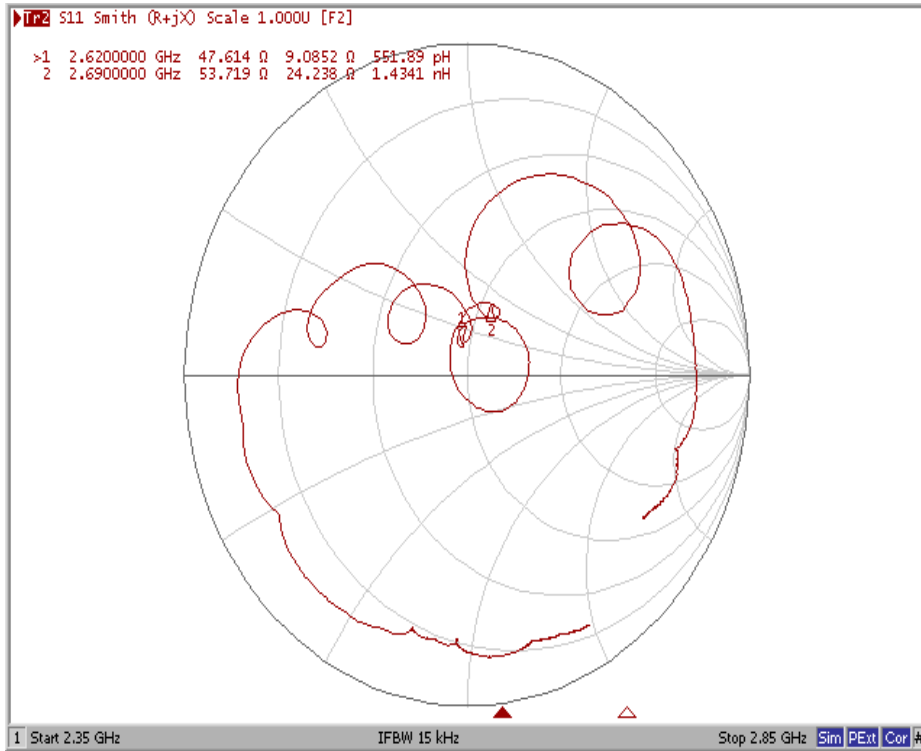

SAW Filter 2655 MHz
Part No: MP08939

Model: TA1847B
Rev No: 1

E. PCB FOOTPRINT:

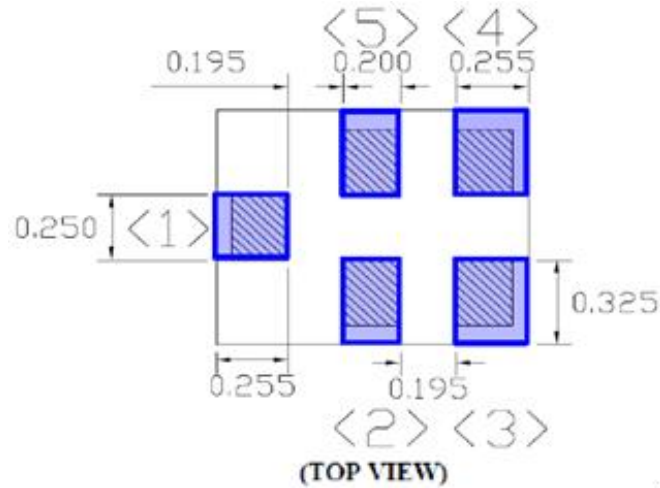

F. OUTLINE DRAWING:

Device size: 1.1typ. x 0.9typ. x 0.5max.

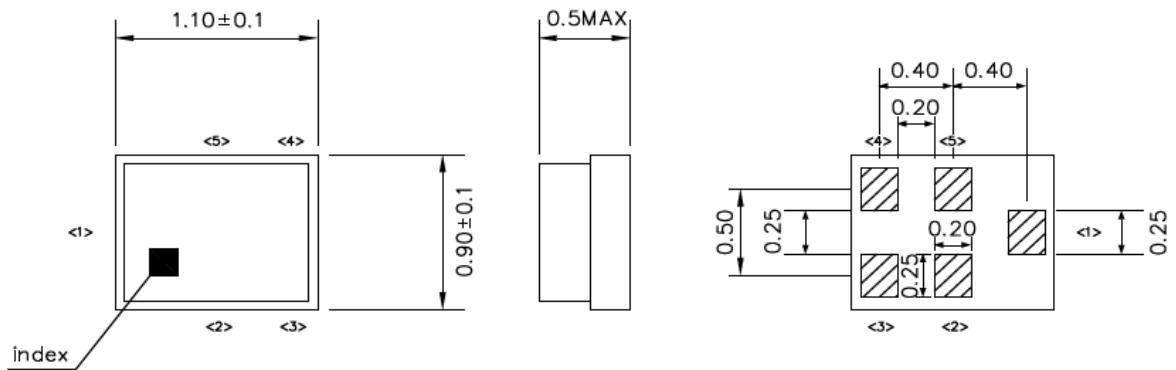

Unit : mm

Pin configuration

Pin No.	Symbol	Function
1	IN	Unbalanced pin
2	GND	Ground
3	GND	Ground
4	OUT	Unbalanced pin
5	GND	Ground

SAW Filter 2655 MHz
Part No: MP08939

Model: TA1847B
Rev No: 1

G PACKING:

1. Reel dimension

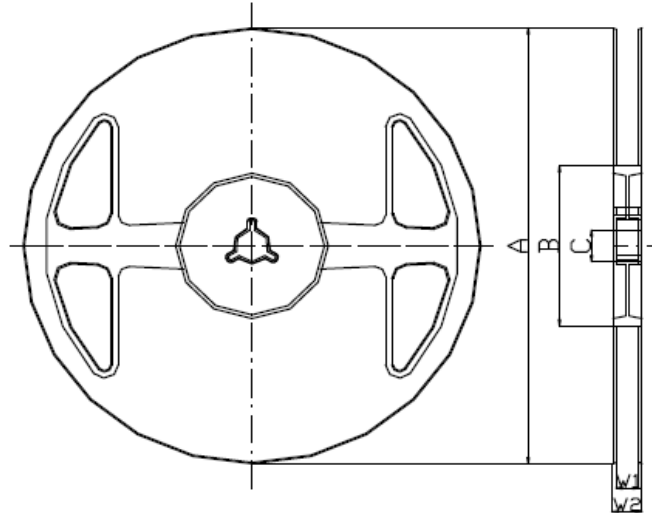

Materials of Reel

Material : Polystyrene + Carbon

Color : Black

Surface resistance (reference value) : $10^9 \Omega/\text{sq}$ Max.

Unit : mm

Code	Quantity	A	B	C	W1	W2
J	5,000 pcs	ϕ 180.0 +0.0/-1.5	ϕ 66.0 +/-0.5	ϕ 13.0 +/-0.2	9.0 +1.0/-0.0	11.4 +/-1.0

2. Tape dimension

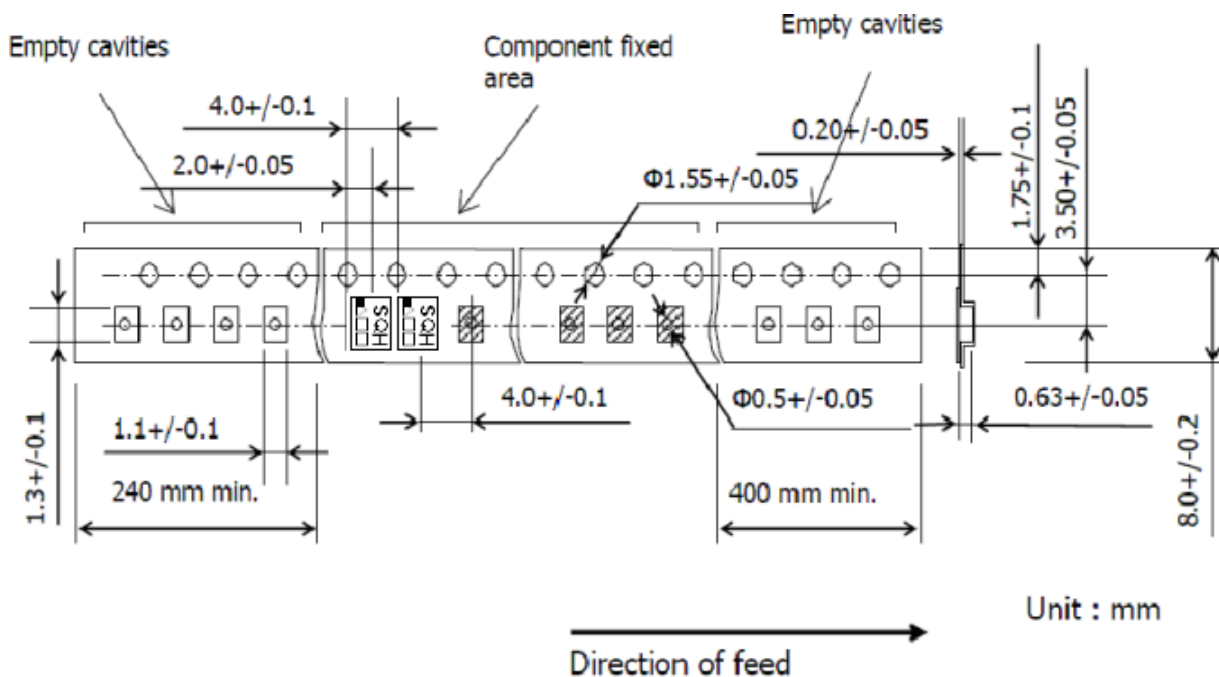

Unit : mm

SAW Filter 2655 MHz
Part No: MP08939

Model: TA1847B
Rev No: 1

H. RECOMMENDED REFLOW PROFILE:

1. Preheating shall be fixed at 150~180°C for 60~90 seconds.
2. Ascending time to preheating temperature 150°C shall be 30 seconds min.
3. Heating shall be fixed at 220°C for 50~80 seconds and at 260°C+0/-5°C peak (20~40sec).
4. Time: 2 times.

