

**SAW Filter 1795.0MHz**

**Model: TA1947A**

**Part No: MP10447**

**Rev No: 1**

**A. MAXIMUM RATING:**

Electrostatic Sensitive Device

1. Input Power Level: 10dBm
2. DC voltage: 3V
3. Operating Temperature: -40°C to +85°C
4. Storage Temperature: -40°C to +85°C
5. Moisture Sensitivity Level: Level 1 (MSL 1)

**B. ELECTRICAL CHARACTERISTICS:**

Item	Unit	Min.	Typ.	Max.
Center frequency Fc	MHz	-	1795	-
Insertion loss within 1785 ~1805 MHz IL	dB	-	1.5	3.5
Amplitude ripple (p-p) within 1785 ~ 1805MHz	dB	-	0.2	2.0
Group Delay (1785 ~ 1805MHz)	ns	-	15.0	40.0
Return Loss (1785 ~ 1805MHz)	dB	10	15	-
Attenuation (Reference level from 0dB)				
800 ~ 1730MHz	dB	30	37	-
1730 ~ 1740MHz	dB	20	37	-
1740 ~ 1755MHz	dB	6	17	-
1835 ~ 1845MHz	dB	6	19	-
1845 ~ 2800MHz	dB	30	41	-
Source impedance Z <sub>S</sub>	Ω	-	50	-
Load impedance Z <sub>L</sub>	Ω	-	50	-

**C. MEASUREMENT CIRCUIT:**

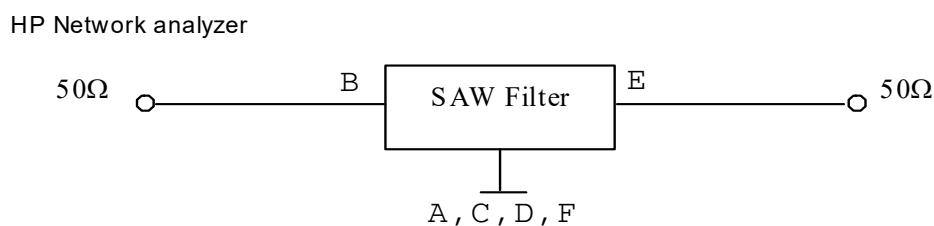



**SAW Filter 1795.0MHz**  
**Part No: MP10447**

**Model: TA1947A**  
**Rev No: 1**

**F. FREQUENCY CHARACTERISTICS:**

1. Transfer functions

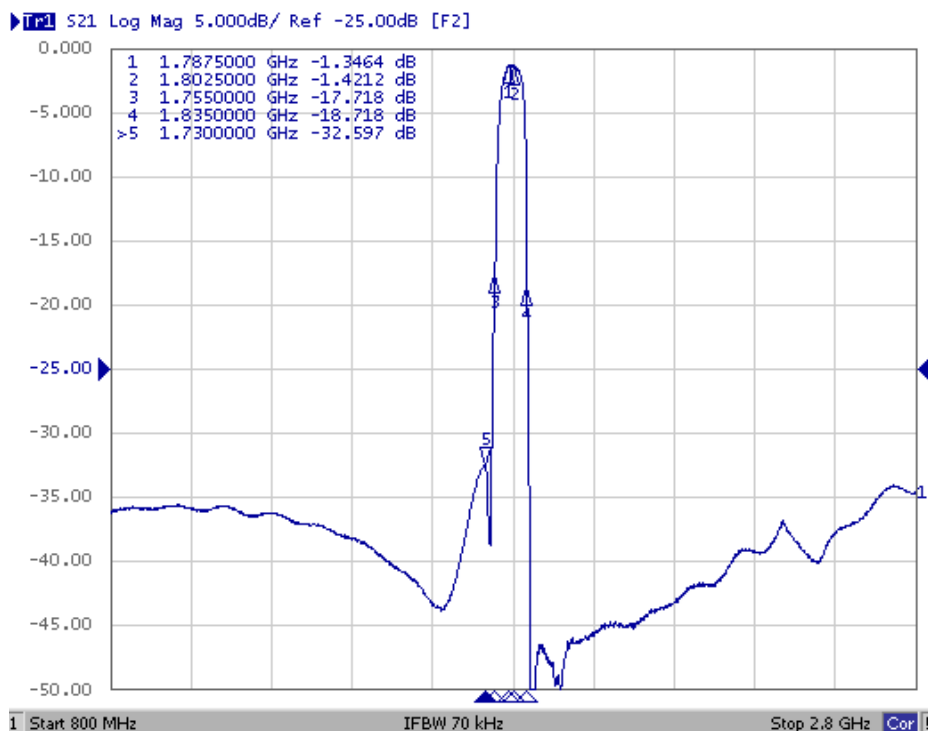
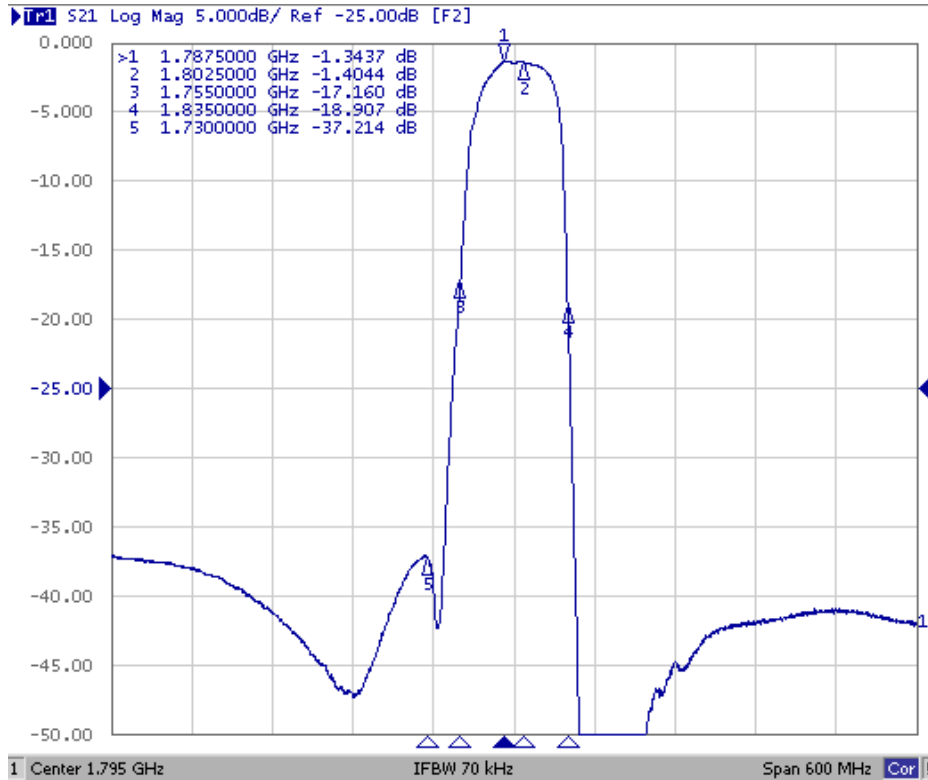

**SAW Filter 1795.0MHz**  
**Part No: MP10447**

**Model: TA1947A**  
**Rev No: 1**

## 2. Group delay

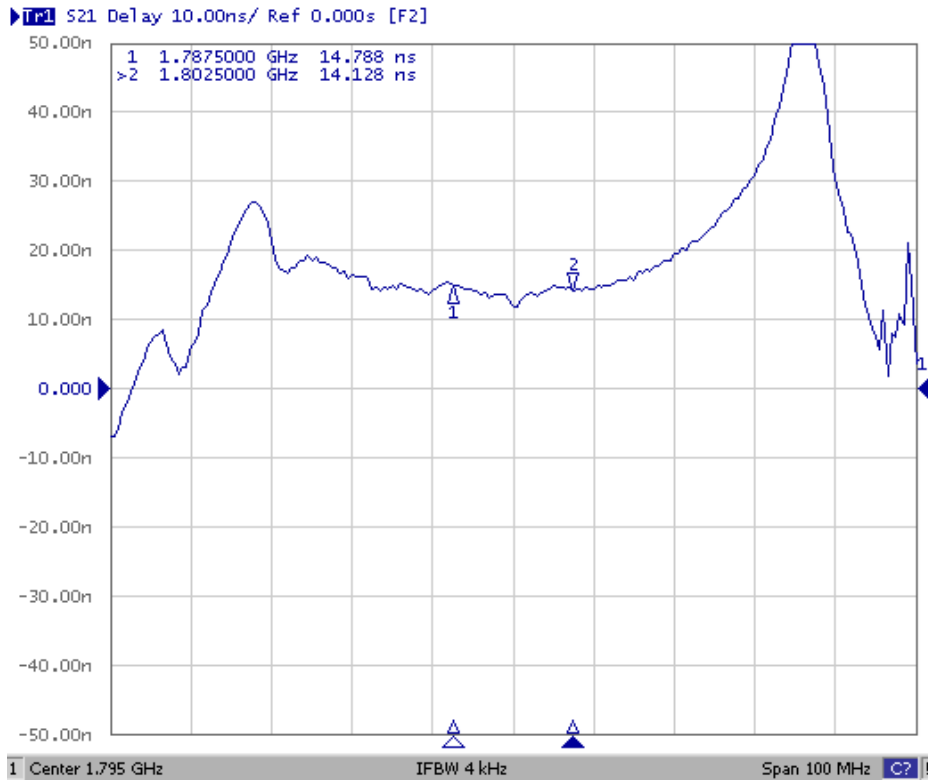

**SAW Filter 1795.0MHz**  
**Part No: MP10447**

**Model: TA1947A**  
**Rev No: 1**

### 3. Reflection Functions

#### Return loss

S11



S22

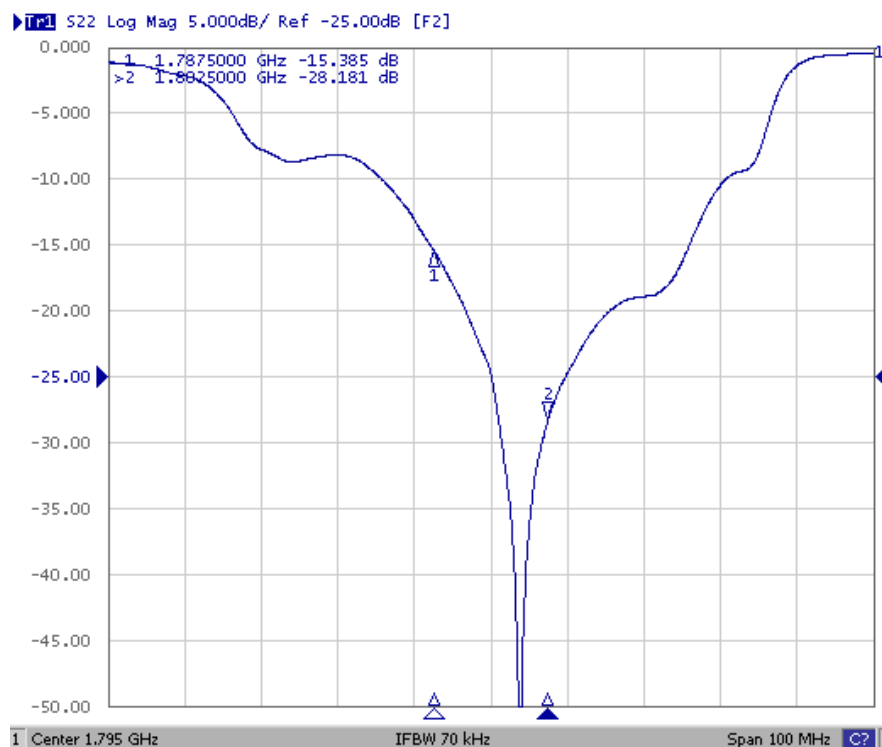

**SAW Filter 1795.0MHz**  
**Part No: MP10447**

**Model: TA1947A**  
**Rev No: 1**

**G. PACKING:**

1. Reel Dimensions

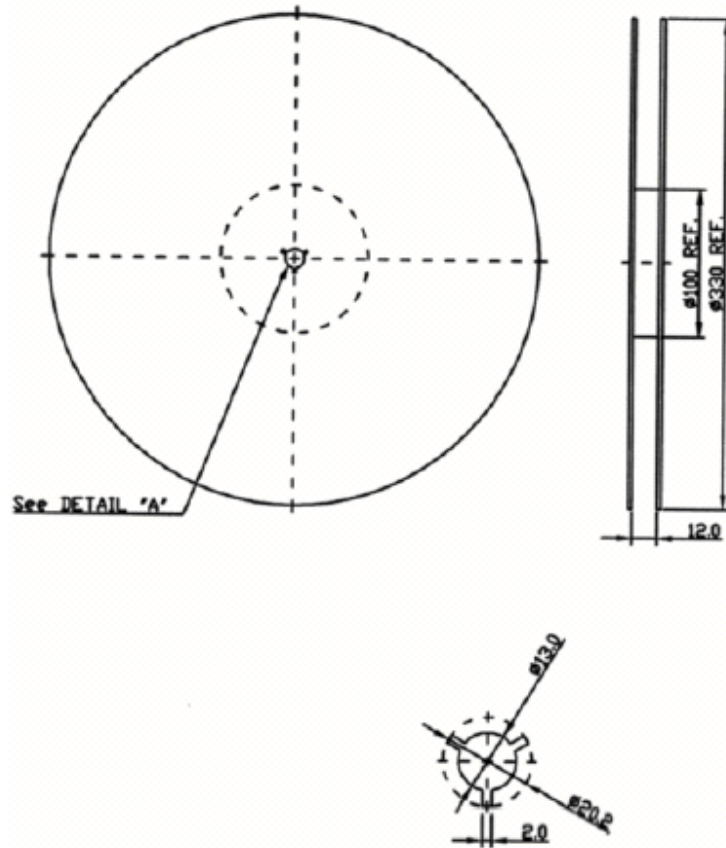

2. Tape Dimensions

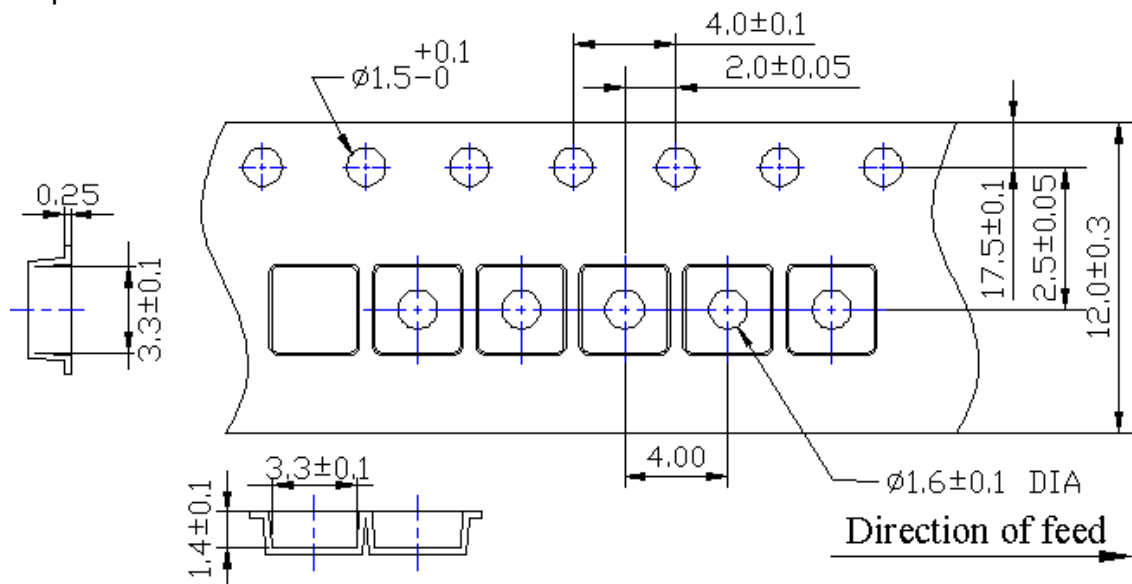

**SAW Filter 1795.0MHz**  
**Part No: MP10447**

**Model: TA1947A**  
**Rev No: 1**

**H. RECOMMENDED REFLOW PROFILE:**

1. Preheating shall be fixed at 150 ~ 180°C for 60 ~ 90 seconds.
2. Ascending time to preheating temperature 150°C shall be 30 seconds min.
3. Heating shall be fixed at 220°C for 50 ~ 80 seconds and at 260°C +0/-5°C peak (20 ~ 40 sec).
4. Time: 2 times.

