

1030.0MHz SAW Filter
Part No: MP11169

Model: TA2541A
Rev No: 1

A. MAXIMUM RATING:

Electrostatic Sensitive Device (ESD)

1. Input Power Level: 20dBm
2. DC Voltage: 6V
3. Operating Temperature: -20°C to +60°C
4. Storage Temperature: -40°C to +85°C

B. ELECTRICAL CHARACTERISTICS:

1. Terminating source impedance (single): $Z_S = 50\Omega$
2. Terminating load impedance (single): $Z_L = 50\Omega$

Item	Unit	Min	Typ.	Max
Center Frequency Fc	MHz	-	1030.	-
Insertion Loss (1029~1031MHz) IL	dB		3.0	4.0
VSWR (1029~1031MHz)			1.5	2.0
Group delay (1029~1031MHz)	ns	90	100	110
Variation of group delay (1029~1031MHz)	ns		20	30 ¹⁾
Amplitude ripple				
(1029~1031MHz)	dB		0.5	1.2
Attenuation				
1024.5 ~ 1035.5MHz	dB	4	5	23~ 27°C
1020 ~ 1041MHz	dB	25	30	23~ 27°C
1015 ~ 1045MHz	dB	35	40	23~ 27°C
1005 ~ 1055MHz	dB	45	50	
990 ~ 1070MHz	dB	50	55	
Temperature coefficient	ppm/°C	-36		
Package size	mm	SMD 3x3		

Averaged over 2MHz

1030.0MHz SAW Filter
Part No: MP11169

Model: TA2541A
Rev No: 1

C. TEST CIRCUIT:

(2): Unbalance Port

(5): Unbalance Port

Others: Ground

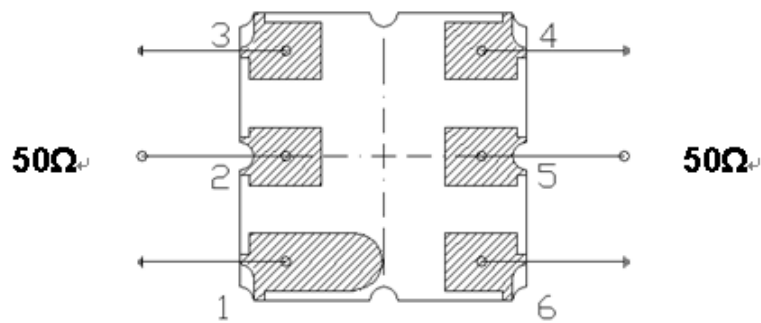

1030.0MHz SAW Filter
Part No: MP11169

Model: TA2541A
Rev No: 1

D. FREQUENCY CHARACTERISTICS:

1. S21 response :(Span 200MHz)

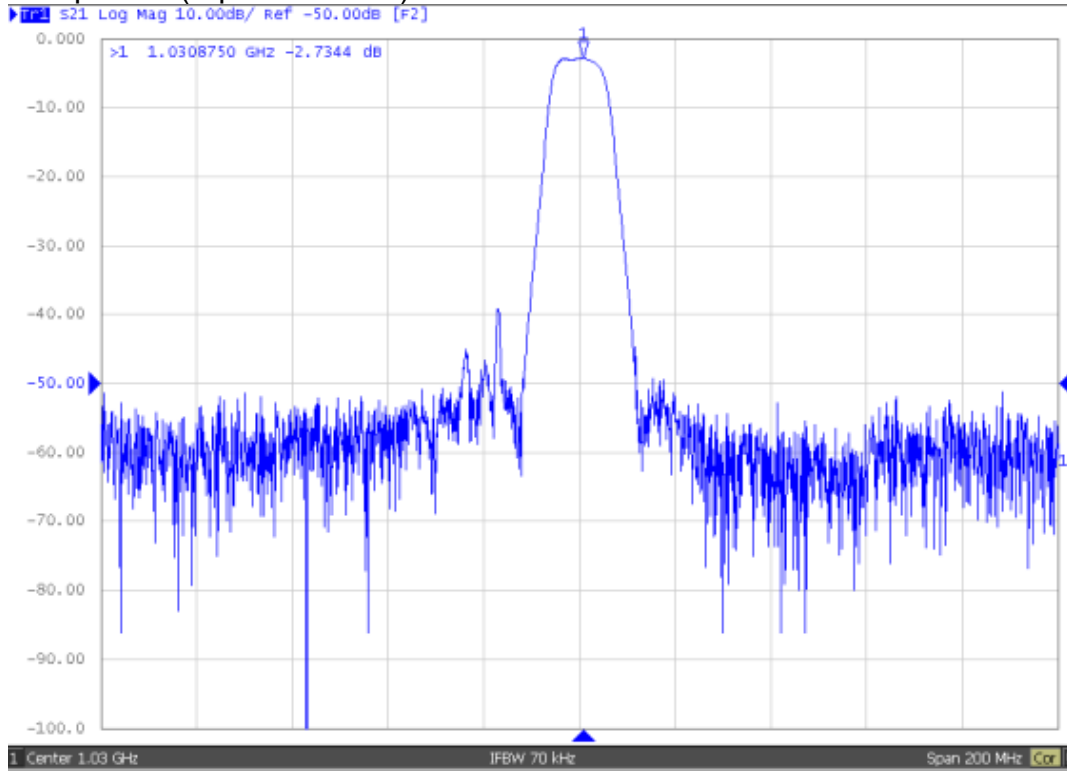

2. S21 response :(Span 20MHz)

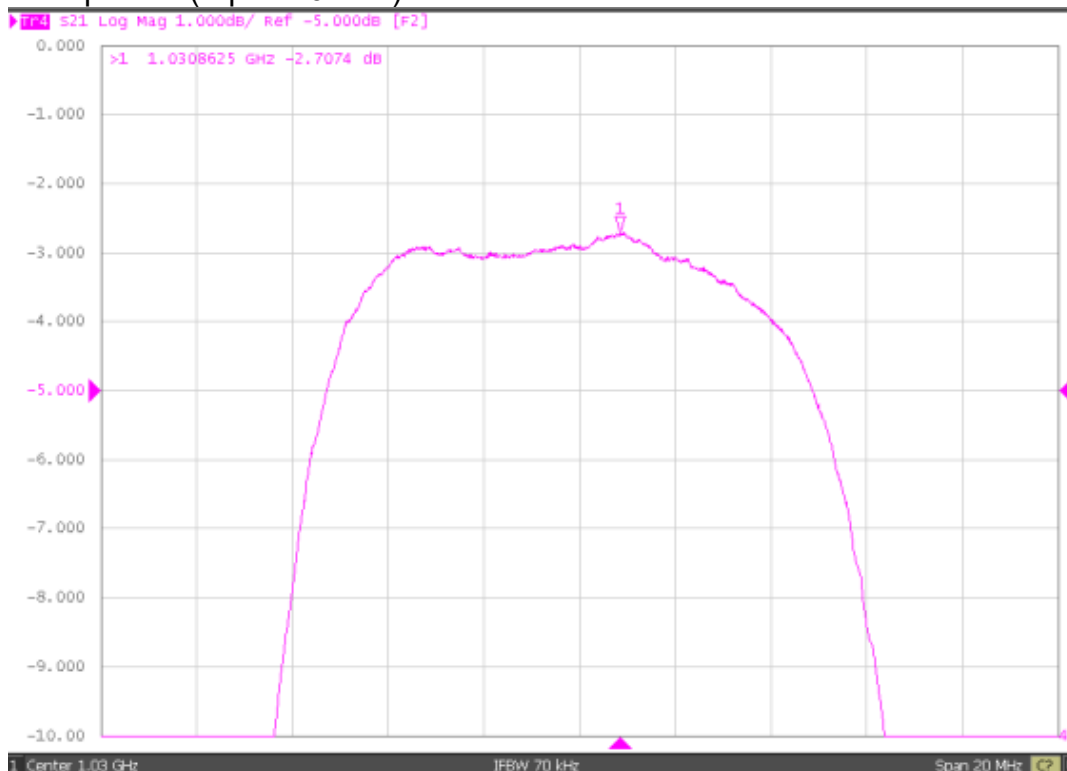

1030.0MHz SAW Filter
Part No: MP11169

Model: TA2541A
Rev No: 1

3. S21 response :(Span 3GHz)

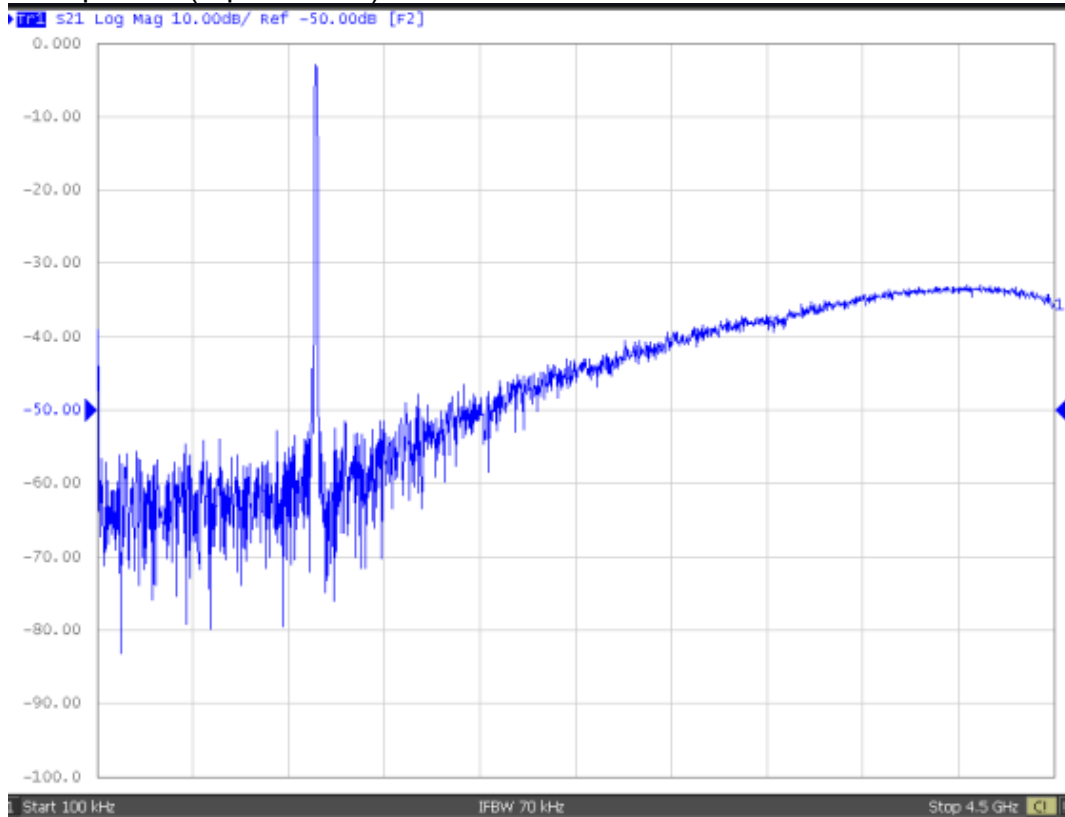

4. G_Delay response :(Span 10MHz)

TA2541A

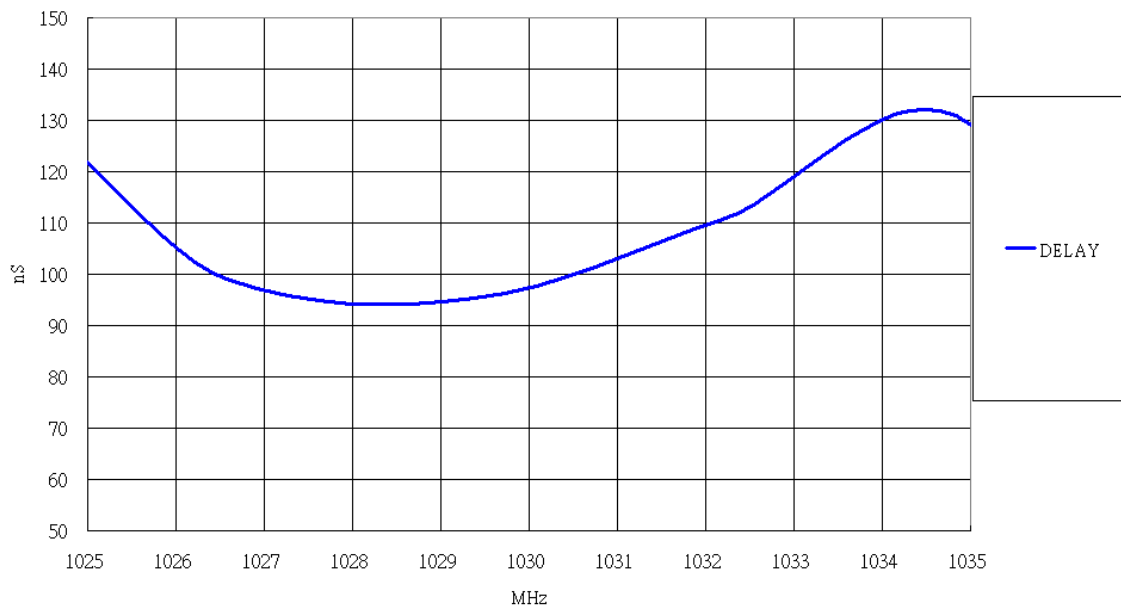

1030.0MHz SAW Filter
Part No: MP11169

Model: TA2541A
Rev No: 1

E. OUTLINE DRAWING:

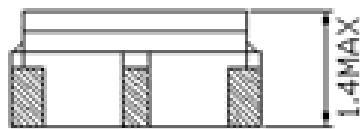
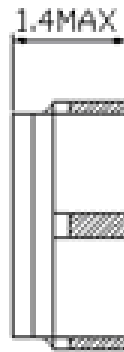
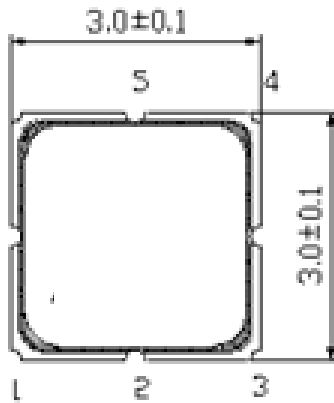

Unit : mm

Not Specified Tolerance : +/-0.15 mm

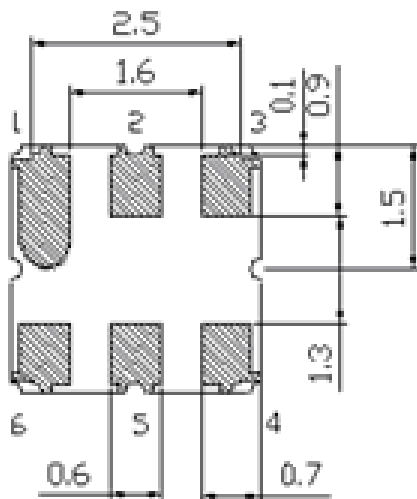

Pin No.	Symbol	Function
1	GND	Ground
2	IN	Input
3	GND	Ground
4	GND	Ground
5	OUT	Output
6	GND	Ground

1030.0MHz SAW Filter
Part No: MP11169

Model: TA2541A
Rev No: 1

F. PACKING:

1. Reel Dimensions

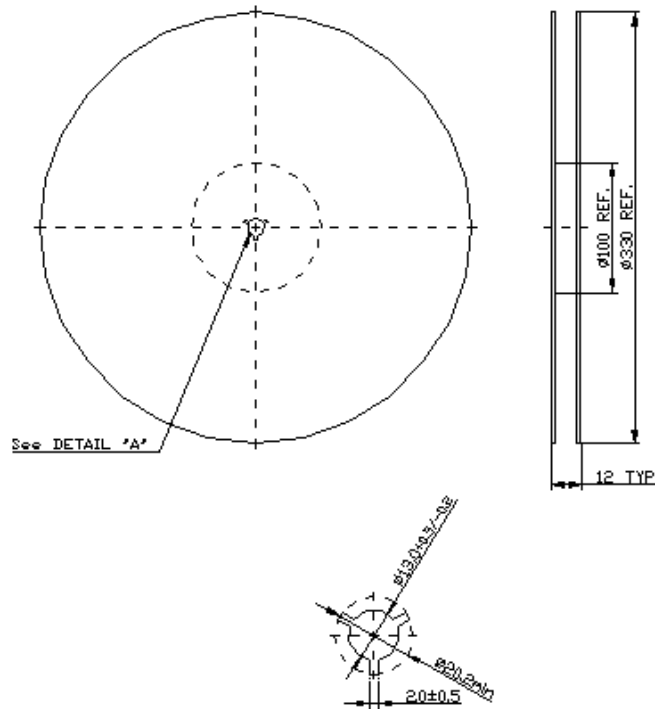

2. TAPE DIMENSION.

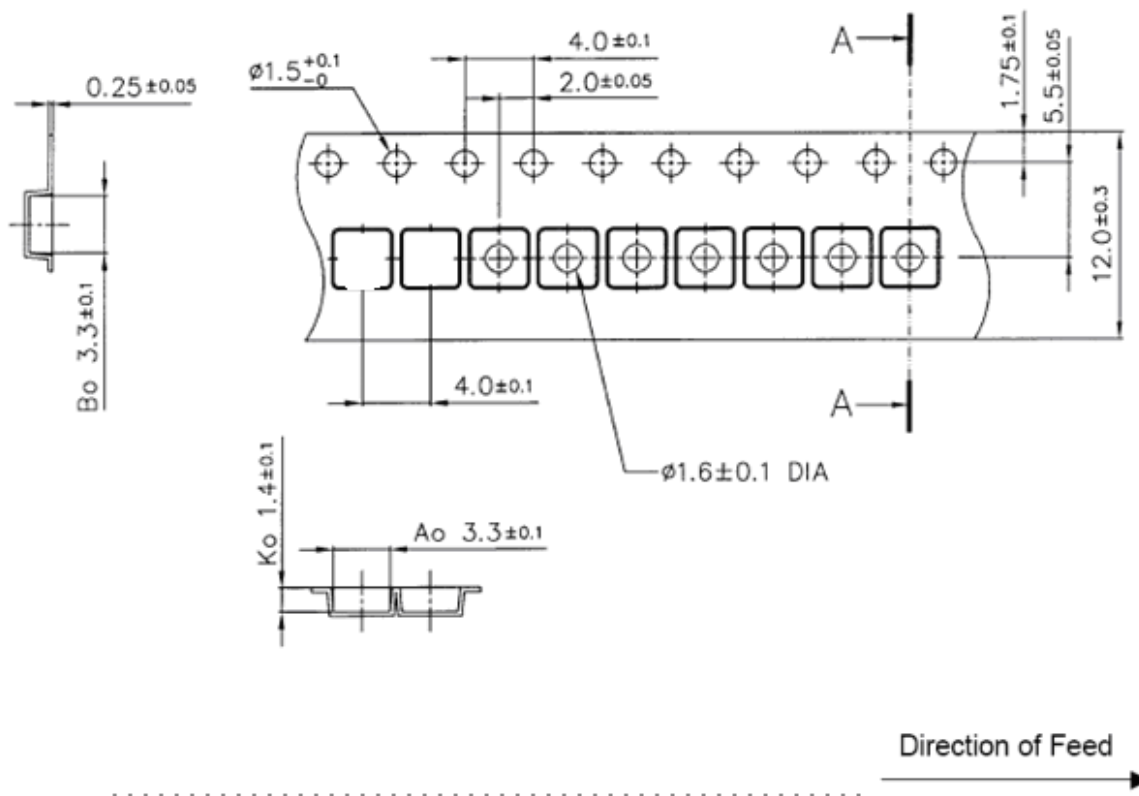

1030.0MHz SAW Filter
Part No: MP11169

Model: TA2541A
Rev No: 1

G. RECOMMENDED REFLOW PROFILE:

1. Preheating shall be fixed at 150~180°C for 60~90 seconds.
2. Ascending time to preheating temperature 150°C shall be 30 seconds min.
3. Heating shall be fixed at 220°C for 50~80 seconds and at 260°C +0/-5°C peak (20~40 sec).
4. Time: 2 times.

