

SAW Filter 770.0MHz
Part No: MP10220

Model: TA1557A
Rev No: 1

A. MAXIMUM RATING:

1. Input Power Level: 20dBm
2. DC voltage: 3V
3. Operating Temperature: -30°C to +85°C
4. Storage Temperature: -40°C to +85°C

B. ELECTRICAL CHARACTERISTICS:

Item	Unit	Min.	Typ.	Max.	Note
Center Frequency Fc	MHz	-	770	-	-
Max. Insertion Loss (764 ~ 776MHz) IL	dB	-	2.3	3.5	-
Passband ripple (764 ~ 776MHz)	dB	-	0.9	2.0	-
Source Impedance (single ended)	Ω	-	50	-	-
Load Impedance (single ended)	Ω	-	50	-	-
Attenuation					
D.C ~ 736MHz	dB	45	57	-	-
736 ~ 746MHz	dB	30	44	-	-
802 ~ 825MHz	dB	30	47	-	-
825 ~ 1300MHz	dB	45	60	-	-
Package size	mm	SMD 3.8 x 3.8			

C. MEASUREMENT CIRCUIT:

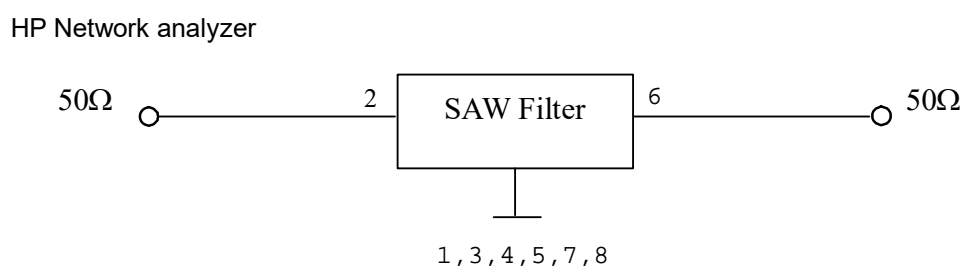

SAW Filter 770.0MHz
Part No: MP10220

Model: TA1557A
Rev No: 1

D. FREQUENCY CHARACTERISTICS:

1. Wide band Response: (span 1.3GHz)

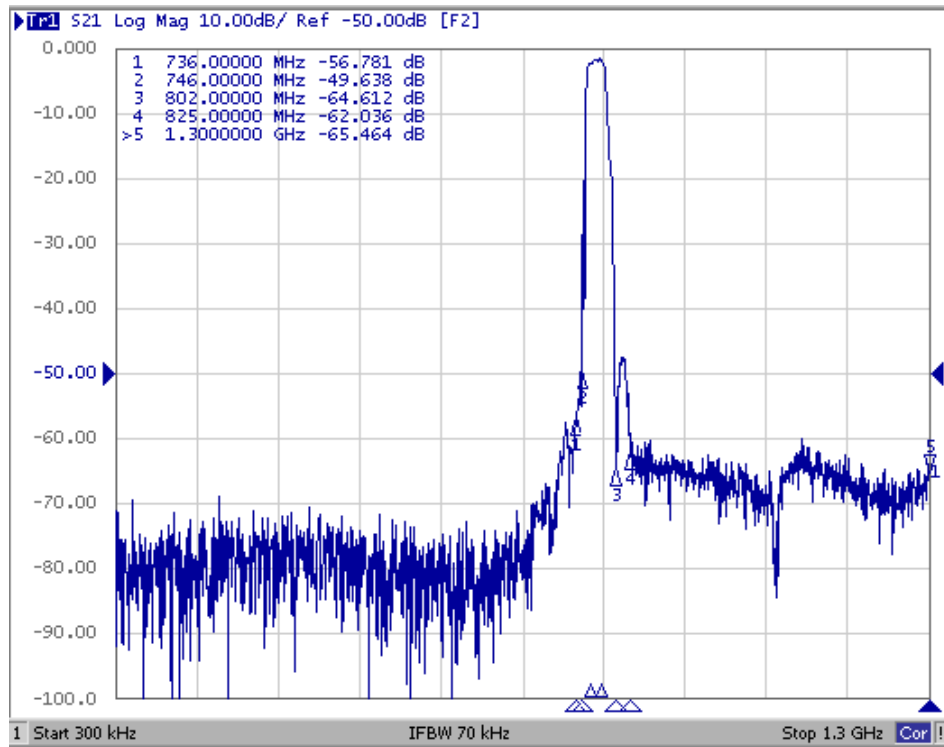

2. Pass band Response:(span 200MHz)

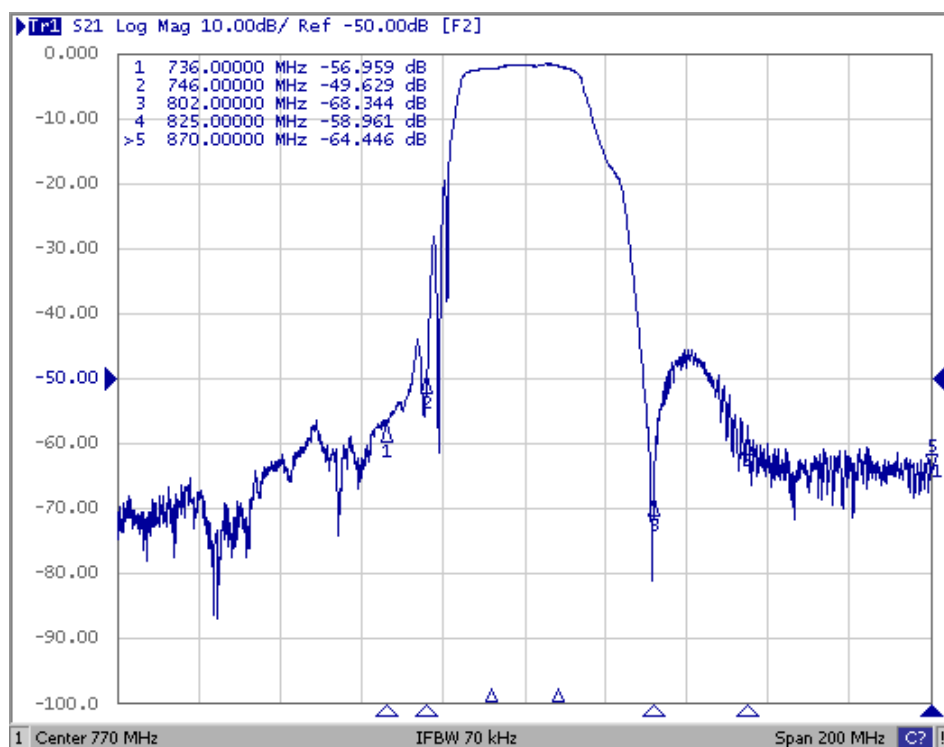

SAW Filter 770.0MHz
Part No: MP10220

Model: TA1557A
Rev No: 1

3. Pass band Response: (span 50MHz)

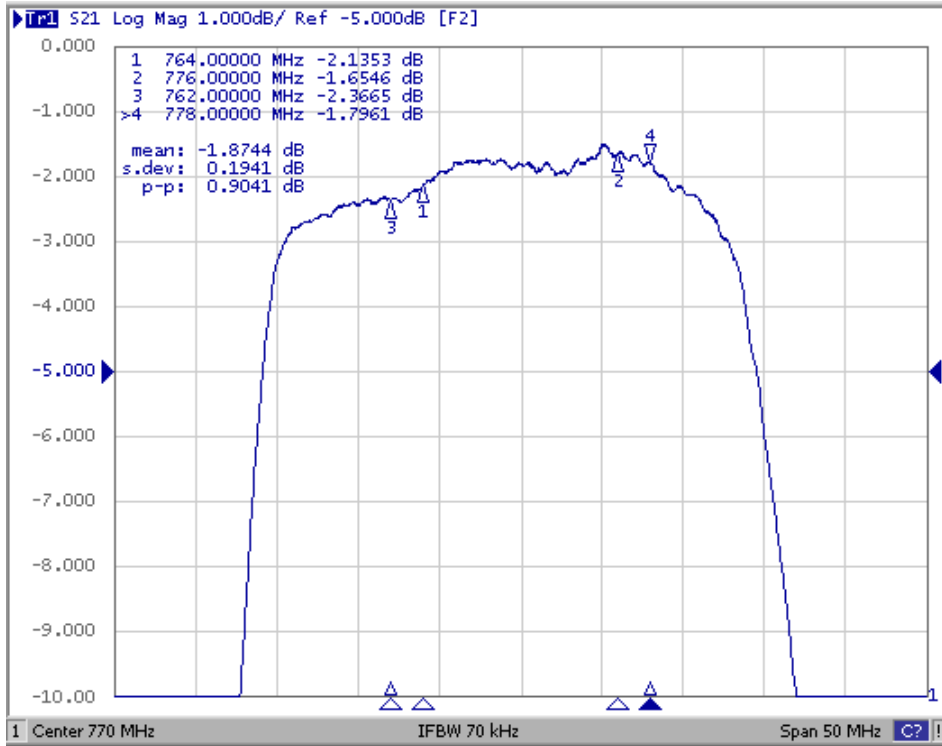

4. S11 & S22 VSWR Response: (span 50MHz)

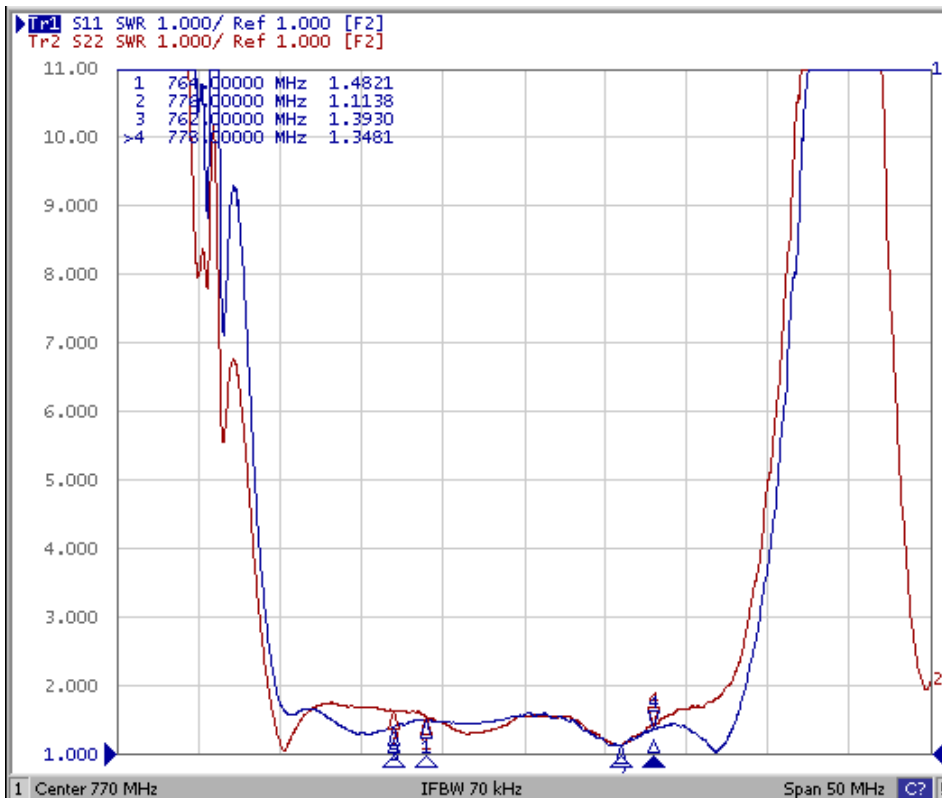

SAW Filter 770.0MHz
Part No: MP10220

Model: TA1557A
Rev No: 1

E. OUTLINE DRAWING:

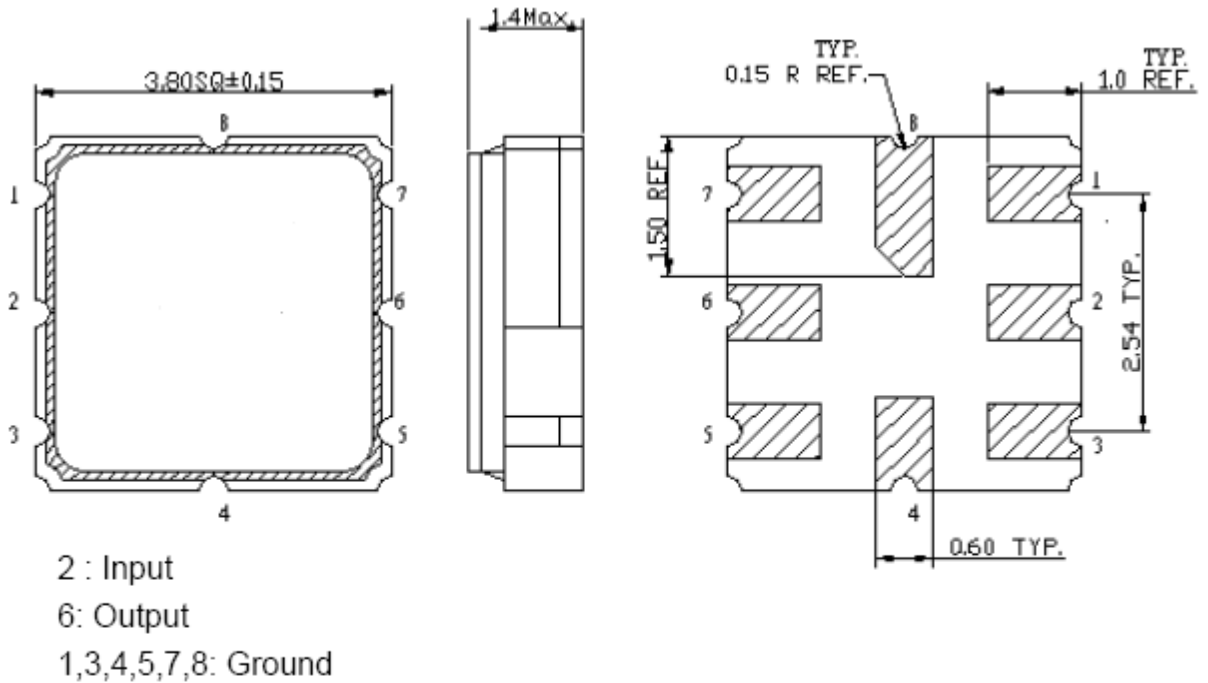

F. PCB FOOTPRINT:

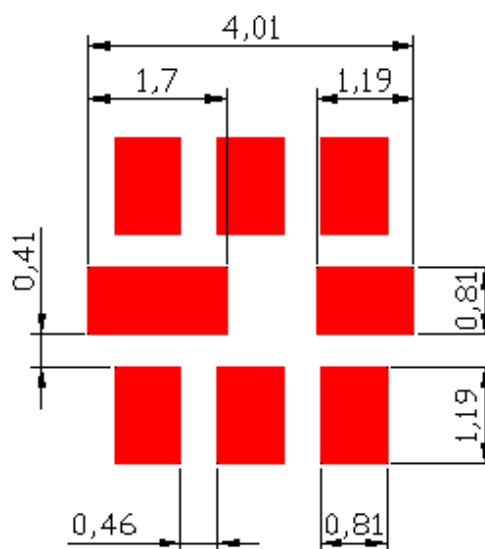

SAW Filter 770.0MHz
Part No: MP10220

Model: TA1557A
Rev No: 1

G. PACKING:

1. Reel Dimensions

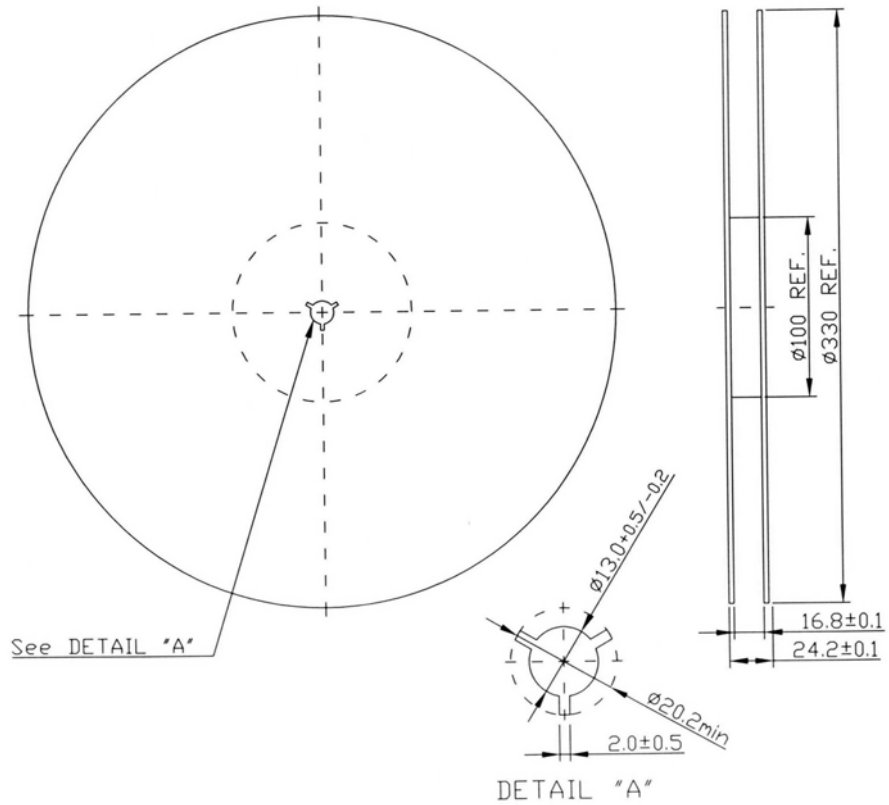

2. Tape Dimensions

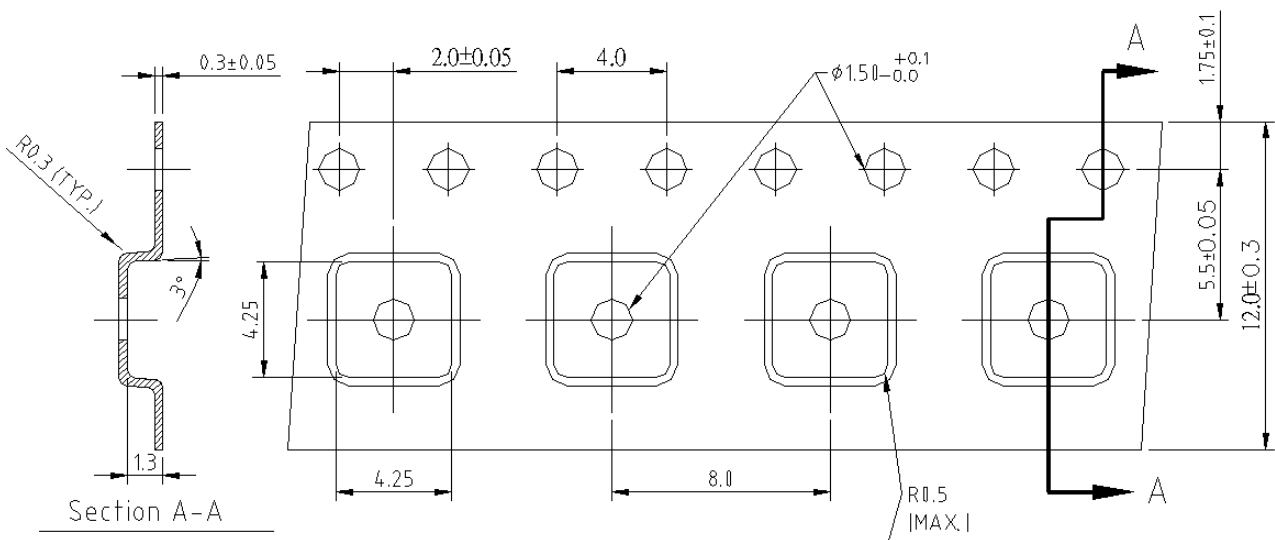

SAW Filter 770.0MHz
Part No: MP10220

Model: TA1557A
Rev No: 1

H. RECOMMENDED REFLOW PROFILE:

