

SAW Filter 915.0MHz
Part No: MP10080

Model: TA2211A
Rev No: 1

A. MAXIMUM RATING:

Electrostatic Sensitive Device (ESD)

1. Input Power Level: 16dBm
2. DC Voltage: 3.6V
3. Operating Temperature: -30°C to +70°C
4. Storage Temperature: -40°C to +85°C
5. Moisture Sensitivity Level: Level 1

B. ELECTRICAL CHARACTERISTICS:

1. Terminating source impedance: $Z_S = 50\Omega$
2. Terminating load impedance: $Z_L = 50\Omega$

Item	Unit	Min.	Typ.	Max.
Center Frequency	MHz	-	915	-
Insertion Loss (910 ~ 920MHz)	dB	-	2.6	3.5
Amplitude ripple (910 ~ 920MHz)	dB	-	0.6	1.6
VSWR (910 ~ 920MHz)	-	-	1.4	2.0
Attenuation				
00 10 ~ 895MHz	dB	35	39	-
895 ~ 902MHz	dB	10	19	-
929 ~ 1000MHz	dB	25	28	-
1000 ~ 1500MHz	dB	40	42	-
1500 ~ 2600MHz	dB	30	40	-
Temperature Coefficient	ppm/K	-	-36	-

Notes:

1. In production, devices will be tested at room temperature to a guard banded specification to ensure electrical compliance over temperature.
2. Typical values are based on average measurements at room temperature.

SAW Filter 915.0MHz
Part No: MP10080

Model: TA2211A
Rev No: 1

C. FREQUENCY CHARACTERISTICS:

1. Span 150MHz

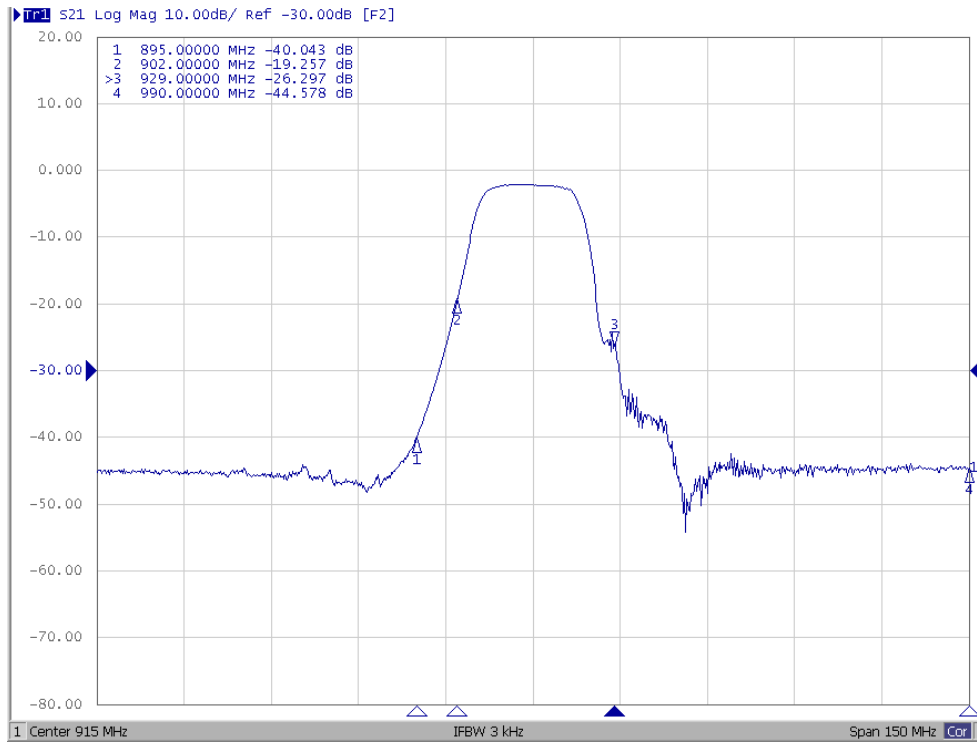

2. Span 3000MHz

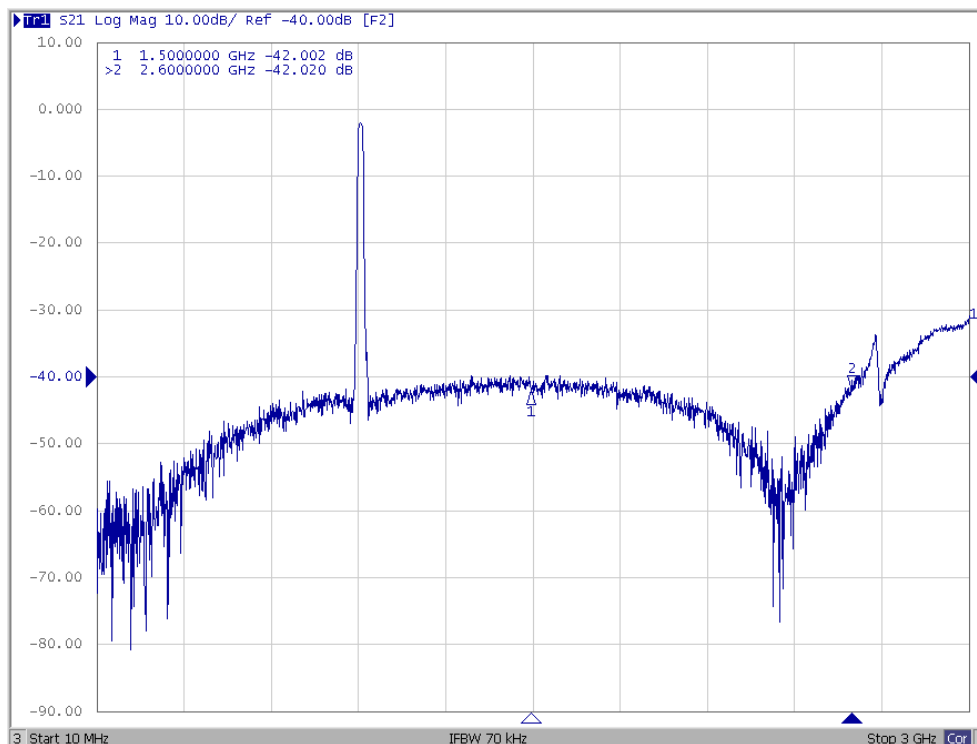

SAW Filter 915.0MHz
Part No: MP10080

Model: TA2211A
Rev No: 1

3. Span 50MHz

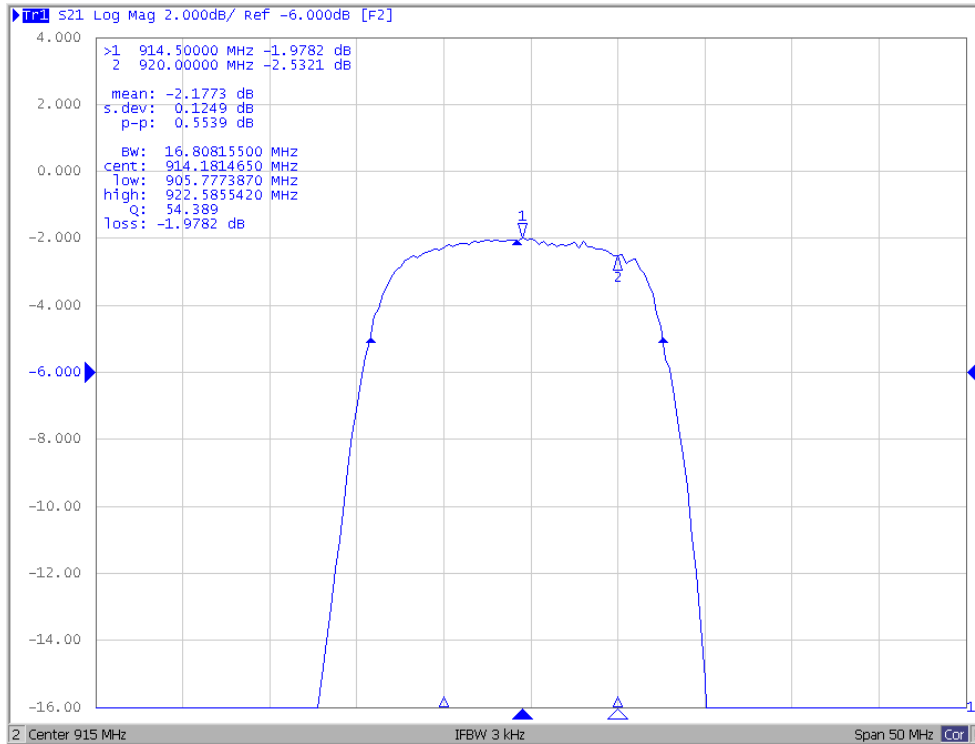

4. Reflection Respond (VSWR, Smith Chart) Span 50MHz

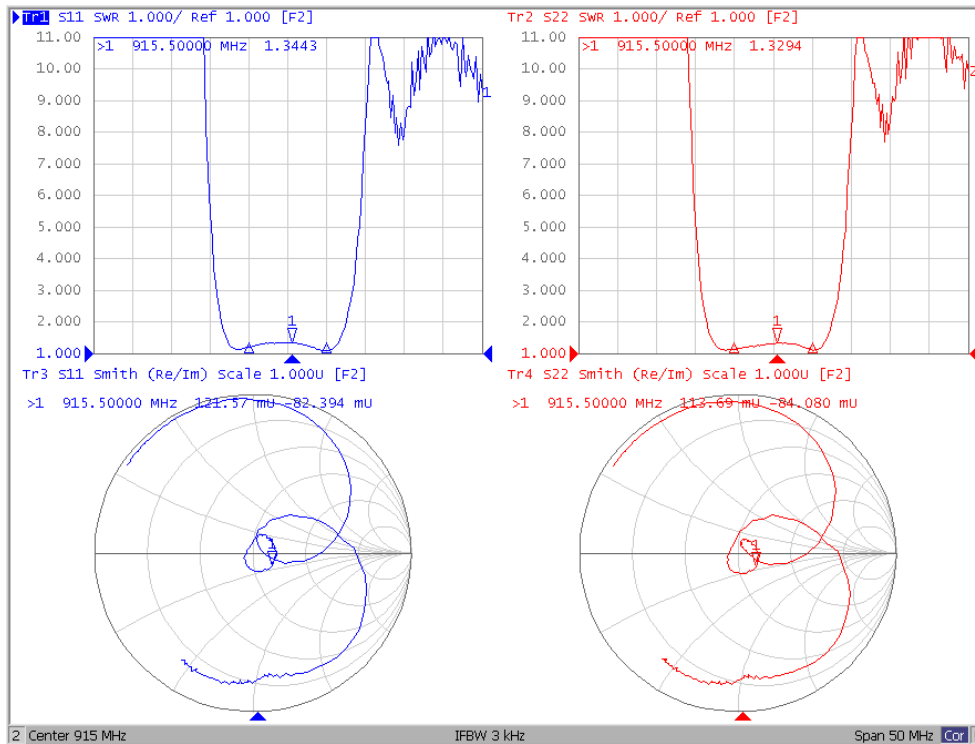

SAW Filter 915.0MHz
Part No: MP10080

Model: TA2211A
Rev No: 1

D. MEASUREMENT CIRCUIT:

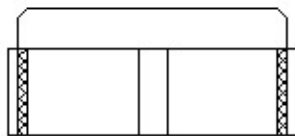
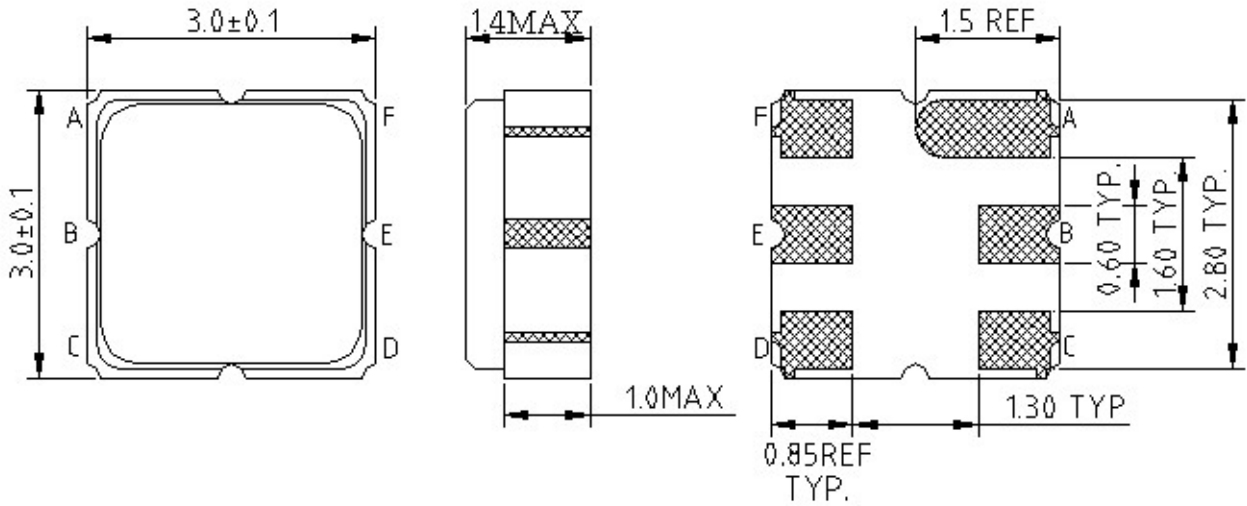

B: Input
 E: Output
 A, C, D, F: Ground
 Unit: mm

E. PCB FOOTPRINT:

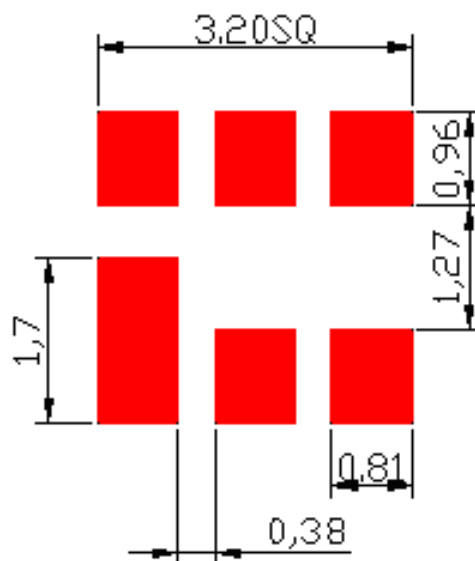

SAW Filter 915.0MHz
Part No: MP10080

Model: TA2211A
Rev No: 1

F. PACKING:

1. Reel Dimensions

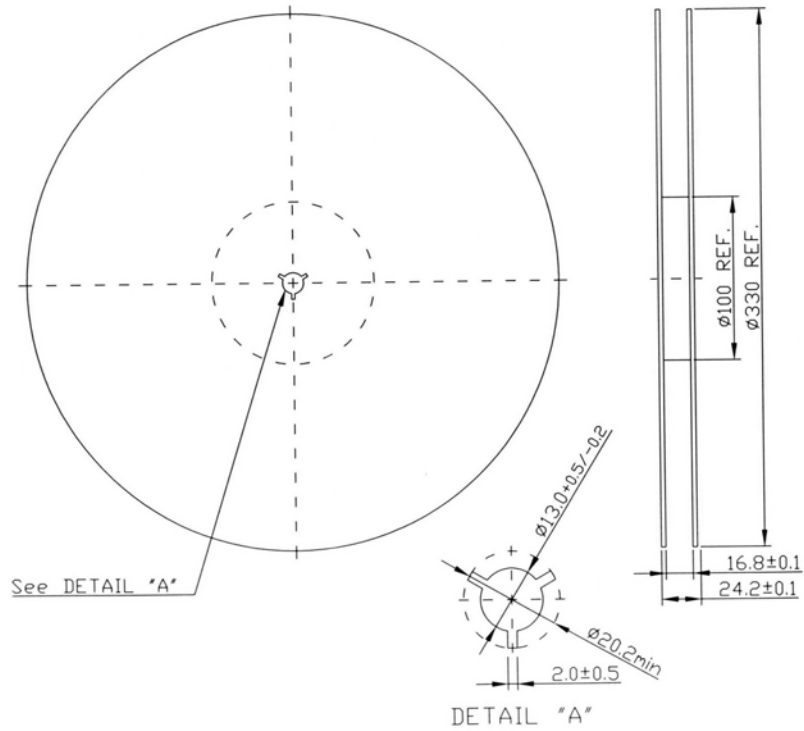

2. Tape Dimensions

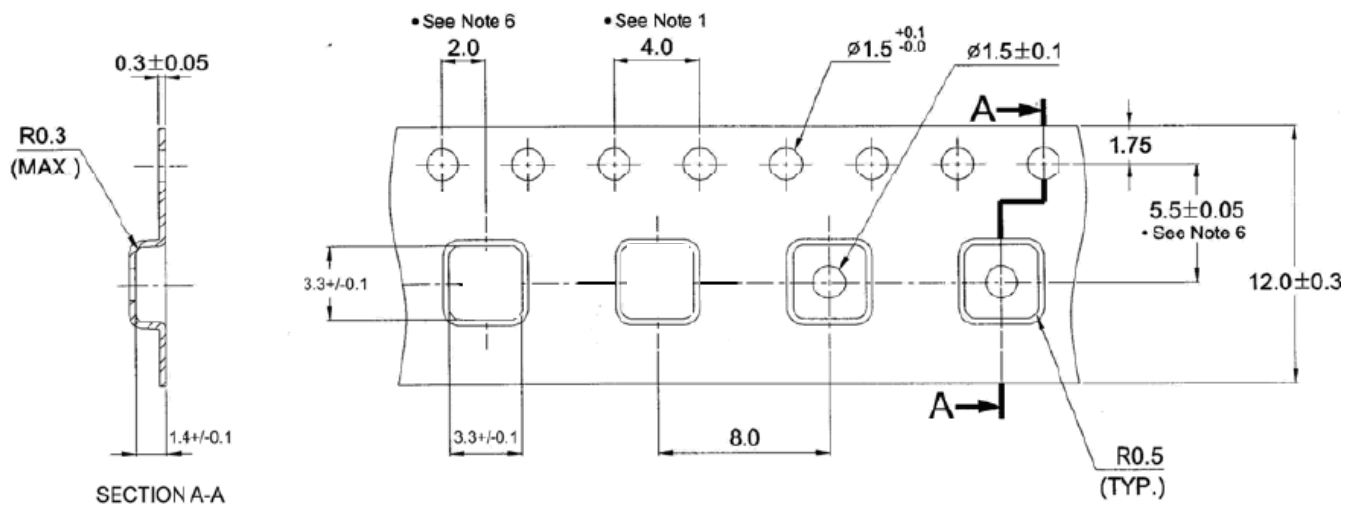

SAW Filter 915.0MHz
Part No: MP10080

Model: TA2211A
Rev No: 1

G. RECOMMENDED REFLOW PROFILE:

1. Preheating shall be fixed at 150 ~ 180°C for 60 ~ 90 seconds.
2. Ascending time to preheating temperature 150°C shall be 30 seconds min.
3. Heating shall be fixed at 220°C for 50 ~ 80 seconds and at 260°C +0/-5°C peak (20 ~ 40 sec).
4. Time: 2 times.

