

SAW Filter: 1740.0MHz

Model: TA2630A

Part No: MP10582

Rev No: 1

A. MAXIMUM RATING:

Electrostatic Sensitive Device (ESD)

1. Input Power Level: 10dBm
2. DC Voltage: 0V
3. Operating Temperature: -30°C to +85°C
4. Storage Temperature: -40°C to +85°C
5. Moisture Sensitivity Level: Level 3 (MSL3)

B. ELECTRICAL CHARACTERISTICS:

1. Terminating source impedance (single): $Z_S = 50\Omega$
2. Terminating load impedance(single): $Z_L = 50\Omega$

Item	Unit	Min	Typ.	Max
Center Frequency Fc	MHz	-	1740	-
Insertion Loss (1710 ~ 1770MHz) IL	dB		1.5	2.7
Amplitude ripple (1710 ~ 1770MHz)			0.7	1.8
VSWR (1710 ~ 1770MHz)			2.0	2.5
Attenuation				
800 ~ 1355MHz	dB	30	37	
1574 ~ 1577MHz	dB	30	52	
1600 ~ 1680MHz	dB	12	22	
1805 ~ 1880MHz	dB	17	24	
1930 ~ 1990MHz	dB	30	36	
2110 ~ 2170MHz	dB	30	44	
Package size	mm	1411		

SAW Filter: 1740.0MHz
Part No: MP10582

Model: TA2630A
Rev No: 1

C. OUTLINE DRAWING:

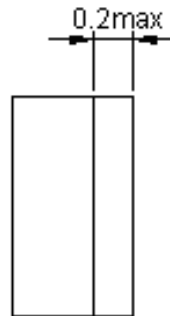
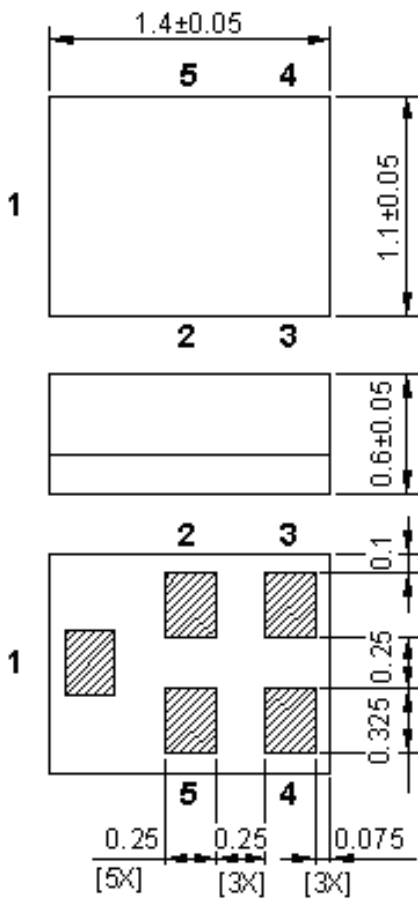

All tolerances are ± 0.05 mm unless otherwise specified
 Coplanarity : 0.1 mm max.
 1 to 5 : Pin No.
 Unit : mm

Pin-No.↕	Symbol↕	Function↕
1↕	IN↕	Input↕
2↕	GND↕	Ground↕
3↕	GND↕	Ground↕
4↕	OUT↕	Output↕
5↕	GND↕	Ground↕

D. MEASUREMENT CIRCUIT:

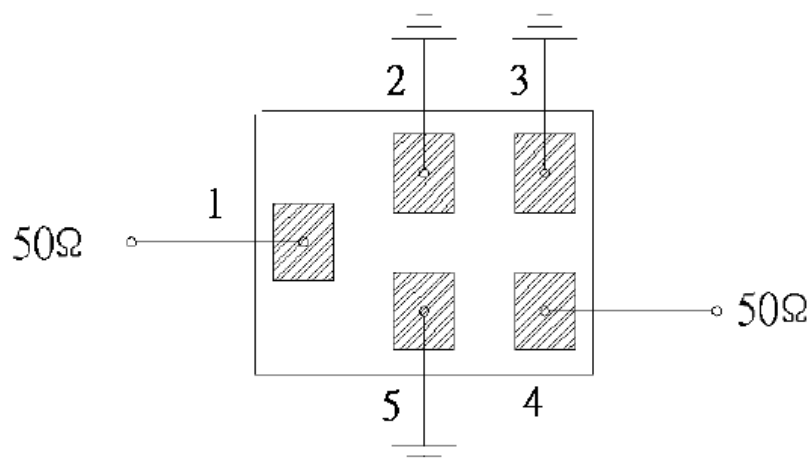

SAW Filter: 1740.0MHz
Part No: MP10582

Model: TA2630A
Rev No: 1

E. FREQUENCY CHARACTERISTICS:

1. S21 response: (span 500MHz)

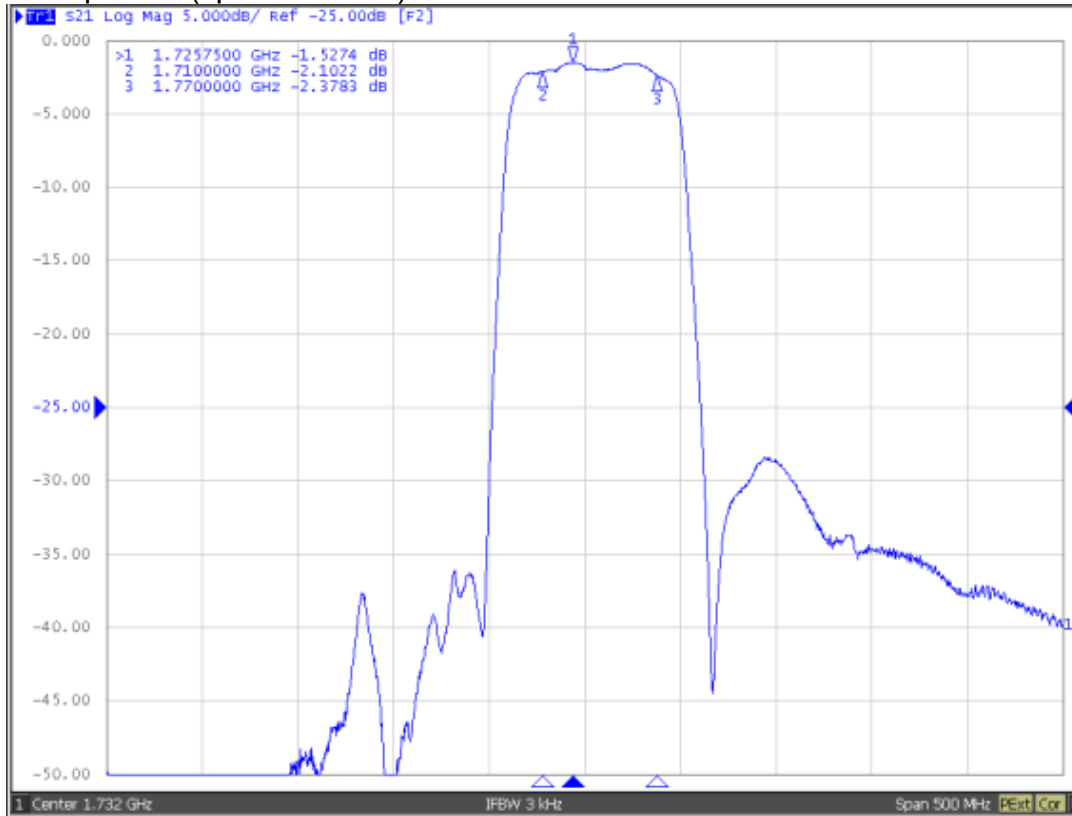

2. S21 response: (span 100MHz)

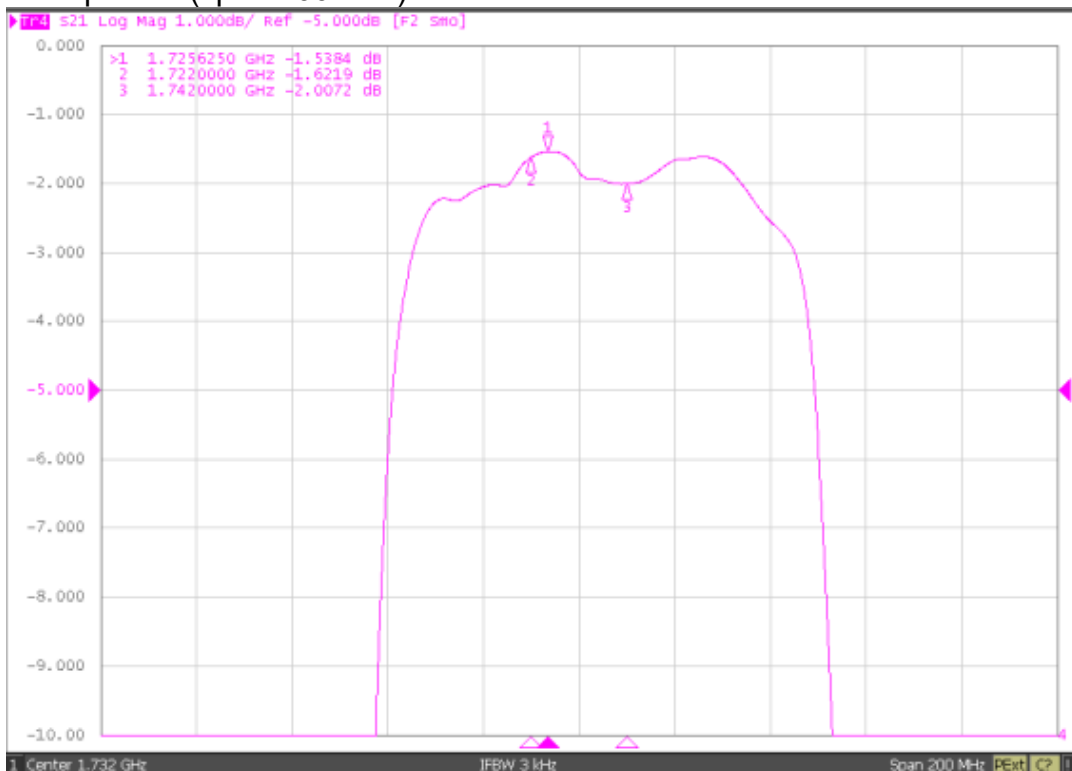

SAW Filter: 1740.0MHz
Part No: MP10582

Model: TA2630A
Rev No: 1

3. S21 response: (span 3000MHz)

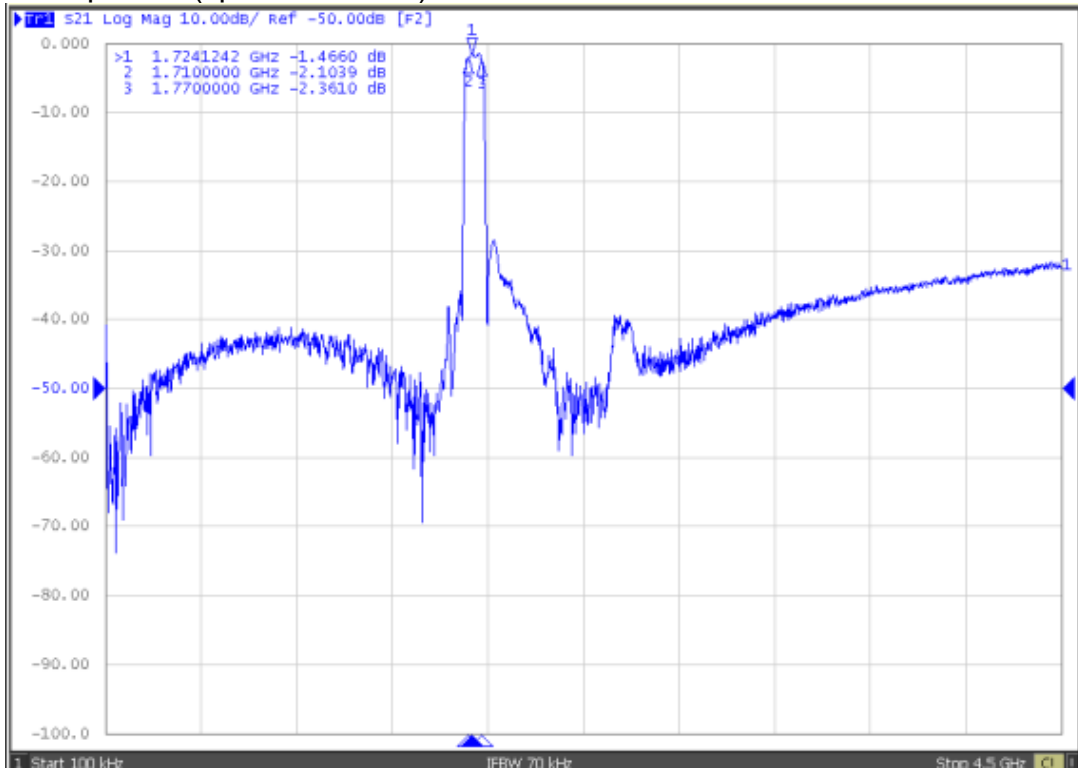

4. S11:

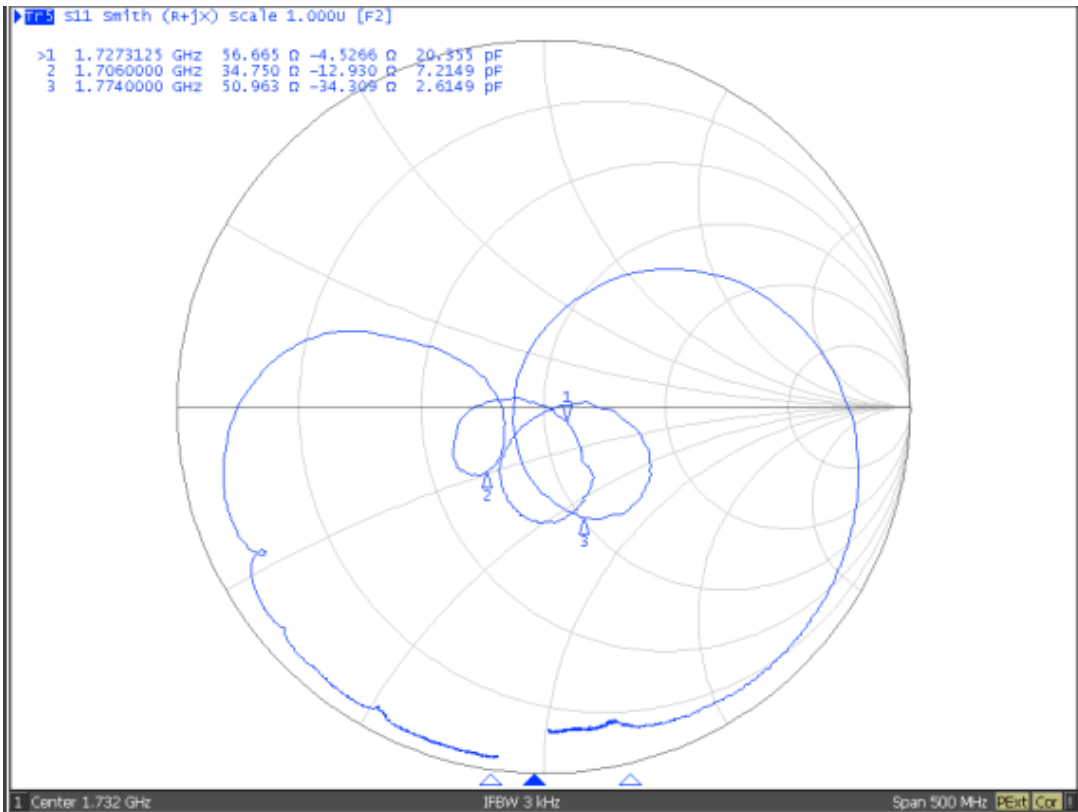

SAW Filter: 1740.0MHz
Part No: MP10582

Model: TA2630A
Rev No: 1

5. S22:

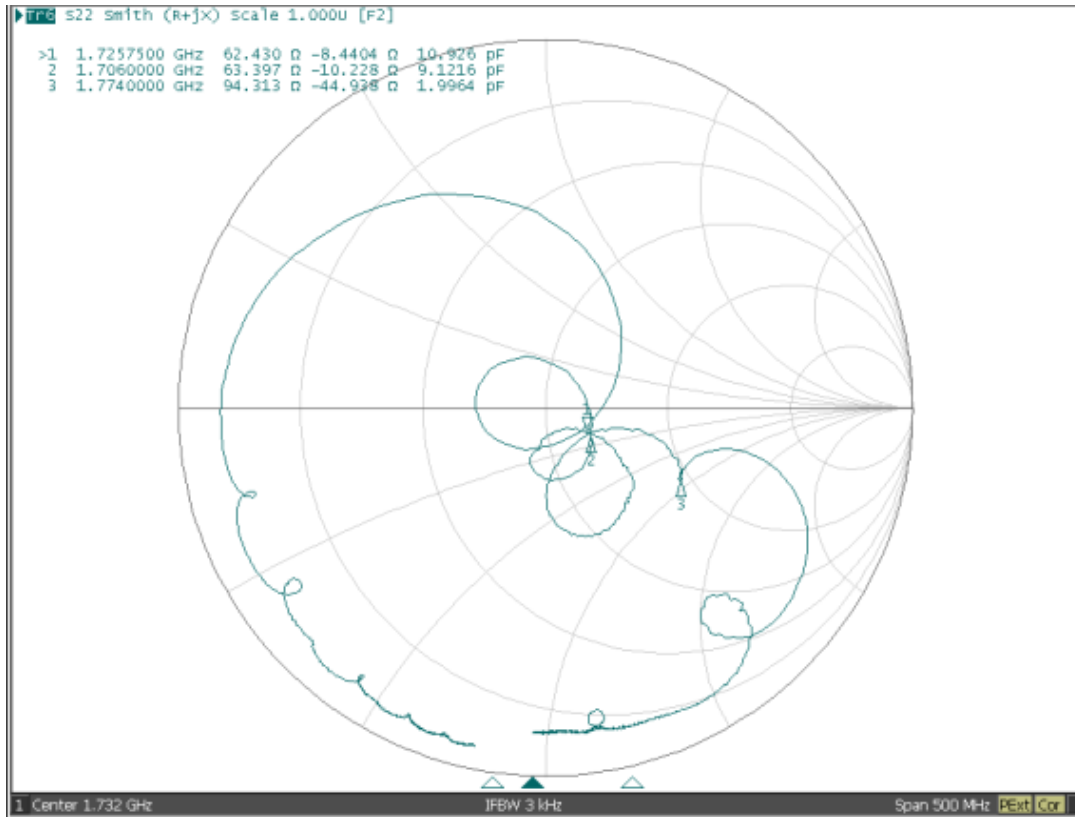

F. PCB FOOTPRINT:

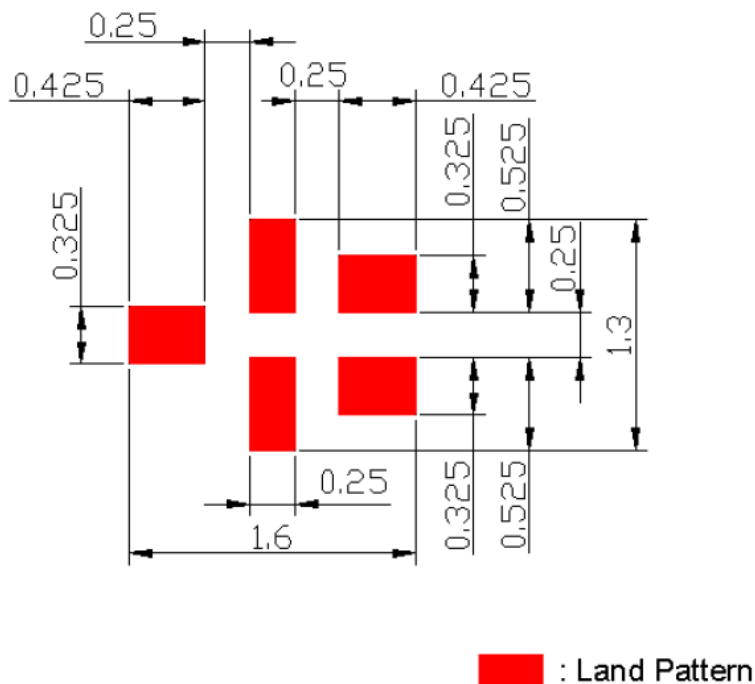

SAW Filter: 1740.0MHz
Part No: MP10582

Model: TA2630A
Rev No: 1

G. PACKING:

1. Reel Dimensions

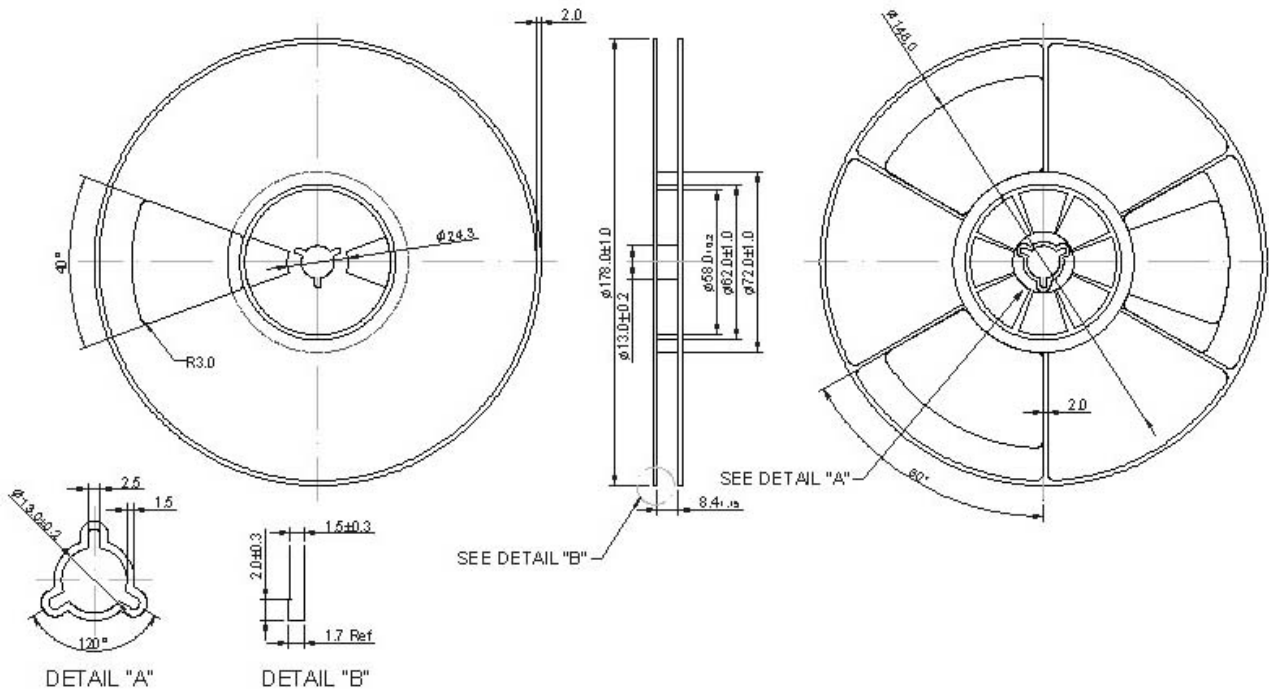

2. Tape Dimensions

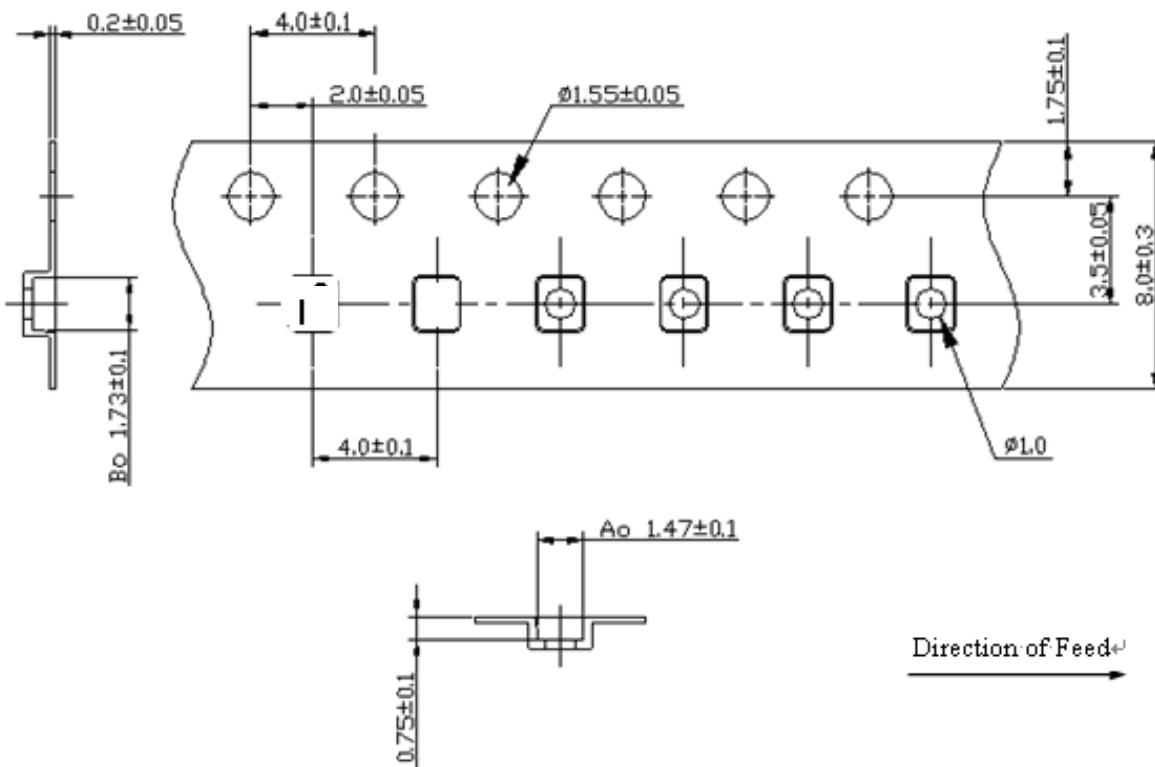

SAW Filter: 1740.0MHz
Part No: MP10582

Model: TA2630A
Rev No: 1

H. RECOMMENDED REFLOW PROFILE:

1. Preheating shall be fixed at 150 ~ 180°C for 60 ~ 90 seconds.
2. Ascending time to preheating temperature 150°C shall be 30 seconds min.
3. Heating shall be fixed at 220°C for 50 ~ 80 seconds and at 260°C +0/-5°C peak (20 ~ 40 sec).
4. Time: 2 times.

