

SAW Filter 1587.50MHz

Model: TA1901A

Part No: MP09856

Rev No: 1

A. MAXIMUM RATING:

Electrostatic Sensitive Device (ESD)

1. Input Power Level: 20dBm
2. DC Voltage: 5V
3. Operating Temperature: -40°C to +105°C
4. Storage Temperature: -40°C to +105°C
5. Moisture Sensitive Level (MSL): Level 1

B. ELECTRICAL CHARACTERISTICS:

Terminating source/load impedance (single): $Z_S = 50\Omega/Z_L = 50\Omega$

Item	Unit	Min	Typ	Max
Center Frequency Fc	MHz	-	1587.5	-
Insertion Loss (1559 ~ 1616MHz) IL	dB		2.0	2.5
VSWR (1559 ~ 1616MHz)			2.0	2.5
Amplitude ripple (1559 ~ 1616MHz)	dB		1.0	1.8
Group Delay Ripple (1598 ~ 1606MHz)	nS		2	6
Attenuation				
10 ~ 1300MHz	dB	40	45	
1300 ~ 1490MHz	dB	30	35	
1490 ~ 1525MHz	dB	23	28	
1650 ~ 1660MHz	dB	30	35	
1660 ~ 1840MHz	dB	35	40	
1840 ~ 2000MHz	dB	35	40	
2000 ~ 2500MHz	dB	30	35	
Package size	mm	2016		

C. TEST CIRCUIT:

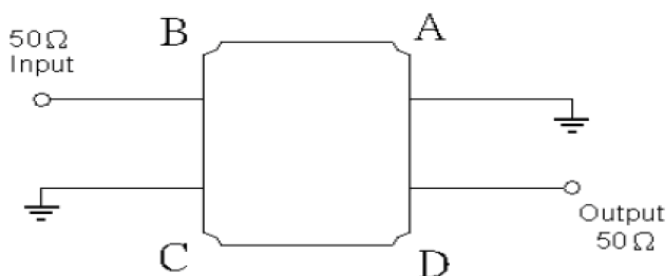

SAW Filter 1587.50MHz
Part No: MP09856

Model: TA1901A
Rev No: 1

D. FREQUENCY CHARACTERISTICS:

1. S21 response: (span 500MHz)

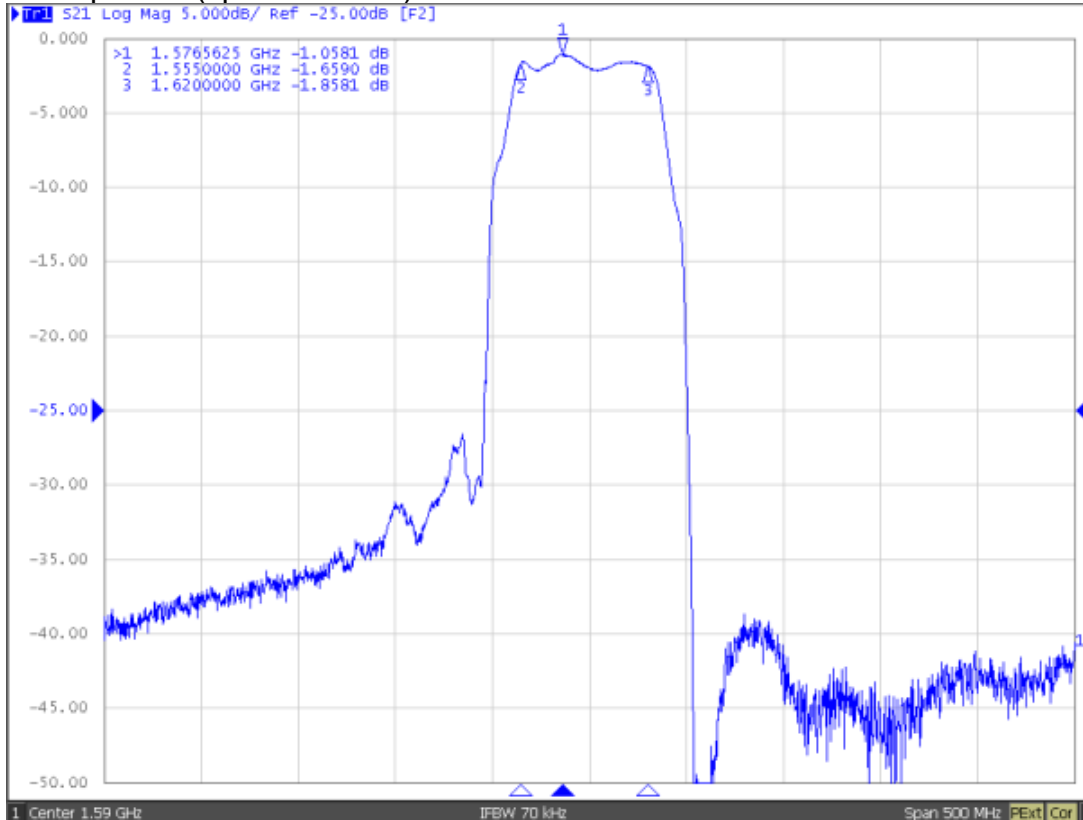

2. S21 response: (span 100MHz)

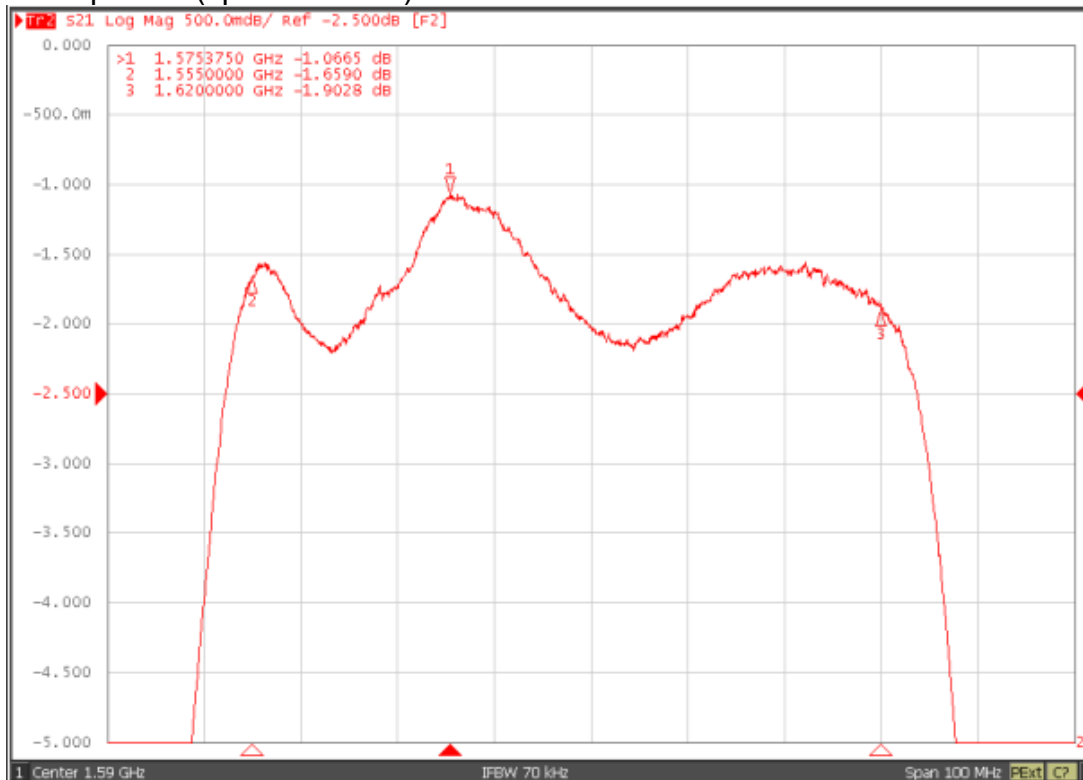

SAW Filter 1587.50MHz
Part No: MP09856

Model: TA1901A
Rev No: 1

3. S11/S22 response

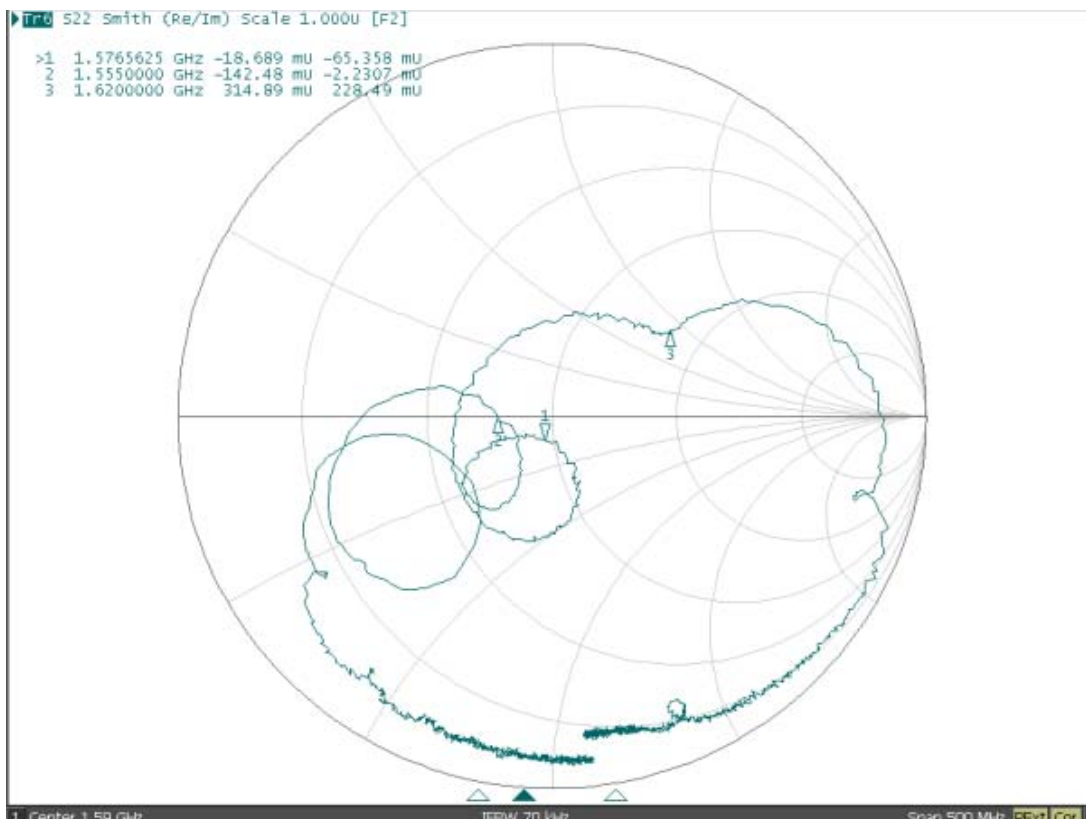
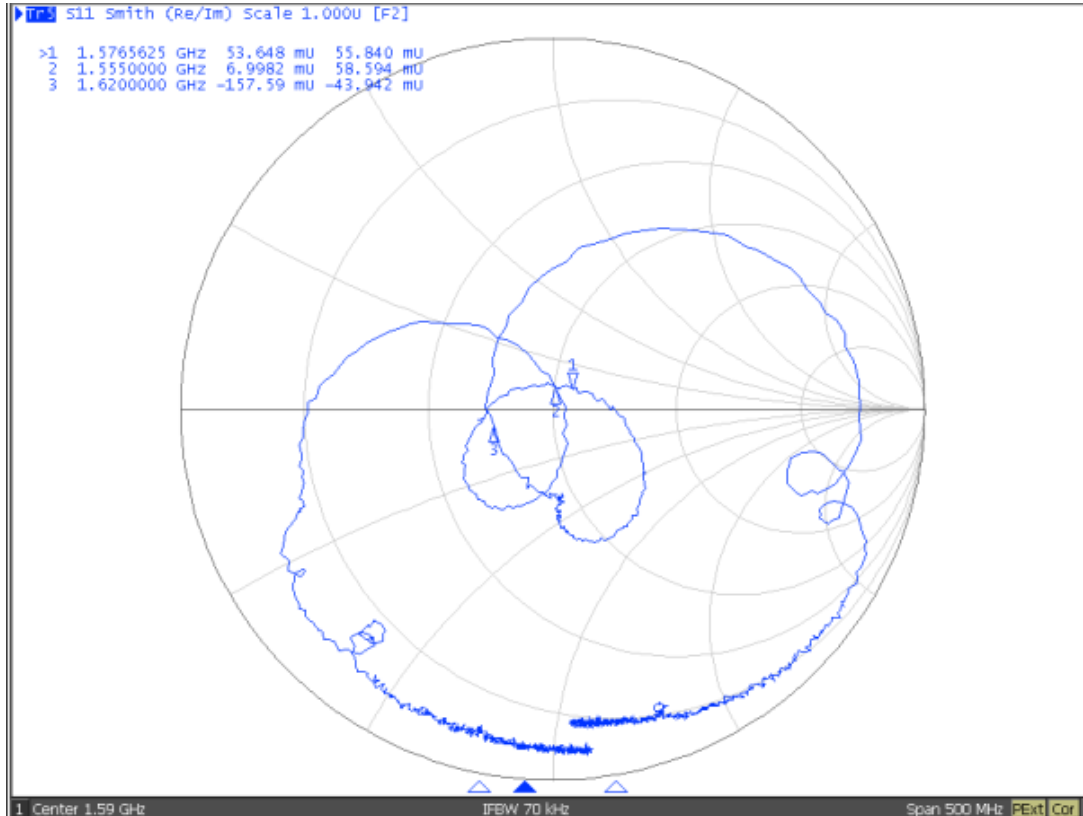

SAW Filter 1587.50MHz
Part No: MP09856

Model: TA1901A
Rev No: 1

4. S21 response: (span 3GHz)

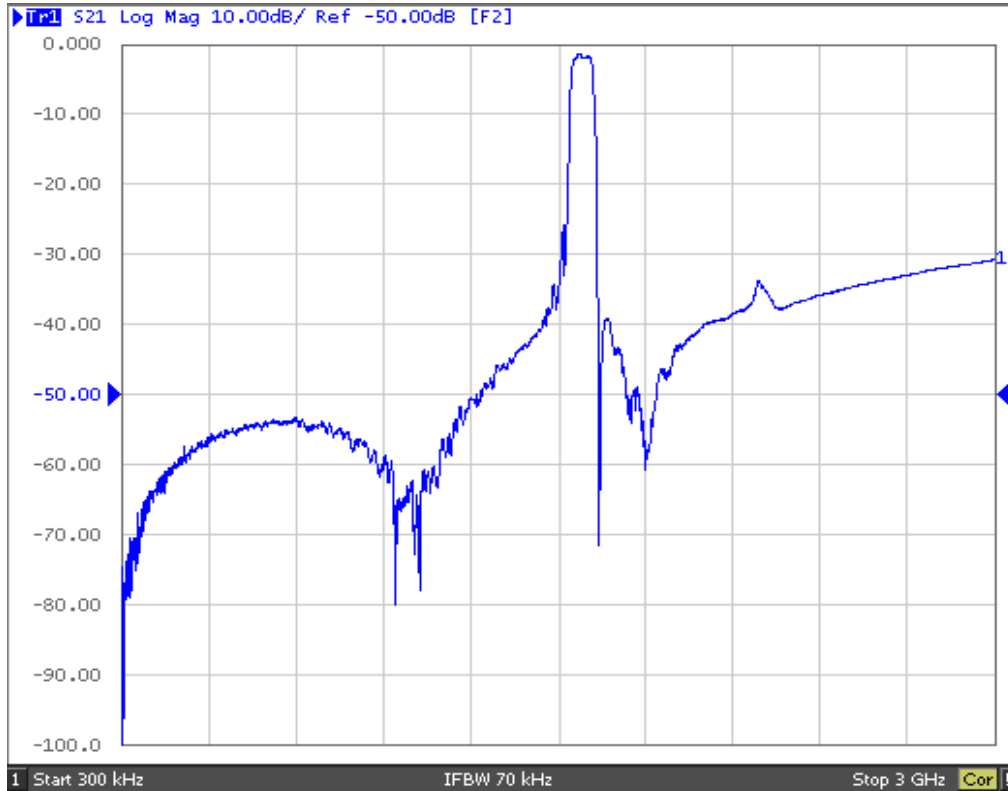

E. OUTLINE DRAWING:

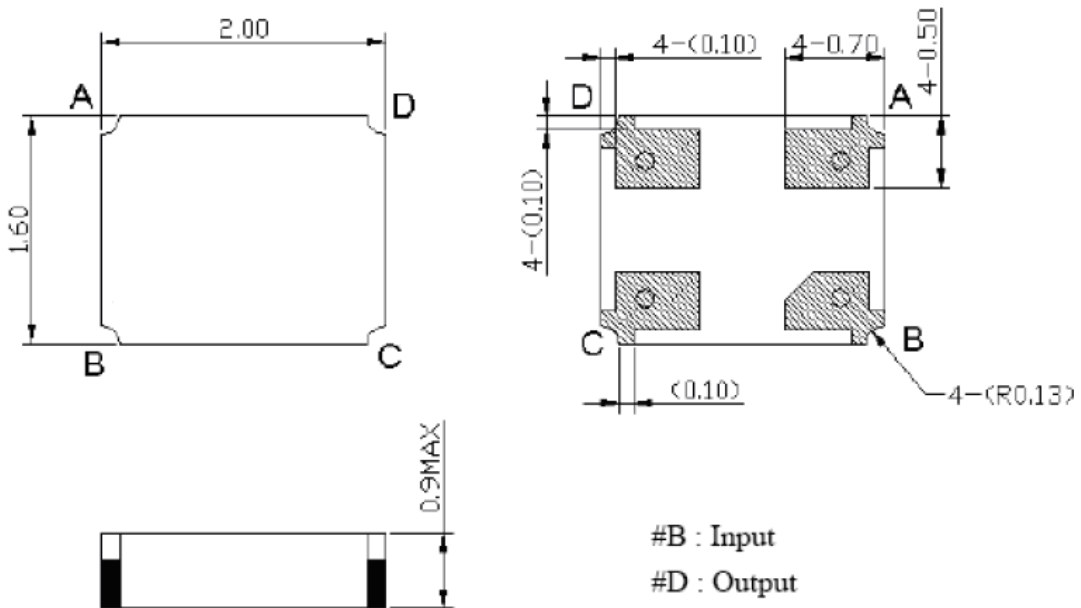

#B : Input
 #D : Output
 #A,C : Ground
 Unit : mm

F. PACKING:

1. Reel Dimension

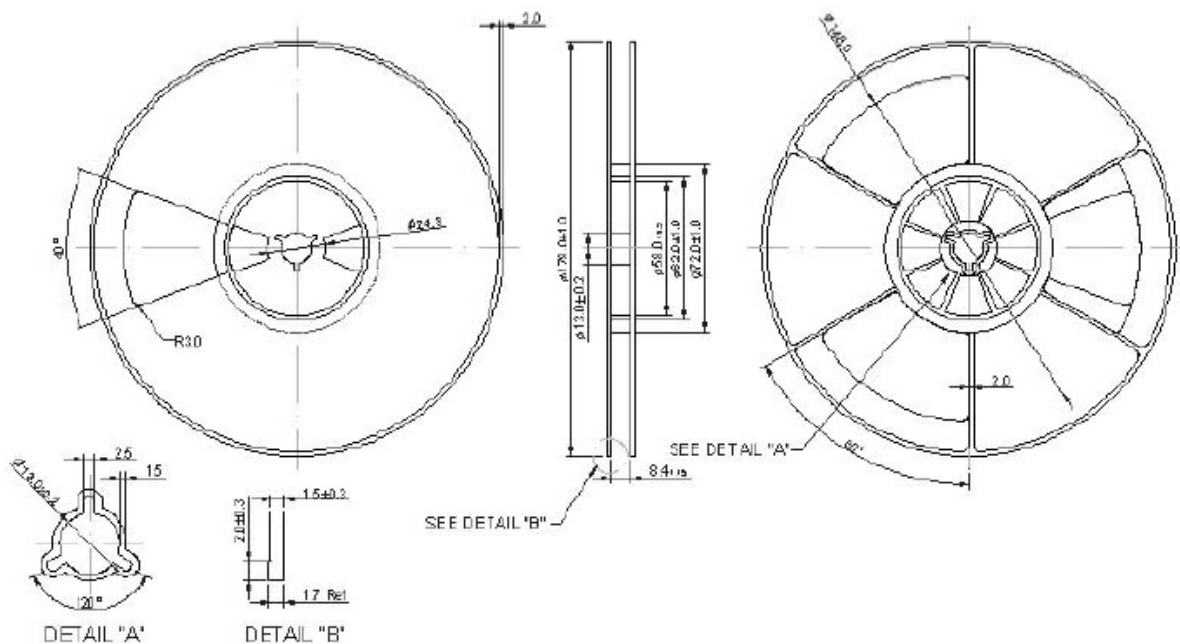

2. Tape Dimension

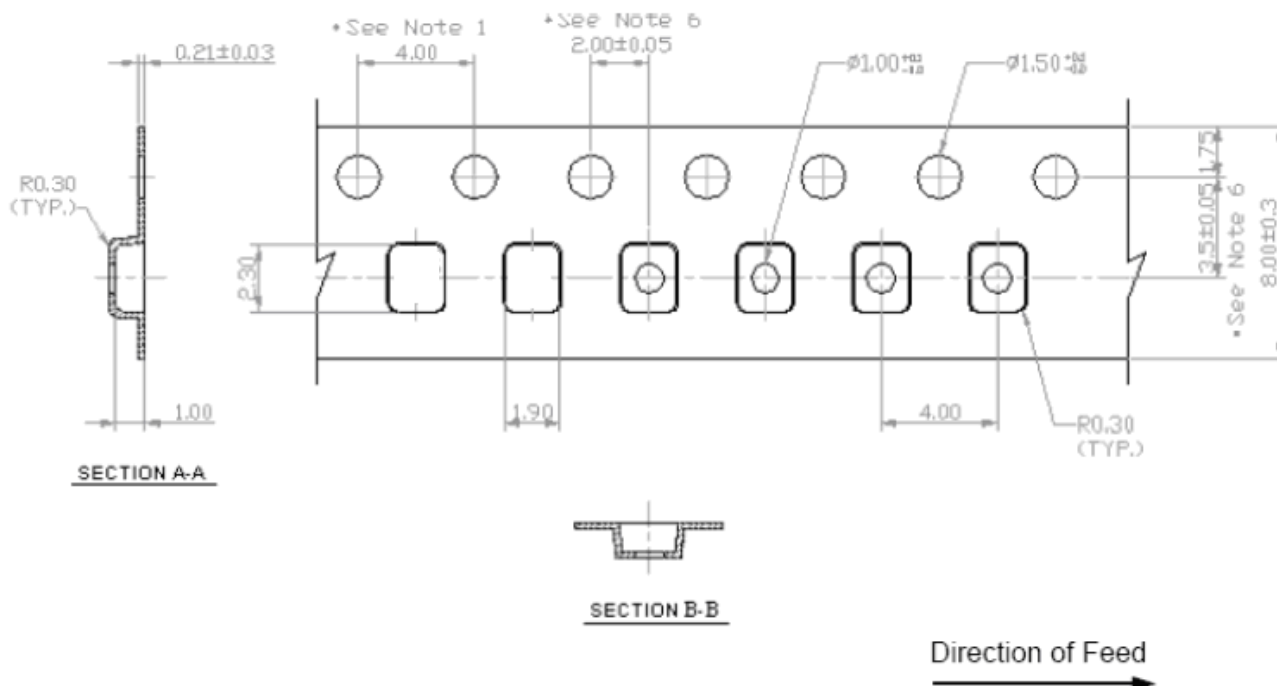

SAW Filter 1587.50MHz
Part No: MP09856

Model: TA1901A
Rev No: 1

G. RECOMMENDED REFLOW PROFILE:

1. Preheating shall be fixed at 150 ~ 180°C for 60 ~ 90 seconds.
2. Ascending time to preheating temperature 150°C shall be 30 seconds min.
3. Heating shall be fixed at 220°C for 50 ~ 80 seconds and at 260°C +0/-5°C peak (20 ~ 40 sec).
4. Time: 2 times.

