

**SAW Filter 1176.50MHz**

**Model: TA2471B**

**Part No: MP09910 AEC-Q200 compliant**

**Rev No: 1**

**A. MAXIMUM RATING:**

Electrostatic Sensitive Device (ESD)

1. Input Power Level: 13dBm (2000h)
2. DC Voltage: 3V
3. Operating Temperature: -20°C to +85°C
4. Storage Temperature: -40°C to +85°C
5. ESD Machine Mode: 50V
6. ESD Human Body Mode: 100V
7. Moisture Sensitive Level (MSL): Level 2a

**B. ELECTRICAL CHARACTERISTICS:**

1. Temperature range for specification:  $T_{spec} = -20^{\circ}\text{C}$  to  $+85^{\circ}\text{C}$
2. Terminating source impedance:  $Z_S = 50\Omega$
3. Terminating load impedance:  $Z_L = 50\Omega$

Item	Unit	Min.	Typ.	Max.
Center Frequency $F_c$	MHz	-	1176.5	-
Insertion Loss (1164 ~ 1189MHz) IL	dB	-	1.8	2.4
Amplitude Ripple (1164 ~ 1189MHz)	dBp-p	-	0.5	1.3
VSWR (1164 ~ 1189MHz)		-	1.8	2.1
Group Delay Deviation (1164 ~ 1189MHz)	ns	-	7	13
Attenuation (refer to 0dB)				
100 ~ 814MHz	dB	53	63	-
814 ~ 849MHz	dB	53	62	-
849 ~ 980MHz	dB	51	57	-
980 ~ 1010MHz	dB	51	56	-
1010 ~ 1100MHz	dB	50	54	-
1100 ~ 1130MHz	dB	40	46	-
1250 ~ 1427MHz	dB	25	50	-
1427 ~ 1463MHz	dB	45	50	-
1710 ~ 2025MHz	dB	40	45	-
2300 ~ 2690MHz	dB	38	42	-
2690 ~ 3000MHz	dB	37	42	-
3000 ~ 6000MHz	dB	17	22	-
Temperature Coefficient	ppm/K	-	-36	-

**SAW Filter 1176.50MHz**

**Model: TA2471B**

**Part No: MP09910 AEC-Q200 compliant**

**Rev No: 1**

**C. OUTLINE DRAWING:**

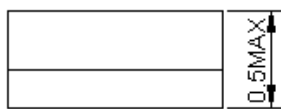
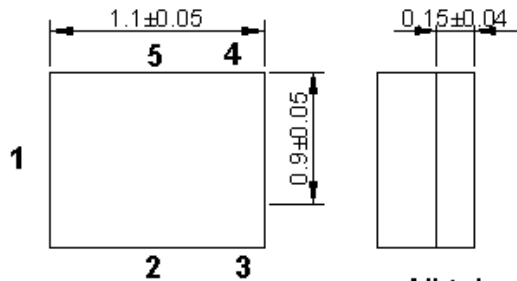

All tolerances are +/-0.05 mm unless otherwise specified  
 Coplanarity : 0.1 mm max.  
 1 to 5 : Pin No.  
 Unit : mm

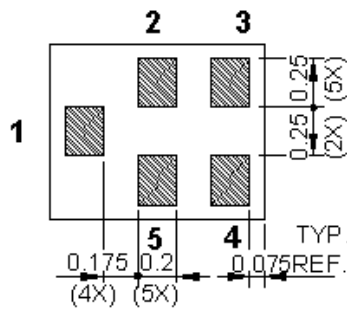

- 1: Input
- 4: Output
- 2, 3, 5: Ground

**D. MEASUREMENT CIRCUIT:**

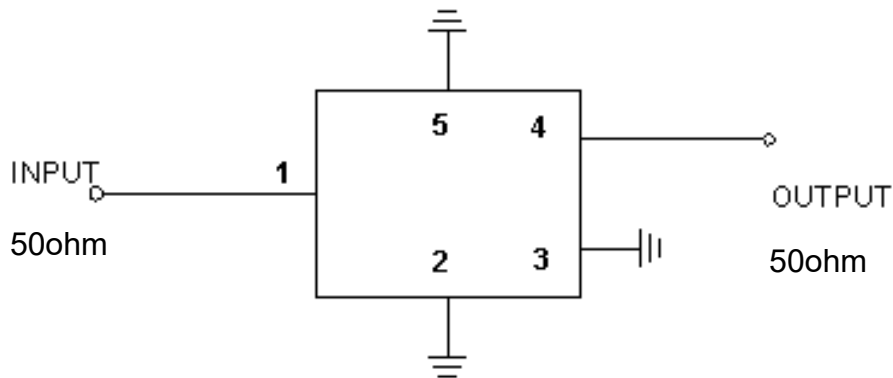

**E. PCB FOOTPRINT:**

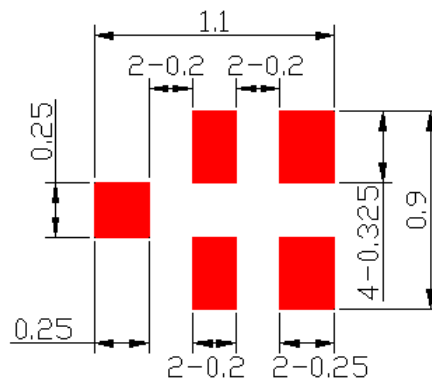

**SAW Filter 1176.50MHz**  
**Part No: MP09910 AEC-Q200 compliant**

**Model: TA2471B**  
**Rev No: 1**

**F. FREQUENCY CHARACTERISTICS:**

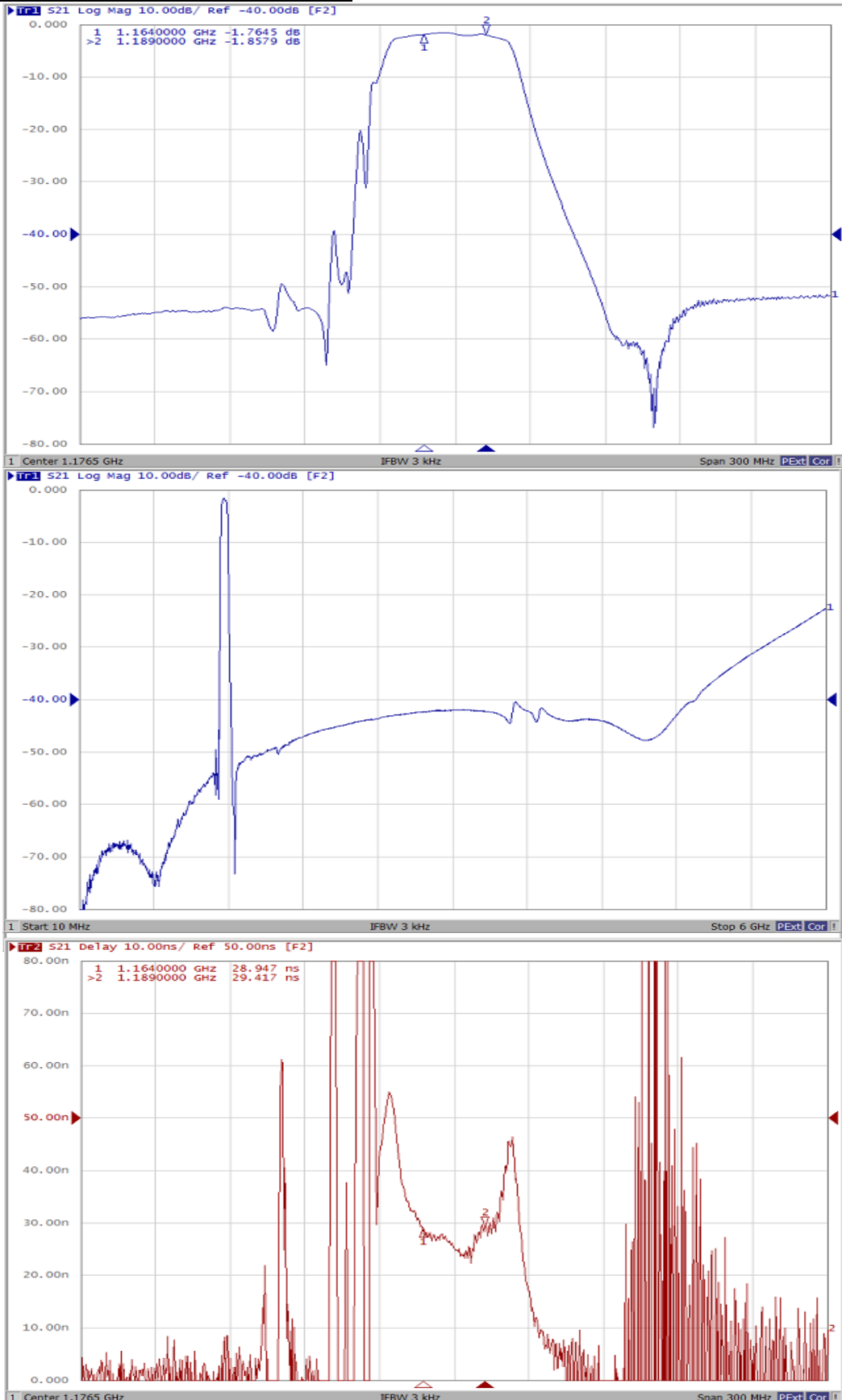

**SAW Filter 1176.50MHz**  
**Part No: MP09910 AEC-Q200 compliant**

**Model: TA2471B**  
**Rev No: 1**

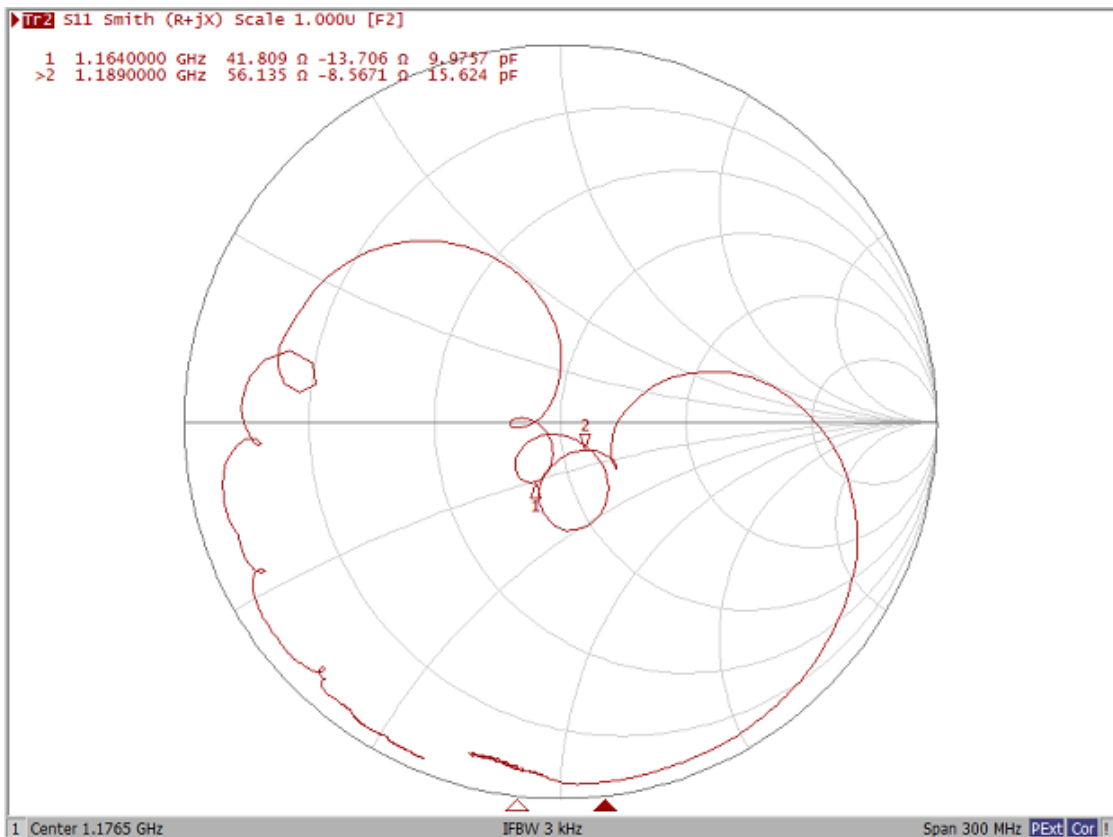
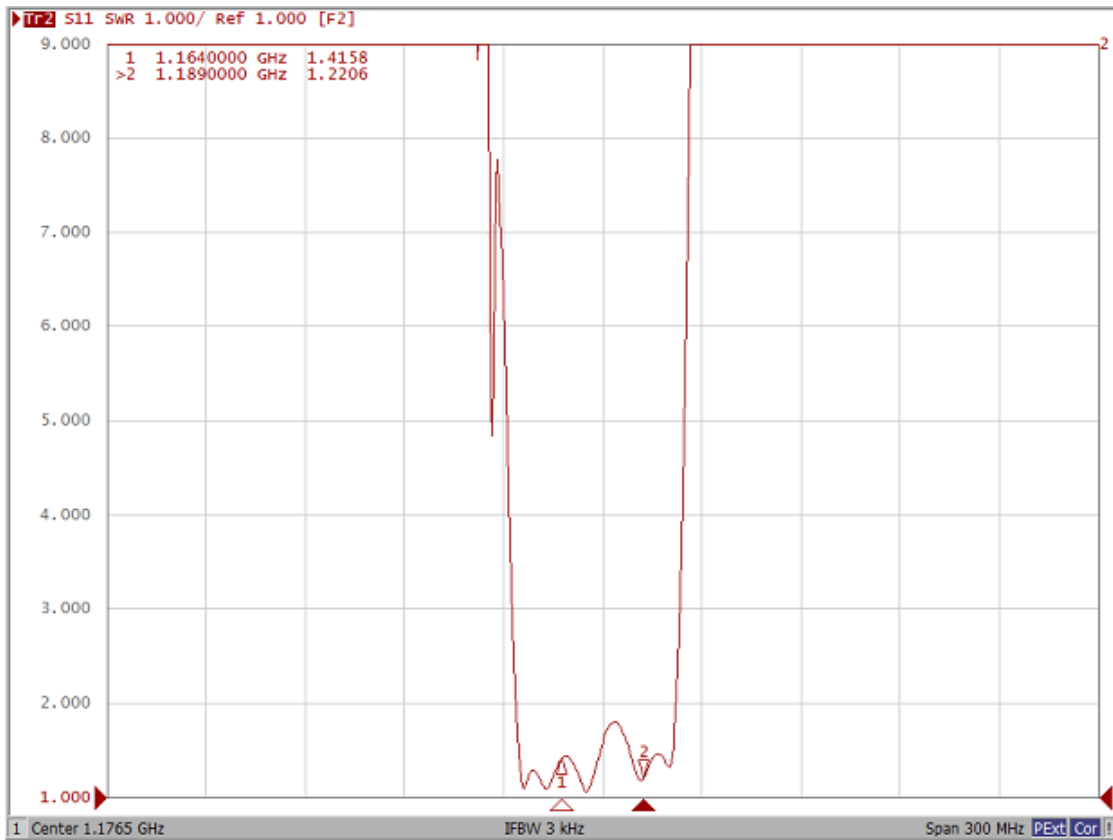

**SAW Filter 1176.50MHz**  
**Part No: MP09910 AEC-Q200 compliant**

**Model: TA2471B**  
**Rev No: 1**

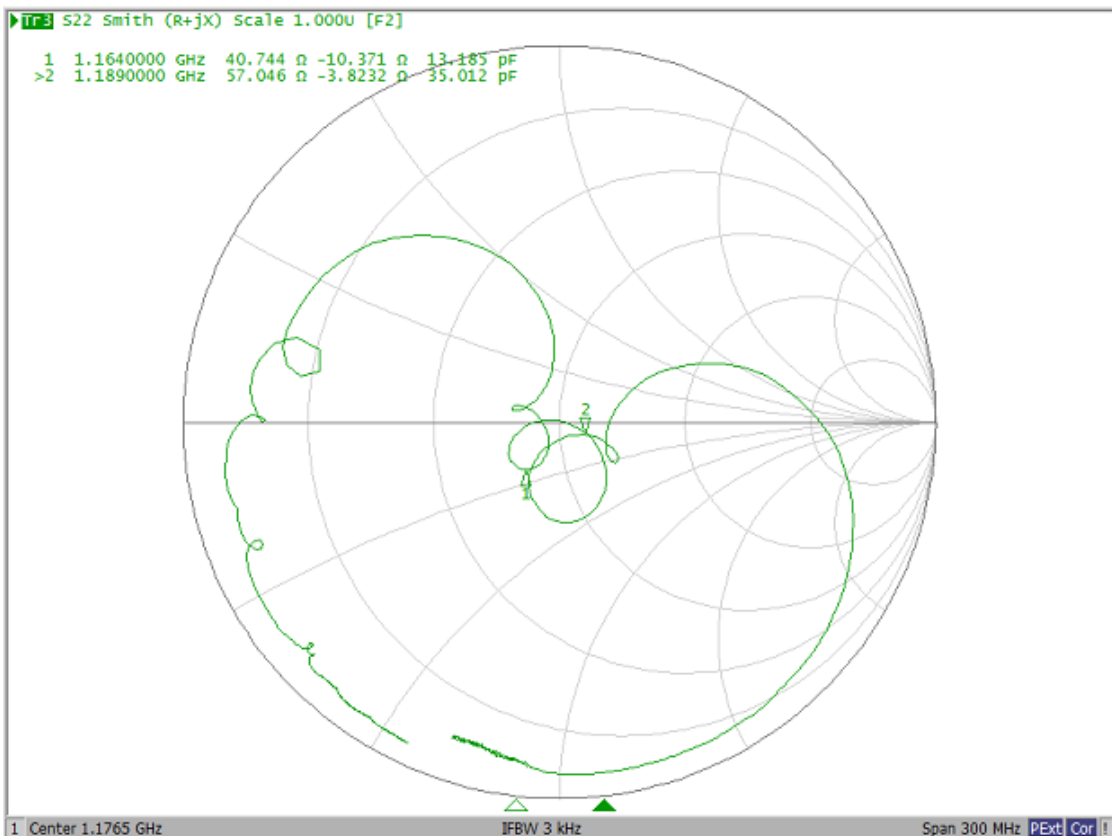
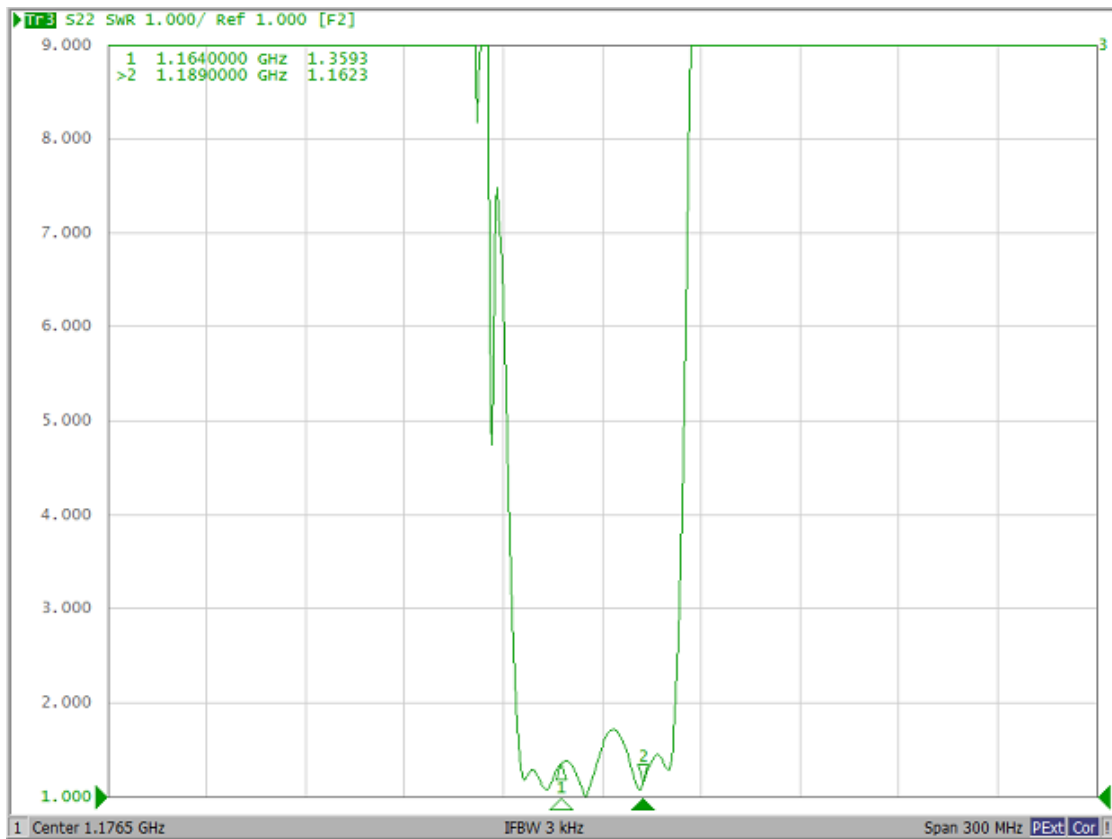

**SAW Filter 1176.50MHz**  
**Part No: MP09910 AEC-Q200 compliant**

**Model: TA2471B**  
**Rev No: 1**

**G. PACKING:**

1. Reel Dimensions

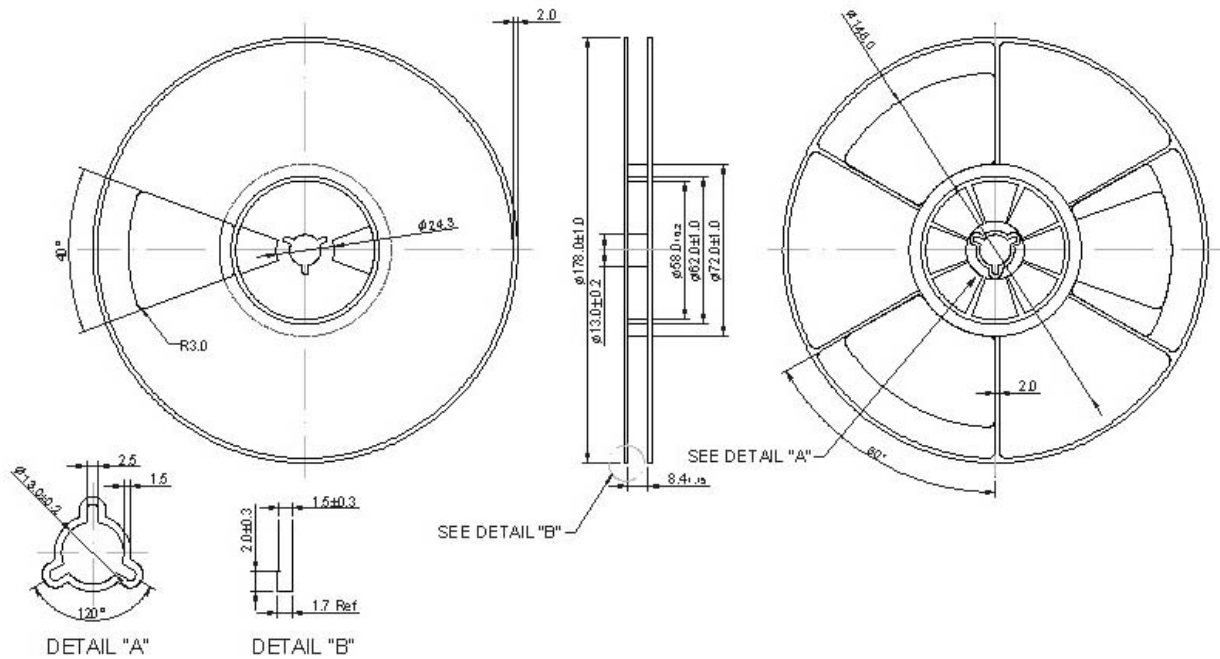

2. Tape Dimensions

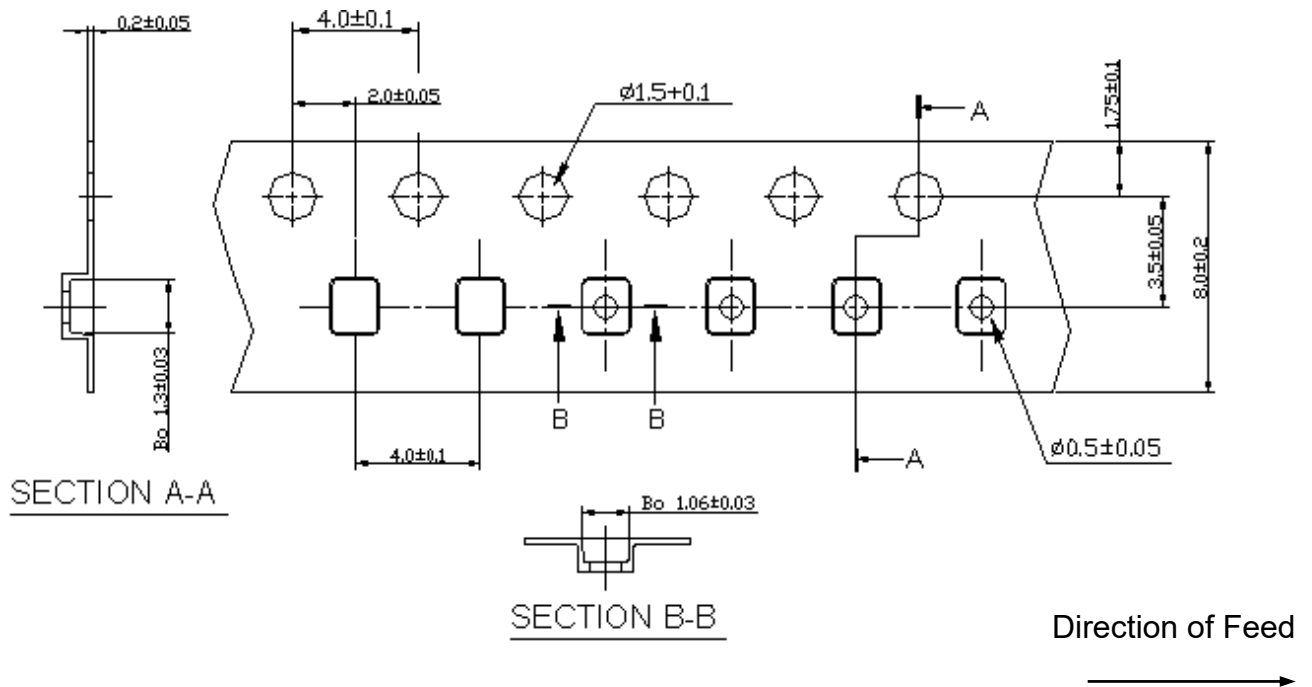

**SAW Filter 1176.50MHz**

**Model: TA2471B**

**Part No: MP09910 AEC-Q200 compliant**

**Rev No: 1**

**H. RECOMMENDED REFLOW PROFILE:**

1. Preheating shall be fixed at 150 ~ 180°C for 60 ~ 90 seconds.
2. Ascending time to preheating temperature 150°C shall be 30 seconds min.
3. Heating shall be fixed at 220°C for 50 ~ 80 seconds and at 245 ~ 260°C peak (min. 10sec).
4. Time: 2 times.

