

**SAW Filter 925.80MHz**  
**Part No: MP09911**

**Model: TA2435A**  
**Rev No: 1**

**A. MAXIMUM RATING:**

Electrostatic Sensitive Device (ESD)

1. Input Power Level: 20dBm
2. DC voltage: 3 V
3. Operating Temperature: -40°C to +85°C
4. Storage Temperature: -40°C to +85°C
5. Moisture Sensitivity Level: Level 1 (MSL1)

**B. ELECTRICAL CHARACTERISTICS:**

Item	Unit	Min.	Typ.	Max.
Center frequency	MHz	-	925.8	-
Insertion loss (923.5 ~ 928.1MHz)	dB	-	2.2	2.8
Amplitude ripple (923.5 ~ 928.1MHz)	dB	-	0.3	1.3
VSWR (923.5 ~ 928.1MHz)	-	-	1.4	2.0
Attenuation (Reference level from 0dB)				
10 ~ 815	dB	40	43	-
815 ~ 830	dB	40	43	-
830 ~ 875	dB	40	42	-
875 ~ 905	dB	27	42	-
905 ~ 915	dB	12	25	-
945 ~ 950	dB	35	60	-
950 ~1150	dB	50	54	-
1150 ~ 1856	dB	32	42	-
1856 ~ 2500	dB	26	37	-
Temperature Coefficient of Frequency	ppm/k	-	-36	-

**SAW Filter 925.80MHz**  
**Part No: MP09911**

**Model: TA2435A**  
**Rev No: 1**

**C. MEASUREMENT CIRCUIT:**

HP Network analyzer

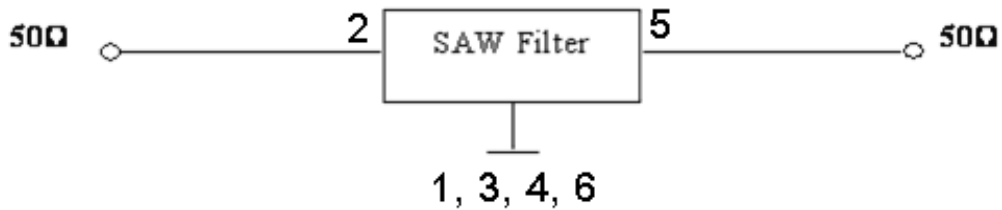

**D. OUTLINE DRAWING:**

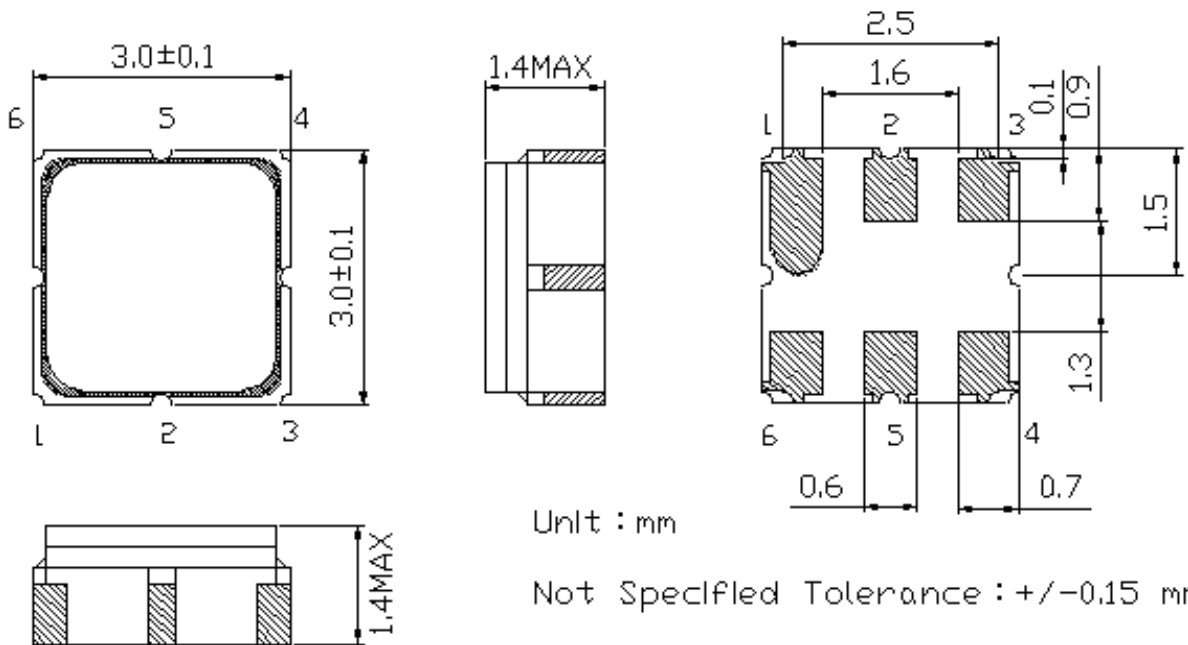

**E. PCB FOOTPRINT:**

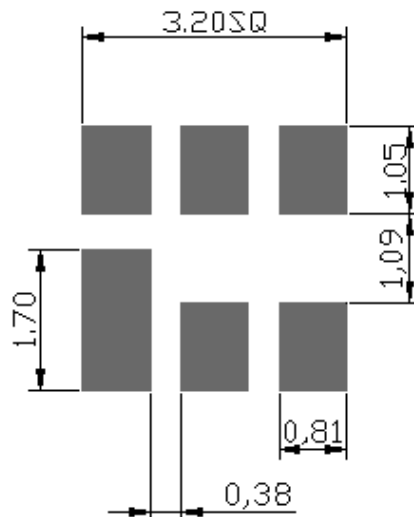

**SAW Filter 925.80MHz**  
**Part No: MP09911**

**Model: TA2435A**  
**Rev No: 1**

**F. FREQUENCY CHARACTERISTICS:**

1. Span 200MHz

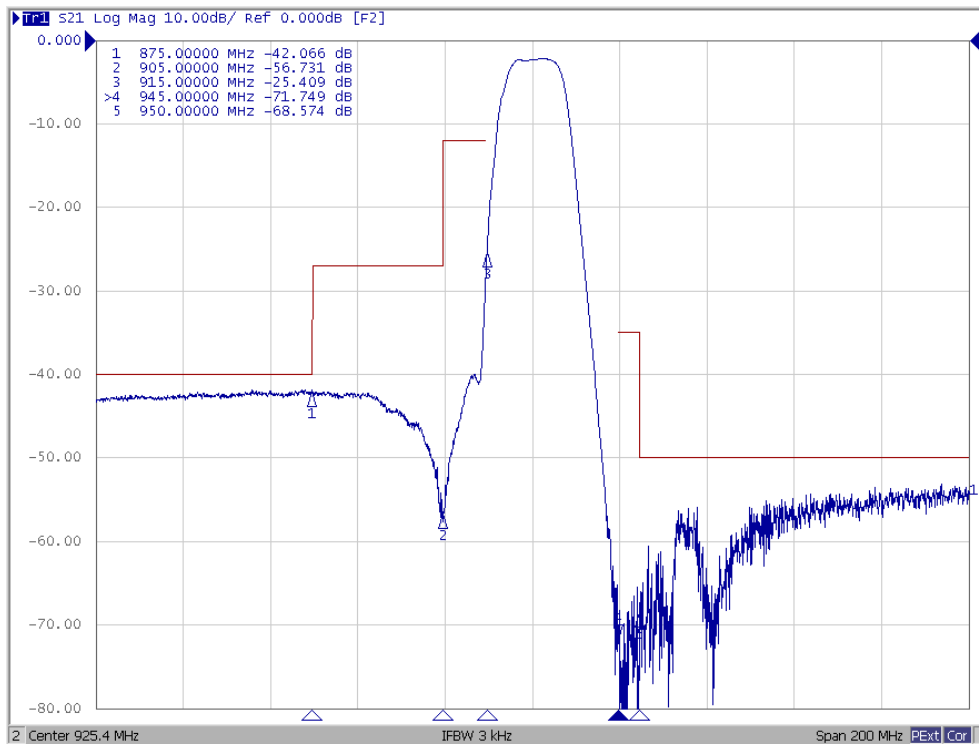

2. Span 3000MHz

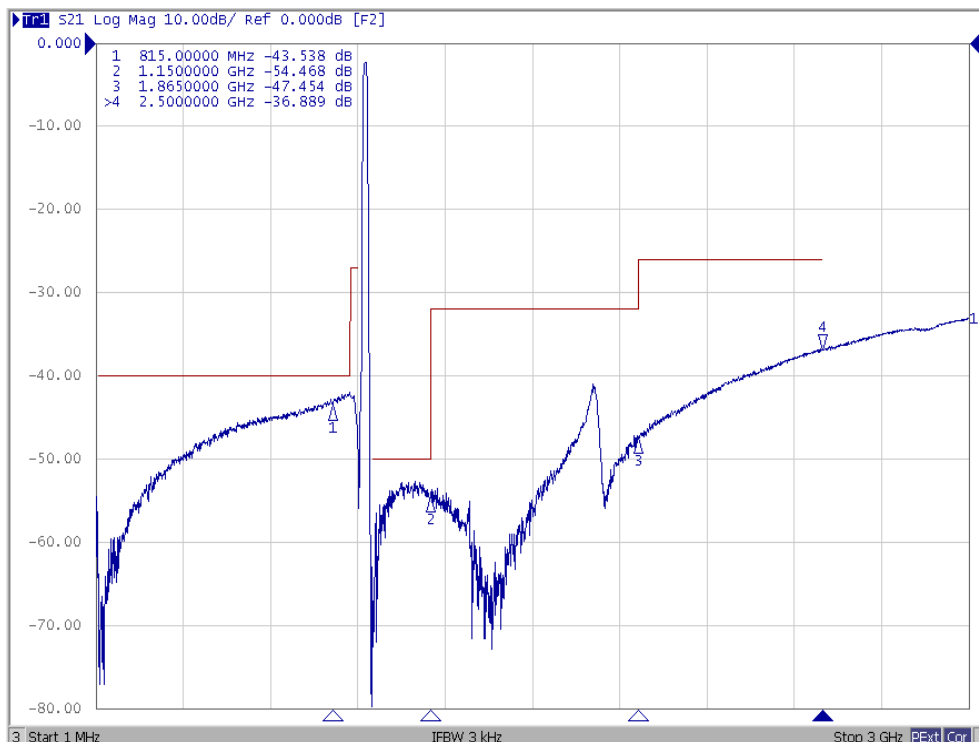

**SAW Filter 925.80MHz**  
**Part No: MP09911**

**Model: TA2435A**  
**Rev No: 1**

3. Span 40 MHz

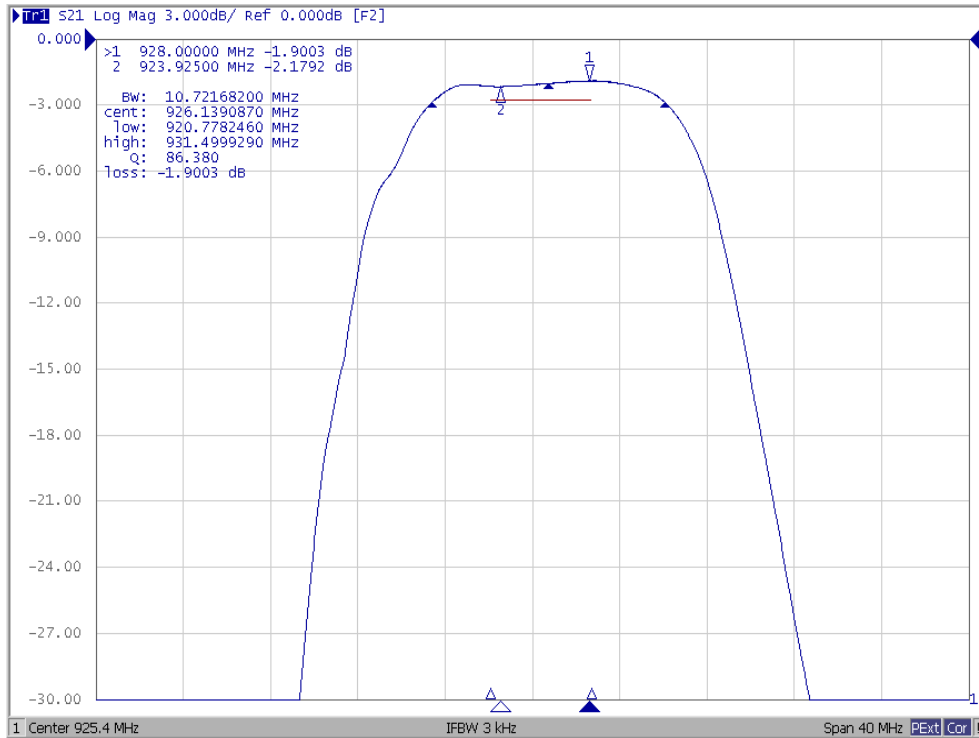

4. Reflective function

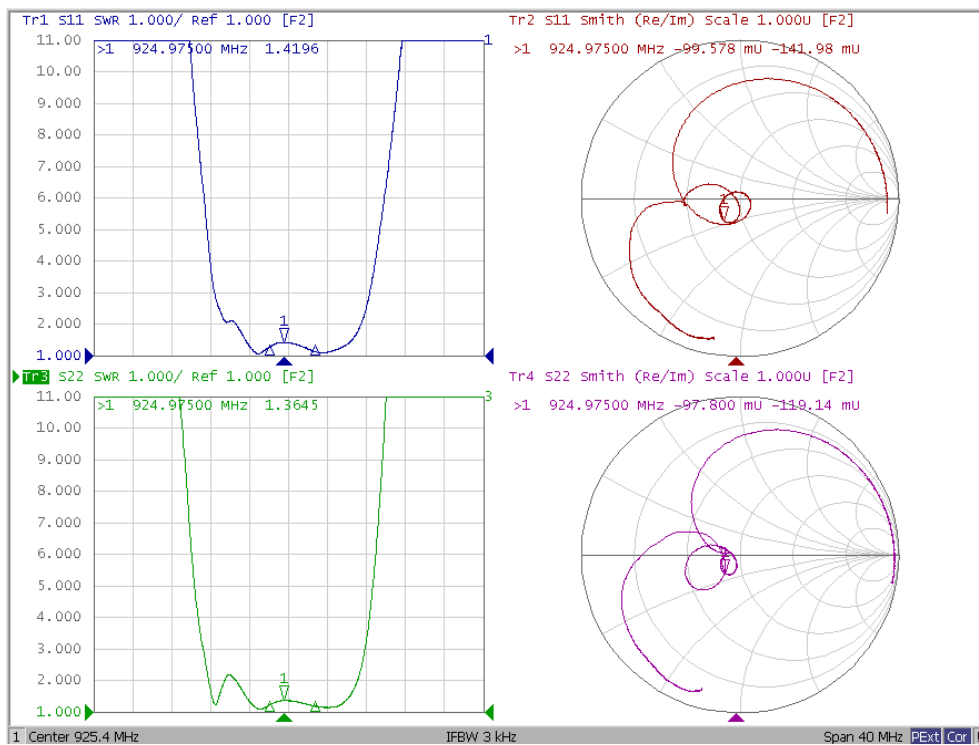

**SAW Filter 925.80MHz**  
**Part No: MP09911**

**Model: TA2435A**  
**Rev No: 1**

**G. PACKING:**

1. Reel Dimension

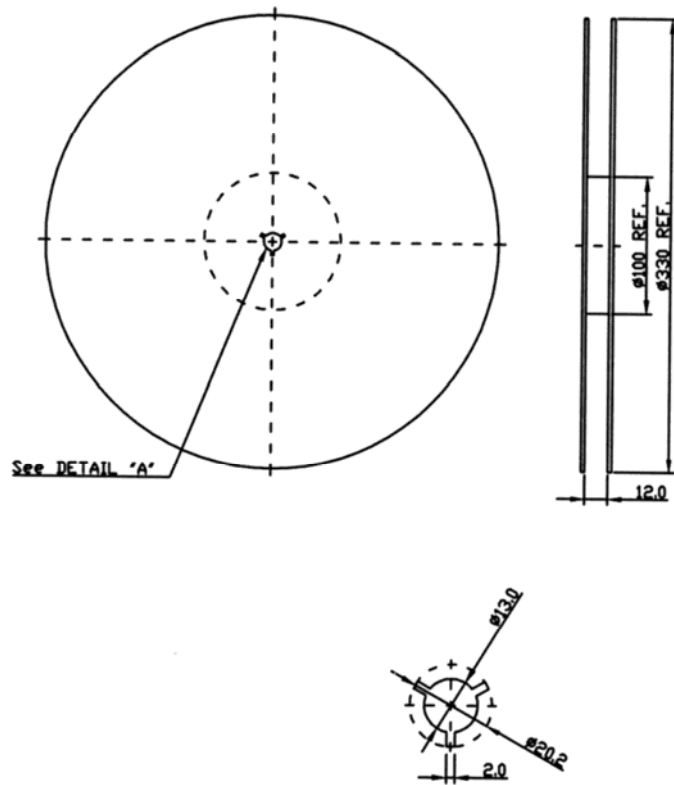

2. Tape Dimension

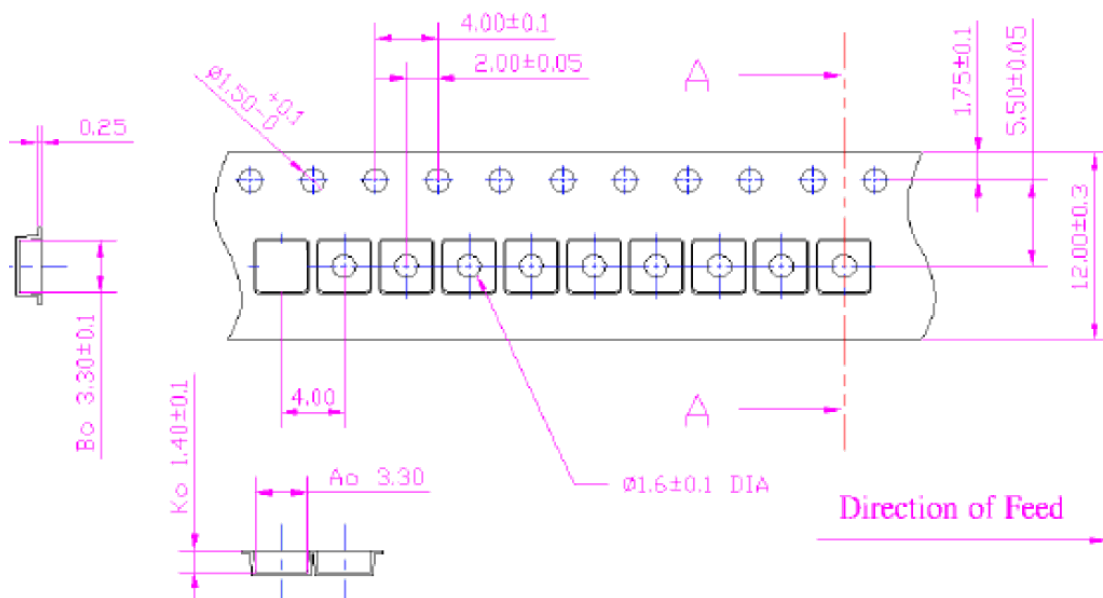

**SAW Filter 925.80MHz**  
**Part No: MP09911**

**Model: TA2435A**  
**Rev No: 1**

**H. RECOMMENDED REFLOW PROFILE:**

1. Preheating shall be fixed at 150 ~ 180°C for 60 ~ 90 seconds.
2. Ascending time to preheating temperature 150°C shall be 30 seconds min.
3. Heating shall be fixed at 220°C for 50 ~ 80 seconds and at 260°C +0/-5°C peak (20 ~ 40 sec).
4. Time: 2 times.

