

SAW Filter 1582.4690MHz

Model: TA1804A

Part No: MP06617

Rev No: 3

A. MAXIMUM RATING:

Electrostatic Sensitive Device (ESD)

1. Input Power Level: 10dBm
2. DC Voltage: 3V
3. Operating Temperature: -30°C to +85°C
4. Storage Temperature: -40°C to +85°C
5. Moisture Sensitivity Level: Level 1
6. Maximum ESD: ±50V (Human body model)

B. ELECTRICAL CHARACTERISTICS:

1. Terminating source impedance: $Z_S = 50\Omega$ (Single-ended)
2. Terminating load impedance: $Z_L = 50\Omega$ (Single-ended)

Parameters Description		Unit	Min.	Typ.	Max.
Center Frequency		MHz	-	1582.469	-
Insertion Loss	1574.42~1576.42MHz	dB (*1)	-	0.95	1.5
	1565.42~1585.42MHz	dB (*1)	-	1.5	2.0
	1597.552~1605.886MHz	dB (*1)	-	1.4	2.0
	1559.052~1563.144MHz	dB (*1)	-	1.7	2.0
VSWR(Input/Output)	1574.42~1576.42MHz	-	-	1.3	2.0
	1565.42~1585.42MHz	-	-	1.9	2.3
	1597.552~1605.886MHz	-	-	1.5	2.3
	1559.052~1563.144MHz	-	-	1.8	2.3
Attenuation (Reference level from 0dB)					
50~925MHz		dB	32	36	-
925~980MHz		dB	32	36	-
1427~1463MHz		dB	32	39	-
1710~1785MHz		dB	32	39	-
1850~1910MHz		dB	32	38	-
1920~1980MHz		dB	32	37	-
2401~2483MHz		dB	32	39	-
2500~2570MHz		dB	31	38	-
Temperature Coefficient of Frequency		ppm/°C	-36		

(*1) Specification of insertion loss excludes loss that comes from the test board.

SAW Filter 1582.4690MHz
Part No: MP06617

Model: TA1804A
Rev No: 3

C. FREQUENCY CHARACTERISTIC:

1. Frequency Response:

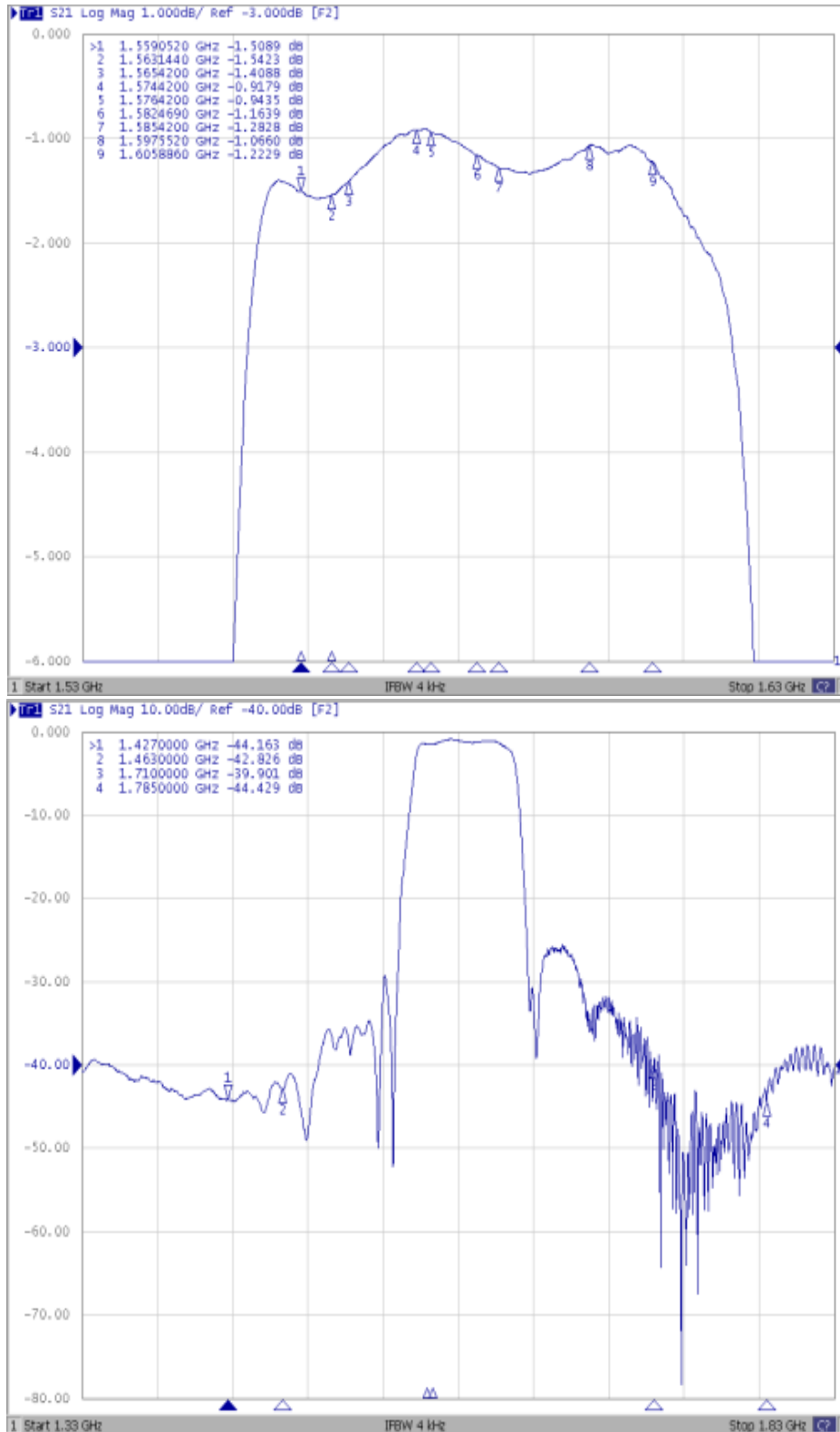

SAW Filter 1582.4690MHz
Part No: MP06617

Model: TA1804A
Rev No: 3

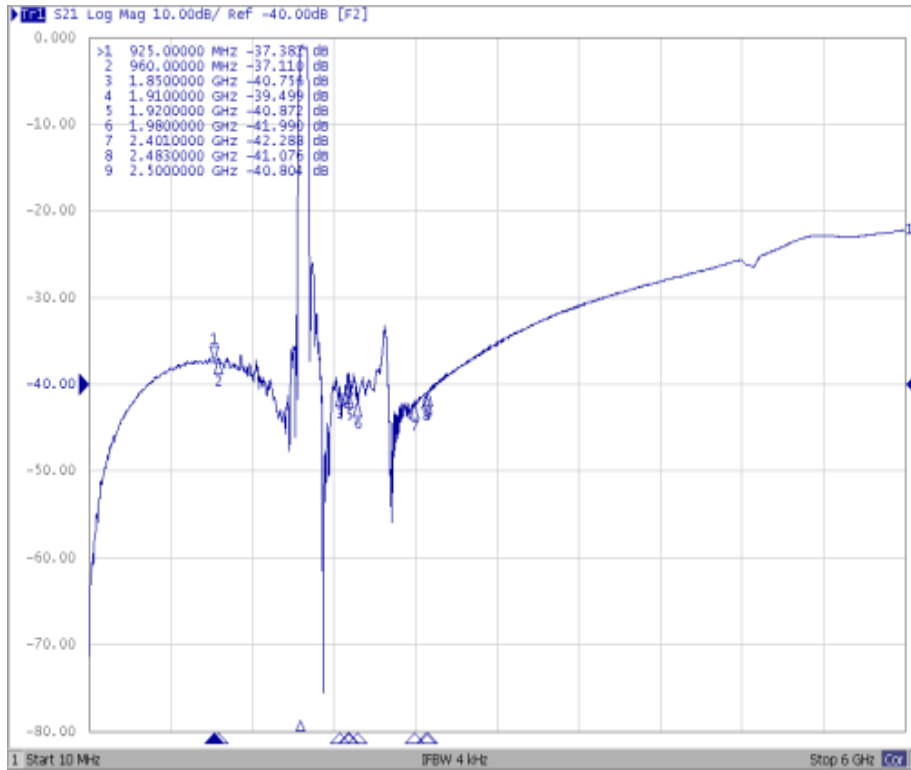

2. VSWR S11

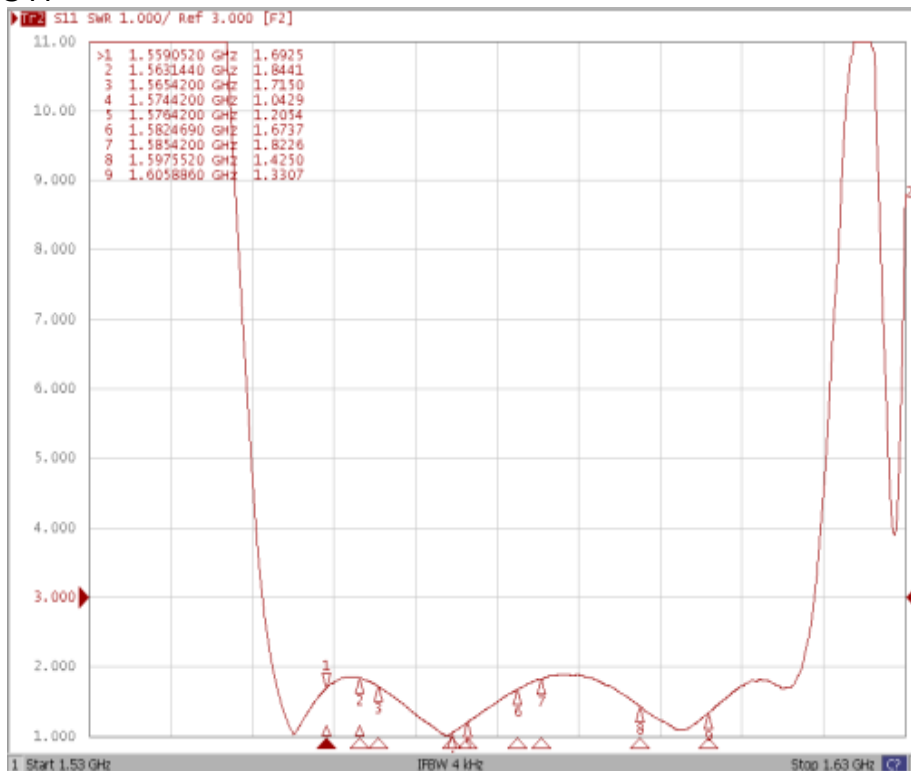

SAW Filter 1582.4690MHz
Part No: MP06617

Model: TA1804A
Rev No: 3

3. VSWR S22

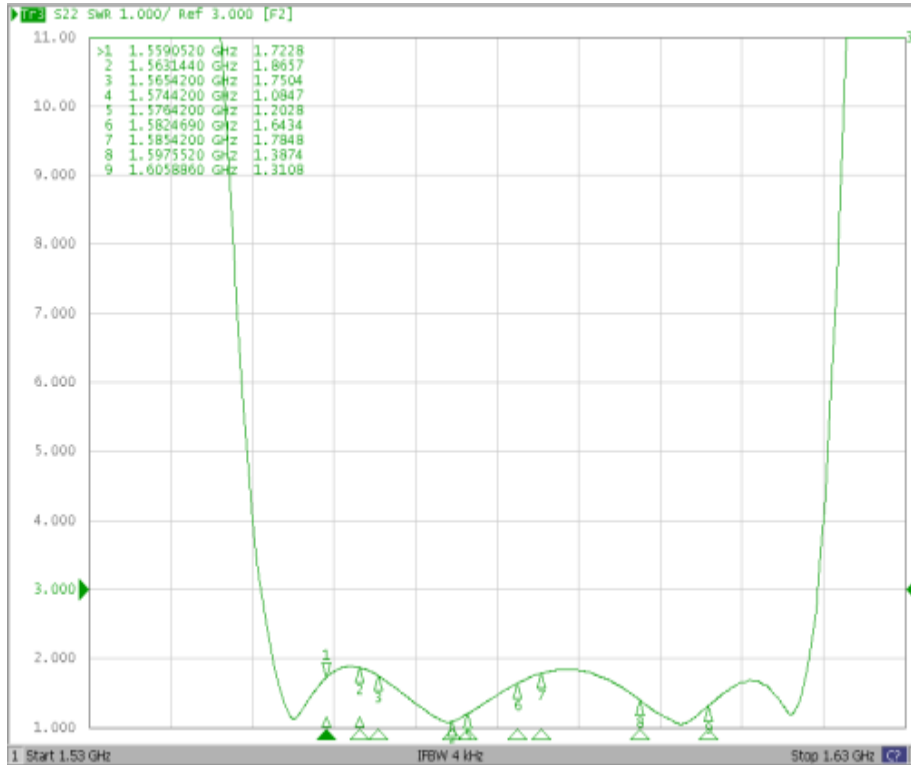

4. Smith Chart S11

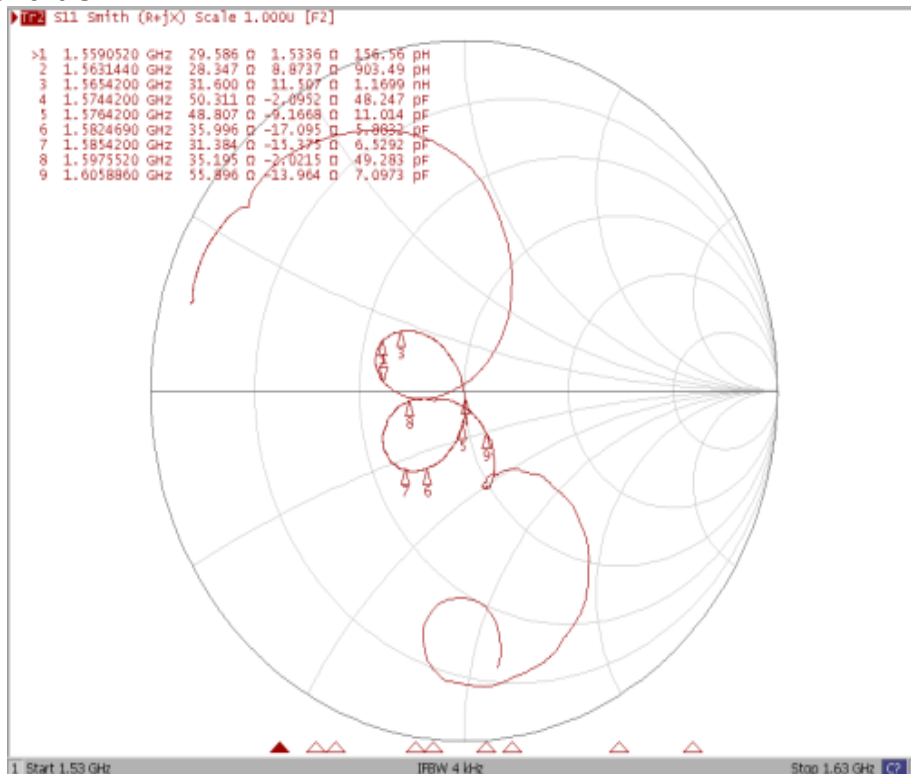

SAW Filter 1582.4690MHz
Part No: MP06617

Model: TA1804A
Rev No: 3

5. Smith Chart S22

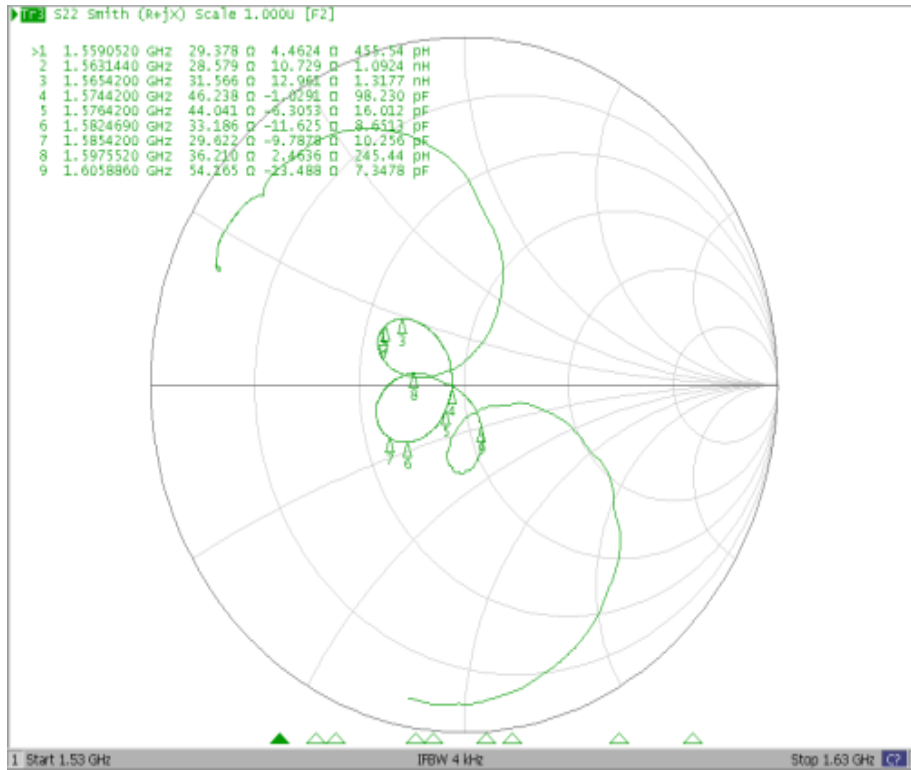

D. MEASUREMENT CIRCUIT:

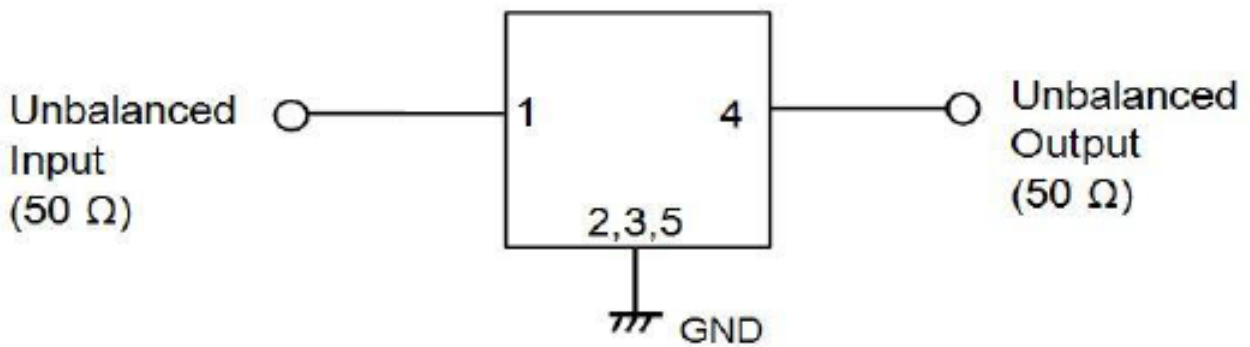

1 to 5: Pin No.

SAW Filter 1582.4690MHz
Part No: MP06617

Model: TA1804A
Rev No: 3

E. PCB FOOTPRINT:

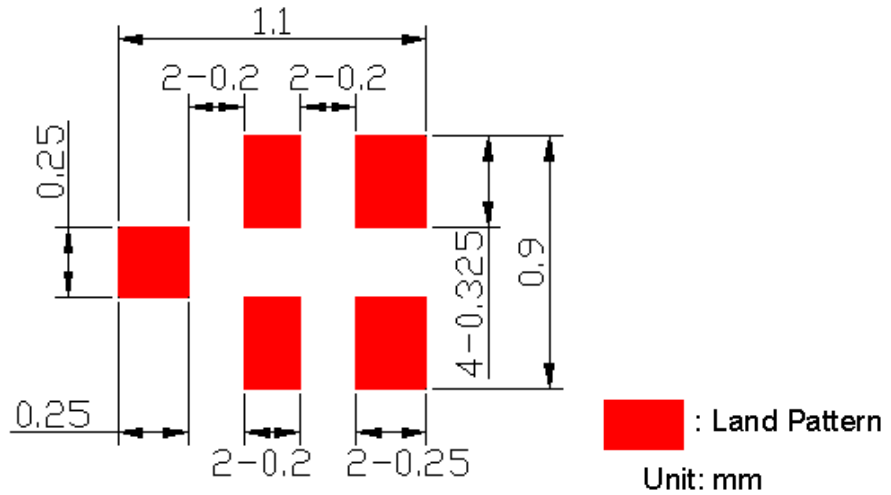

F. OUTLINE DRAWING:

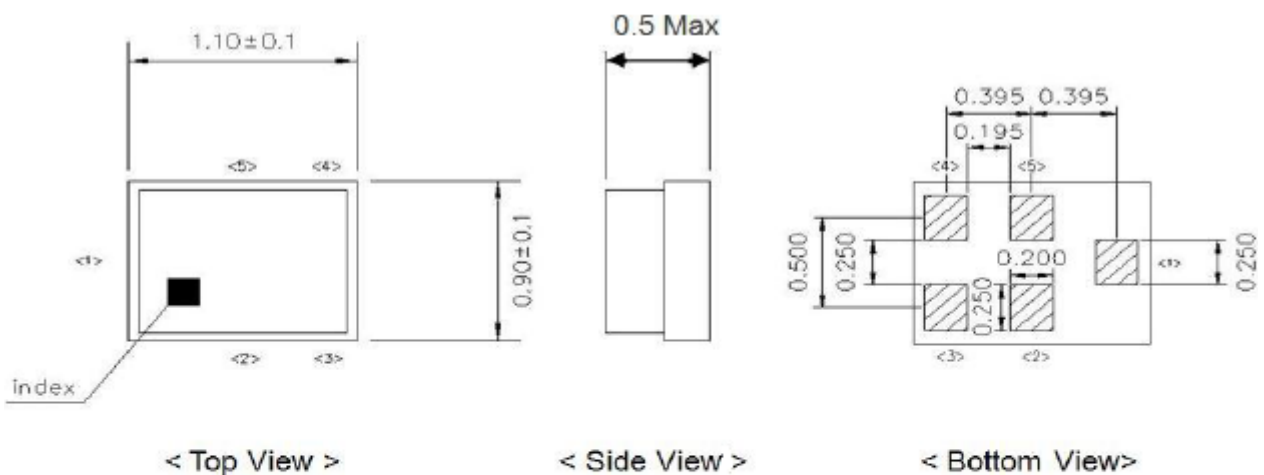

Not Specified Tolerance: +/-0.05mm

Coplanarity: 0.1mm max.

1 to 5 : Pin No.

Unit:mm

Pin No.	Symbol	Function
1	IN	Unbalanced Input
2	GND	Ground
3	GND	Ground
4	OUT	Unbalanced Output
5	GND	Ground

SAW Filter 1582.4690MHz
Part No: MP06617

Model: TA1804A
Rev No: 3

G. PACKING:

1. Reel Dimension

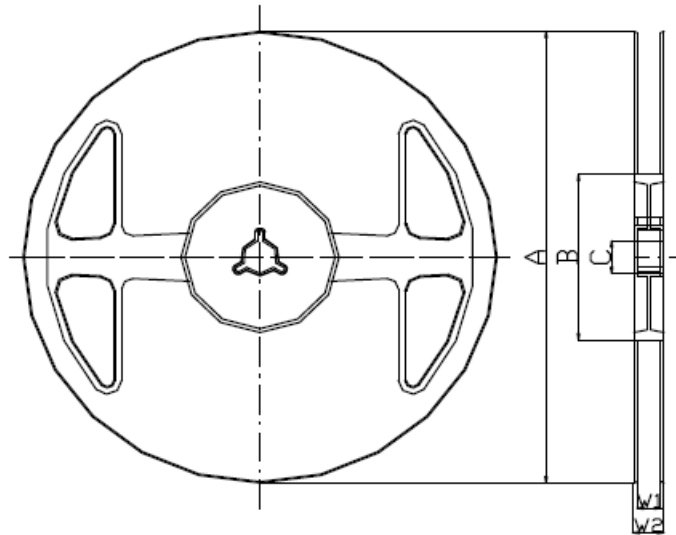

Materials of Reel

Material : Polystyrene + Carbon

Color : Black

Surface resistance (reference value) : $10^9 \Omega/\text{sq}$ Max.

Unit : mm

Code	Quantity	A	B	C	W1	W2
J	5,000 pcs	$\phi 180.0 +0.0/-1.5$	$\phi 66.0 +/-0.5$	$\phi 13.0 +/-0.2$	$9.0 +1.0/-0.0$	$11.4 +/-1.0$

2. Tape Dimension

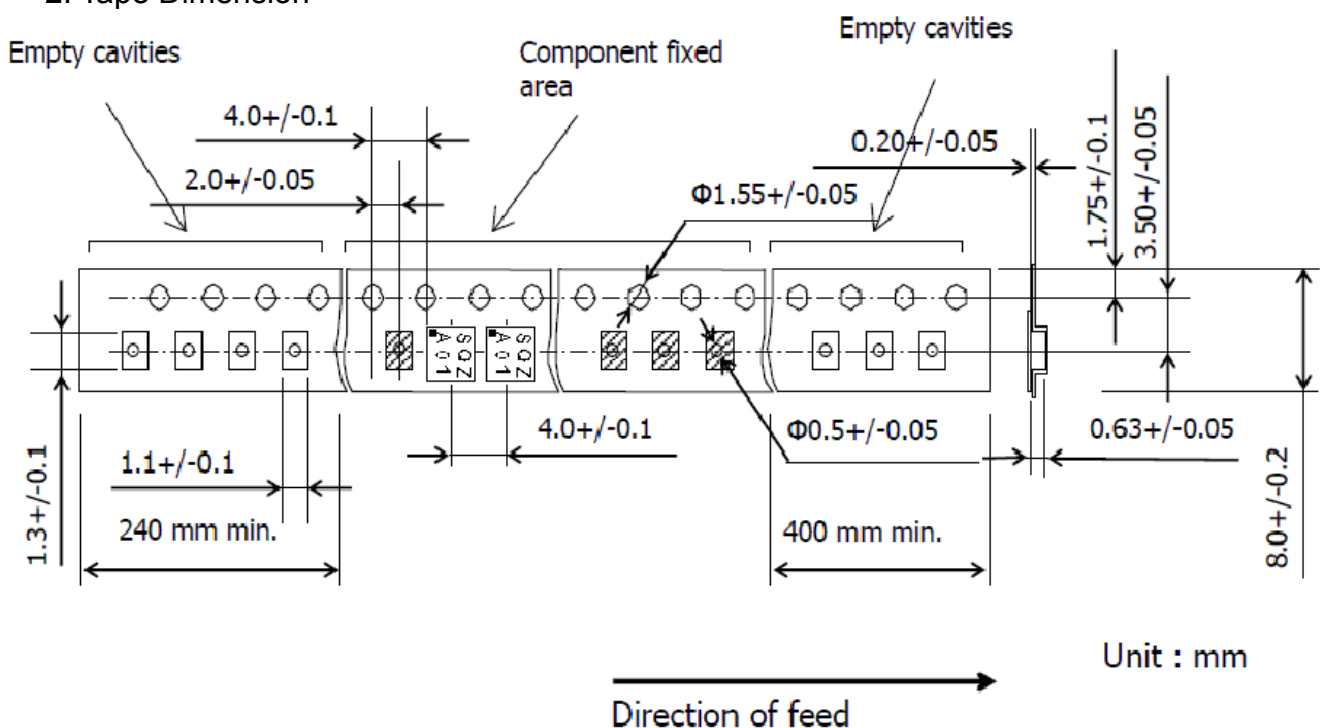

Unit : mm

SAW Filter 1582.4690MHz
Part No: MP06617

Model: TA1804A
Rev No: 3

H. RECOMMENDED REFLOW PROFILE:

1. Preheating shall be fixed at 150 ~ 180°C for 60 ~ 90 seconds.
2. Ascending time to preheating temperature 150°C shall be 30 seconds min.
3. Heating shall be fixed at 220°C for 50 ~ 80 seconds and at 260°C +0/-5°C peak (20 ~ 40 sec).
4. Time: 2 times.

