

SAW Filter 1582.40MHz
Part No: MP09197

Model: TA2396A
Rev No: 1

A. MAXIMUM RATING:

Electrostatic Sensitive Device (ESD)

1. Input Power Level: 15dBm
2. Input Power Level at 915MHz: 23dBm
3. DC Voltage: 3V
4. Operating Temperature: -40°C to +125°C
5. Storage Temperature: -40°C to +125°C
6. Moisture Sensitivity Level: Level 3 (MSL3)

B. ELECTRICAL CHARACTERISTICS:

1. Terminating source impedance (single): $Z_S = 50\Omega$
2. Terminating load impedance (single): $Z_L = 50\Omega$

Item	Unit	Min	Typ.	Max
Center Frequency Fc	MHz	-	1582.4	-
Insertion Loss (1559.05 ~ 1563.15MHz) IL	dB		1.8	2.0
Insertion Loss (1573.37 ~ 1577.47MHz) IL	dB		1.0	2.0
Insertion Loss (1574.42 ~ 1576.42MHz) IL	dB		1.0	1.4
Insertion Loss (1597.78 ~ 1605.66MHz) IL	dB		1.6	2.2
VSWR (1559.05 ~ 1563.15MHz)			1.6	2.1
VSWR (1574.42 ~ 1576.42MHz)			1.3	2.1
VSWR (1597.78 ~ 1605.66MHz)			1.6	2.1
Variation of group delay (1597.78 ~ 1605.66MHz)	ns		4	14 ¹)
Attenuation				
50 ~ 824MHz	dB	36	41	
824 ~ 925MHz	dB	35	40	
1427 ~ 1453MHz	dB	38	43	
1710 ~ 1785MHz	dB	27	32	
1850 ~ 1910MHz	dB	33	38	
1920 ~ 1980MHz	dB	33	38	
2400 ~ 2500MHz	dB	35	40	
2500 ~ 2570MHz	dB	33	38	
2600 ~ 3000MHz	dB	29	34	
Temperature coefficient	ppm/°C	-36		
Package size	mm	1411		

Note: Averaged over 2MHz

SAW Filter 1582.40MHz
Part No: MP09197

Model: TA2396A
Rev No: 1

C. OUTLINE DRAWING:

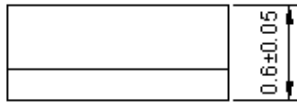
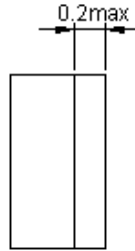
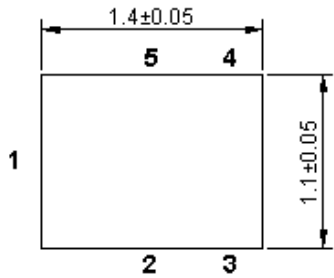

All tolerances are +/-0.05 mm unless otherwise specified
 Coplanarity : 0.1 mm max.
 1 to 5 : Pin No.
 Unit : mm

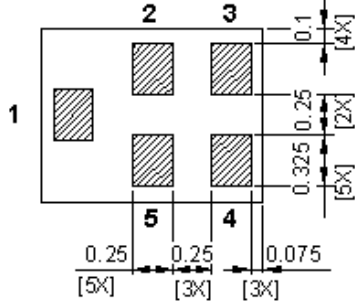

Pin No.	Symbol	Function
1	IN	Input
2	GND	Ground
3	GND	Ground
4	OUT	Output
5	GND	Ground

D. MEASUREMENT CIRCUIT:

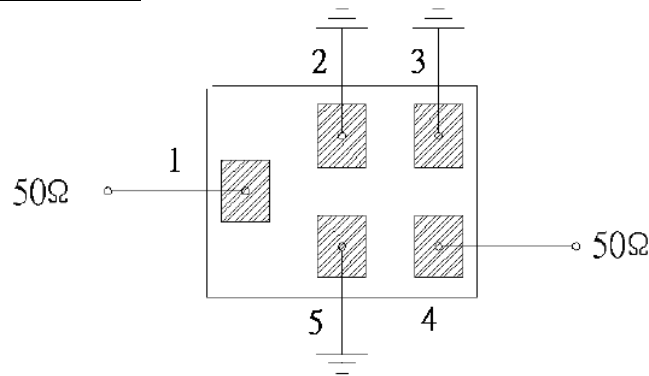

E. PCB FOOTPRINT:

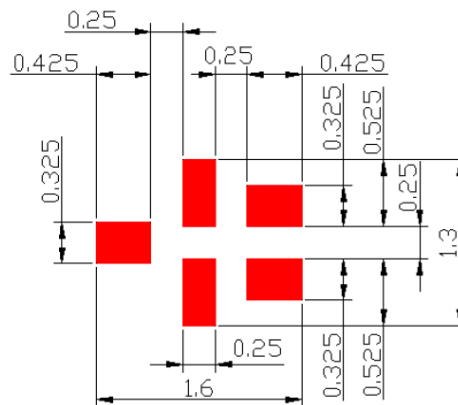

■ : Land Pattern

SAW Filter 1582.40MHz
Part No: MP09197

Model: TA2396A
Rev No: 1

F. FREQUENCY CHARACTERISTICS:

1. S21 response: (span 500MHz)

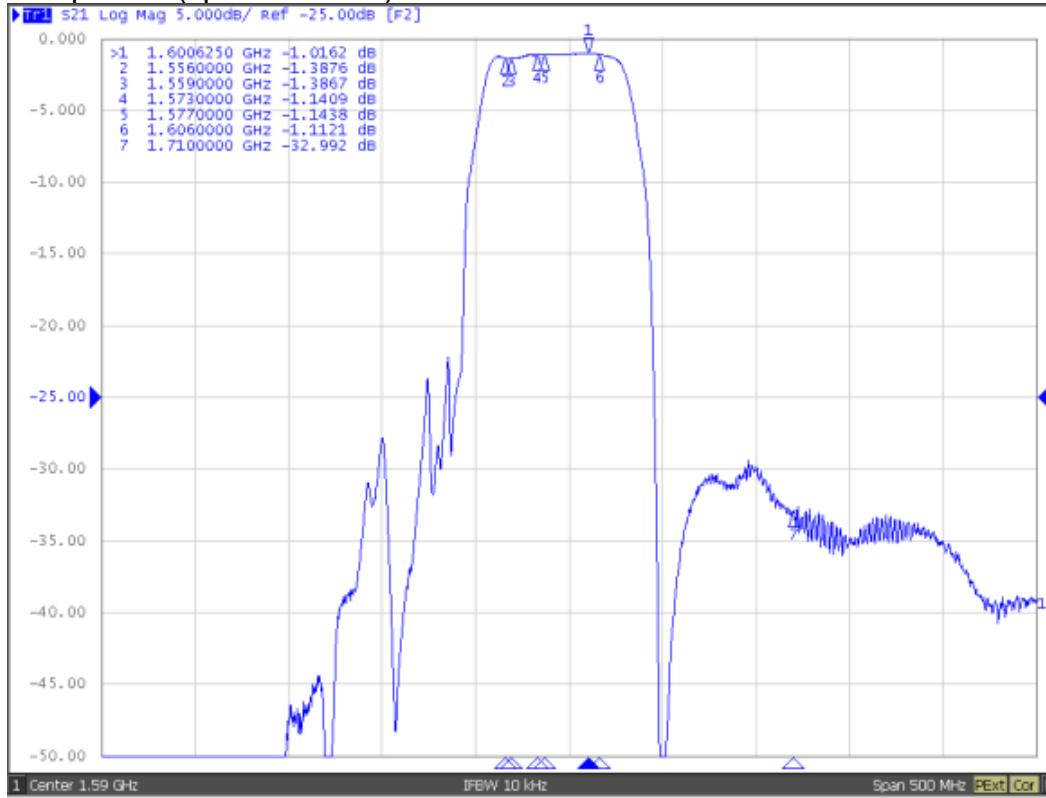

2. S21 response: (span 120MHz)

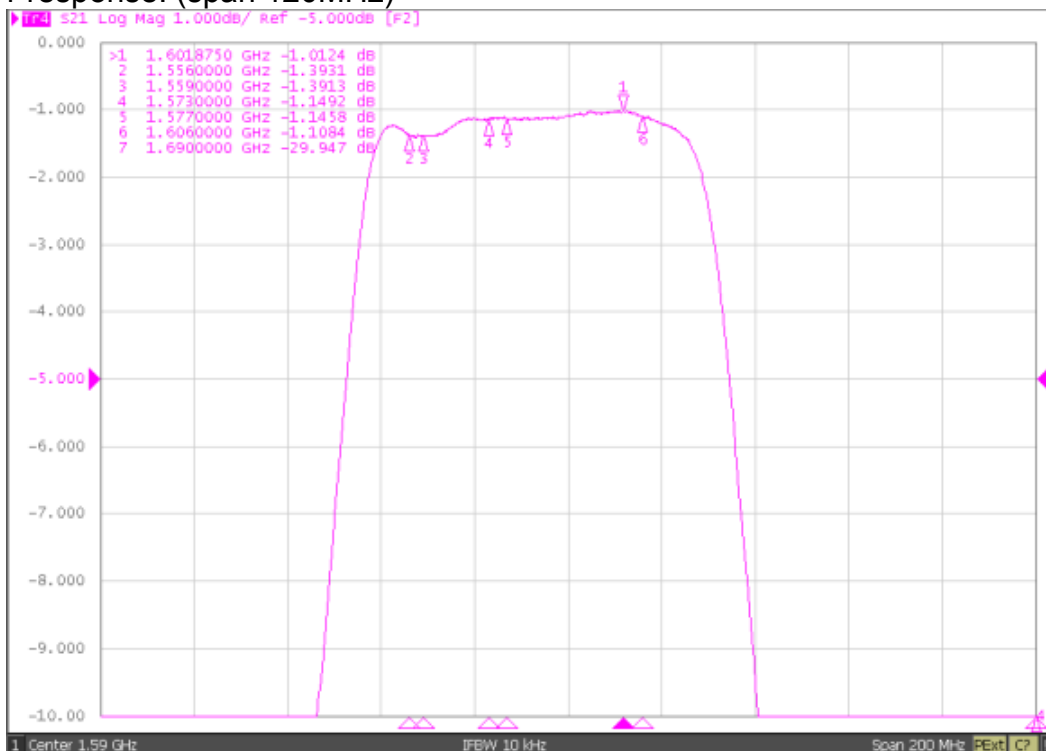

SAW Filter 1582.40MHz
Part No: MP09197

Model: TA2396A
Rev No: 1

3. S11/S22 response:

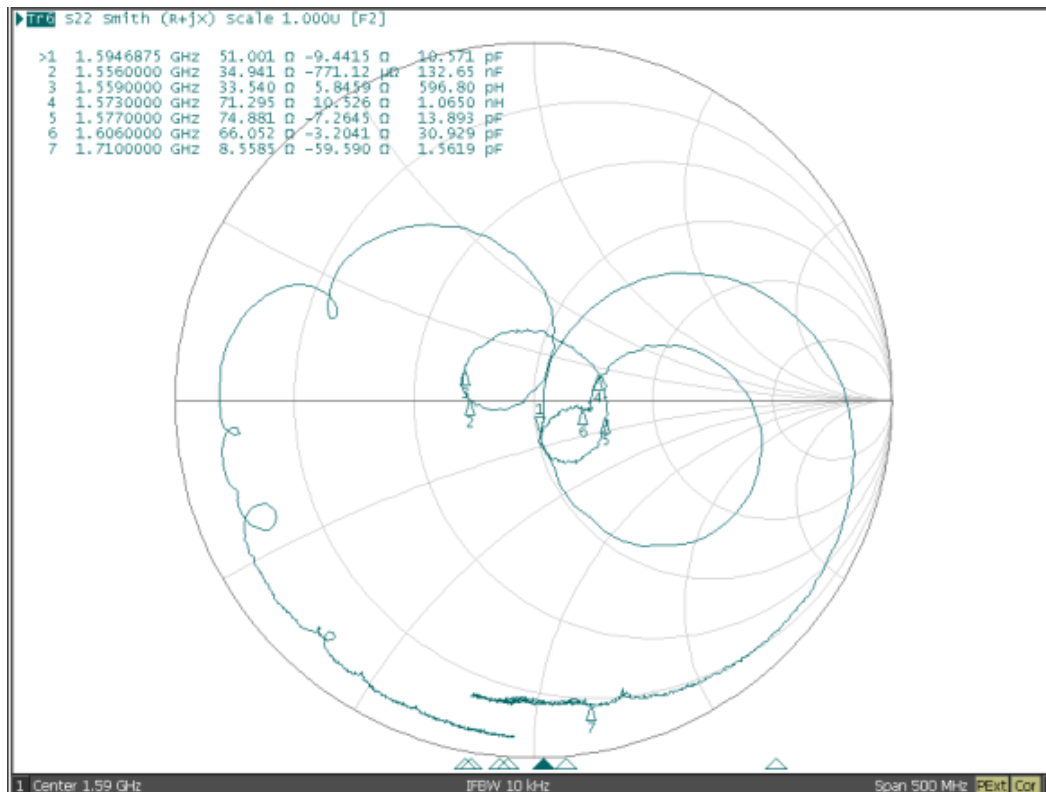
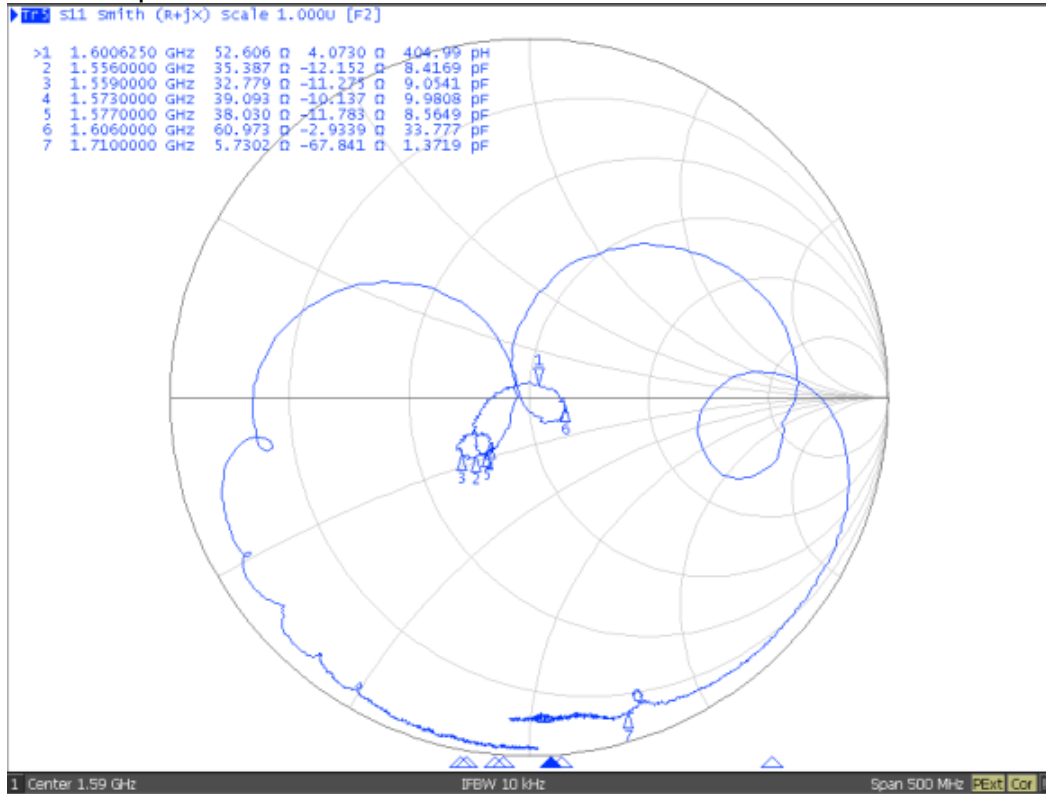

SAW Filter 1582.40MHz
Part No: MP09197

Model: TA2396A
Rev No: 1

4. S21 response: (span 4.5GHz)

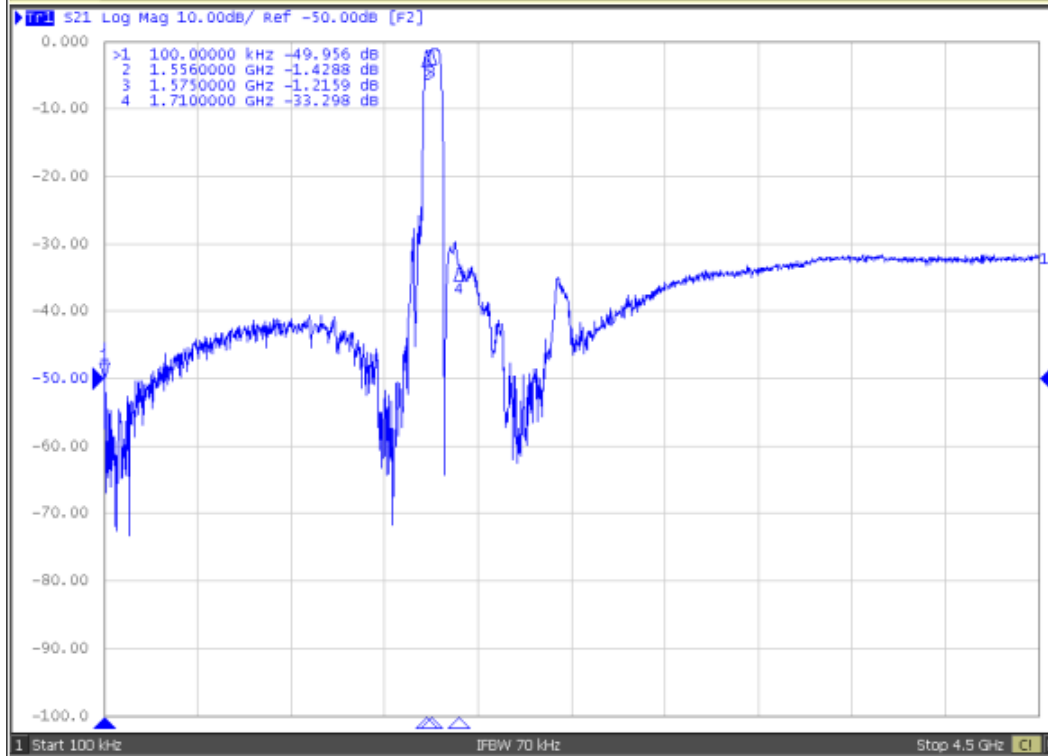

SAW Filter 1582.40MHz
Part No: MP09197

Model: TA2396A
Rev No: 1

G. PACKING:

1. Reel Dimension

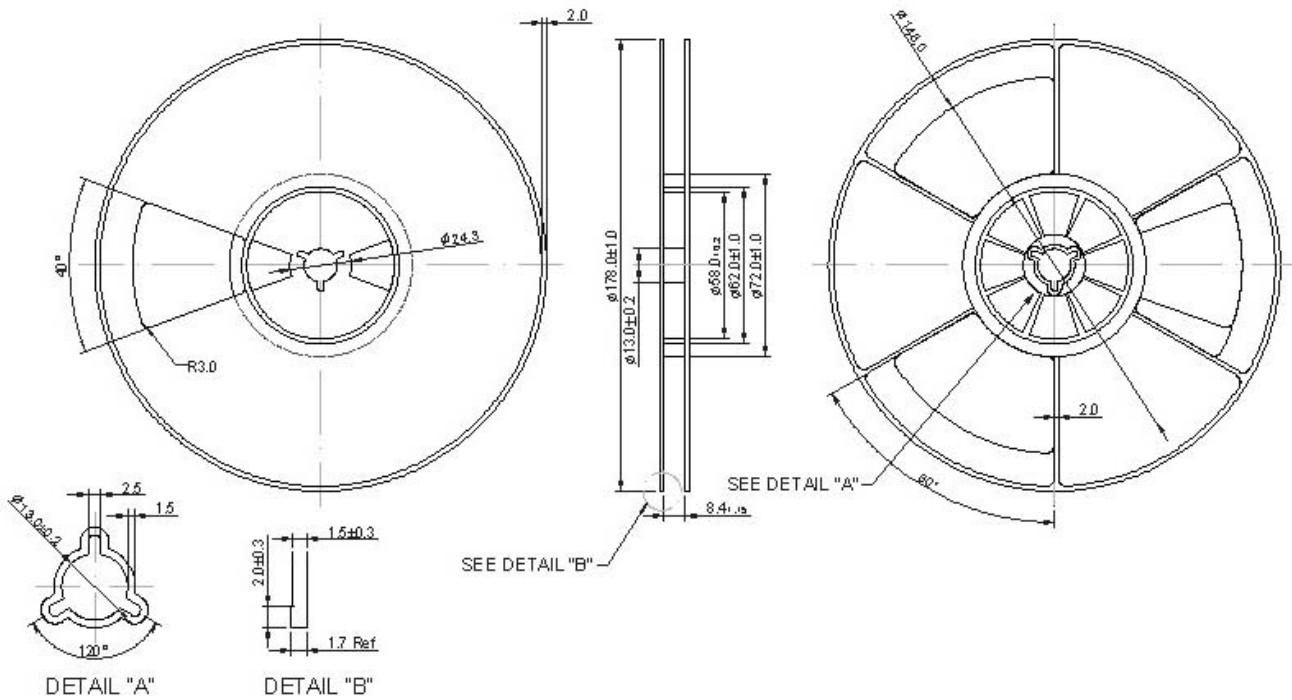

2. Tape Dimension

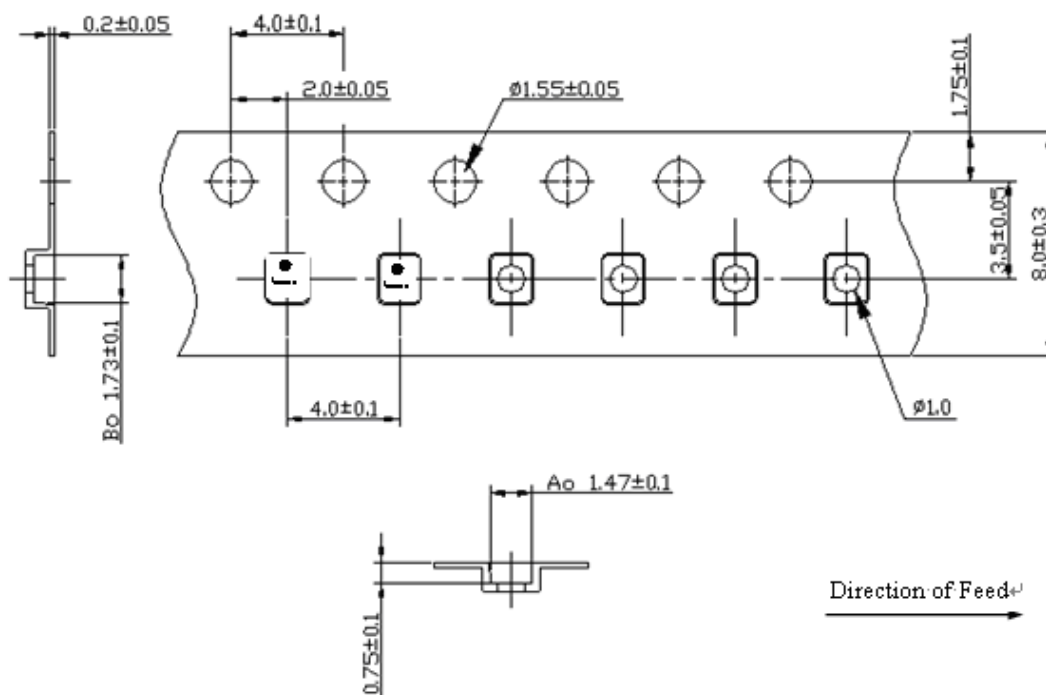

SAW Filter 1582.40MHz

Model: TA2396A

Part No: MP09197

Rev No: 1

H. RECOMMENDED REFLOW PROFILE:

1. Preheating shall be fixed at 150 ~ 180°C for 60 ~ 90 seconds.
2. Ascending time to preheating temperature 150°C shall be 30 seconds min.
3. Heating shall be fixed at 220°C for 50 ~ 80 seconds and at 260°C +0/-5°C peak (20 ~ 40 sec).
4. Time: 2 times.

