

SAW Filter 3500.0MHz

Model: TA2307A

Part No: MP08675

Rev No: 1

A. MAXIMUM RATING:

Electrostatic Sensitive Device (ESD)

1. Input Power Level: 23dBm, 2h, 95°C
2. DC voltage: 0V
3. Operating Temperature: -40°C to +105°C
4. Storage Temperature: -40°C to +105°C
5. Moisture Sensitivity Level: Level 1(MSL1)

B. ELECTRICAL CHARACTERISTICS:

| Item | Unit | Min. | Typ. | Max. |
|--|--------|------|------|------|
| Center frequency Fc | MHz | - | 3500 | - |
| Insertion loss (3400 ~ 3600MHz) IL | dB | - | 3.7 | 5.0 |
| Amplitude ripple (3400 ~ 3600MHz) | dB p-p | - | 0.4 | 3.0 |
| VSWR (3400 ~ 3600MHz) | - | - | 2.1 | 2.5 |
| Absolute group delay (3400 ~ 3600MHz) | ns | | 2 | 30 |
| Group delay ripple (3400 ~ 3600MHz) | ns | - | 1.5 | 15 |
| Attenuation (Reference level from 0dB) | | | | |
| 10 ~ 2550MHz | dB | 23 | 27 | - |
| 2550 ~ 2690MHz | dB | 25 | 28 | - |
| 2690 ~ 3000MHz | dB | 25 | 29 | - |
| 3000 ~ 3200MHz | dB | 10 | 31 | - |
| 3800 ~ 3850MHz | dB | 10 | 40 | - |
| 3850 ~ 4200MHz | dB | 20 | 38 | - |
| 4200 ~ 5000MHz | dB | 5 | 32 | - |
| 5000 ~ 6000MHz | dB | 1 | 30 | - |
| Temperature Coefficient of Frequency | ppm/°C | - | -80 | - |

SAW Filter 3500.0MHz
Part No: MP08675

Model: TA2307A
Rev No: 1

C. FREQUENCY CHARACTERISTICS:

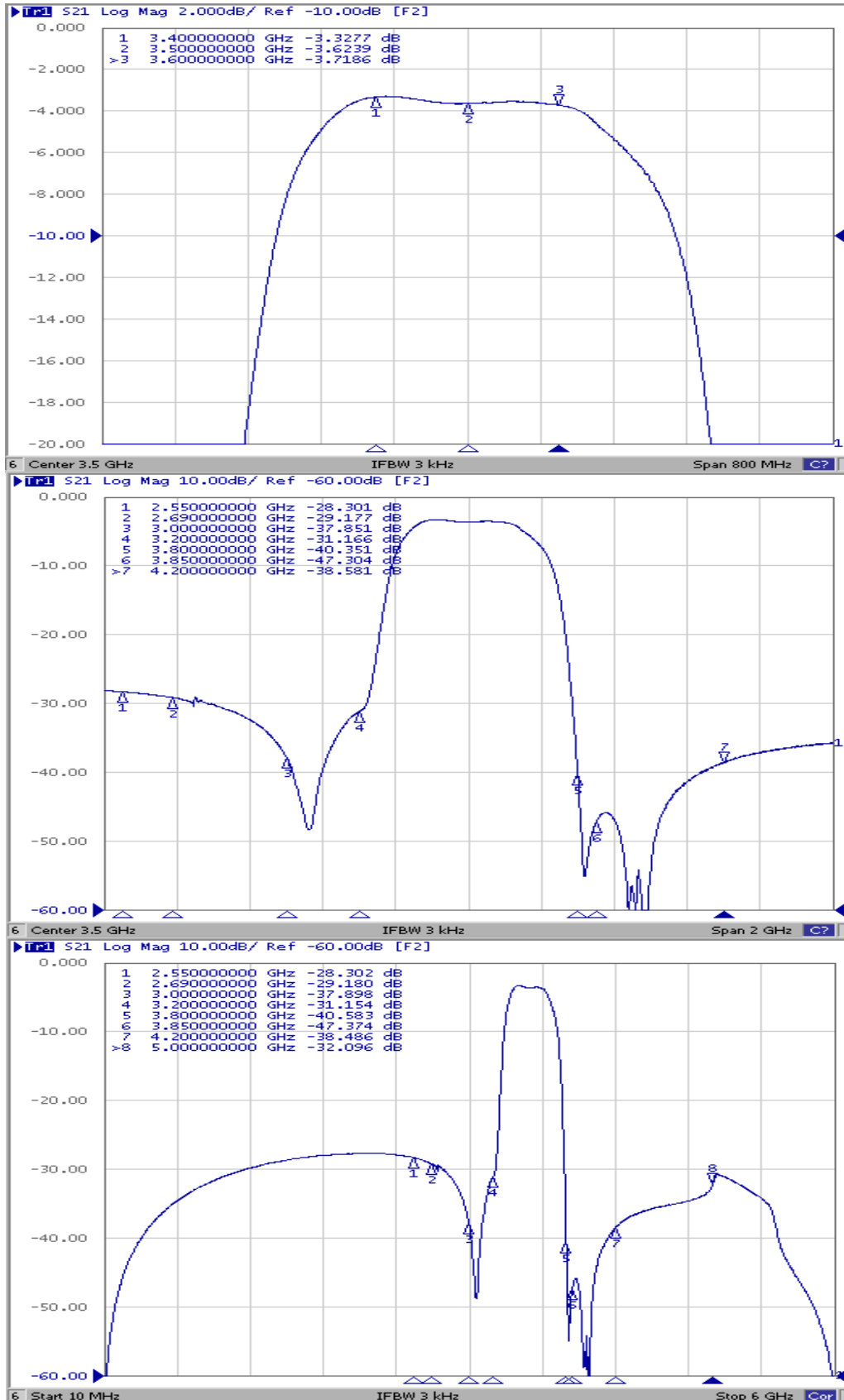

SAW Filter 3500.0MHz
Part No: MP08675

Model: TA2307A
Rev No: 1

Reflection Functions

S11

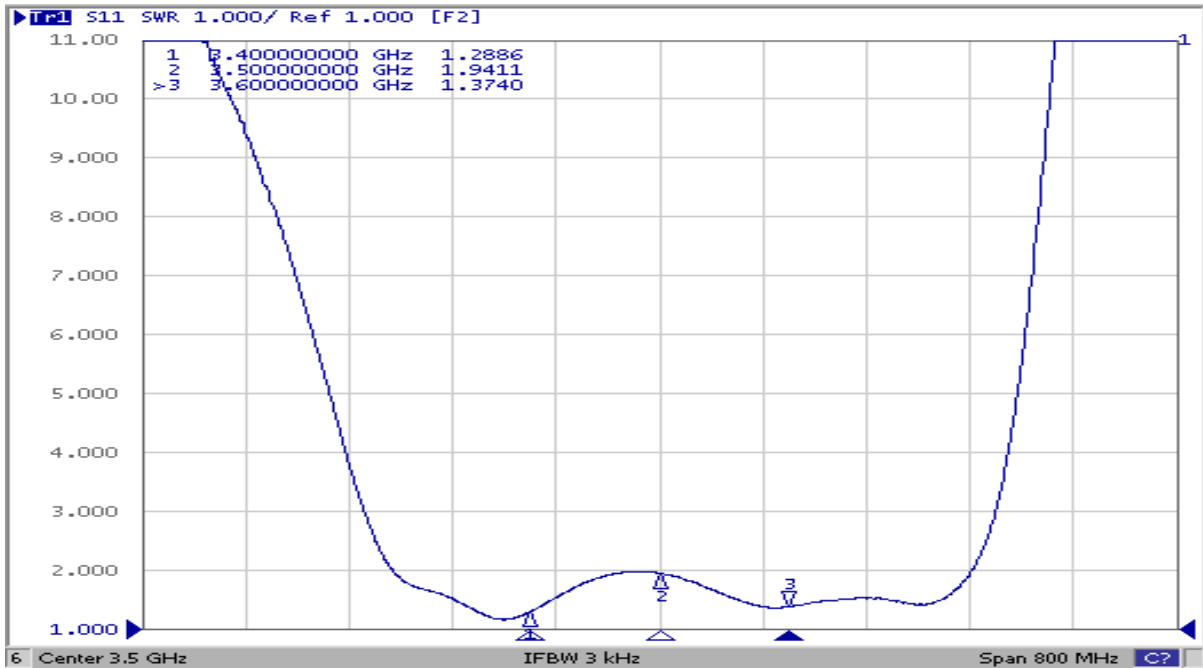

S22

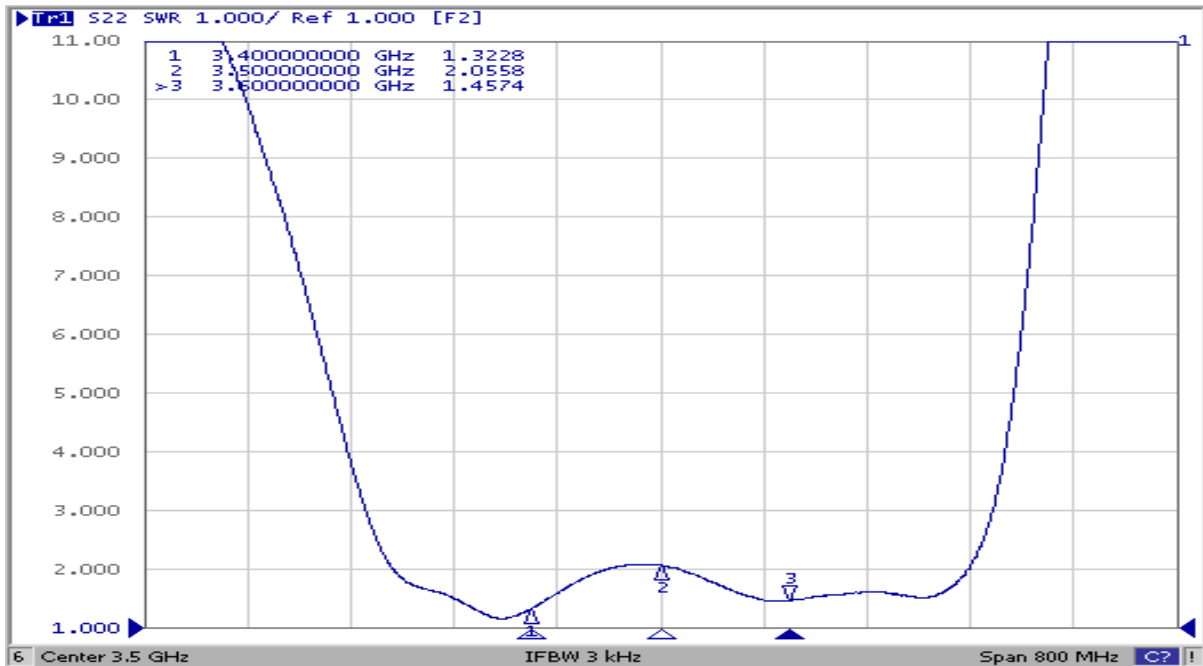

SAW Filter 3500.0MHz

Model: TA2307A

Part No: MP08675

Rev No: 1

D. MEASUREMENT CIRCUIT:

HP Network analyzer

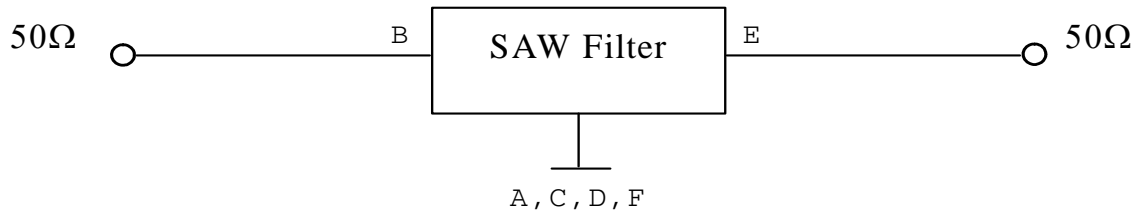

E. OUTLINE DRAWING:

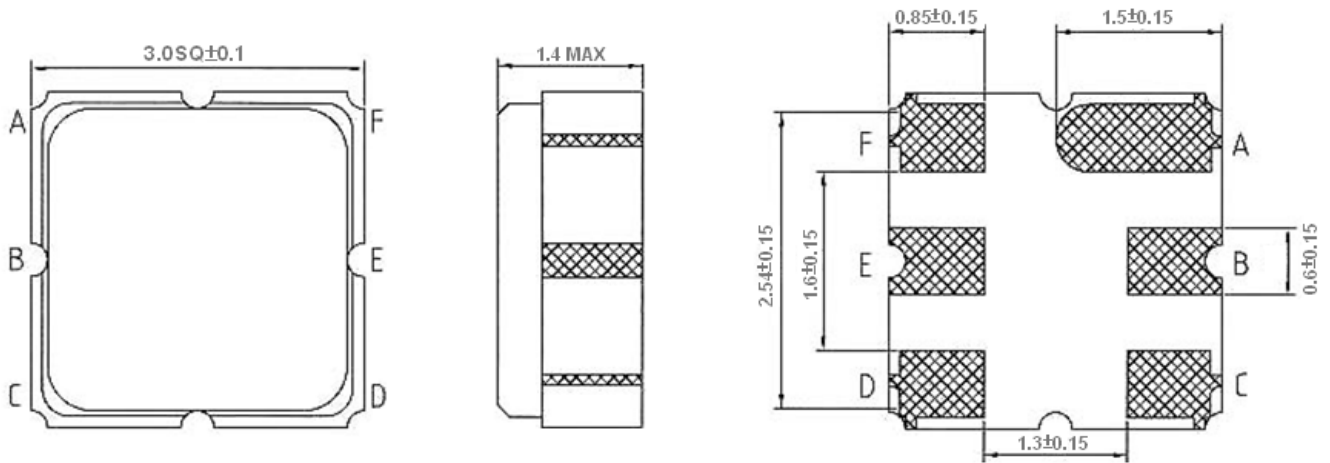

B: Input
 E: Output
 A, C, D, F: Ground
 Unit: mm

F. PCB FOOTPRINT:

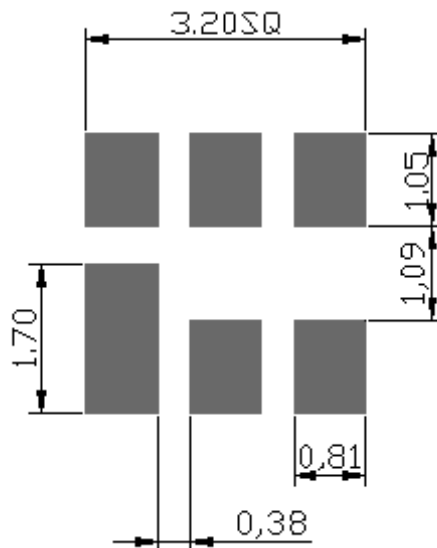

SAW Filter 3500.0MHz
Part No: MP08675

Model: TA2307A
Rev No: 1

G PACKING:

1. Reel Dimension

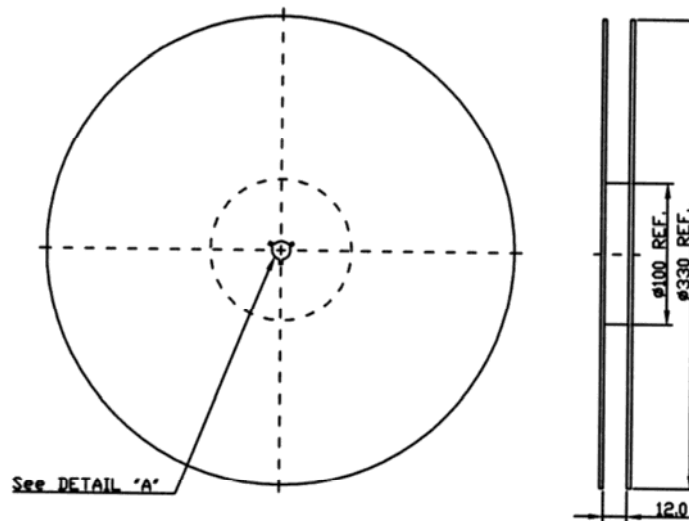

2. Tape Dimension

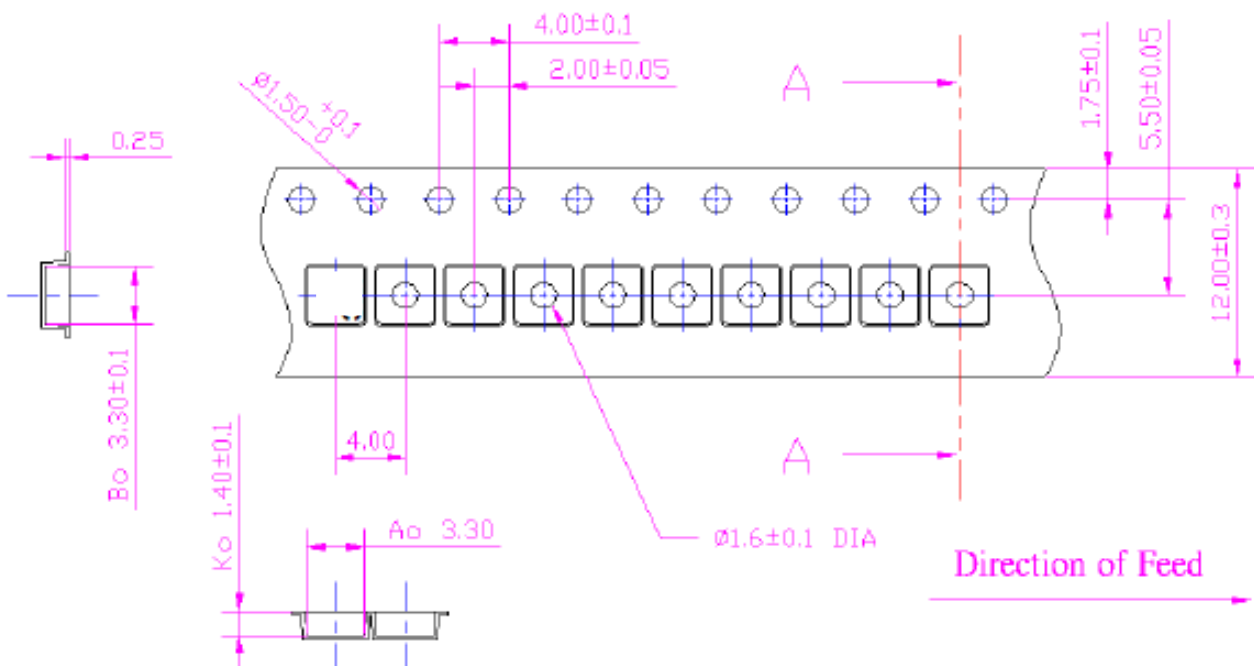

SAW Filter 3500.0MHz
Part No: MP08675

Model: TA2307A
Rev No: 1

H. RECOMMENDED REFLOW PROFILE:

1. Preheating shall be fixed at 150 ~ 180°C for 60 ~ 90 seconds.
2. Ascending time to preheating temperature 150°C shall be 30 seconds min.
3. Heating shall be fixed at 220°C for 50 ~ 80 seconds and at 260°C +0/-5°C peak (20 ~ 40 sec).
4. Time: 2 times.

