

**SAW Filter 436.0MHz**  
**Part No: MP08449**

**Model: TA2206A**  
**Rev No: 1**

**A. MAXIMUM RATING:**

Electrostatic Sensitive Device (ESD)

1. Input Power Level: 10dBm
2. DC voltage: 5V
3. Operating Temperature: -30°C to 70°C
4. Storage Temperature: -40°C to +85°C

**B. CHARACTERISTICS:**

Ambient Temperature: 25°C

Item	Unit	Min.	Typ.	Max.
Center frequency Fc	MHz	-	436	-
Insertion loss IL (425 ~ 447MHz)	dB	-	2.1	3.3
VSWR (425 ~ 447MHz)	-	-	1.8	2.0
1dB Bandwidth	MHz	22	28	-
Attenuation (reference from 0dB)				
10 ~ 150MHz	dB	35	54	-
210 ~ 355MHz	dB	30	50	-
355 ~ 370MHz	dB	25	48	-
370 ~ 390MHz	dB	15	45	-
482 ~ 500MHz	dB	15	39	-
500 ~ 505MHz	dB	25	44	-
505 ~ 620MHz	dB	30	45	-
620 ~ 800MHz	dB	27	44	-
Source impedance Z <sub>S</sub>	Ω	-	50	-
Load impedance Z <sub>L</sub>	Ω	-	50	-

Note: No matching network required for operation at 50Ω

**SAW Filter 436.0MHz**  
**Part No: MP08449**

**Model: TA2206A**  
**Rev No: 1**

### C. FREQUENCY CHARACTERISTICS:

#### 1. Wideband

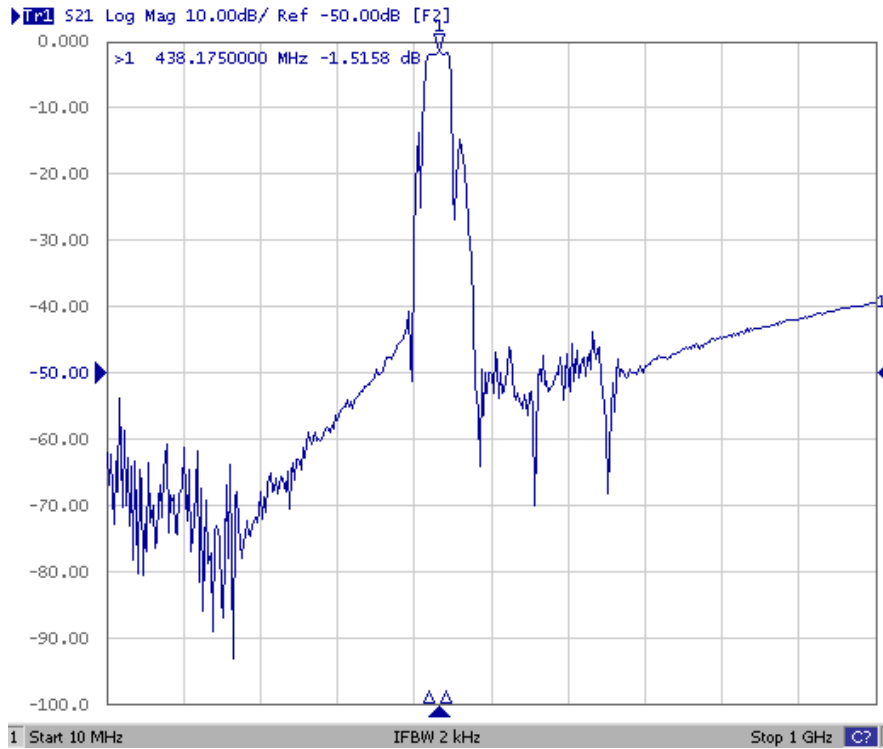

#### 2. Passband

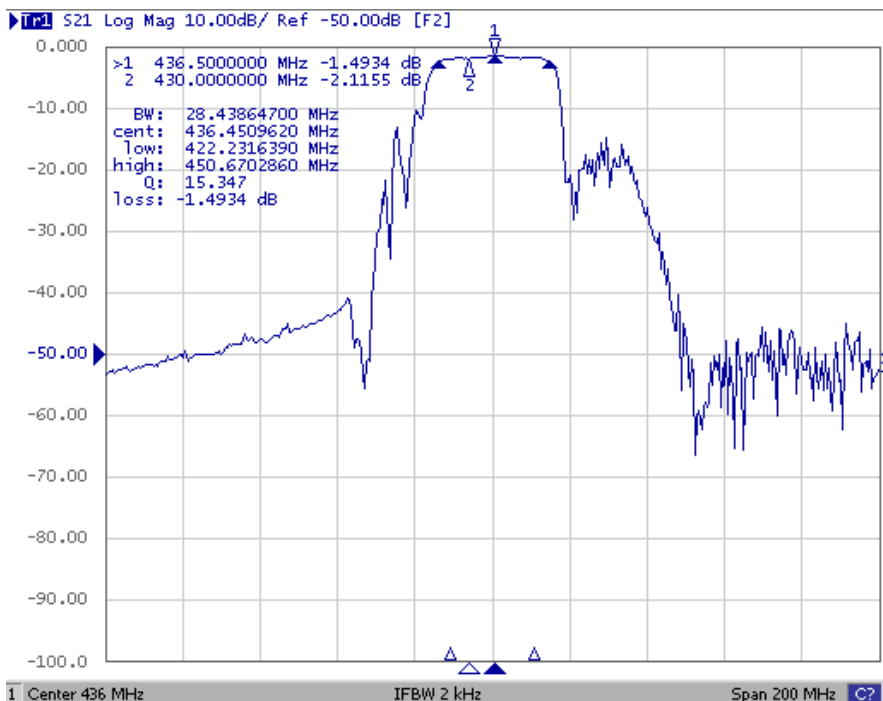

**SAW Filter 436.0MHz**  
**Part No: MP08449**

**Model: TA2206A**  
**Rev No: 1**

### 3. VSWR

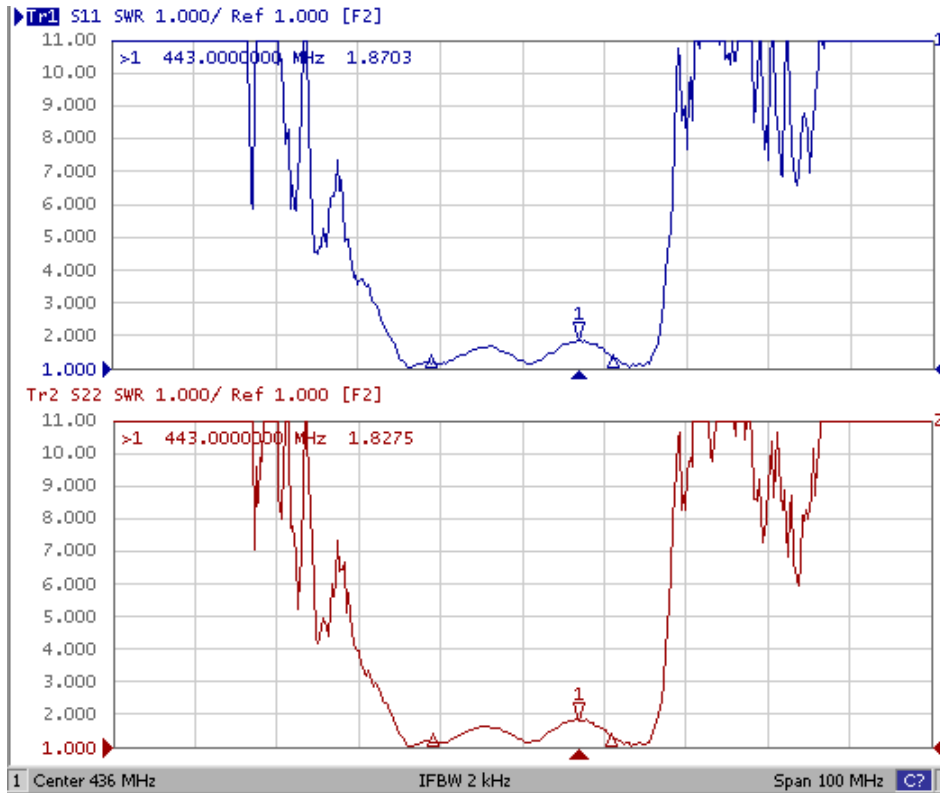

### D. MEASUREMENT CIRCUIT:

HP Network analyzer

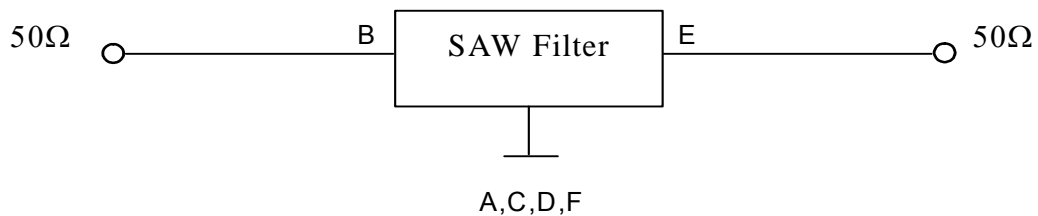

**SAW Filter 436.0MHz**  
**Part No: MP08449**

**Model: TA2206A**  
**Rev No: 1**

**E. OUTLINE DRAWING:**

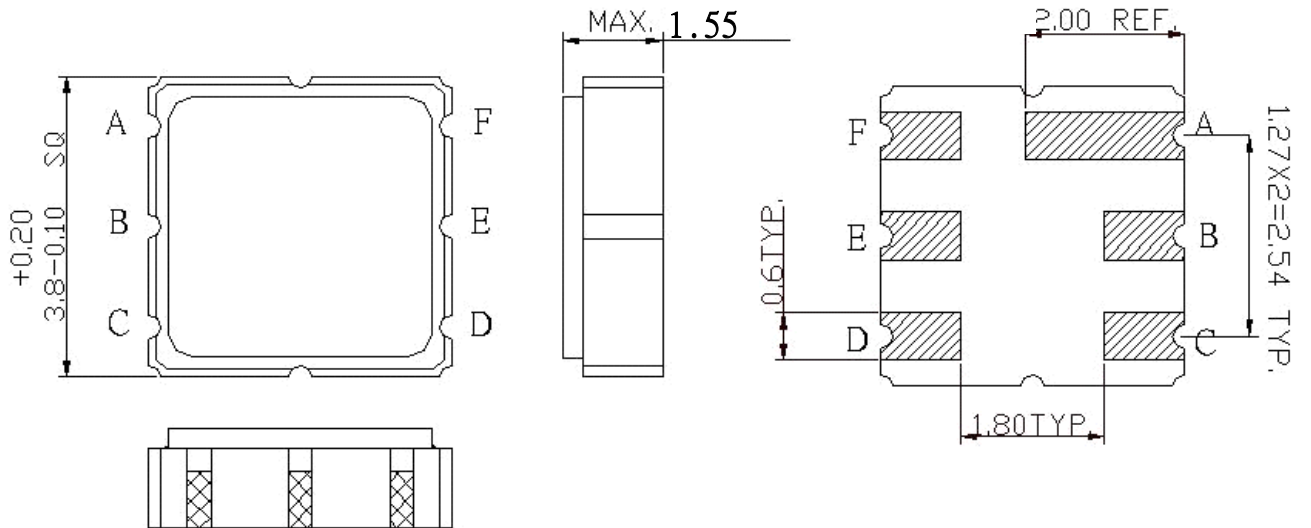

B: Input  
 E: Output  
 A, C, D, F Ground  
 Unit: mm

**F. PCB FOOTPRINT:**

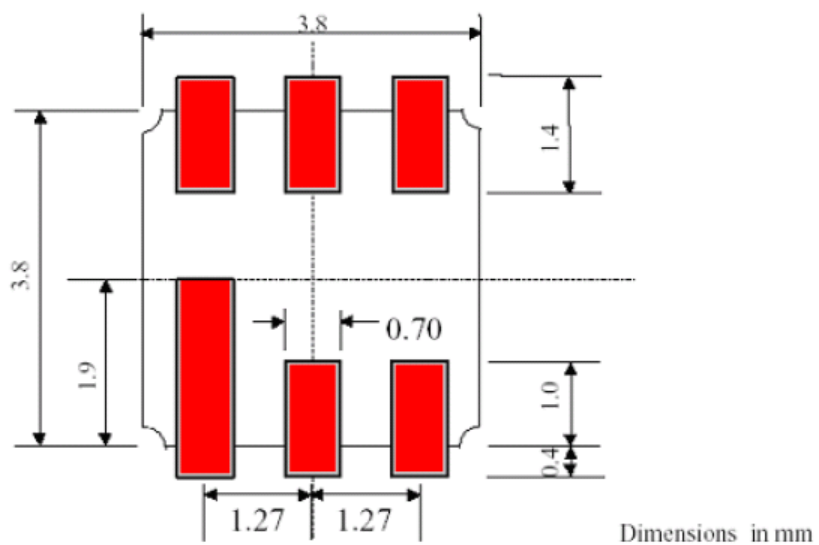

**SAW Filter 436.0MHz**  
**Part No: MP08449**

**Model: TA2206A**  
**Rev No: 1**

**G. PACKING:**

1. Reel Dimension

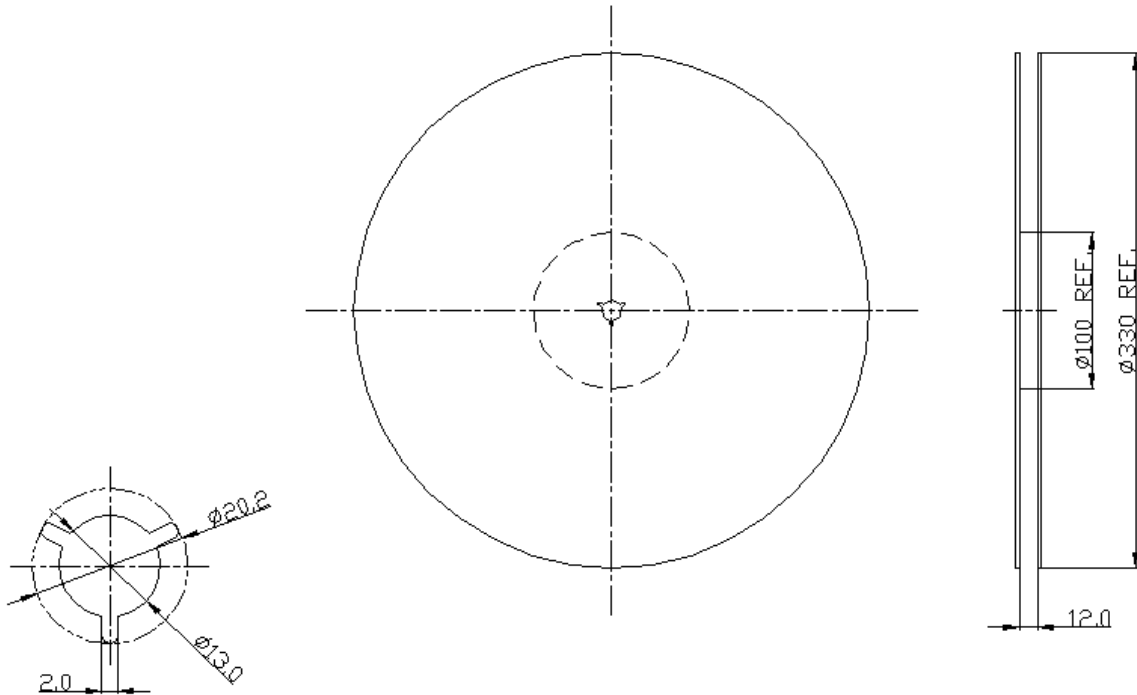

2. Tape Dimension

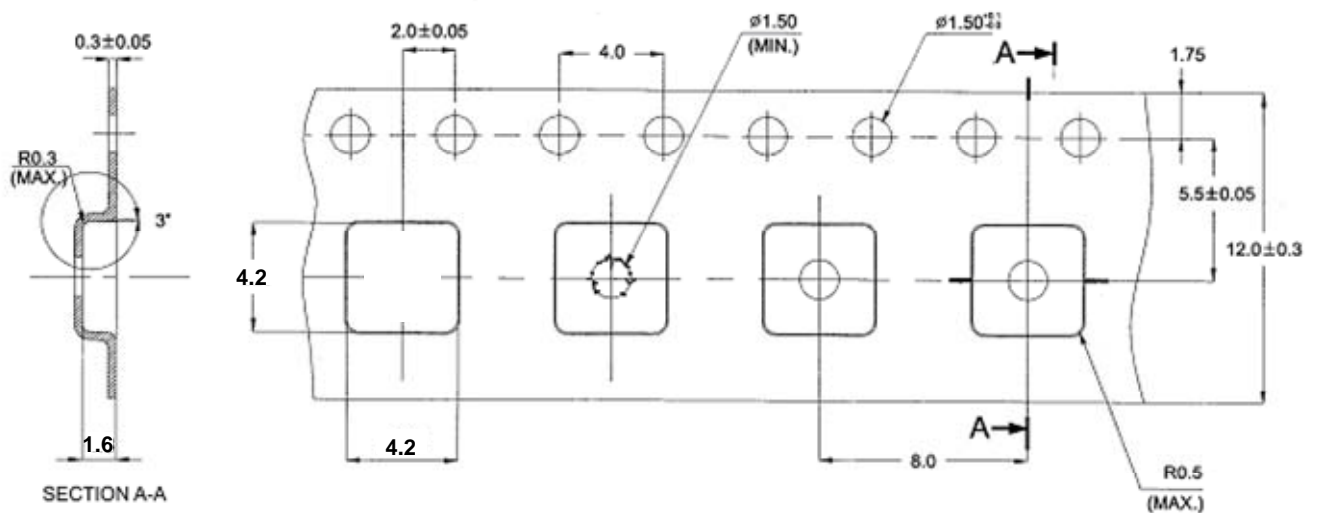

Direction of Feed



**SAW Filter 436.0MHz**  
**Part No: MP08449**

**Model: TA2206A**  
**Rev No: 1**

**H. RECOMMENDED REFLOW PROFILE:**

1. Preheating shall be fixed at 150 ~ 180°C for 60 ~ 90 seconds.
2. Ascending time to preheating temperature 150°C shall be 30 seconds min.
3. Heating shall be fixed at 220°C for 50 ~ 80 seconds and at 260°C +0/-5°C peak (20 ~ 40 sec).
4. Time: 2 times.

