

**SAW Filter 1900.0MHz**

**Model: TA2018A**

**Part No: MP07862**

**Rev No: 1**

**A. MAXIMUM RATING:**

Electrostatic Sensitive Device (ESD)

1. Input Power Level: 10dBm
2. DC Voltage: 3V
3. Operating Temperature: -40°C to +85°C
4. Storage Temperature: -40°C to +105°C

**B. ELECTRICAL CHARACTERISTICS:**

Item	Unit	Min.	Typ.	Max.	Note
Center Frequency Fc	MHz	-	1900	-	-
Insertion Loss (1880 ~ 1920MHz) IL	dB	-	1.4	2	-
VSWR (1880 ~ 1920MHz)		-	1.4	2	
Amplitude ripple (1880 ~ 1920MHz)	dB	-	0.5	1.4	-
Attenuation					-
10 ~ 1710MHz	dB	30	35	-	
1710 ~ 1805MHz	dB	35	43	-	-
1805 ~ 1840MHz	dB	25	30	-	-
1840 ~ 1850MHz	dB	10	13	-	-
2000 ~ 2110MHz	dB	25	30	-	
2110 ~ 2200MHz	dB	30	35	-	-
2200 ~ 4000MHz	dB	30	38	-	-
4000 ~ 6000MHz	dB	27	34	-	-
Package size	mm	SMD 1.1 x 0.9			

**SAW Filter 1900.0MHz**  
**Part No: MP07862**

**Model: TA2018A**  
**Rev No: 1**

**C. FREQUENCY CHARACTERISTICS:**

1. S21 response: (span 500MHz)

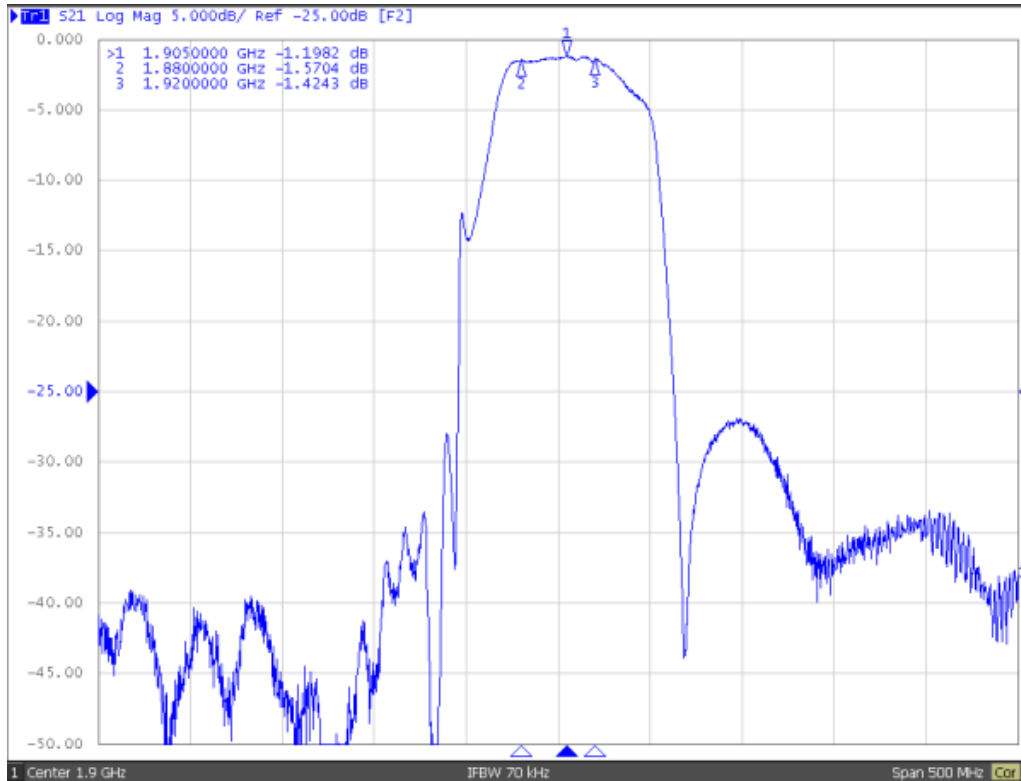

2. S21 response: (span 200MHz)

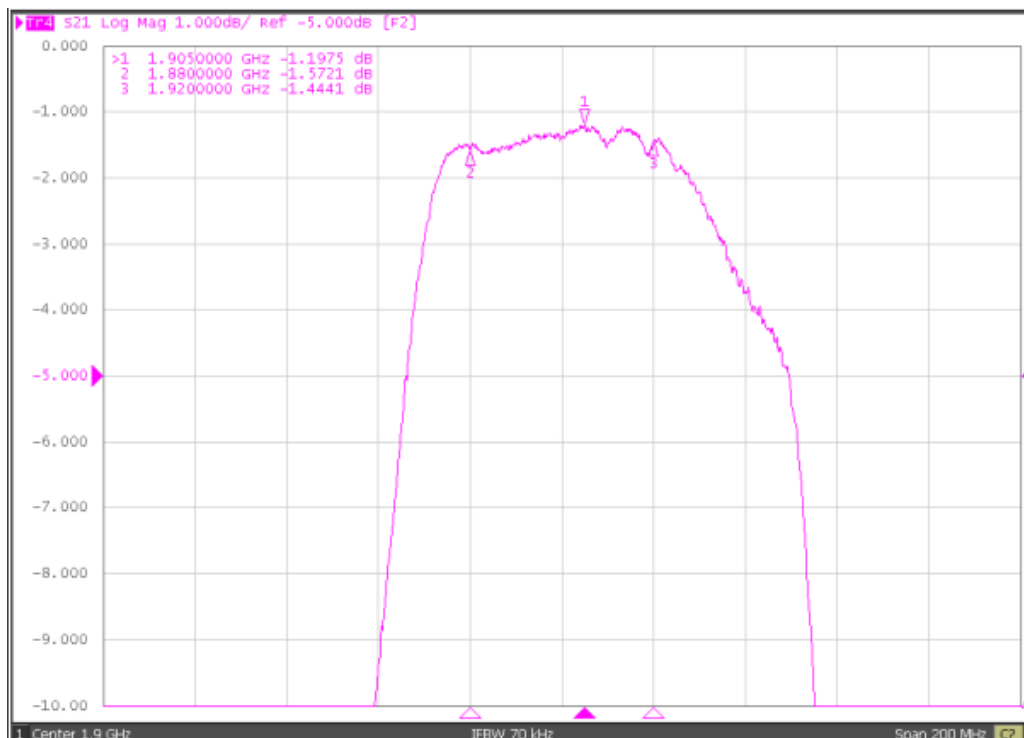

**SAW Filter 1900.0MHz**  
**Part No: MP07862**

**Model: TA2018A**  
**Rev No: 1**

3. S21 response: (span 4.5GHz)

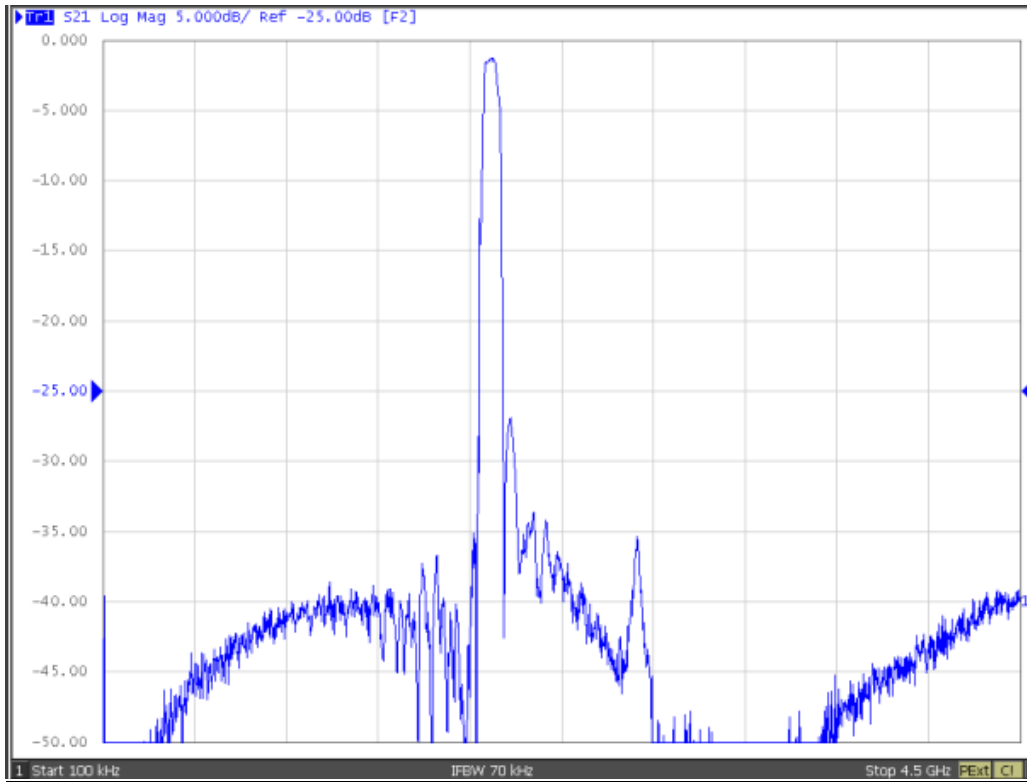

4. S11/S22 response:

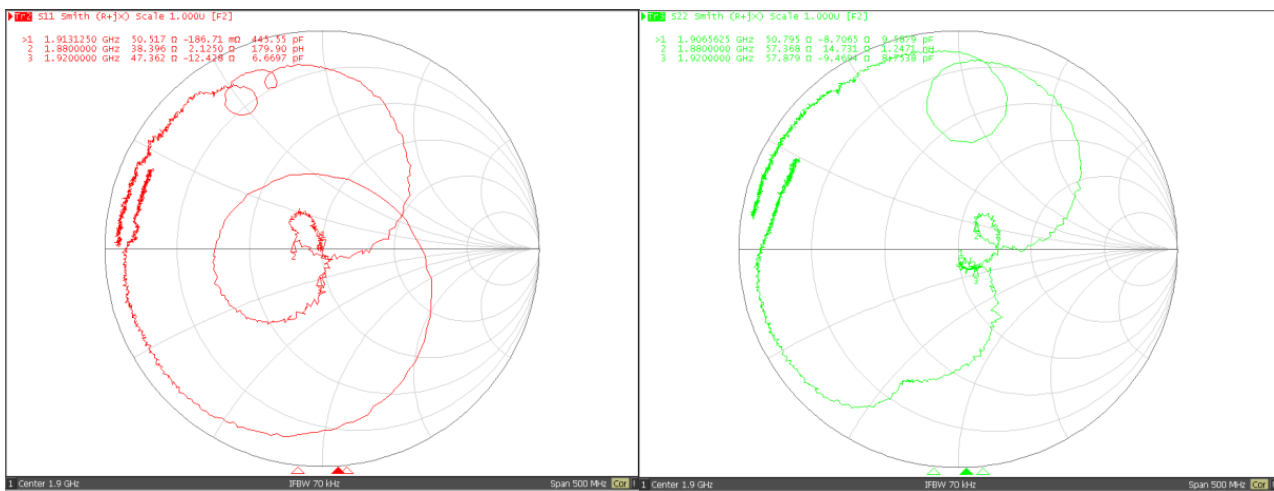

**SAW Filter 1900.0MHz**  
**Part No: MP07862**

**Model: TA2018A**  
**Rev No: 1**

**D. OUTLINE DRAWING:**

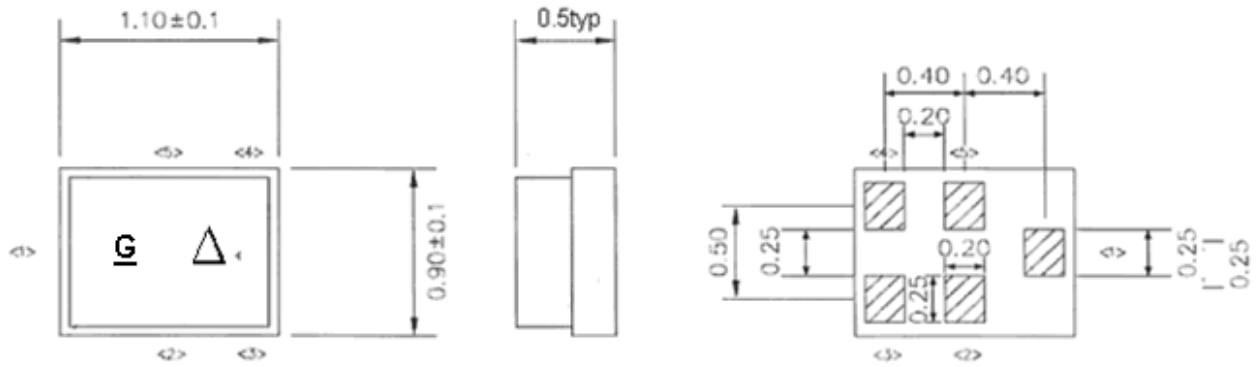

Unit: mm

Pin No.	Symbol	Function
1	IN	Unbalanced pin
2	GND	Ground
3	GND	Ground
4	OUT	Unbalanced pin
5	GND	Ground

**E. MEASUREMENT CIRCUIT:**

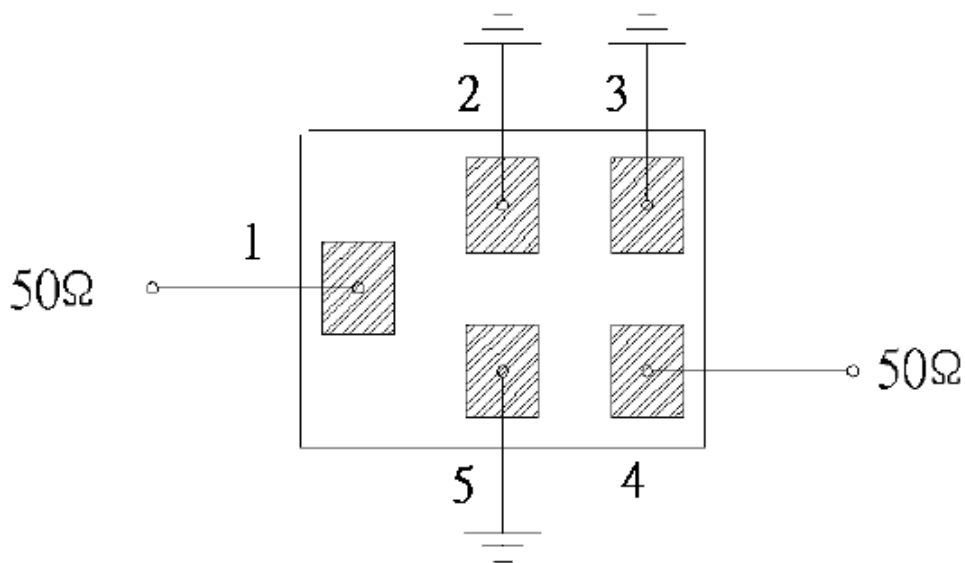

**SAW Filter 1900.0MHz**  
**Part No: MP07862**

**Model: TA2018A**  
**Rev No: 1**

**F. PACKING:**

1. Reel Dimension (Please refer to FR-75D10 for packing quantity)

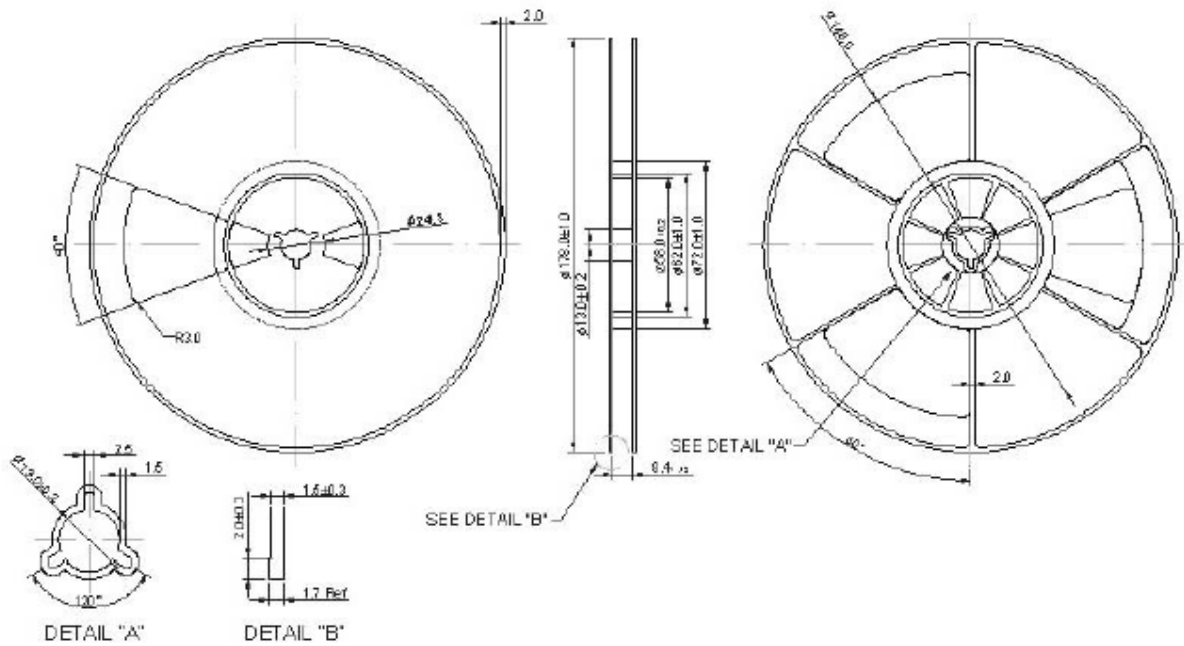

2. Tape Dimension

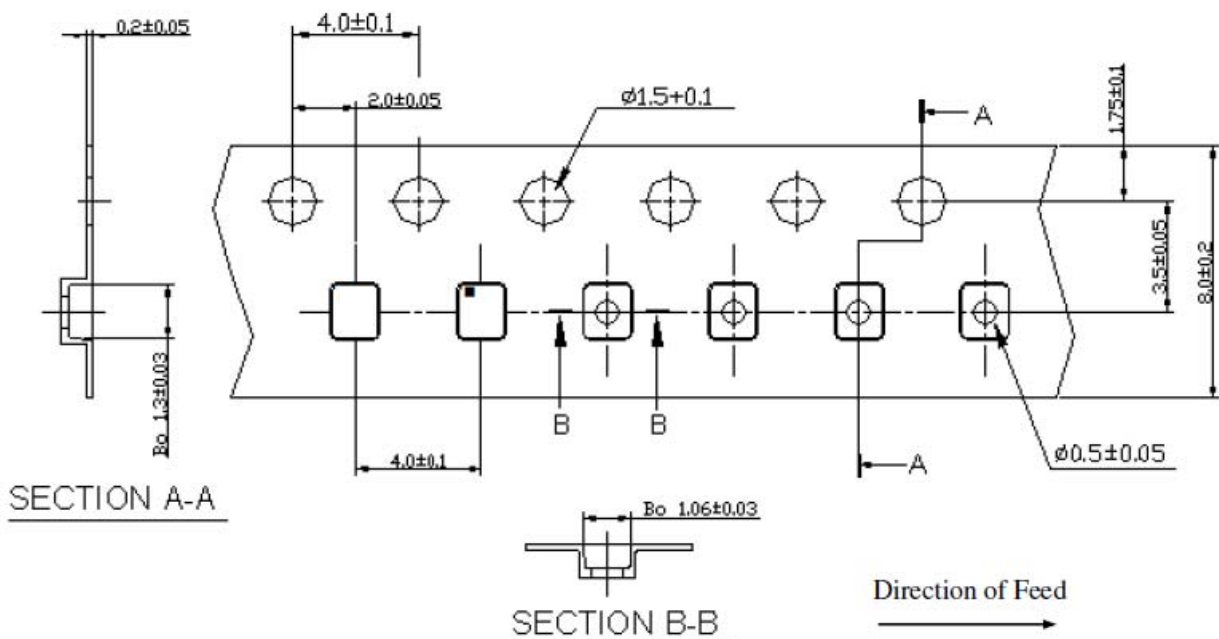

**SAW Filter 1900.0MHz**  
**Part No: MP07862**

**Model: TA2018A**  
**Rev No: 1**

**G. RECOMMENDED REFLOW PROFILE:**

1. Preheating shall be fixed at 150 ~ 180°C for 60 ~ 90 seconds.
2. Ascending time to preheating temperature 150°C shall be 30 seconds min.
3. Heating shall be fixed at 220°C for 50 ~ 80 seconds and at 260°C +0/-5°C peak (20 ~ 40 sec).
4. Time: 2 times.

