

SAW Filter 1120.0MHz
Part No: MP06877

Model: TA1773A
Rev No: 1

A. MAXIMUM RATING:

Electrostatic Sensitive Device (ESD)

1. Input Power Level: 10dBm
2. DC Voltage: 3V
3. Operating Temperature: -40°C to +85°C
4. Storage Temperature: -40°C to +85°C

B. ELECTRICAL CHARACTERISTICS:

Item	Unit	Min.	Typ.	Max.
Center Frequency Fc	MHz	-	1120	-
Insertion loss (1097.5 ~ 1142.5MHz) IL	dB	-	2.2	4.6
Amplitude ripple (1097.5 ~ 1142.5MHz)	dB	-	0.9	3.0
Group Delay ripple (1097.5 ~ 1142.5MHz)	ns	-	36	200
Attenuation (Reference level from 0dB)				
1065.5MHz	dB	24	42	-
1077.5MHz	dB	16	32	-
1162.5MHz	dB	16	21	-
1174.5MHz	dB	16	20	-
Temperature Coefficient of Frequency	ppm/°C	-	-36	-

C. MEASUREMENT CIRCUIT:

HP Network analyzer

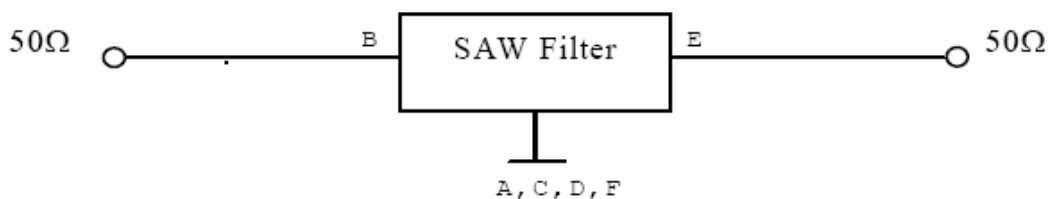

SAW Filter 1120.0MHz
Part No: MP06877

Model: TA1773A
Rev No: 1

D. OUTLINE DRAWING:

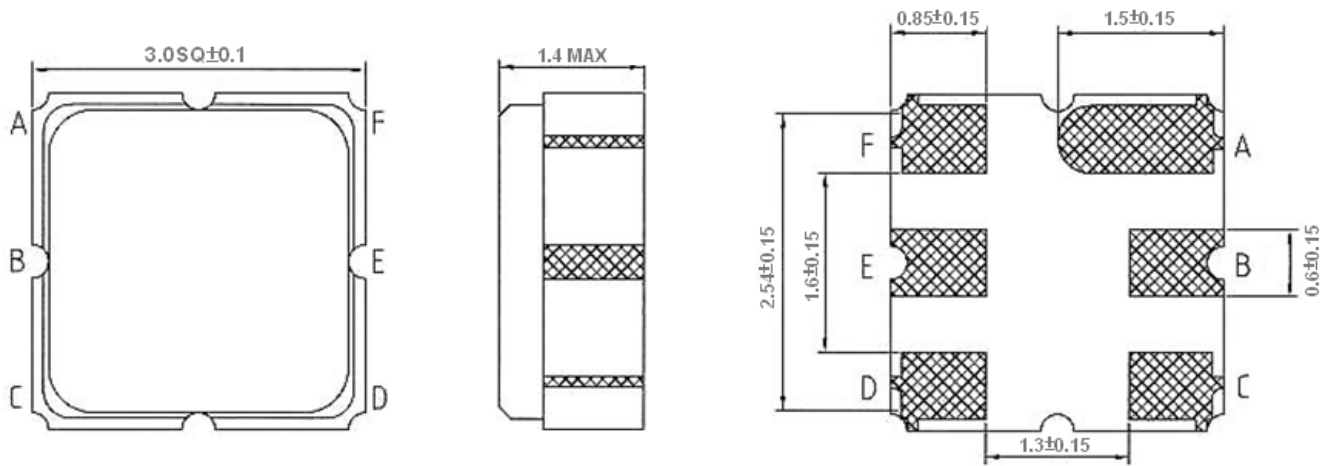

B: Input
E: Output
A, C, D, F: Ground
Unit: mm

E. PCB FOOTPRINT:

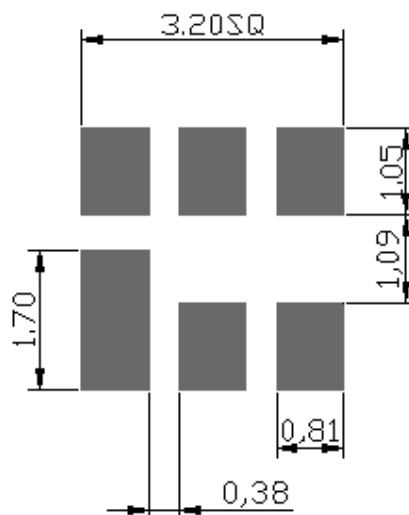

SAW Filter 1120.0MHz
Part No: MP06877

Model: TA1773A
Rev No: 1

F. FREQUENCY CHARACTERISTICS:

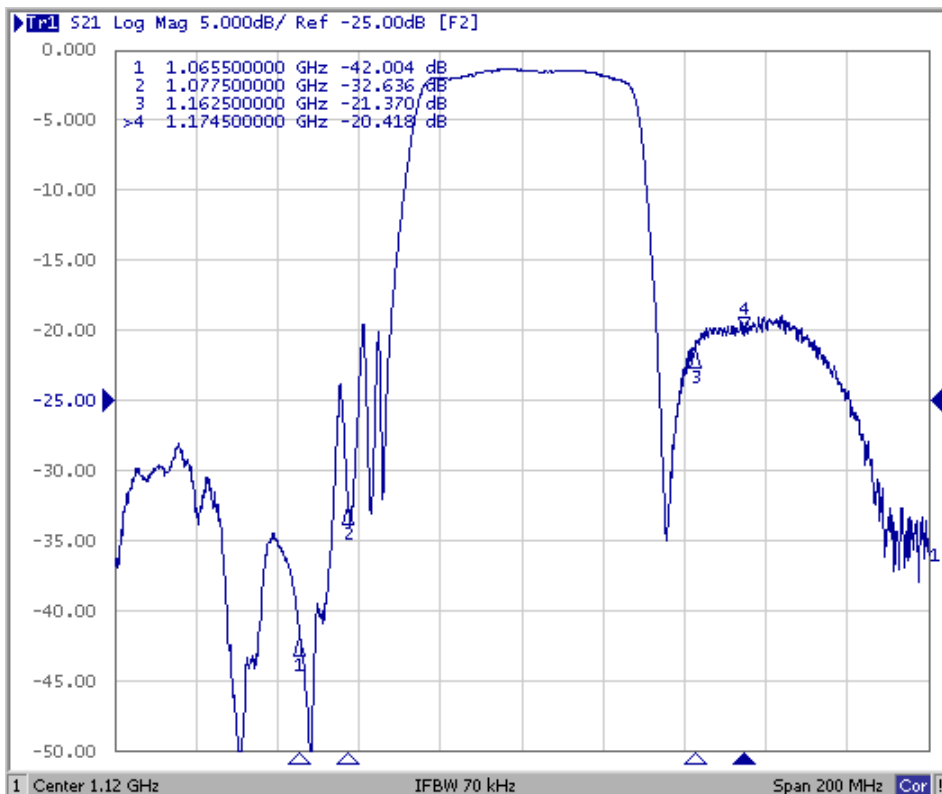
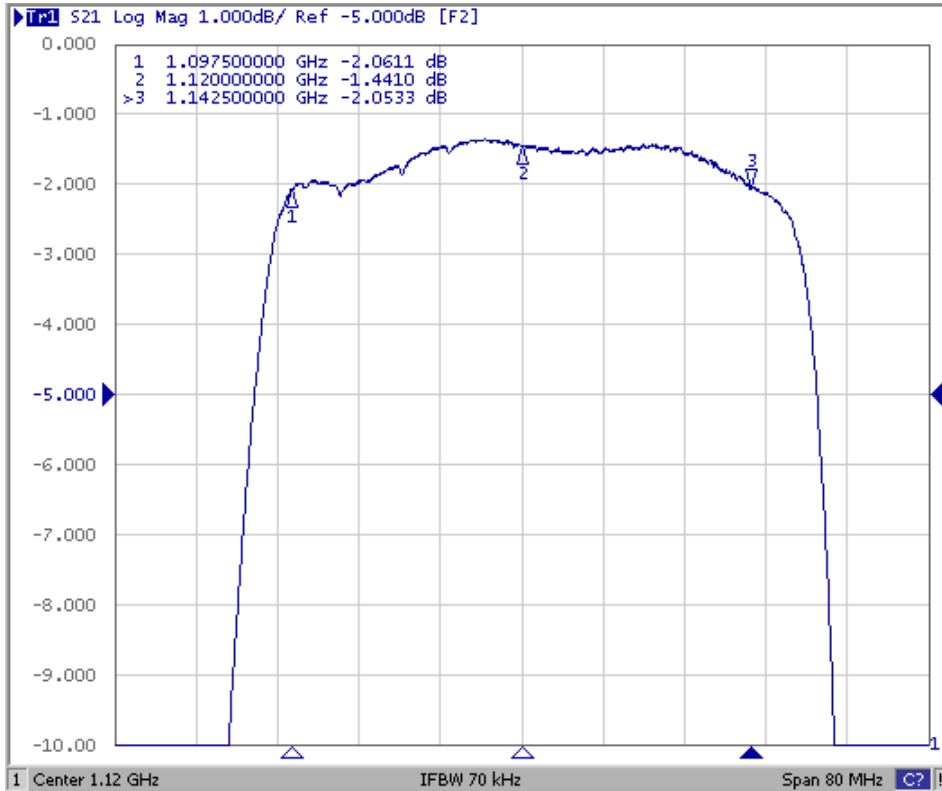

SAW Filter 1120.0MHz
Part No: MP06877

Model: TA1773A
Rev No: 1

G. PACKING:

1. Reel Dimension (Please refer to FR-75D10 for packing quantity)

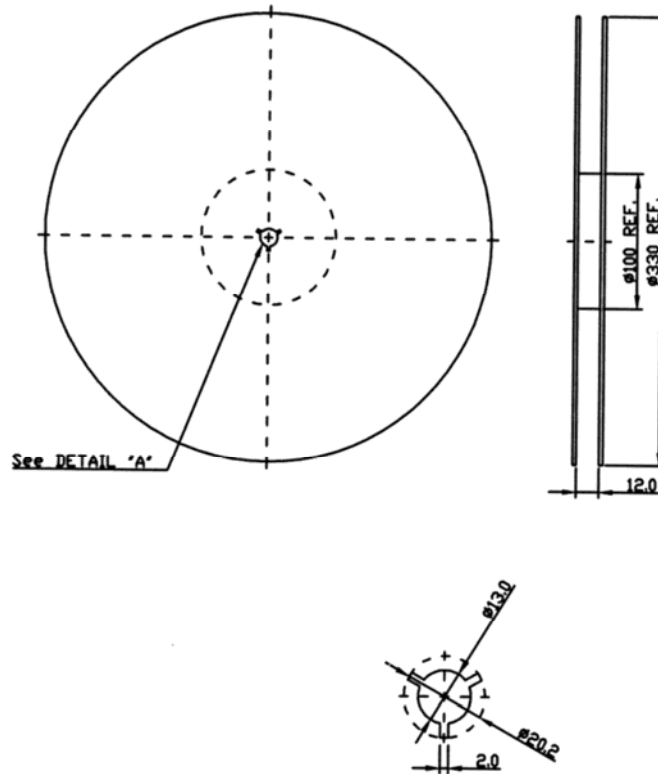

2. Tape Dimension

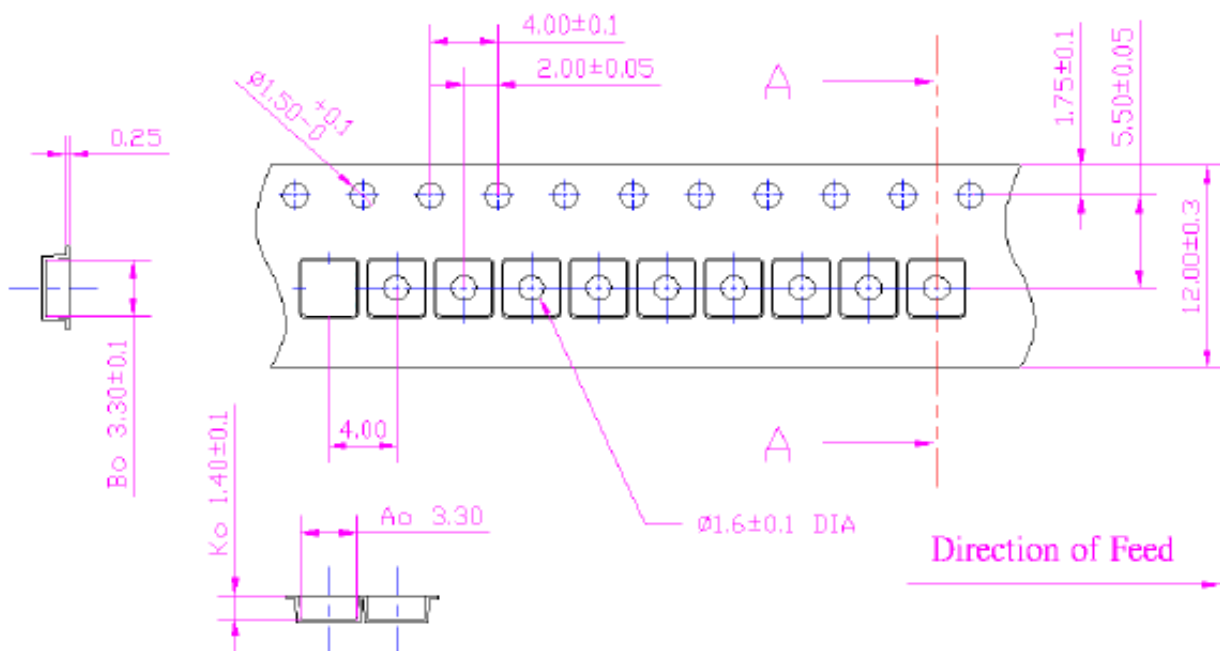

SAW Filter 1120.0MHz
Part No: MP06877

Model: TA1773A
Rev No: 1

H. RECOMMENDED REFLOW PROFILE:

