

**SAW Filter: 707.0MHz**  
**Part No: MP02075**

**Model: TA0941A**  
**Rev No: 1**

**A. MAXIMUM RATING:**

1. Input Power Level: 12 dBm
2. DC voltage: 3 V
3. Operating Temperature: -25°C to +70°C
4. Storage Temperature: -30°C to +85°C

**B. ELECTRICAL CHARACTERISTICS:**

Item	Min.	Typ.	Max.
Center frequency Fc (dB)	-	707	-
Insertion loss within 698 ~ 716MHz IL (dB)	-	1.9	3.5
Amplitude ripple (p - p) within 698 ~ 716MHz (dB)	-	0.4	1.5
Attenuation (Reference level from 0dB)			
728 ~ 750MHz (dB)	-	14	-
750 ~ 787MHz (dB)	38	45	-
1396 ~ 1433MHz (dB)	30	43	-
1710 ~ 2155MHz (dB)	28	38	-
VSWR within 698 ~ 716MHz	-	1.5	2.4
Source impedance Z <sub>S</sub> (Ω)	-	50	-
Load impedance Z <sub>L</sub> (Ω)	-	50	-

**SAW Filter: 707.0MHz**  
**Part No: MP02075**

**Model: TA0941A**  
**Rev No: 1**

**C. FREQUENCY CHARACTERISTICS:**

1. Wide band response: (span 200MHz)

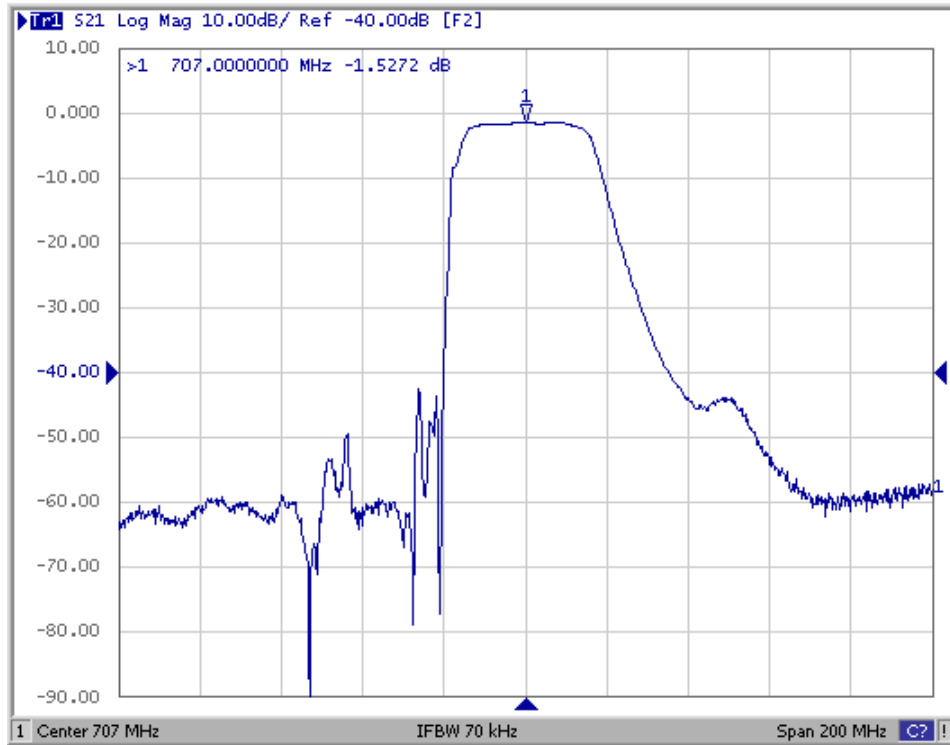

2. Pass band response: (300k ~ 3GHz)

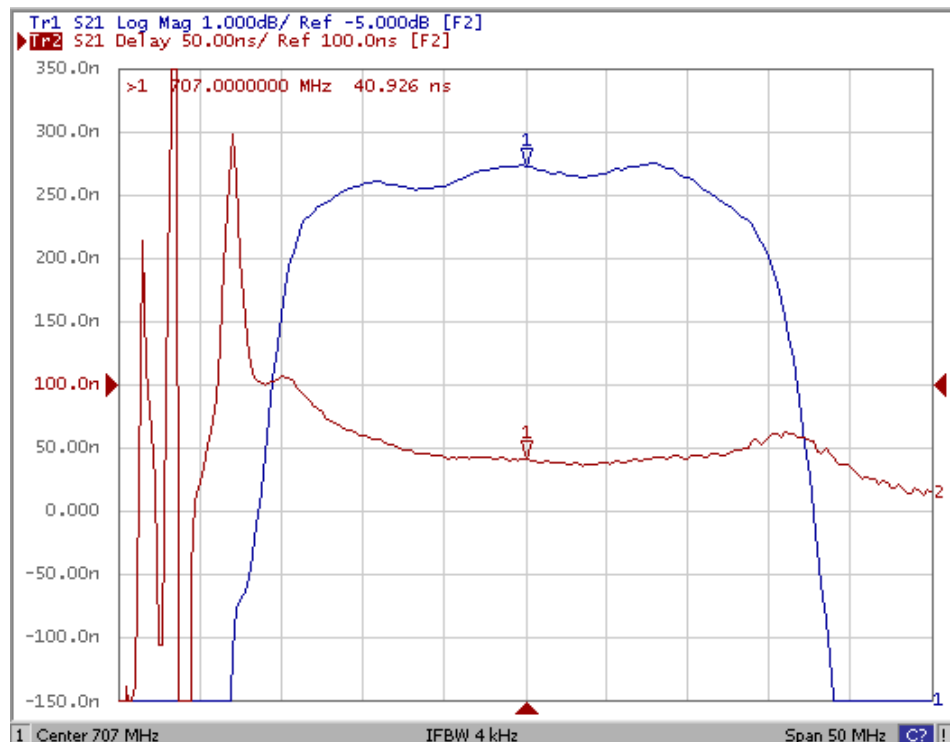

**SAW Filter: 707.0MHz**  
**Part No: MP02075**

**Model: TA0941A**  
**Rev No: 1**

3. Wide band response: (300k ~ 2.2GHz)

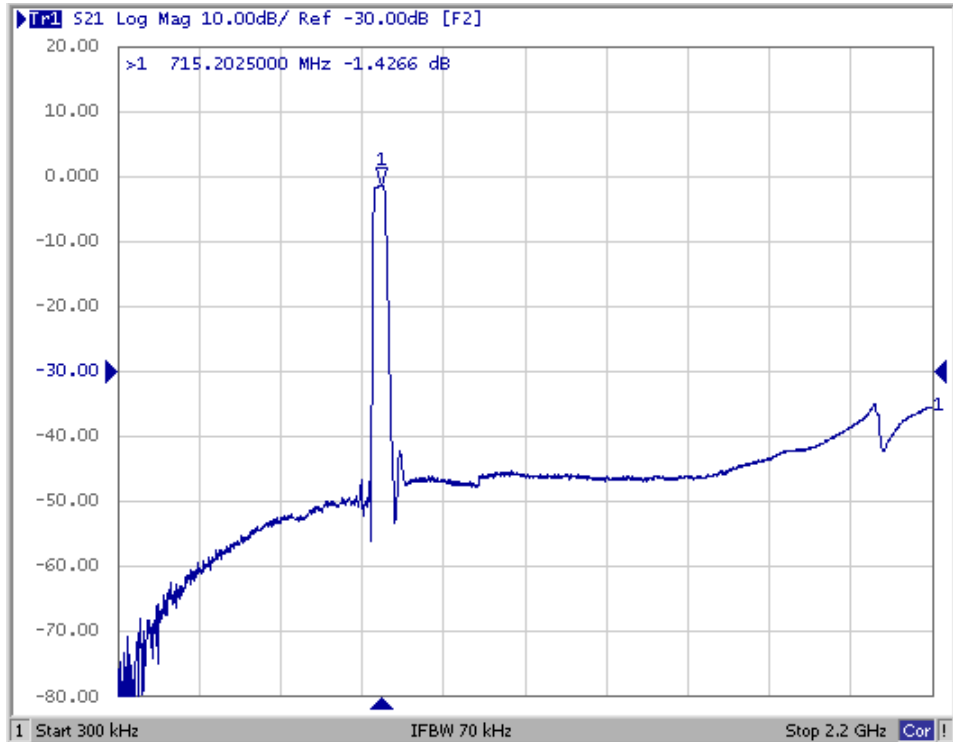

4. S11 and S22 VSWR Variation: (span 60MHz)

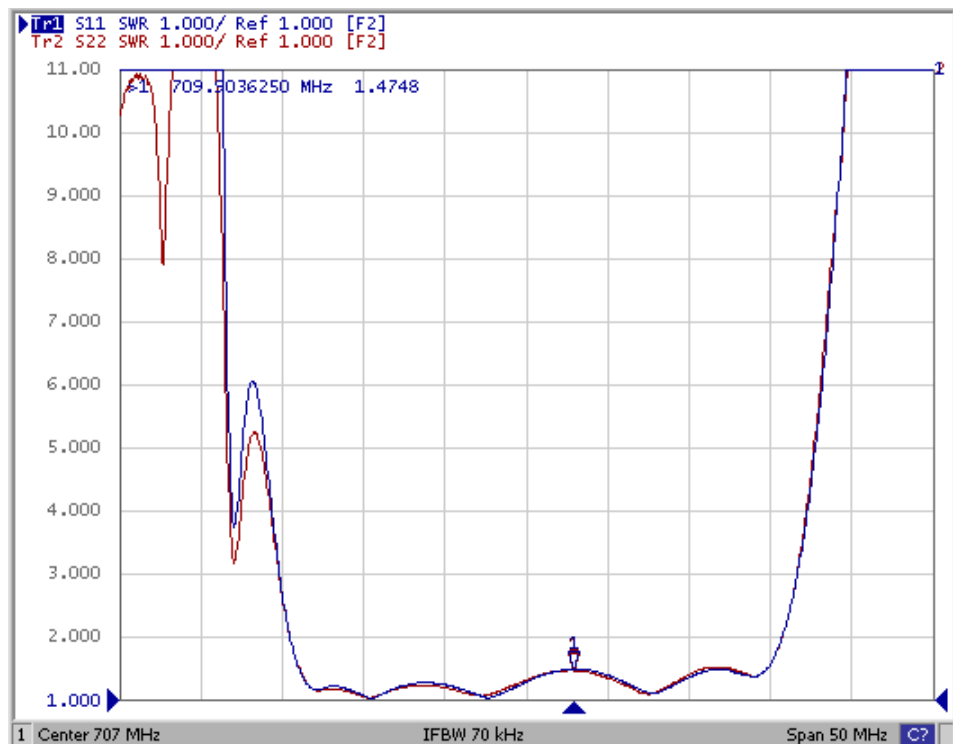

**SAW Filter: 707.0MHz**  
**Part No: MP02075**

**Model: TA0941A**  
**Rev No: 1**

**D. MEASUREMENT CIRCUIT:**

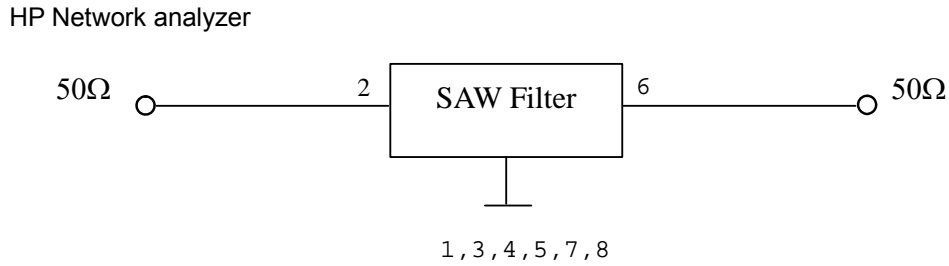

**E. OUTLINE DRAWING:**

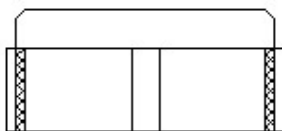
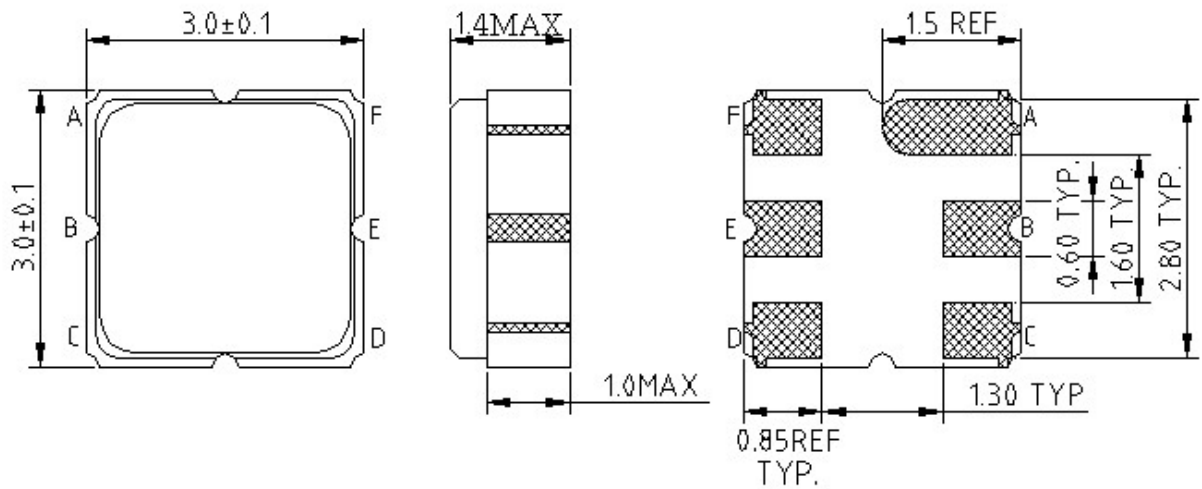

B: Input  
 E: Output  
 1, 3, 4, 5, 7, 8: Ground  
 Unit: mm

**SAW Filter: 707.0MHz**  
**Part No: MP02075**

**Model: TA0941A**  
**Rev No: 1**

**F. PACKING:**

1. Reel Dimension

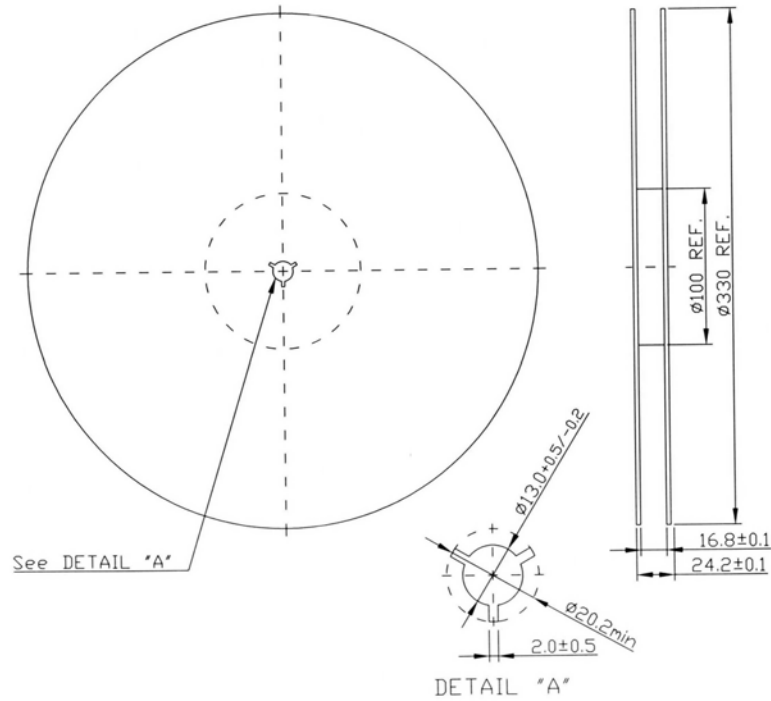

2. Tape Dimension

