

SAW Filter 446MHz
Part No: MP02813

Model: TA0606A
Rev. No: 1

A. MAXIMUM RATING:

1. Input Power Level: 10dBm
2. DC voltage: 3V
3. Operating Temperature: -10°C to +50°C
4. Storage Temperature: -40°C to +85°C

B. ELECTRICAL CHARACTERISTICS:

Item	Min.	Typ.	Max.
Center frequency Fc MHz	-	446	-
Insertion loss (Fc ± 4MHz) IL (dB)	-	2.3	4.5
Amplitude ripple (Fc ± 4MHz) (dB)	-	0.3	2.5
Attenuation (Reference level from 0dB)			
Fc -100 ~ Fc -40.8MHz (dB)	43	50	-
Fc +40 ~ Fc +100MHz (dB)	38	44	-
Source impedance ZS (Ω)	-	50	-
Load impedance ZL (Ω)	-	50	-

Note: No matching network required for operation at 50Ω

C. MEASUREMENT CIRCUIT:

HP Network analyzer

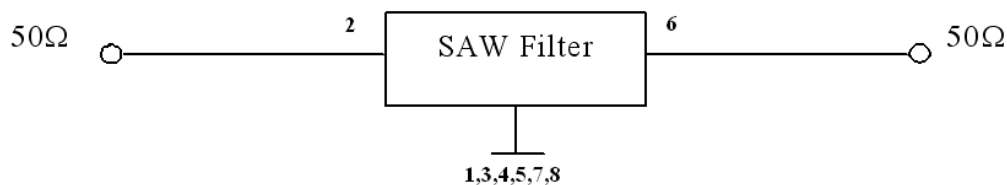

SAW Filter 446MHz
Part No: MP02813

Model: TA0606A
Rev. No: 1

D. FREQUENCY CHARACTERISTICS:

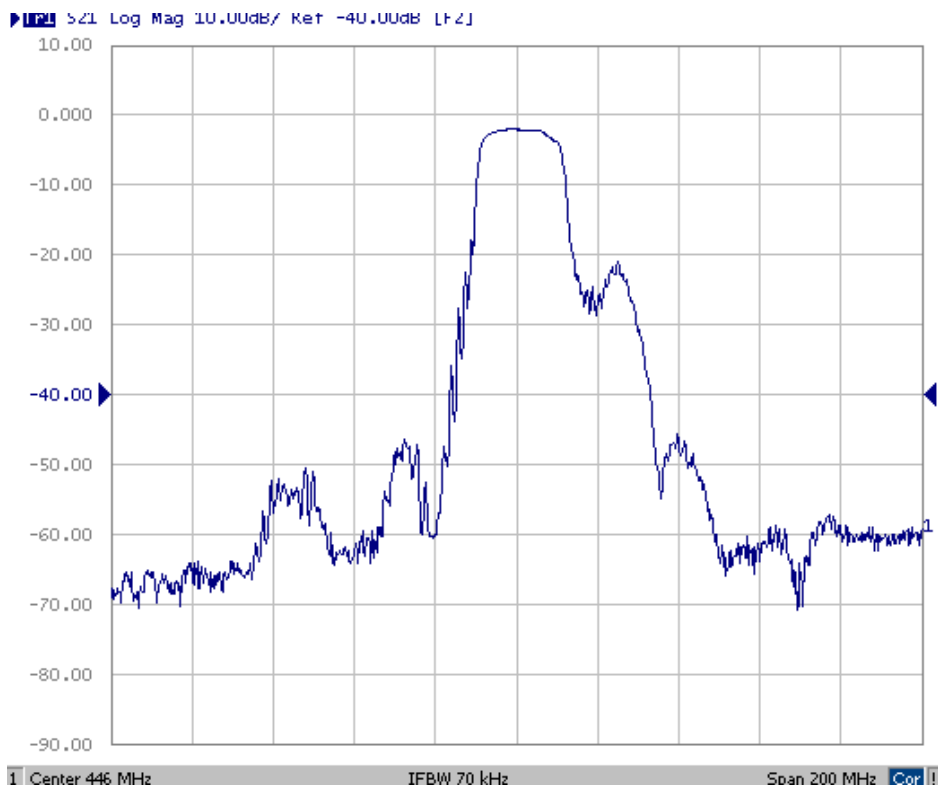
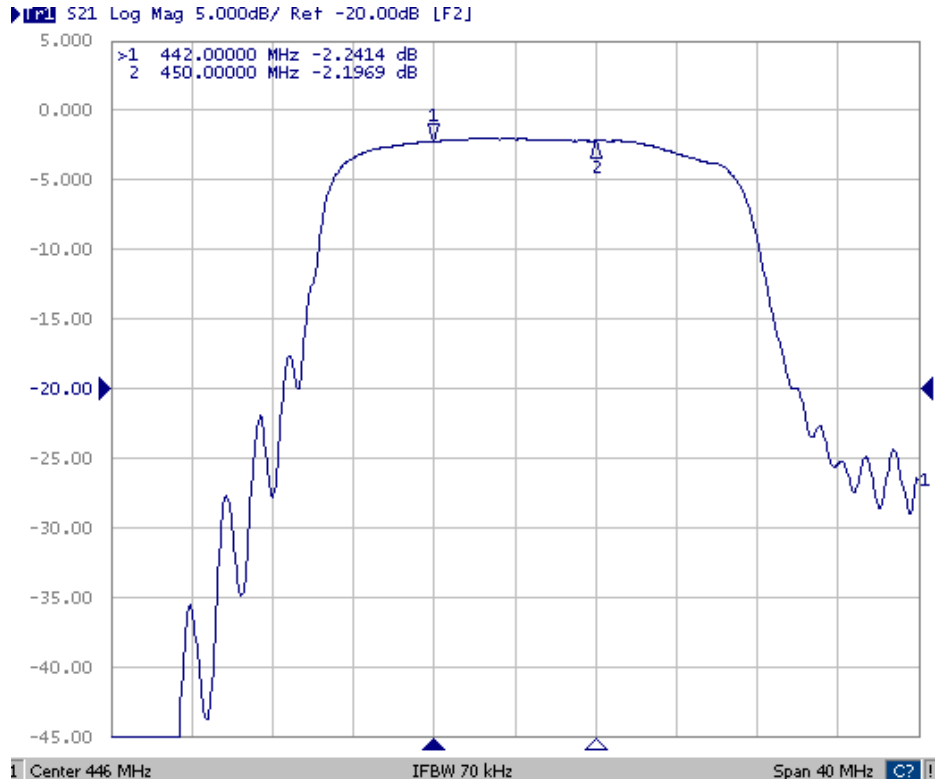

SAW Filter 446MHz
Part No: MP02813

Model: TA0606A
Rev. No: 1

E. OUTLINE DRAWING:

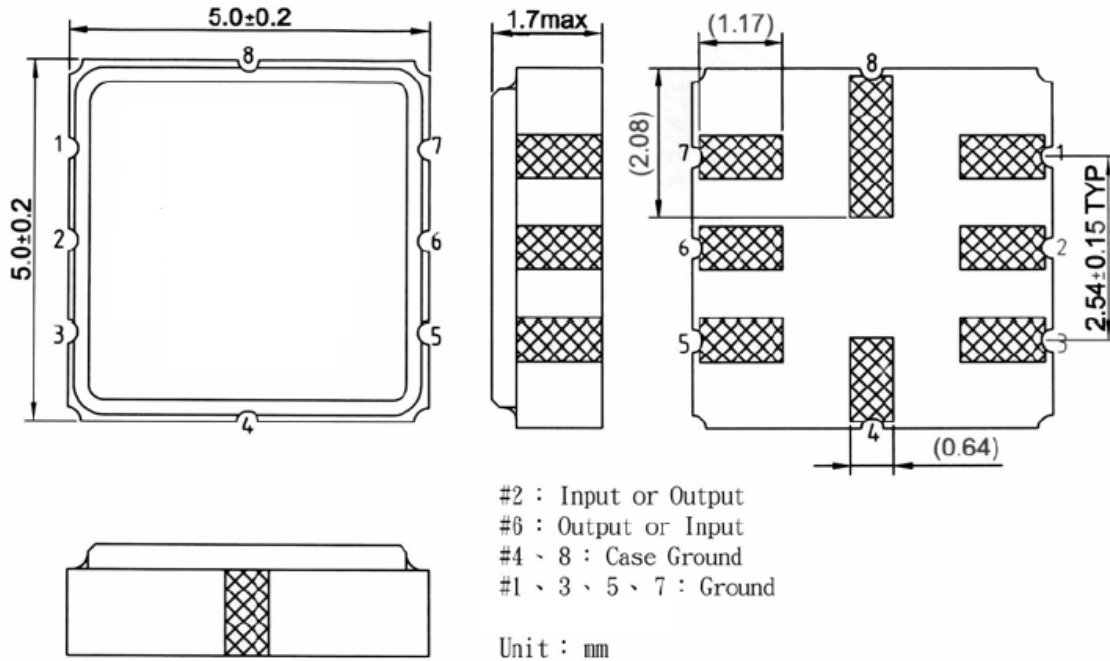

F. PCB FOOTPRINT:

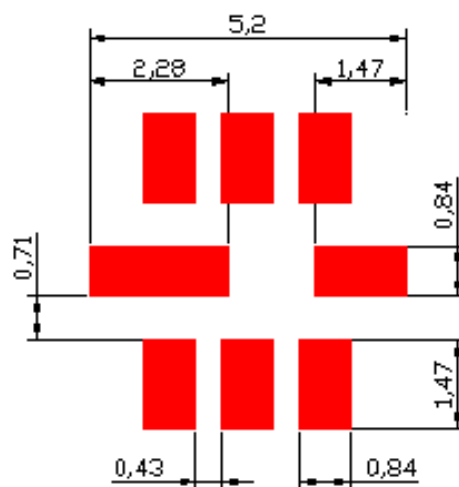

SAW Filter 446MHz
Part No: MP02813

Model: TA0606A
Rev. No: 1

G. PACKING:

1. Reel Dimension

7" = 1000, 13" = 3000

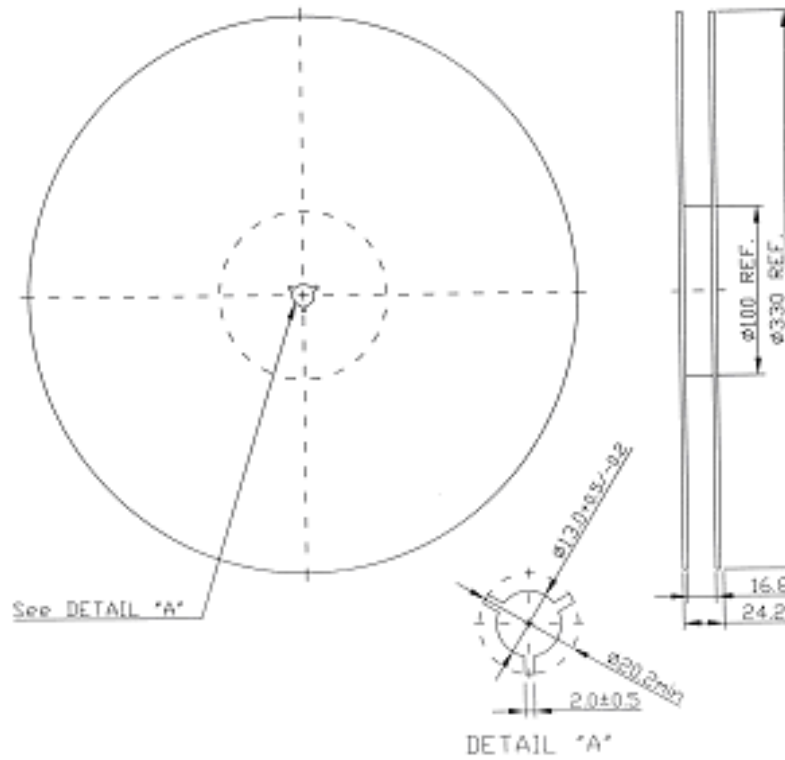

2. Tape Dimension

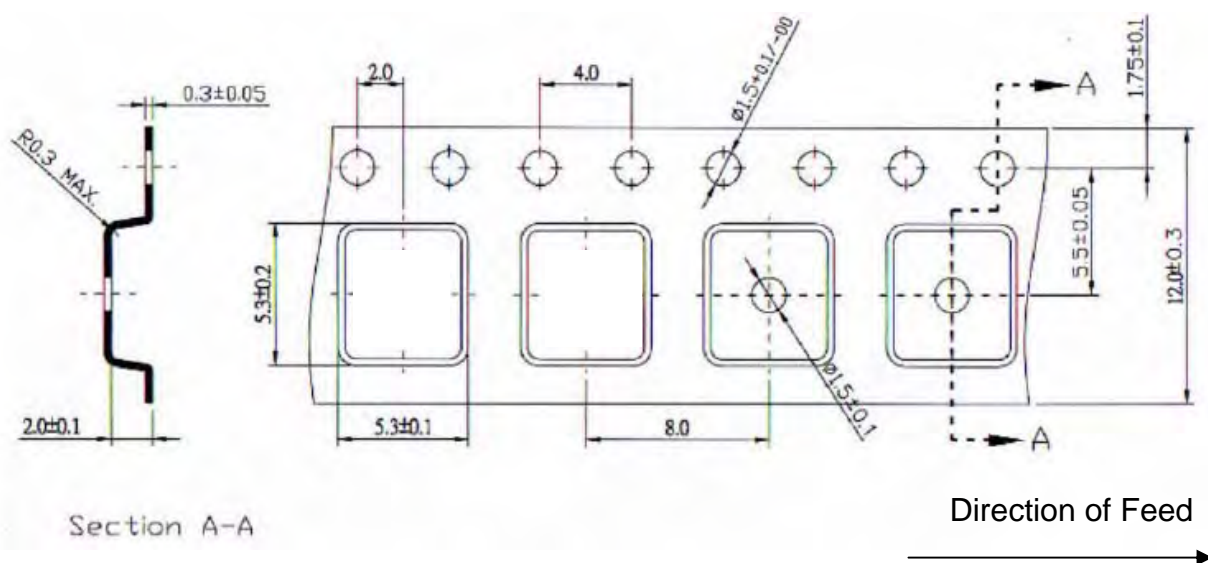

SAW Filter 446MHz
Part No: MP02813

Model: TA0606A
Rev. No: 1

H. RECOMMENDED REFLOW PROFILE:

