

**SAW Filter 869.0MHz**  
**Part No: MA05505**

**Model: TA0296A**  
**Rev No: 2**

**A. MAXIMUM RATING:**

1. Input Power Level: 17dBm
2. DC voltage: 3V
3. Operating Temperature: -10°C to +60°C
4. Storage Temperature: -40°C to +85°C

**B. ELECTRICAL CHARACTERISTICS:**

Item	Unit	Min.	Typ.	Max.
Center Frequency	MHz	-	869	-
Insertion Loss 868 ~ 870MHz	dB	-	2.8	4.0
Ripple 868 ~ 870MHz	dB	-	0.2	1.5
Absolute Attenuation				
825 ~ 828MHz	dB	40	47	-
835 ~ 842MHz	dB	30	39	-
891 ~ 894MHz	dB	30	42	-
910 ~ 913MHz	dB	40	47	-
Source impedance $Z_S$	$\Omega$	-	50	-
Load impedance $Z_L$	$\Omega$	-	50	-

Note 1: No matching network required for operation at 50 $\Omega$ .

**SAW Filter 869.0MHz**  
**Part No: MA05505**

**Model: TA0296A**  
**Rev No: 2**

**C. FREQUENCY CHARACTERISTICS:**

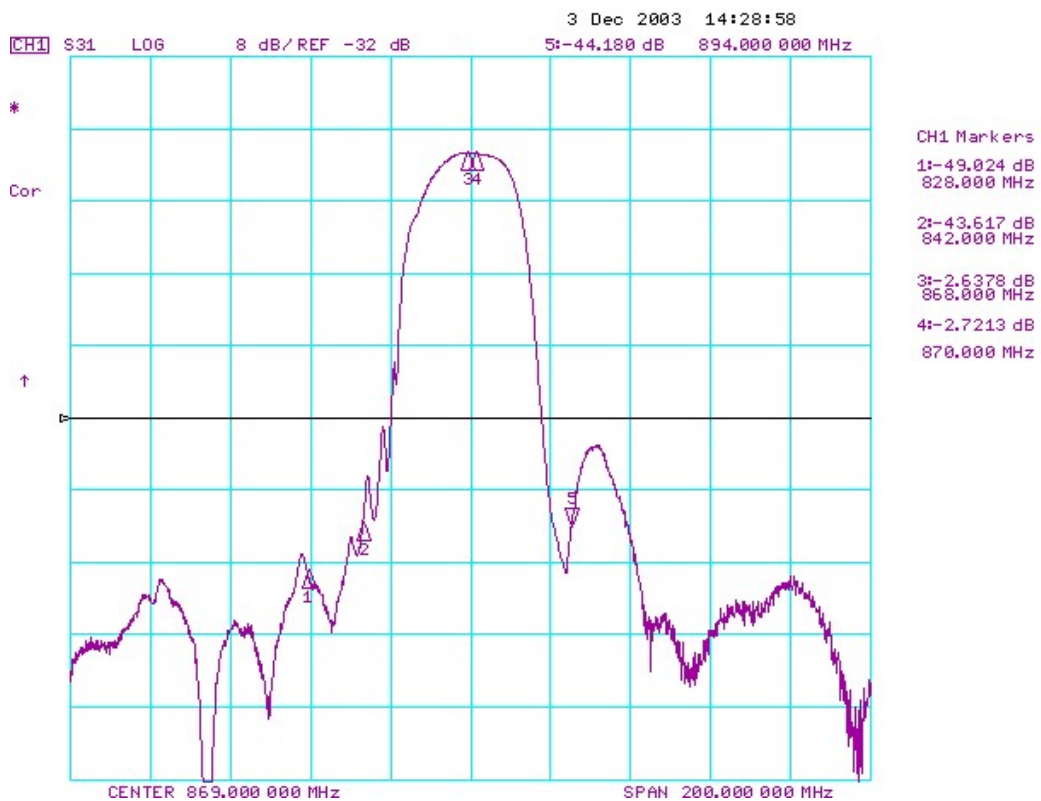
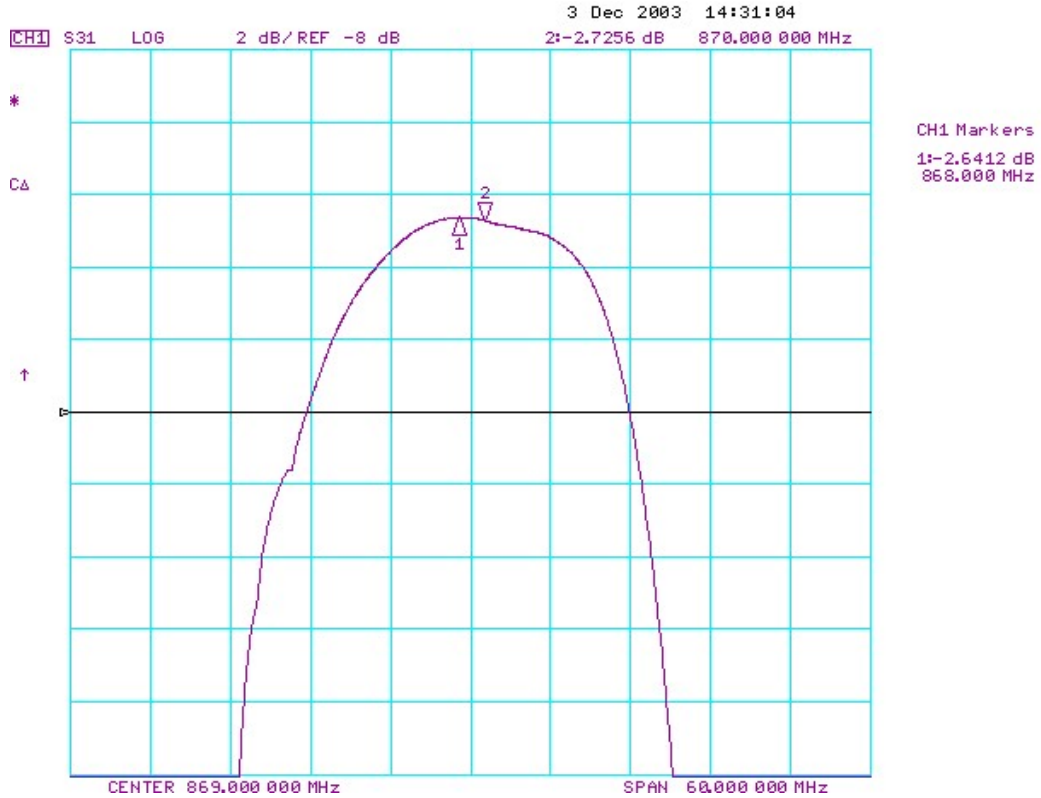

**SAW Filter 869.0MHz**  
**Part No: MA05505**

**Model: TA0296A**  
**Rev No: 2**

Wideband

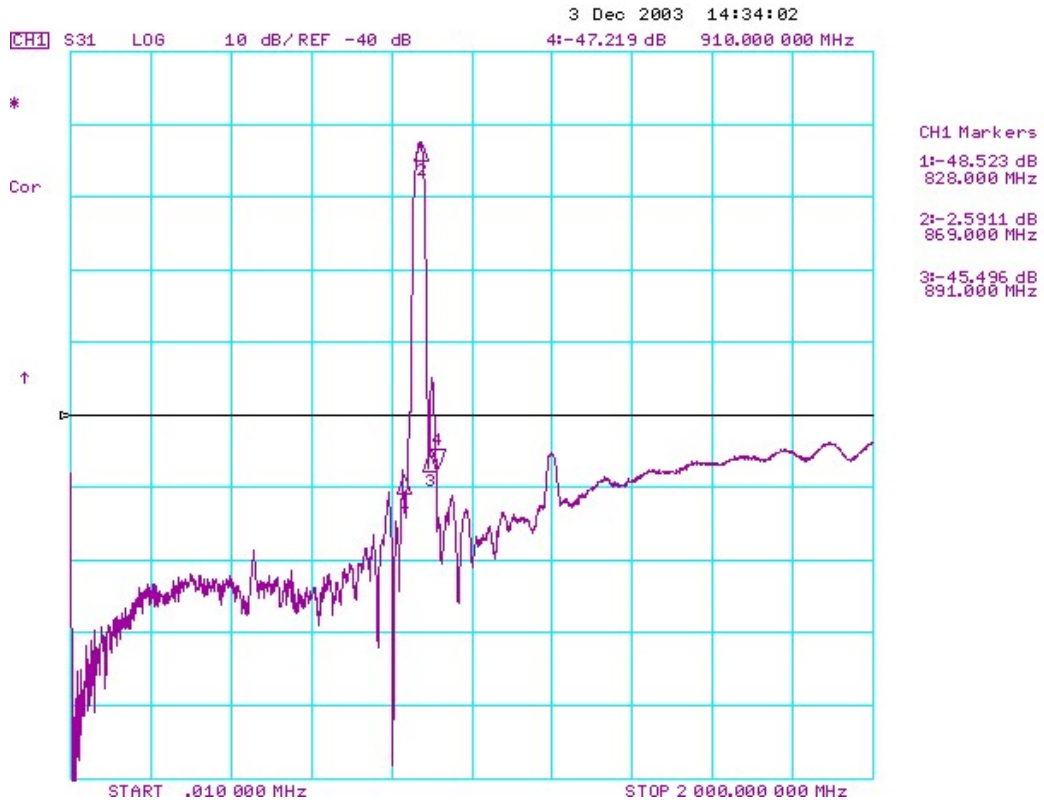

**D. MEASUREMENT CIRCUIT:**

HP Network analyzer

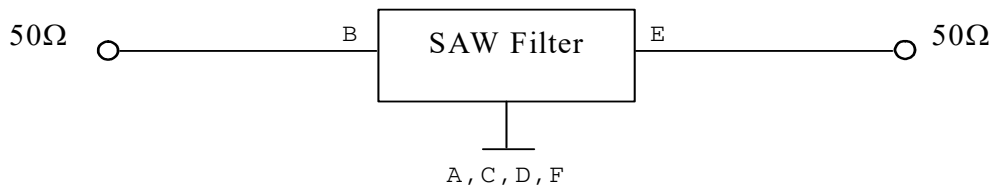

**SAW Filter 869.0MHz**  
**Part No: MA05505**

**Model: TA0296A**  
**Rev No: 2**

**E. PCB FOOTPRINT:**

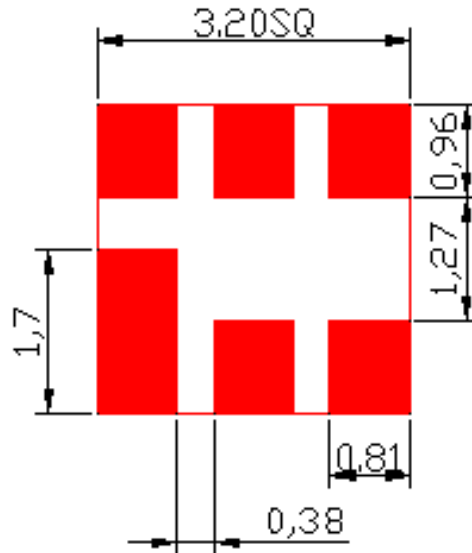

**F. OUTLINE DRAWING:**

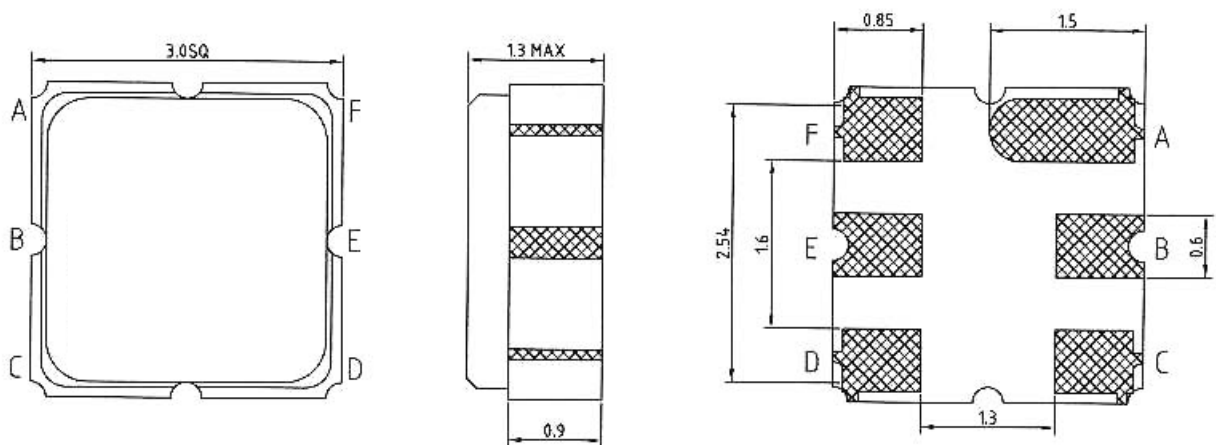

B: Input  
 E: Output  
 A, C, D, F: Ground  
 Unit: mm

**SAW Filter 869.0MHz**  
**Part No: MA05505**

**Model: TA0296A**  
**Rev No: 2**

**G. PACKING:**

1. Reel Dimension

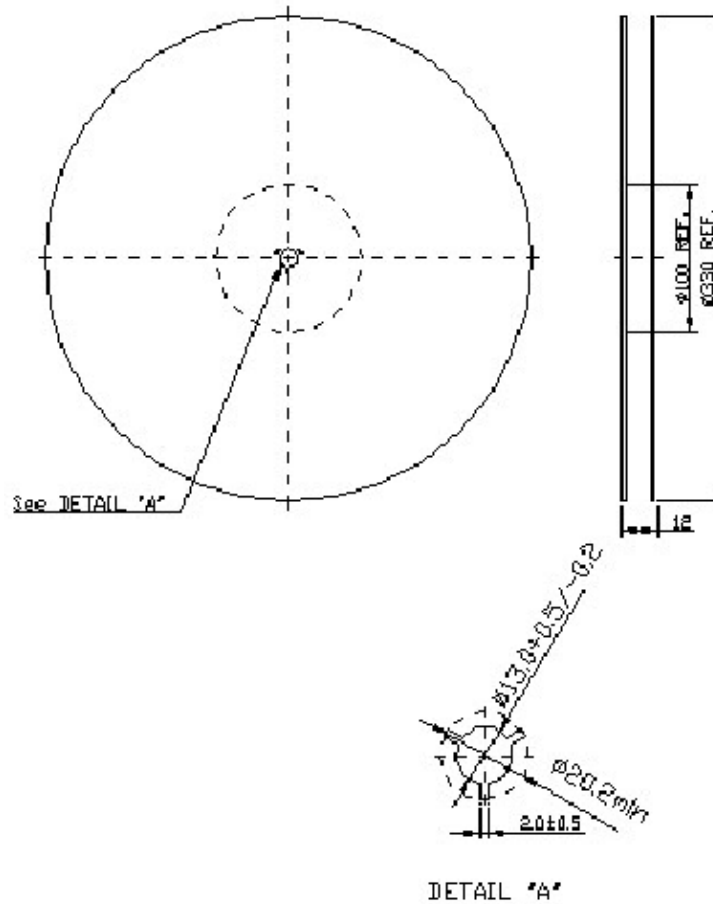

2. Tape Dimension

