

SAW Filter 221.60MHz
Part No: MP09188

Model: TA0576B
Rev No: 1

A. MAXIMUM RATING:

Electrostatic Sensitive Device (ESD)

1. Input Power Level: 20dBm
2. DC voltage: 5V
3. Operating Temperature: -40°C to +85°C
4. Storage Temperature: -40°C to +85°C

B. ELECTRICAL CHARACTERISTICS:

Item	Unit	Min.	Typ.	Max.
Center frequency Fc	MHz	-	221.6	-
Minimum Insertion Loss IL min (reference level)	dB	-	1.95	3.0
Amplitude ripple 218.1 ~ 225.1MHz	dB	-	1.1	2.2
3dB Bandwidth BW -3dB	MHz	7	10	-
Attenuation (Reference level from IL min)				
10 ~ Fc - 35MHz	dB	38	43	-
Fc + 35 ~ 500MHz	dB	38	50	-
Source impedance Z _S	Ω	-	50	-
Load impedance Z _L	Ω	-	50	-

Note: IL min is the minimum of the pass band attenuation. The center frequency Fc is the mean value of the upper and lower frequencies at the 3dB filter attenuation level relative to the IL min.

C. MEASUREMENT CIRCUIT:

HP Network analyzer

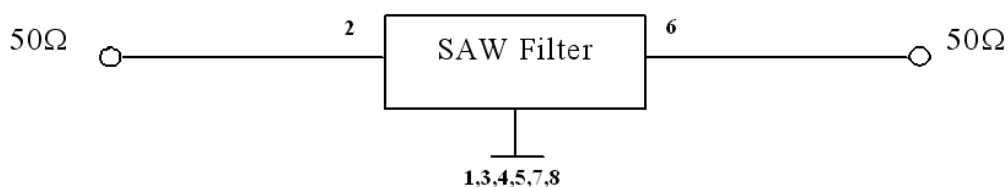

SAW Filter 221.60MHz
Part No: MP09188

Model: TA0576B
Rev No: 1

D. FREQUENCY CHARACTERISTICS:

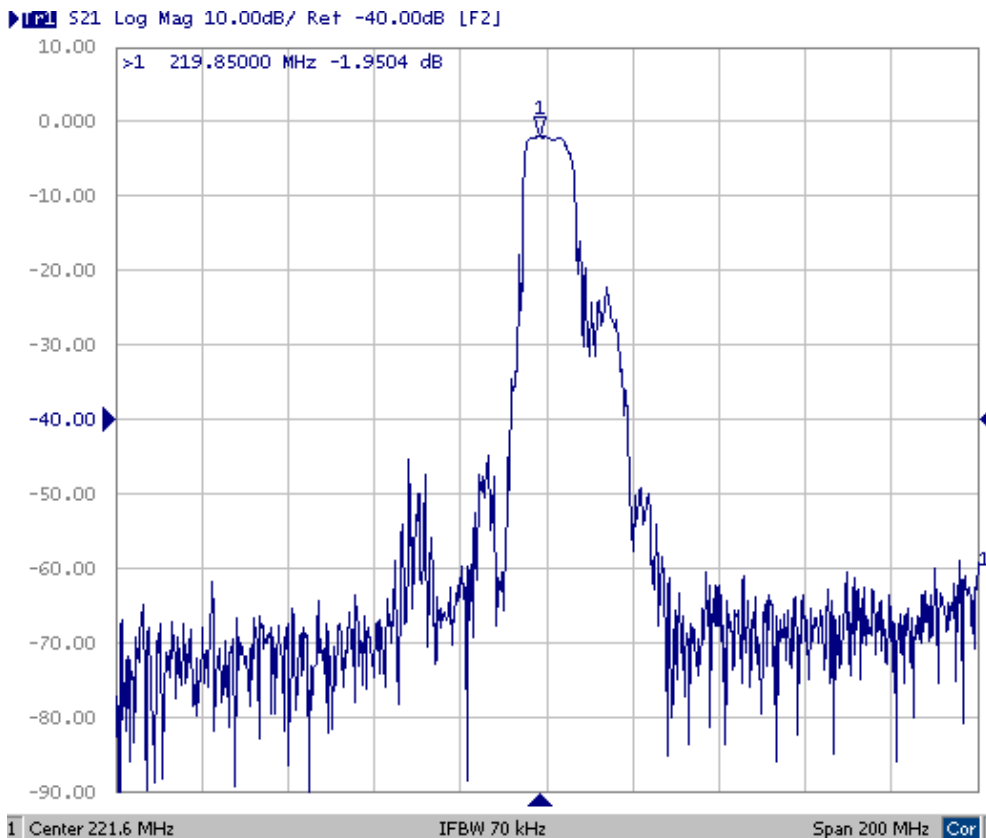
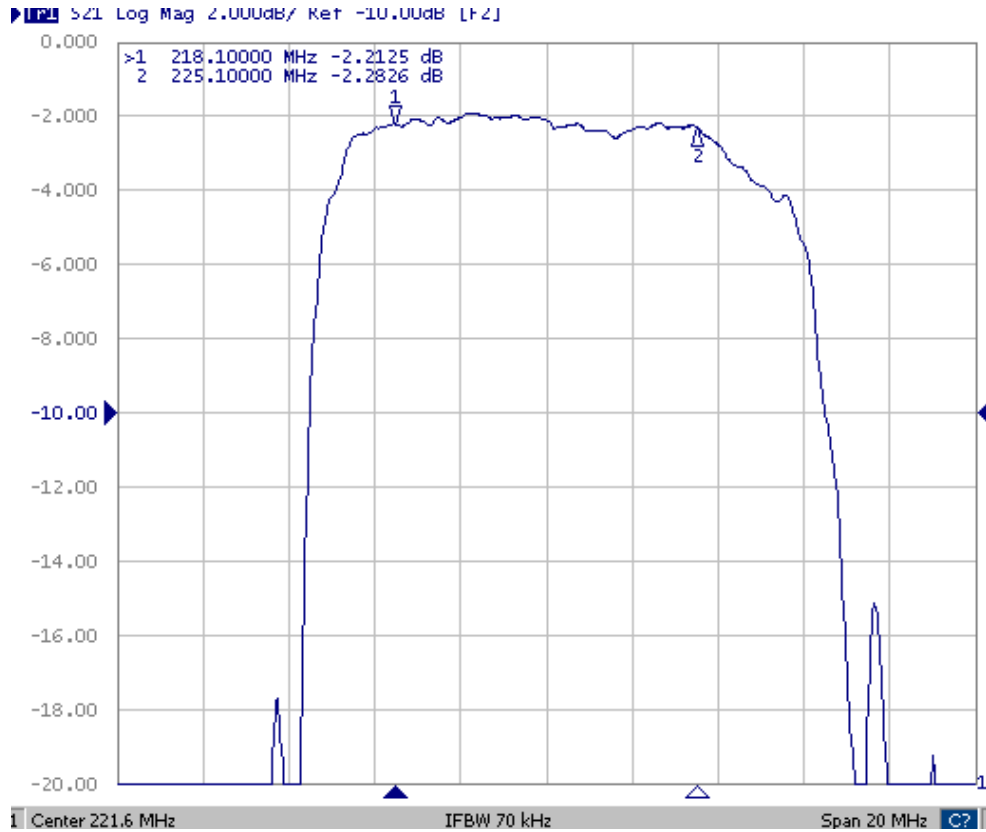

SAW Filter 221.60MHz
Part No: MP09188

Model: TA0576B
Rev No: 1

E. OUTLINE DRAWING:

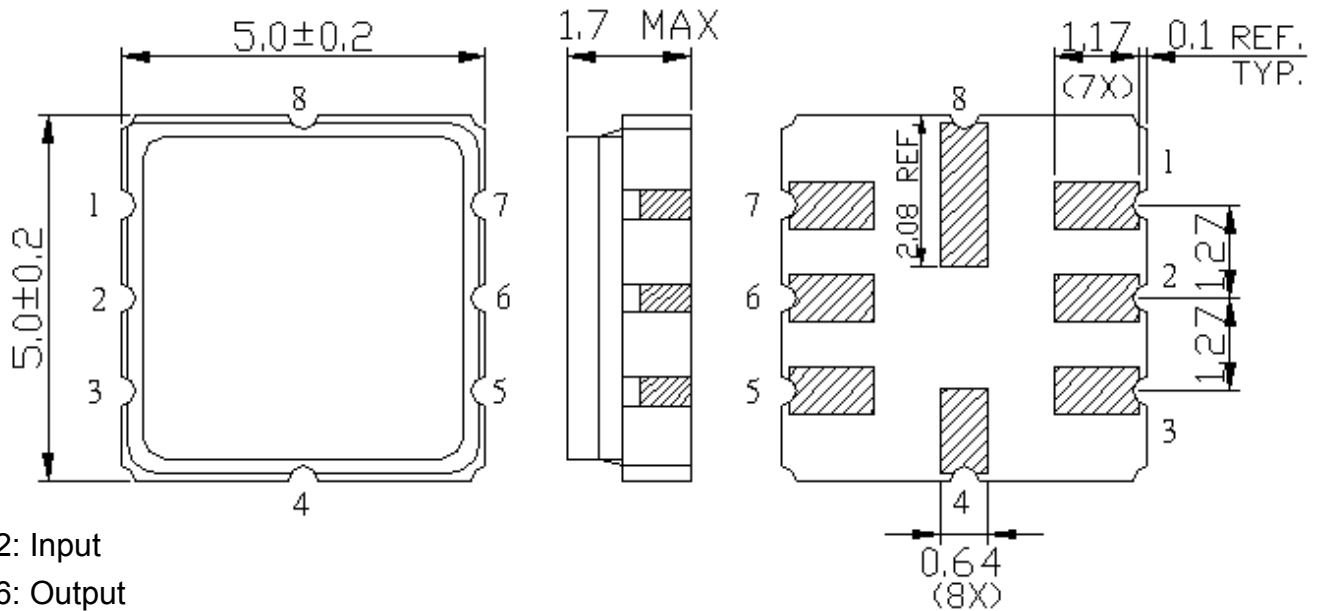

- 2: Input
 - 6: Output
 - 4, 8: Case Ground
 - 1, 3, 5, 7: Ground
- Unit: mm

F. PCB FOOTPRINT:

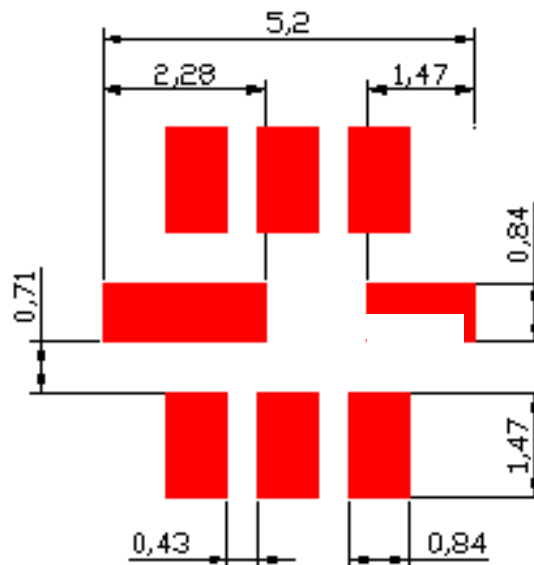

SAW Filter 221.60MHz
Part No: MP09188

Model: TA0576B
Rev No: 1

G. PACKING:

1. Reel Dimension

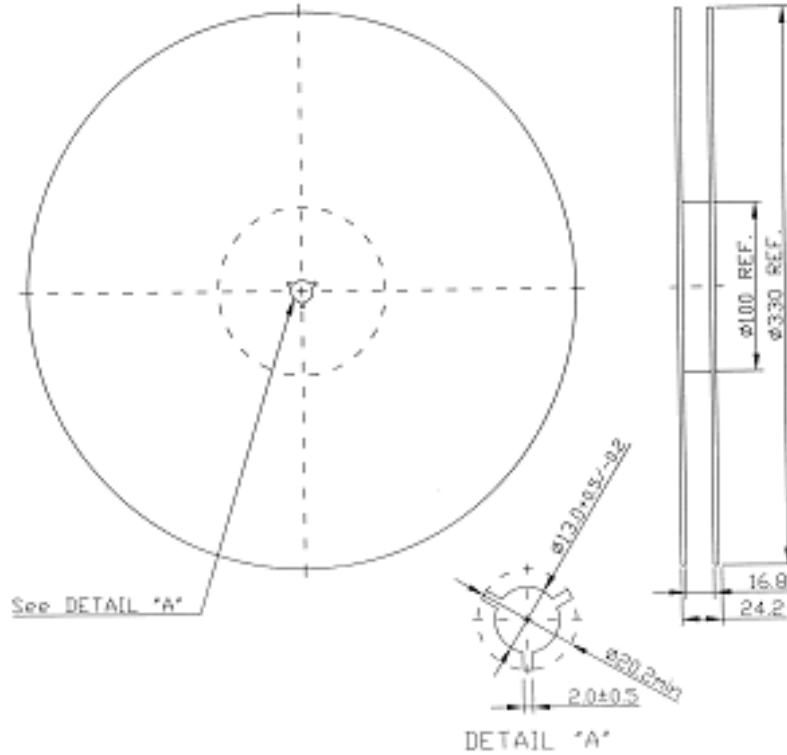

2. Tape Dimension

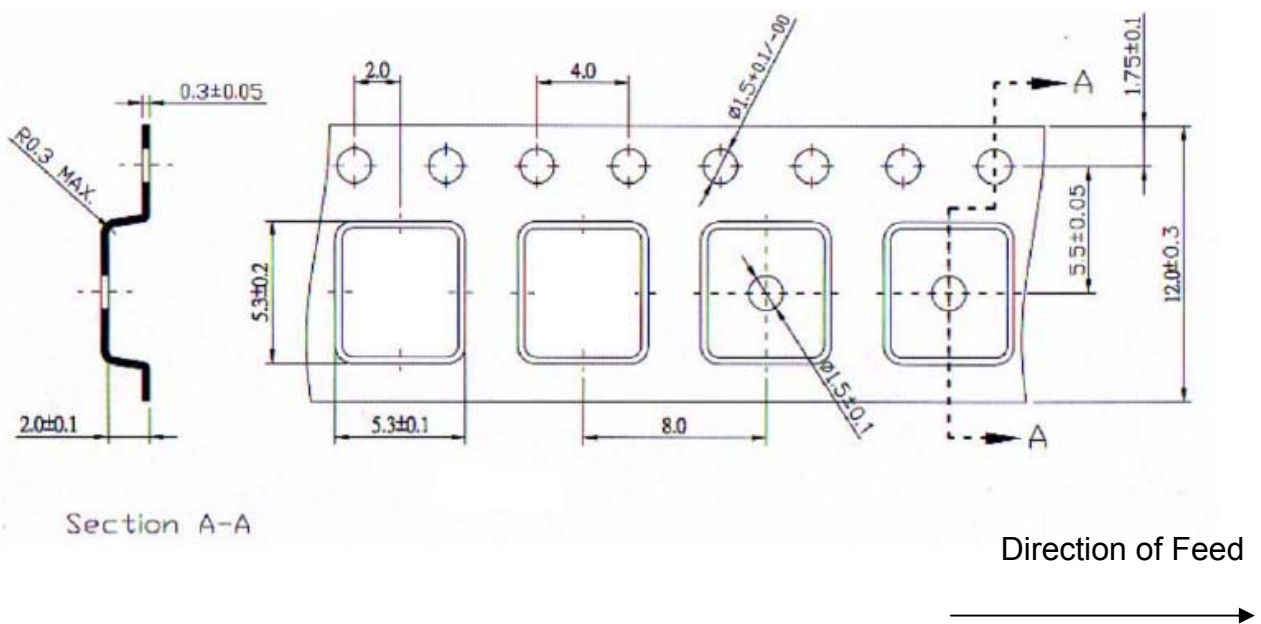

SAW Filter 221.60MHz
Part No: MP09188

Model: TA0576B
Rev No: 1

H. RECOMMENDED REFLOW PROFILE:

1. Preheating shall be fixed at 150 ~ 180°C for 60 ~ 90 seconds.
2. Ascending time to preheating temperature 150°C shall be 30 seconds min.
3. Heating shall be fixed at 220°C for 50 ~ 80 seconds and at 245 ~ 260°C peak (min. 10 sec).
4. Time: 2 times.

