

SAW Filter 1570.0MHz
Part No: MP07626

Model: TA1703A
Rev No: 1

A. MAXIMUM RATING:

Electrostatic Sensitive Device (ESD)

1. Input Power Level: 10dBm
2. DC voltage: 3V
3. Operating Temperature: -40°C to +85°C
4. Storage Temperature: -40°C to +85°C

B. ELECTRICAL CHARACTERISTICS:

Item	Unit	Min.	Typ.	Max.
Center frequency Fc	MHz	-	1570	-
Insertion loss (1530 ~ 1610MHz) IL	dB	-	3.6	4.2
Pass Band Ripple (1530 ~ 1610MHz)	dB	-	1.3	2.2
Group Delay Variation (1530 ~ 1610MHz)	ns	-	4	30
Return loss (1530 ~ 1610MHz)	dB	6	7.5	-
Attenuation (Reference level from 0dB)				
50 ~ 1370MHz	dB	20	28	-
1700 ~ 2000MHz	dB	10	24	-
Temperature Coefficient of Frequency	ppm/°C	-	-80	-

C. MEASUREMENT CIRCUIT:

HP Network analyzer

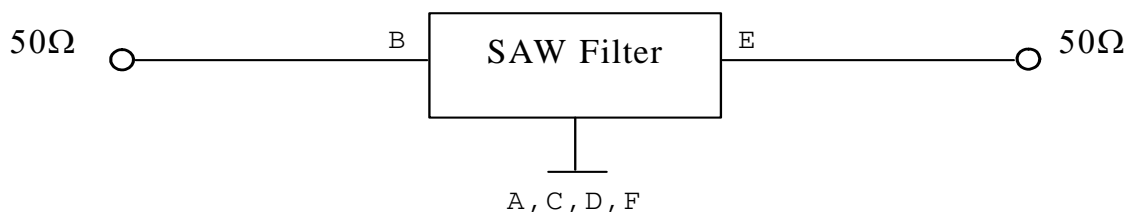

SAW Filter 1570.0MHz
Part No: MP07626

Model: TA1703A
Rev No: 1

D. FREQUENCY CHARACTERISTICS:

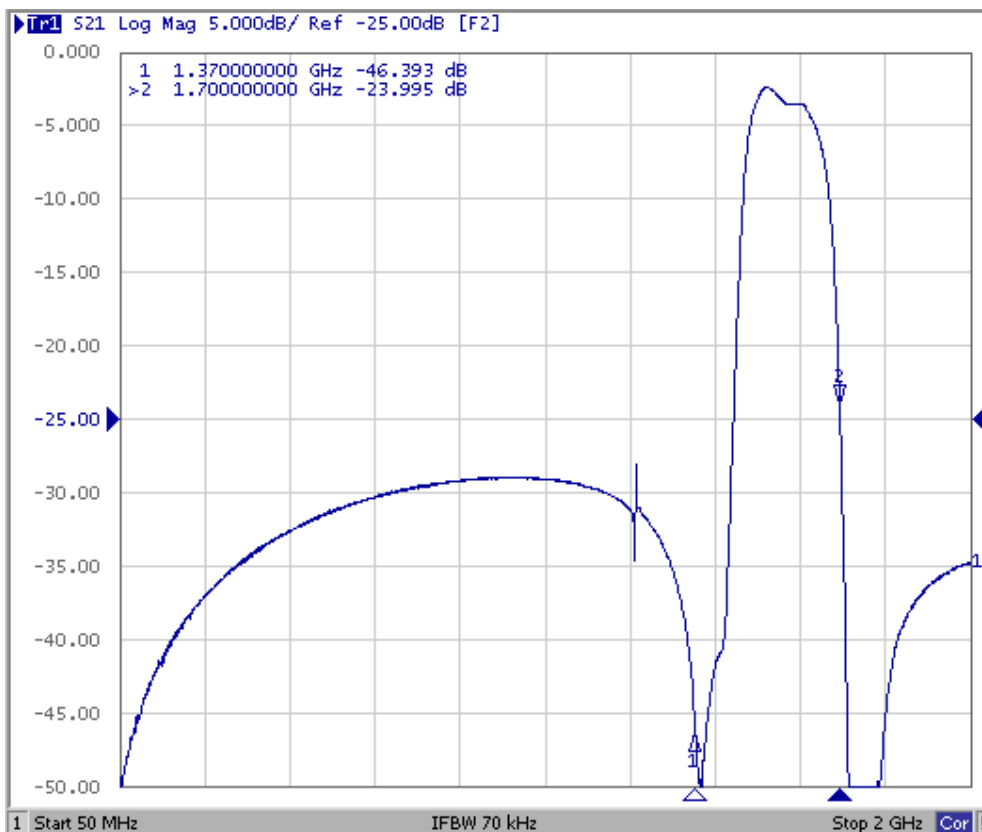
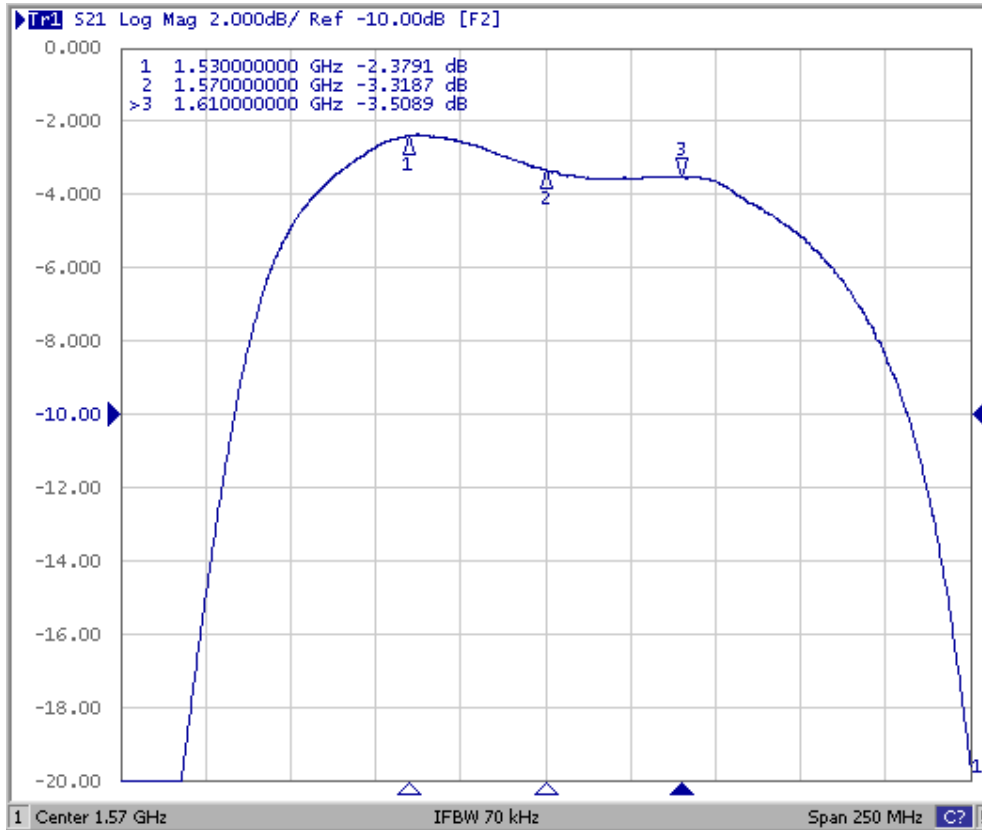

SAW Filter 1570.0MHz
Part No: MP07626

Model: TA1703A
Rev No: 1

Reflection Functions

S11

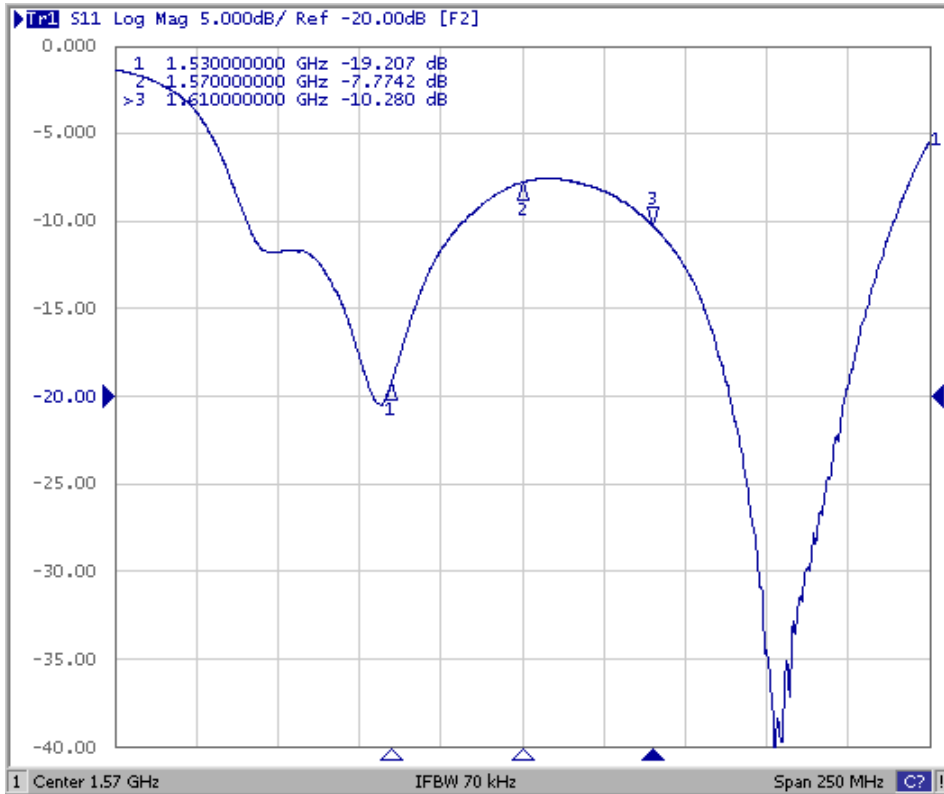

S22

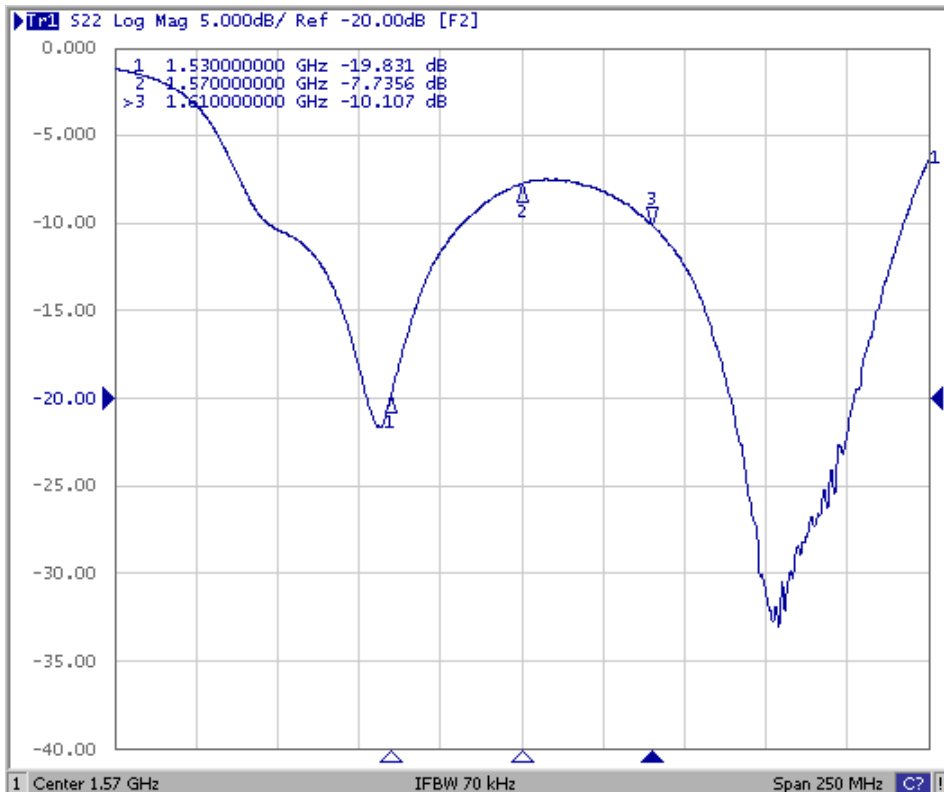

SAW Filter 1570.0MHz
Part No: MP07626

Model: TA1703A
Rev No: 1

E. OUTLINE DRAWING:

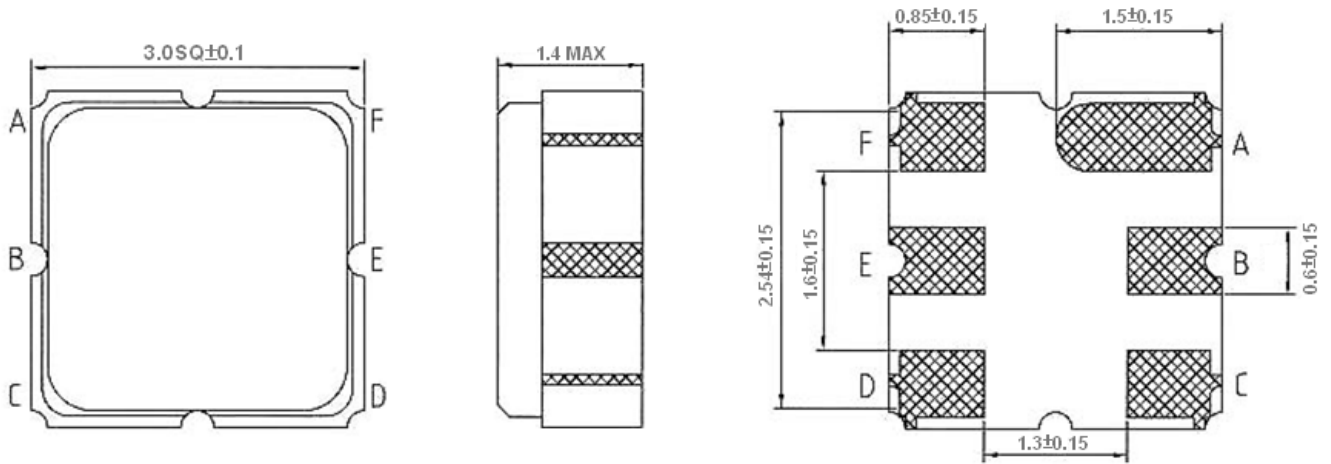

B: Input
E: Output
A, C, D, F: Ground
Unit: mm

F. PCB FOOTPRINT:

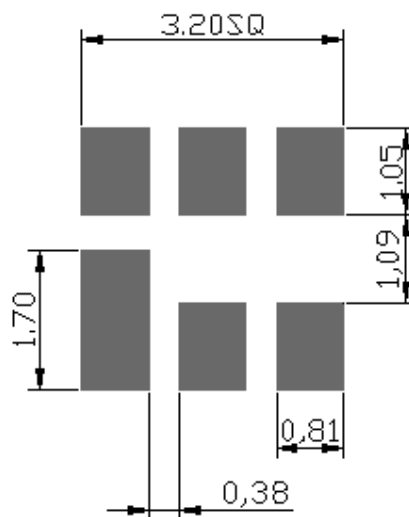

SAW Filter 1570.0MHz
Part No: MP07626

Model: TA1703A
Rev No: 1

G. PACKING:

1. Reel Dimension (Please refer to FR-75D10 for packing quantity)

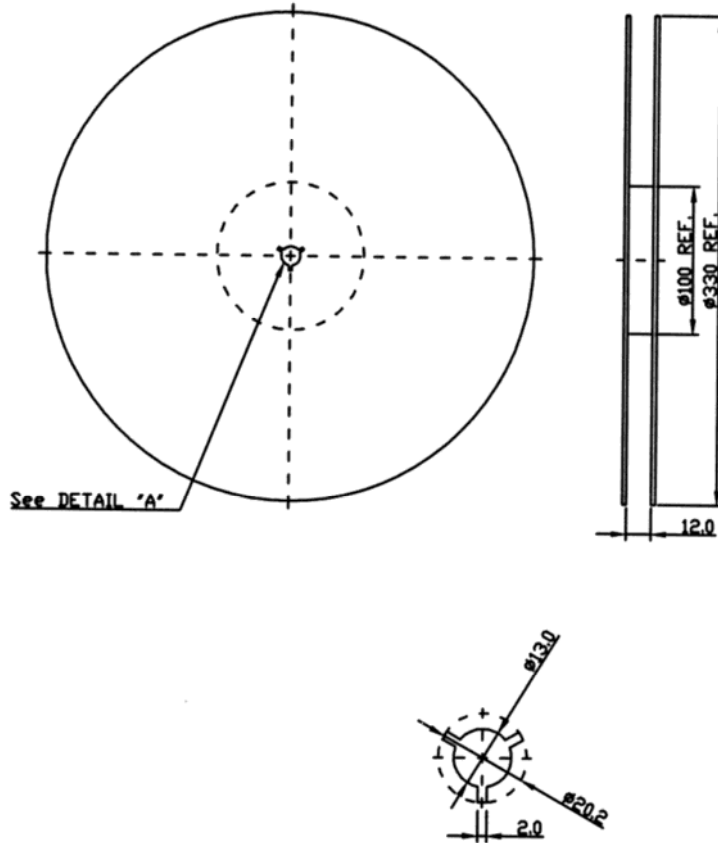

2. Tape Dimension

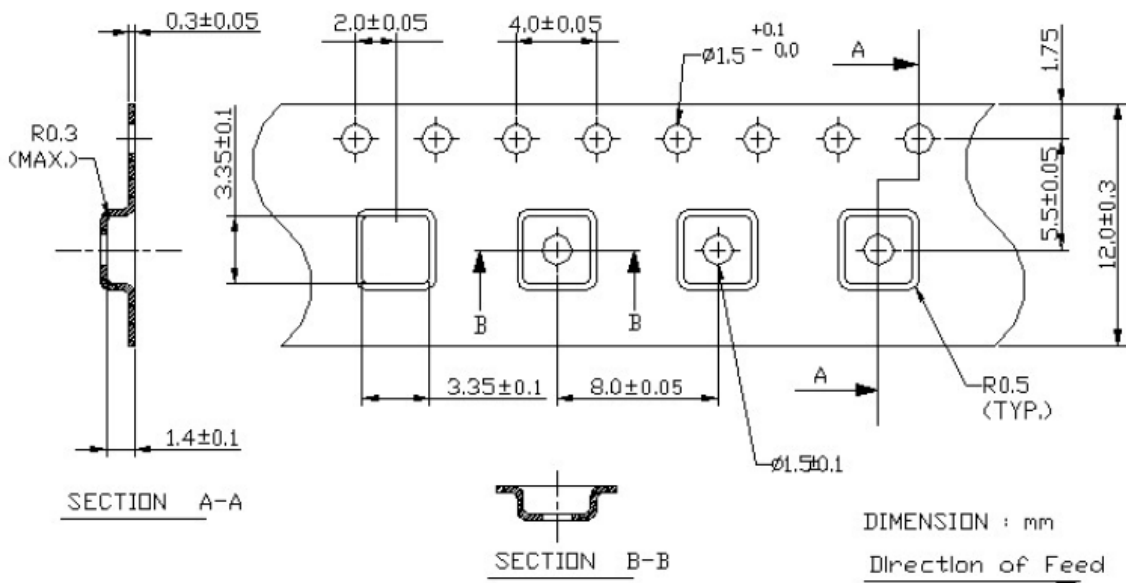

SAW Filter 1570.0MHz
Part No: MP07626

Model: TA1703A
Rev No: 1

H. RECOMMENDED REFLOW PROFILE:

