

SAW Filter 454.0MHz
Part No: MP07262

Model: TA1705A
Rev No: 1

A. MAXIMUM RATING:

Electrostatic Sensitive Device (ESD)

1. Input Power Level: 10dBm
2. DC Voltage: 5V
3. Operating Temperature: -30°C to +70°C
4. Storage Temperature: -40°C to +85°C

B. ELECTRICAL CHARACTERISTICS:

Item	Unit	Min.	Typ.	Max.
Center frequency Fc	MHz	-	454	-
3dB Bandwidth	MHz	-	33.5	-
Max Insertion loss	dB	-	2.0	3.3
Attenuation (reference from 0dB)				
10 ~ 220MHz	dB	35	54	-
220 ~ 375MHz	dB	30	47	-
375 ~ 390MHz	dB	25	45	-
390 ~ 415MHz	dB	15	40	-
500 ~ 520MHz	dB	15	37	-
520 ~ 540MHz	dB	25	45	-
540 ~ 650MHz	dB	30	44	-
650 ~ 850MHz	dB	27	40	-
850 ~ 1100MHz	dB	25	34	-
Source impedance Z _S	Ω	-	50	-
Load impedance Z _L	Ω	-	50	-

SAW Filter 454.0MHz
Part No: MP07262

Model: TA1705A
Rev No: 1

C. FREQUENCY CHARACTERISTICS:

1. Wideband response: (span 1090MHz)

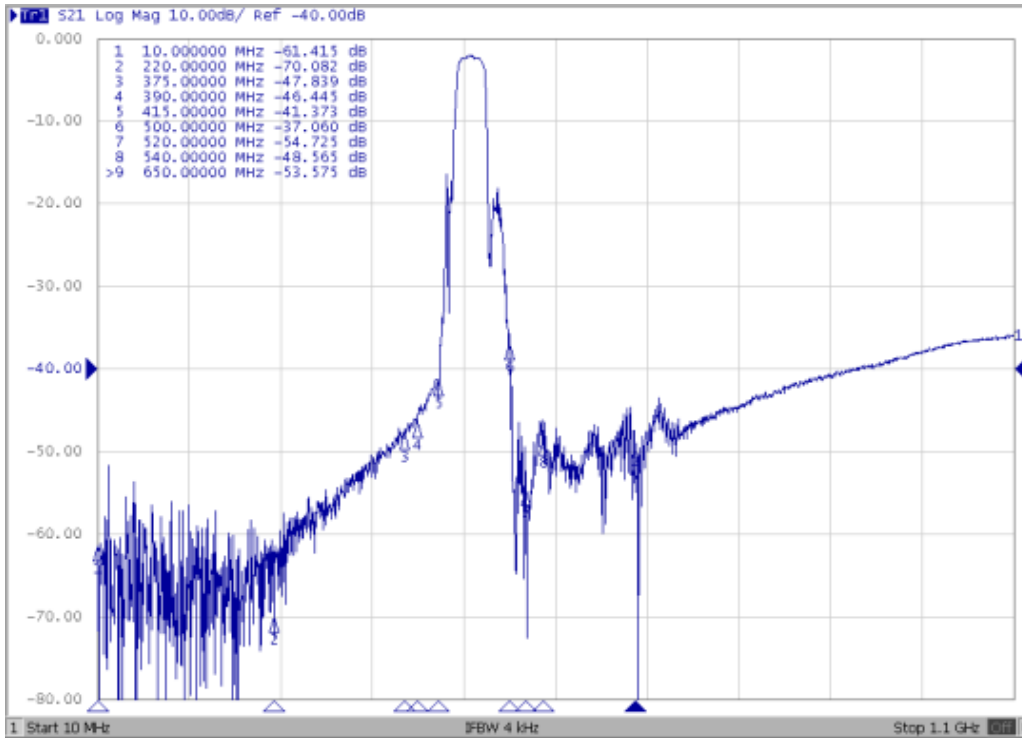

2. S21 response: (span 200MHz)

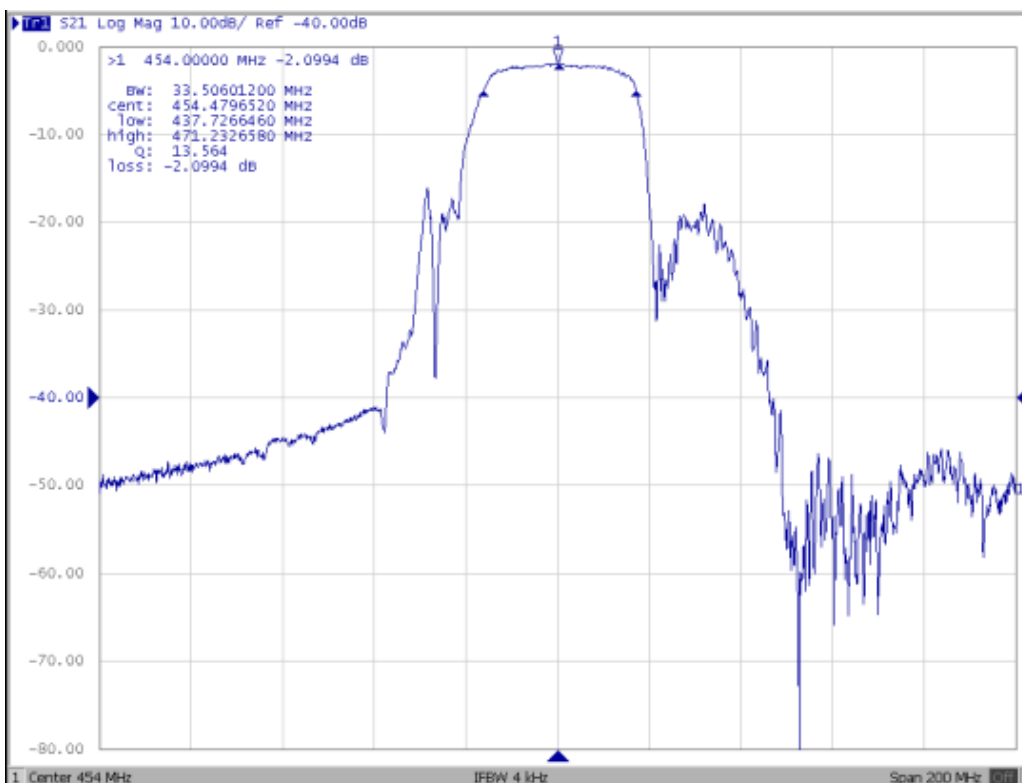

SAW Filter 454.0MHz
Part No: MP07262

Model: TA1705A
Rev No: 1

3. Passband response: (span 50MHz)

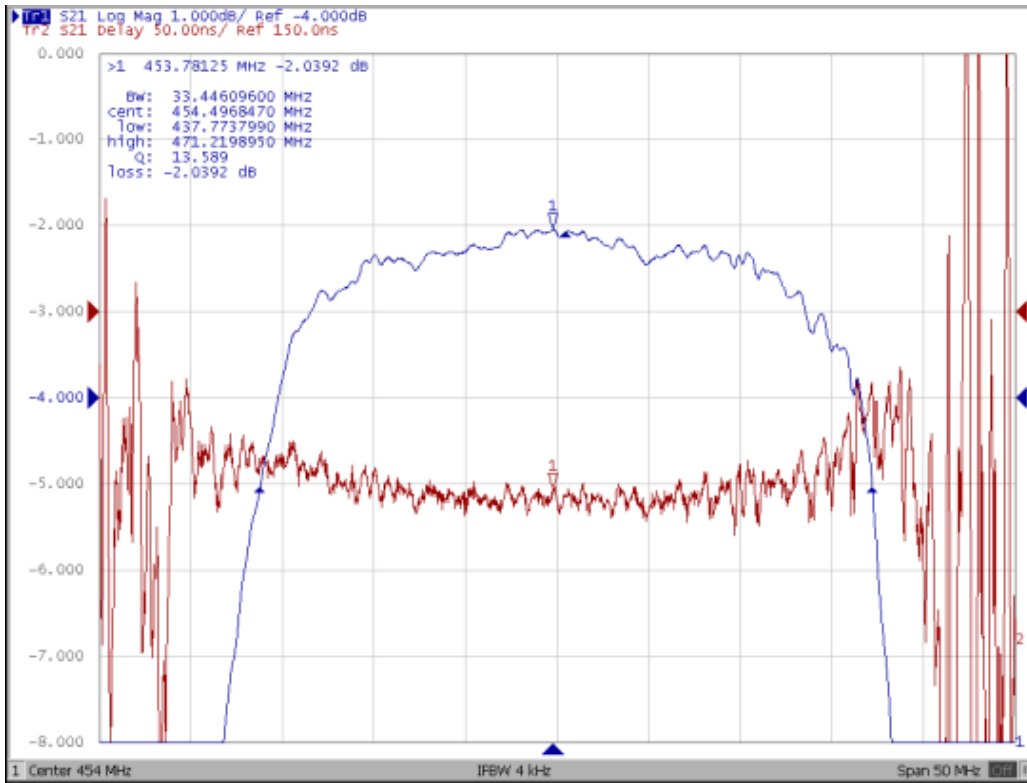

4. S11 & S22 VSWR: (span 50MHz)



SAW Filter 454.0MHz
Part No: MP07262

Model: TA1705A
Rev No: 1

D. MEASUREMENT CIRCUIT:

HP Network analyzer

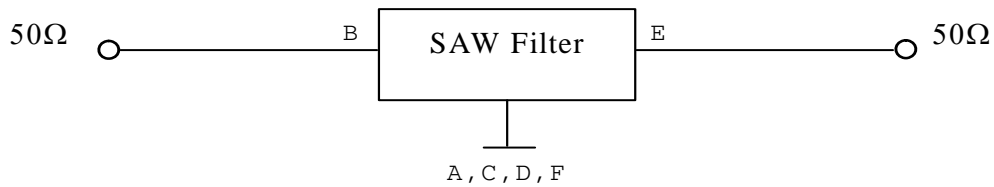

E. OUTLINE DRAWING:

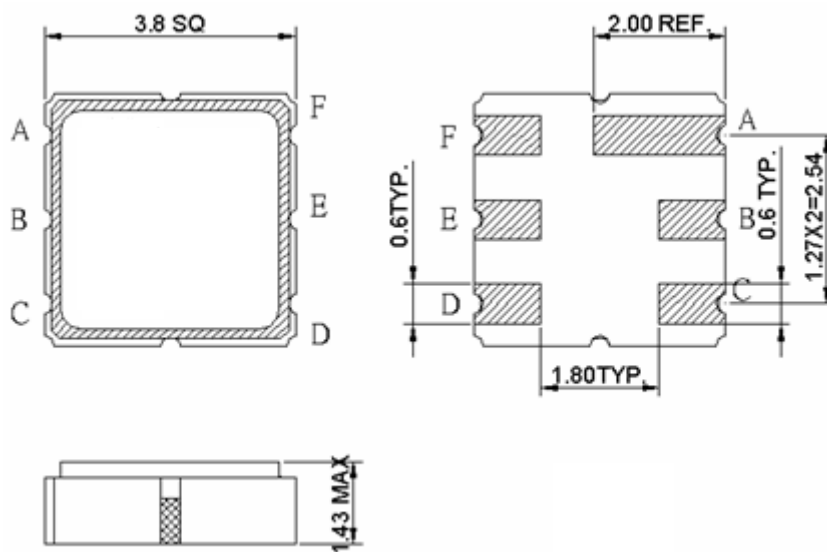

B: Input
 E: Output
 A, C, D, F: Ground
 Unit: mm

F. PCB FOOTPRINT:

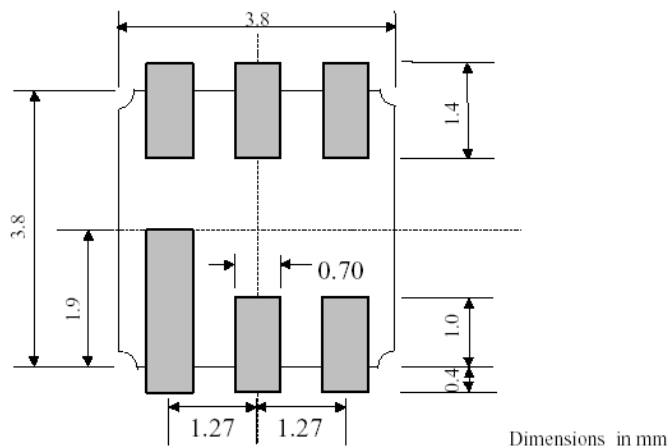

SAW Filter 454.0MHz
Part No: MP07262

Model: TA1705A
Rev No: 1

G. PACKING:

1. Reel Dimension (Please refer to FR-75D10 for packing quantity)

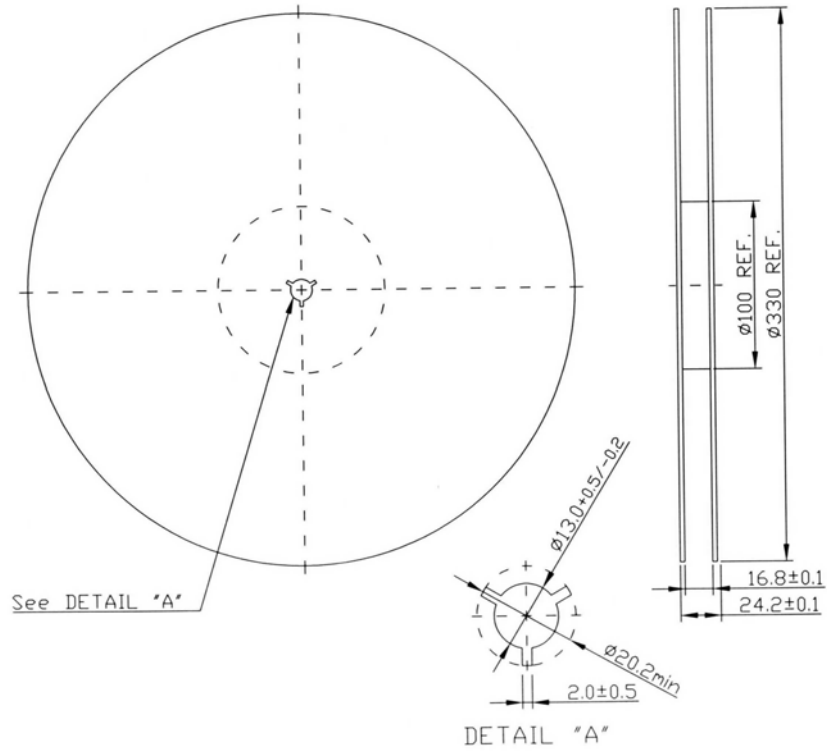

2. Tape Dimension

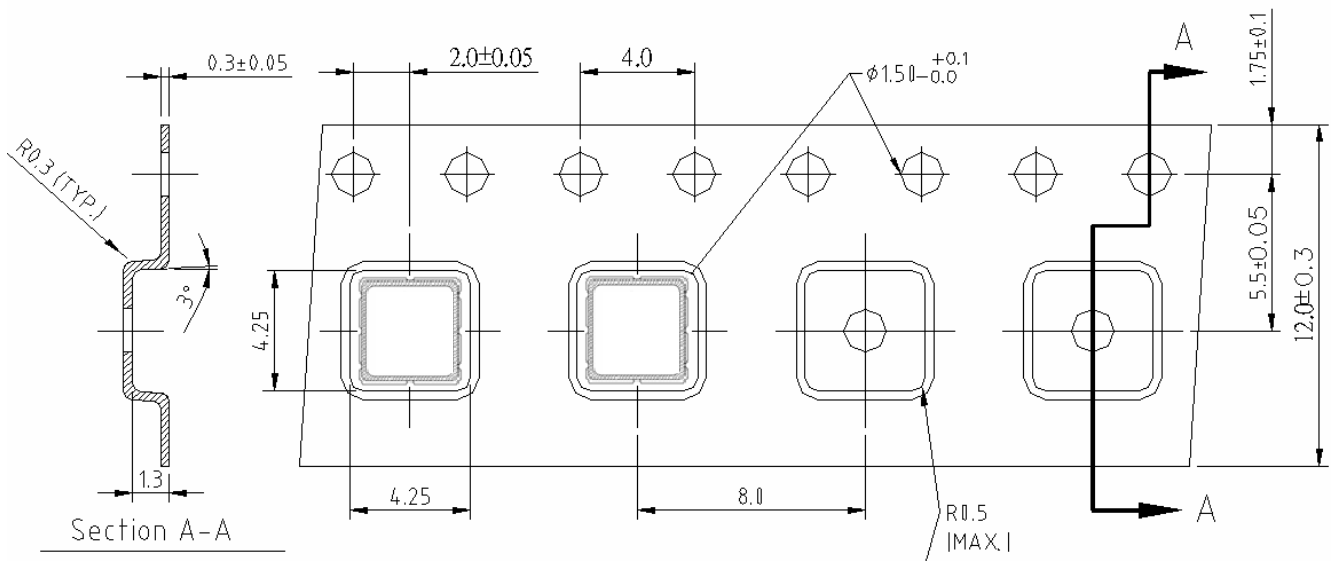

SAW Filter 454.0MHz
Part No: MP07262

Model: TA1705A
Rev No: 1

H. RECOMMENDED REFLOW PROFILE:

