

**SAW Filter: 412.50MHz**

**Model: TA1636A**

**Part No: MP05483**

**Rev No: 1**

**A. MAXIMUM RATING:**

Electrostatic Sensitive Device (ESD)

1. Input Power Level: 10dBm
2. DC Voltage: 3V
3. Operating Temperature: -40°C to +85°C
4. Storage Temperature: -40°C to +85°C

**B. ELECTRICAL CHARACTERISTICS:**

Item	Unit	Min.	Typ.	Max.
Center frequency Fc MHz		-	412.5	-
1dB Bandwidth MHz	dB	-	19.5	-
3dB Bandwidth MHz	dB	20	23.3	-
Insertion loss 403 ~ 422MHz	dB	-	2.3	3.0
Attenuation (reference from 0dB)				
10 ~ 360MHz	dB	50	58	-
360 ~ 385MHz	dB	47	55	-
470 ~ 600MHz	dB	47	51	-
600 ~ 1000 MHz	dB	43	48	-
Source impedance Z <sub>S</sub>	Ω	-	50	-
Load impedance Z <sub>L</sub>	Ω	-	50	-

**SAW Filter: 412.50MHz**  
**Part No: MP05483**

**Model: TA1636A**  
**Rev No: 1**

**C. FREQUENCY CHARACTERISTICS:**

1. Wideband response: (span 1GHz)

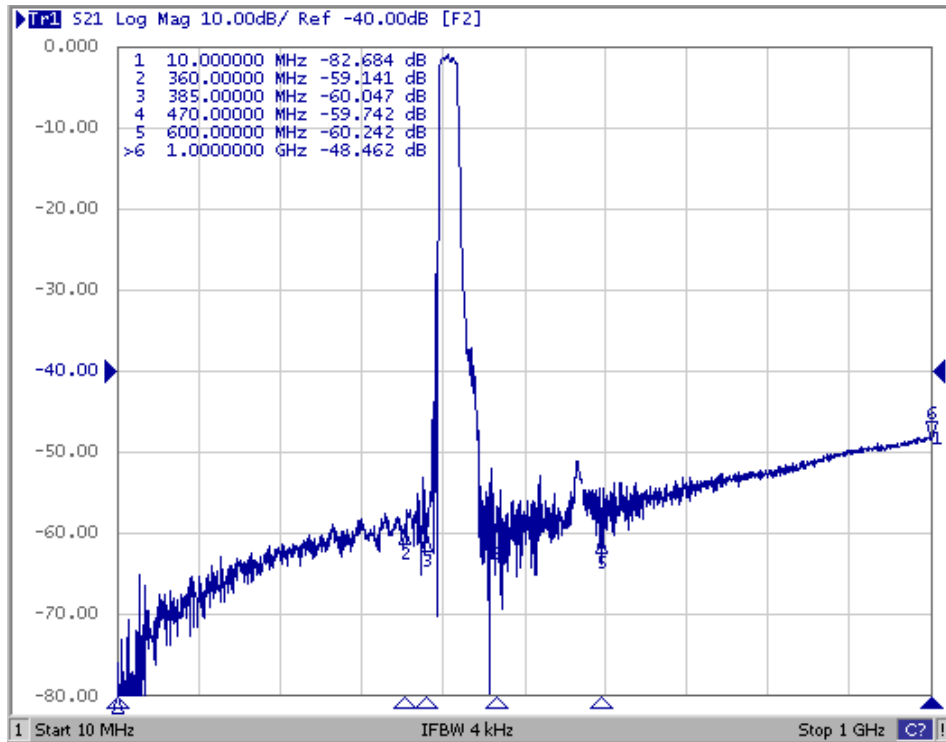

2. S21 response: (span 200MHz)

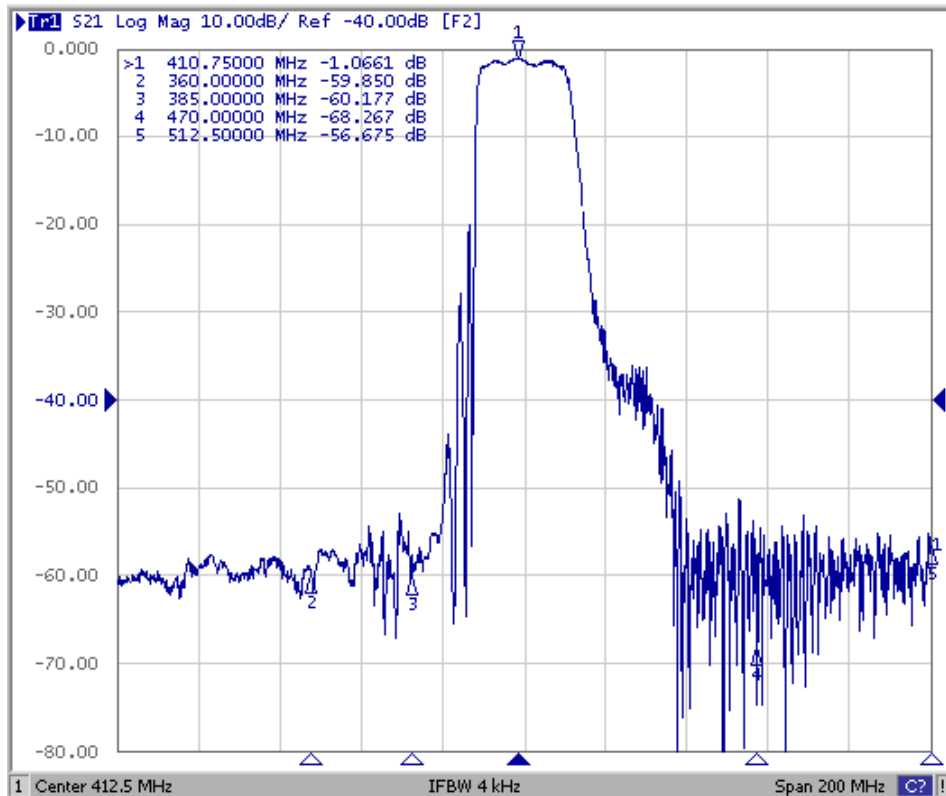

**SAW Filter: 412.50MHz**  
**Part No: MP05483**

**Model: TA1636A**  
**Rev No: 1**

3. Passband response: (span 40MHz)

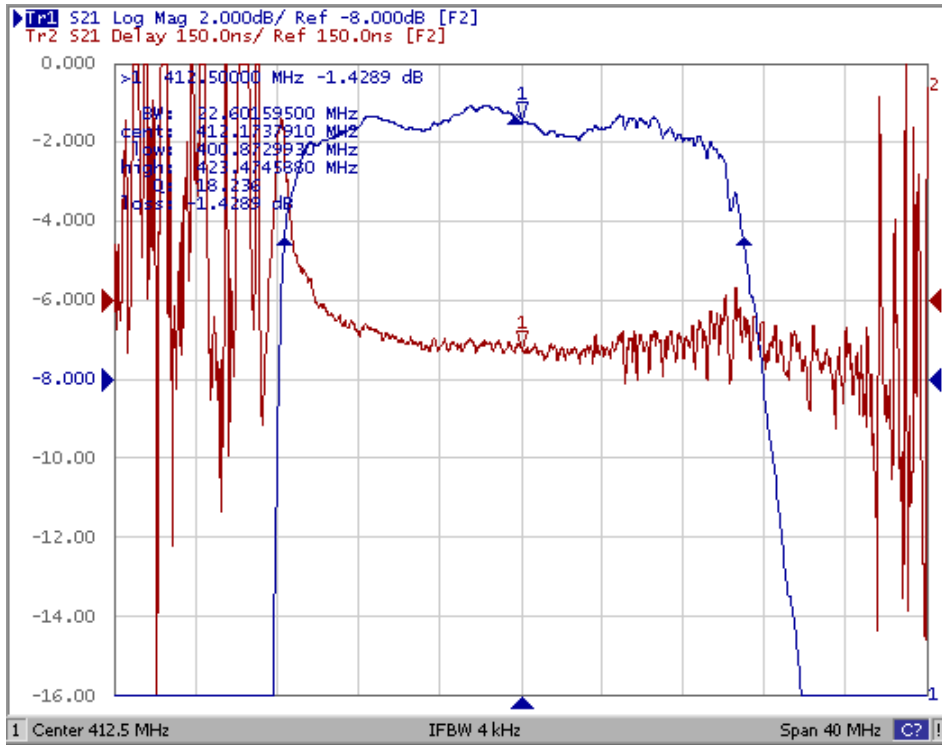

**SAW Filter: 412.50MHz**  
**Part No: MP05483**

**Model: TA1636A**  
**Rev No: 1**

**D. MEASUREMENT CIRCUIT:**

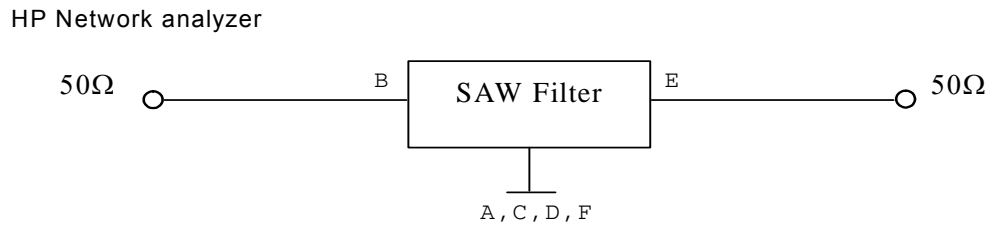

**E. OUTLINE DRAWING:**

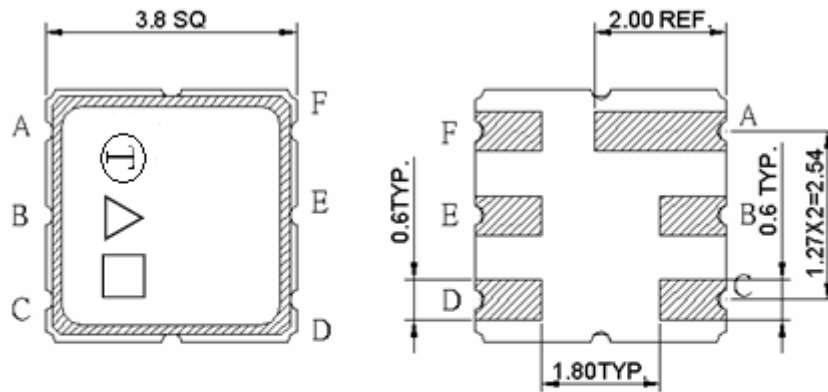

B: Input  
 E: Output  
 A, C, D, F  
 Unit: mm

**F. PCB FOOTPRINT:**

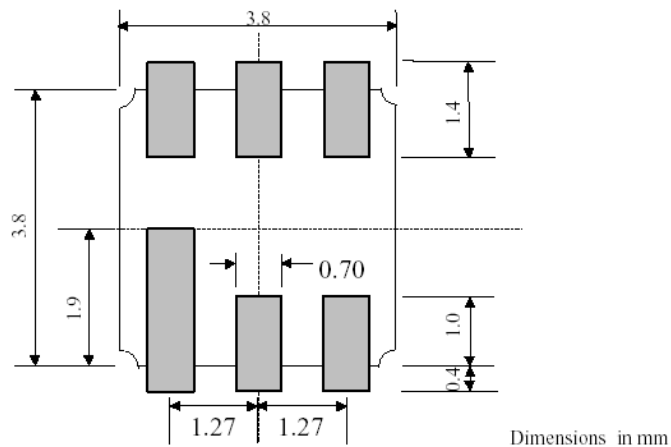

**SAW Filter: 412.50MHz**  
**Part No: MP05483**

**Model: TA1636A**  
**Rev No: 1**

**G. PACKING:**

1. Reel Dimension

(Please refer to FR-75D10 for packing quantity)

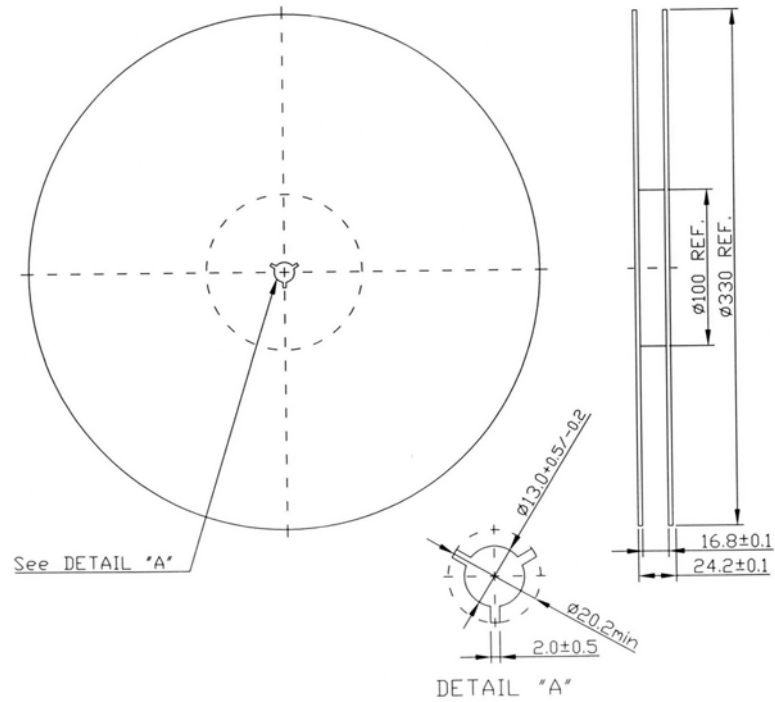

2. Tape Dimension

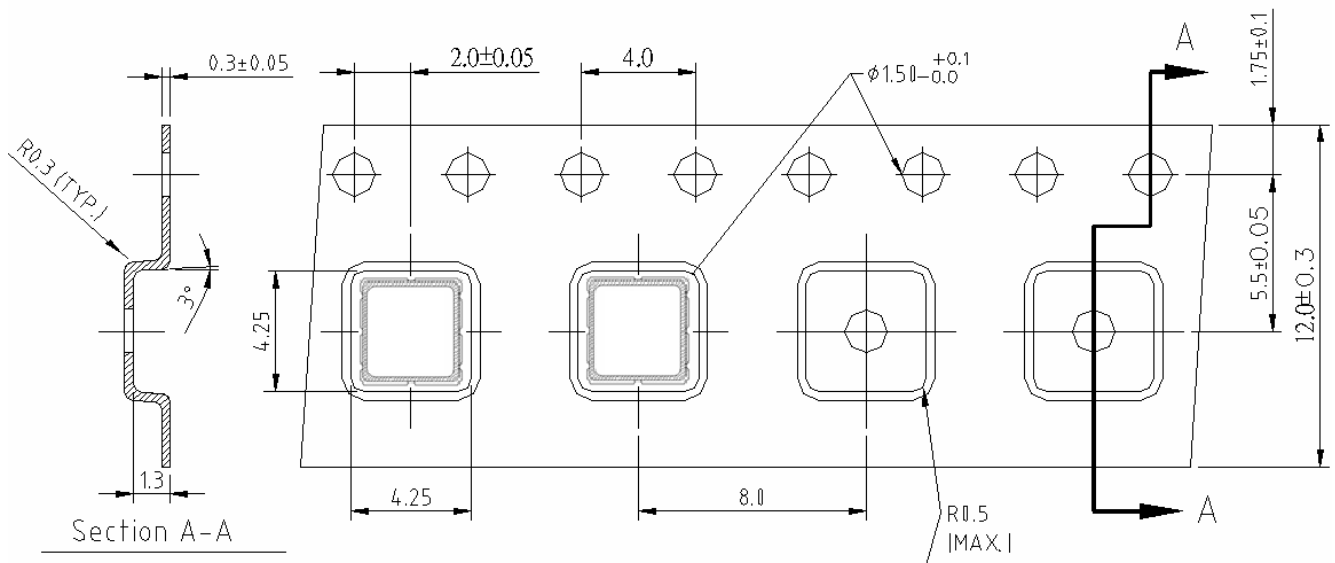

**SAW Filter: 412.50MHz**  
**Part No: MP05483**

**Model: TA1636A**  
**Rev No: 1**

**H. RECOMMENDED REFLOW PROFILE:**

