

SAW Filter 380.0MHz
Part No: MP03700

Model: TB0445A
Rev No: 1

A. MAXIMUM RATINGS:

1. Operating Temperature: -10°C to 75°C
2. Storage Temperature: -40°C to 85°C
3. Input Power: 15dBm

B. ELECTRICAL CHARACTERISTICS:

Ambient Temperature: 25°C

Characteristics	Value		
	Min.	Typ.	Max.
Center frequency Fc MHz	-	380	-
Minimum Insertion loss IL dB	-	11.5	13.0
Lower 1.5 dB Bandwidth MHz	-	377.67	377.90
Upper 1.5 dB Bandwidth MHz	382.10	382.34	-
Lower 10 dB Bandwidth MHz	376.65	376.79	-
Upper 10 dB Bandwidth MHz	-	383.17	383.35
Lower 20 dB Bandwidth MHz	376.25	376.40	-
Upper 20 dB Bandwidth MHz	-	383.56	383.75
Lower 30 dB Bandwidth MHz	375.85	376.12	-
Upper 30 dB Bandwidth MHz	-	383.83	384.15
Passband Ripple 377.9 -382.1MHz dB p-p	-	0.2	1.0
Amplitude Variation 377.9 -382.1MHz dB p-p	-	0.88	1.5
Group Delay 377.9 -382.1MHz usec	-	0.94	-
Group Delay Variation 377.9 -382.1MHz nsec	-	30	120
Source Impedance (Balanced) ohm	-	100	-
Load Impedance (Balanced) ohm	-	100	-

SAW Filter 380.0MHz
Part No: MP03700

Model: TB0445A
Rev No: 1

C. FREQUENCY CHARACTERISTICS:

1. S21 Response: (span 20MHz)

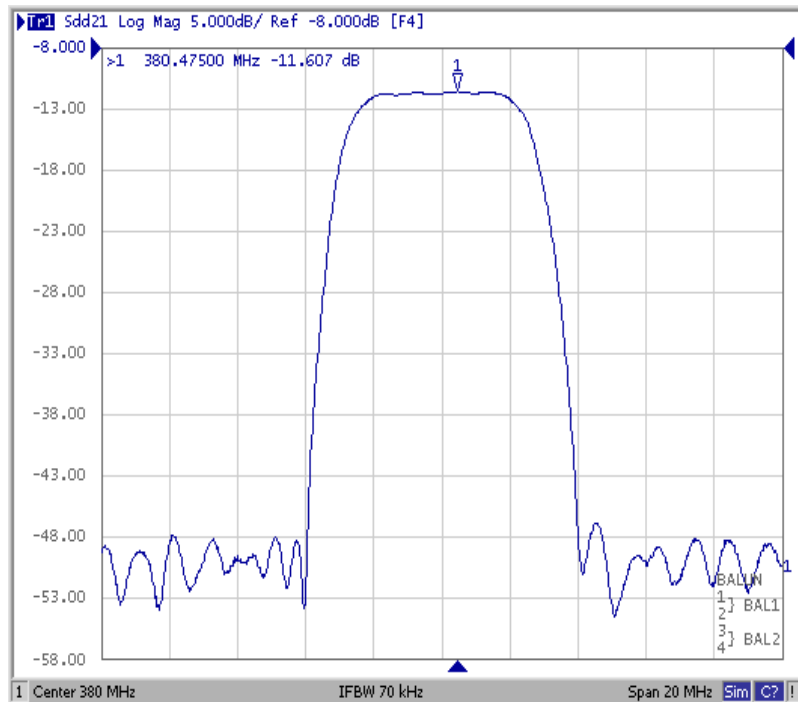

2. Passband Response: (span 8MHz)

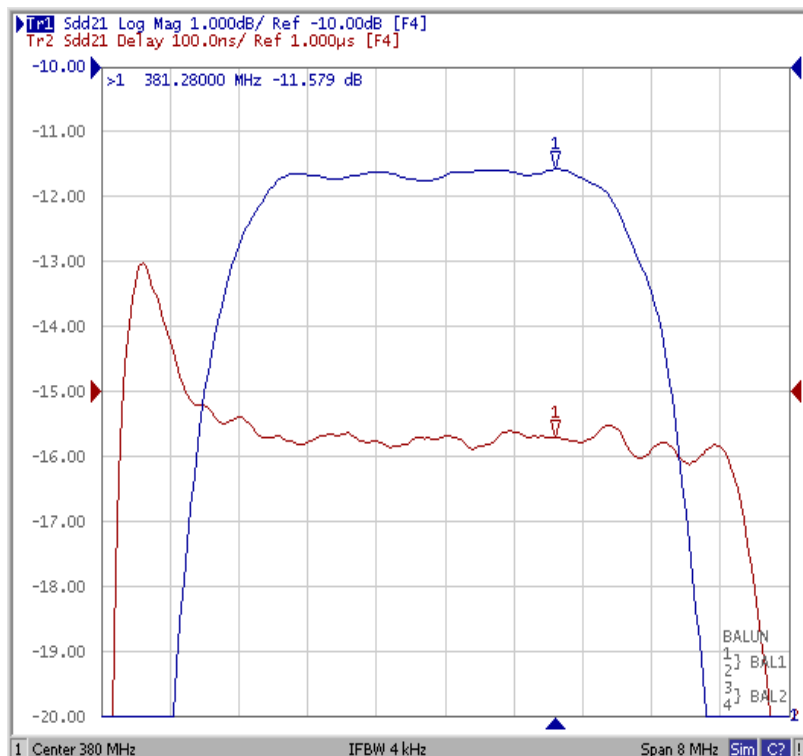

SAW Filter 380.0MHz
Part No: MP03700

Model: TB0445A
Rev No: 1

D. TEST CIRCUIT:

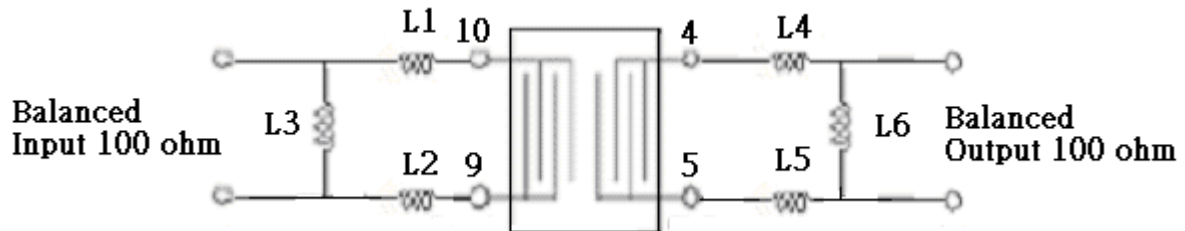

L1 = L2 = 10nH, L3 = 12nH, L4 = L5 = 12nH, L6 = 15nH

E. OUTLINE DRAWING:

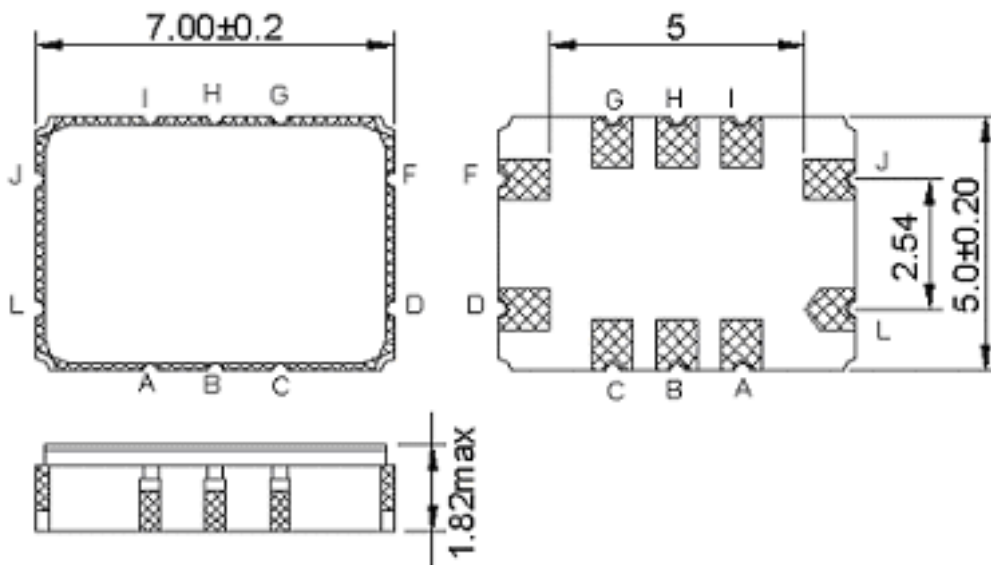

J: Input or Balance Input
 L: Input or Balance Input
 D: Output or balanced Input
 F: Output or balanced Input
 A, B, C, I, H, G: To be Ground
 Unit: mm

SAW Filter 380.0MHz
Part No: MP03700

Model: TB0445A
Rev No: 1

F. PACKING:

1. REEL DIMENSION

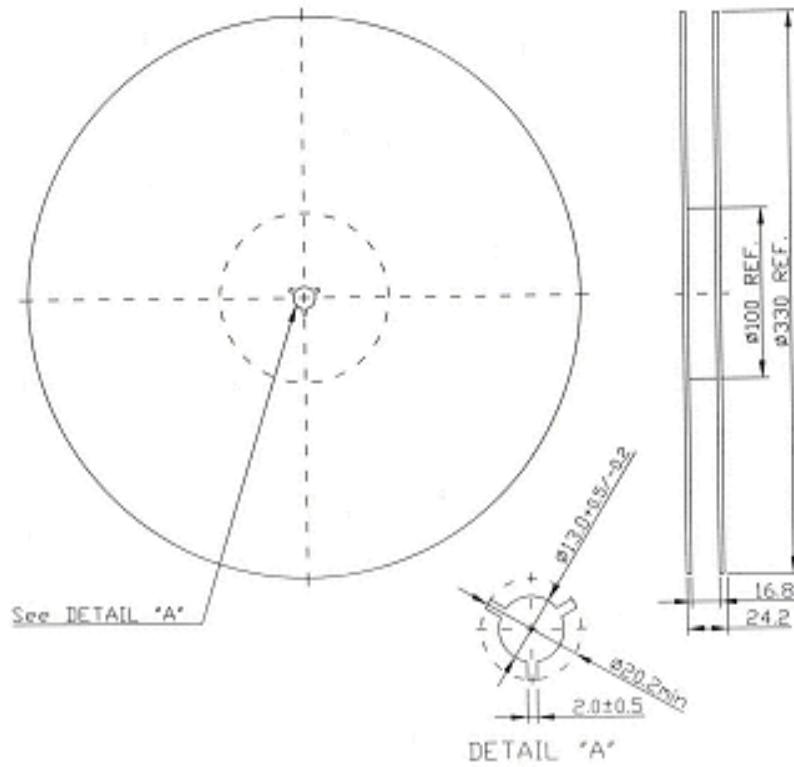

2. TAPE DIMENSION

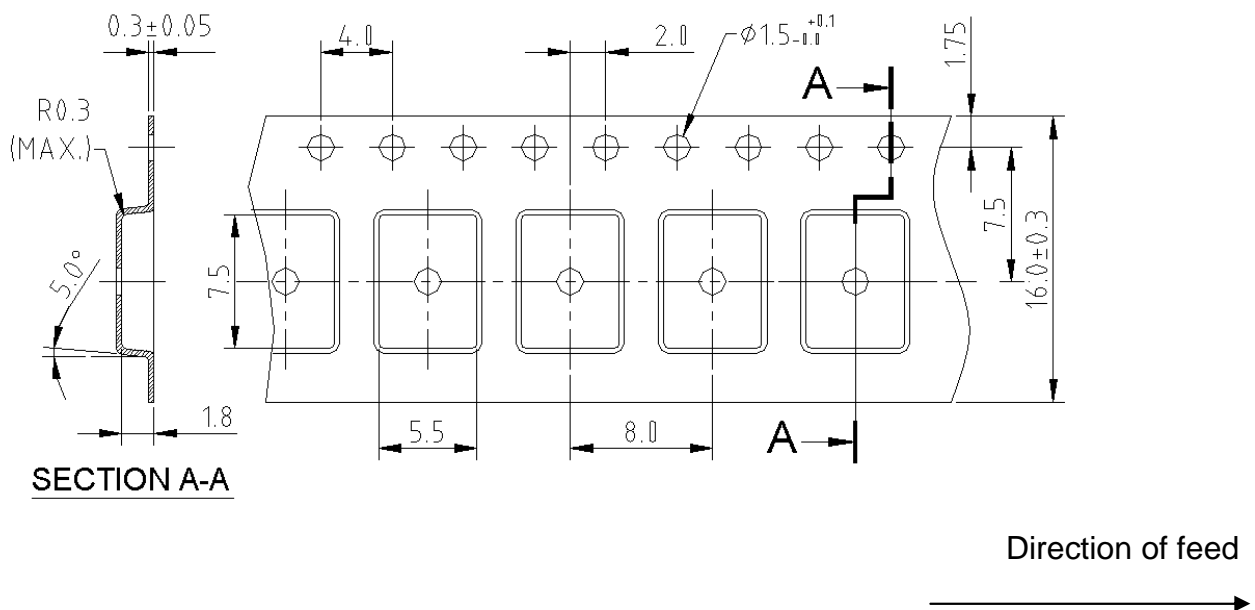

SAW Filter 380.0MHz
Part No: MP03700

Model: TB0445A
Rev No: 1

G. RECOMMENDED REFLOW PROFILE:

