

SAW Filter 815.0MHz
Part No: MP03357

Model: TA1082A
Rev No: 1

A. MAXIMUM RATING:

1. Input Power Level: 10dBm
2. DC voltage: 5V
3. Operating Temperature: -30°C to +80°C
4. Storage Temperature: -40°C to +85°C

B. ELECTRICAL CHARACTERISTICS:

Item	Unit	Min.	Typ.	Max.
Center frequency Fc	MHz	-	815	-
Insertion Loss (805 ~ 825MHz) IL	dB	-	2.8	3.5
Amplitude Ripple (805 ~ 825MHz)	dB	-	1.0	2.0
Input/Output VSWR (805 ~ 825MHz)	-	-	1.9	2.5
Attenuation (Reference level from 0dB)				
10 ~ 780MHz	dB	40	63	-
851 ~ 856MHz	dB	28	50	-
856 ~ 869MHz	dB	40	47	-
896 ~ 941MHz	dB	40	62	-
960 ~ 2200MHz	dB	40	46	-
2200 ~ 2600MHz	dB	30	35	-

C. MEASUREMENT CIRCUIT:

HP Network analyzer

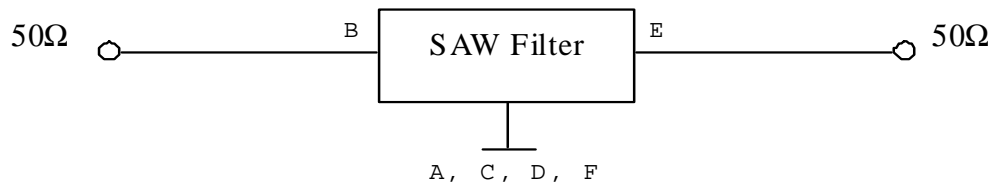

SAW Filter 815.0MHz
Part No: MP03357

Model: TA1082A
Rev No: 1

D. FREQUENCY CHARACTERISTICS:

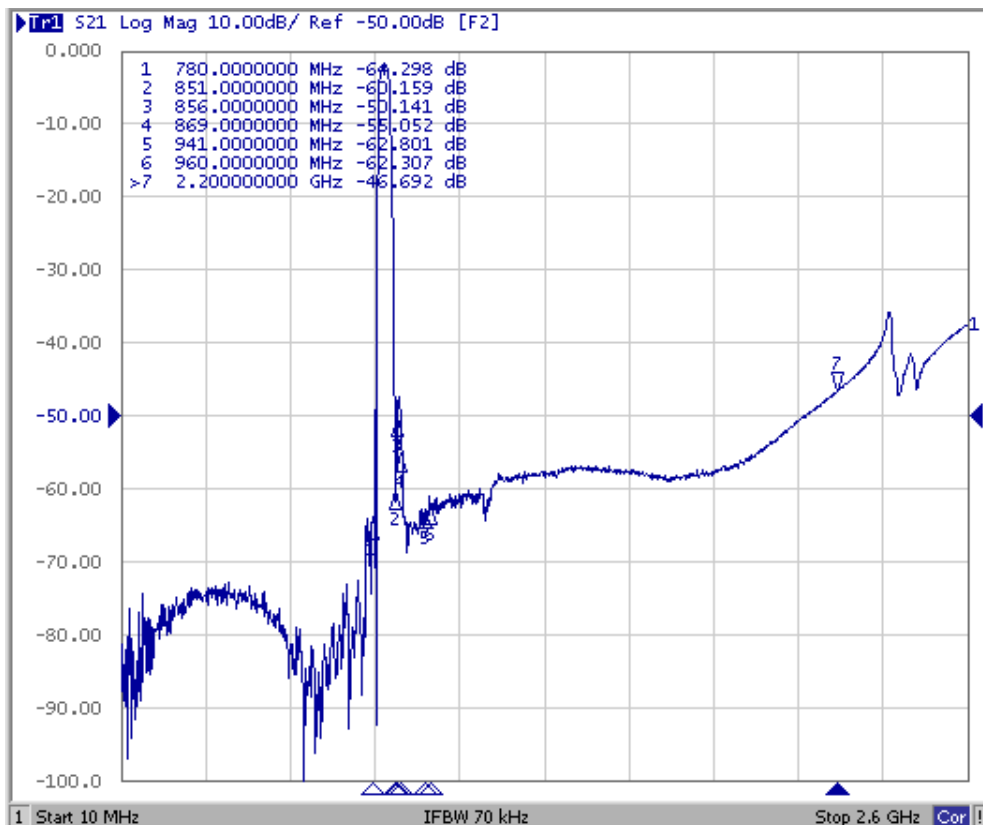
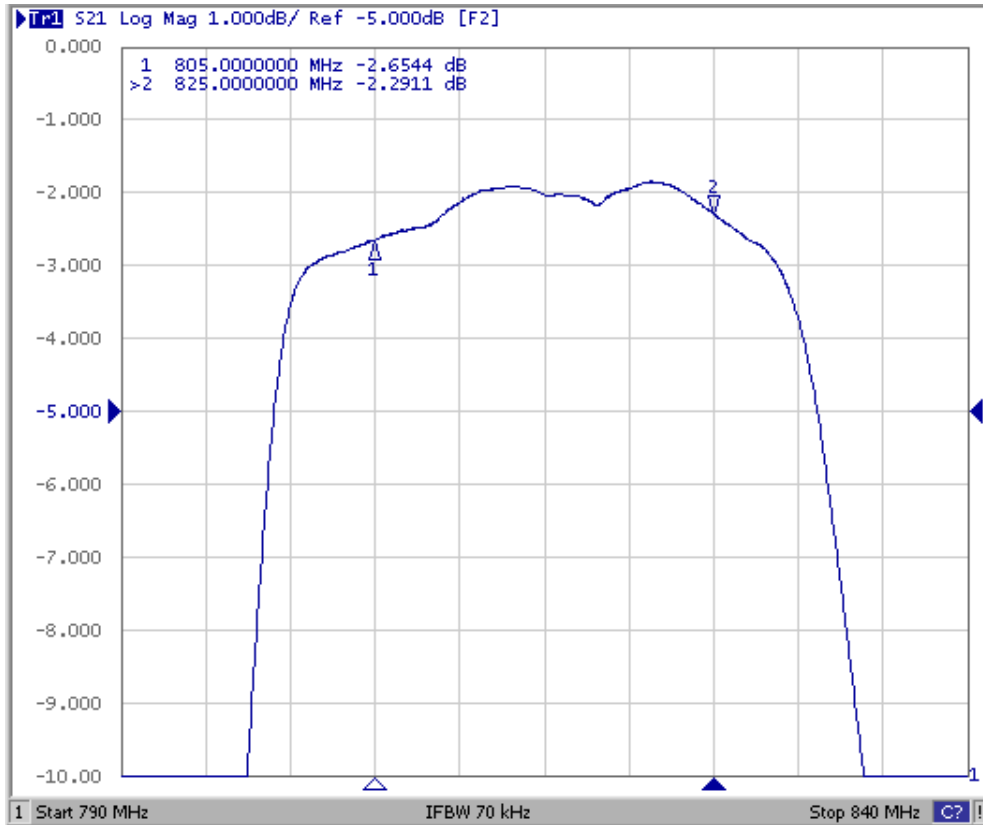

SAW Filter 815.0MHz
Part No: MP03357

Model: TA1082A
Rev No: 1

Reflection Functions

S11

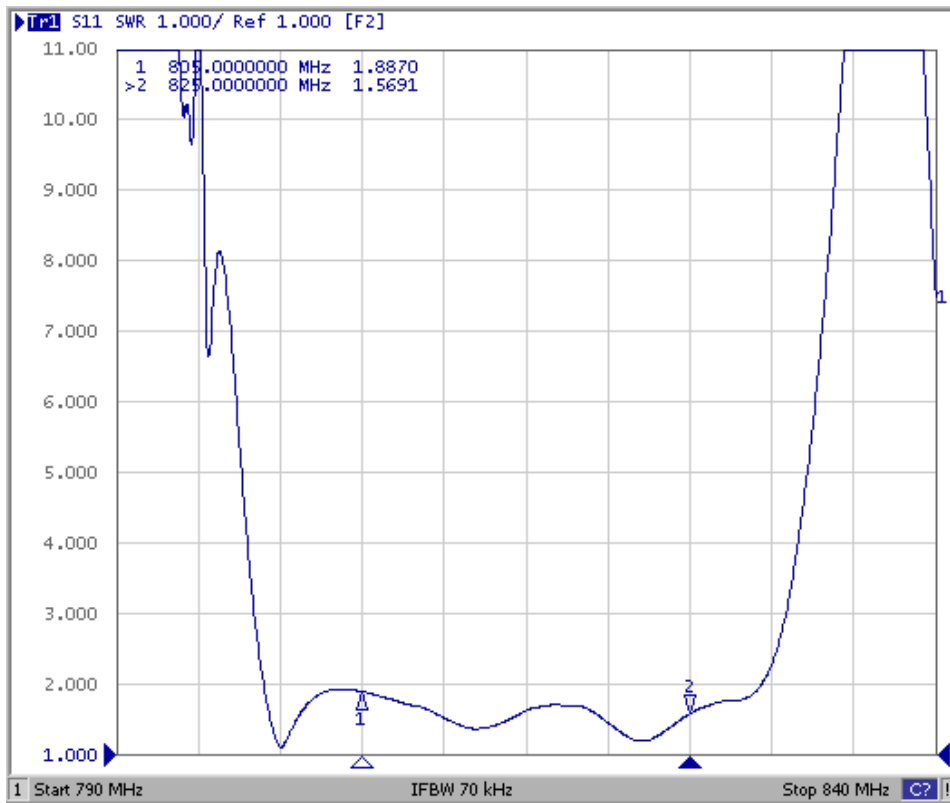

S22

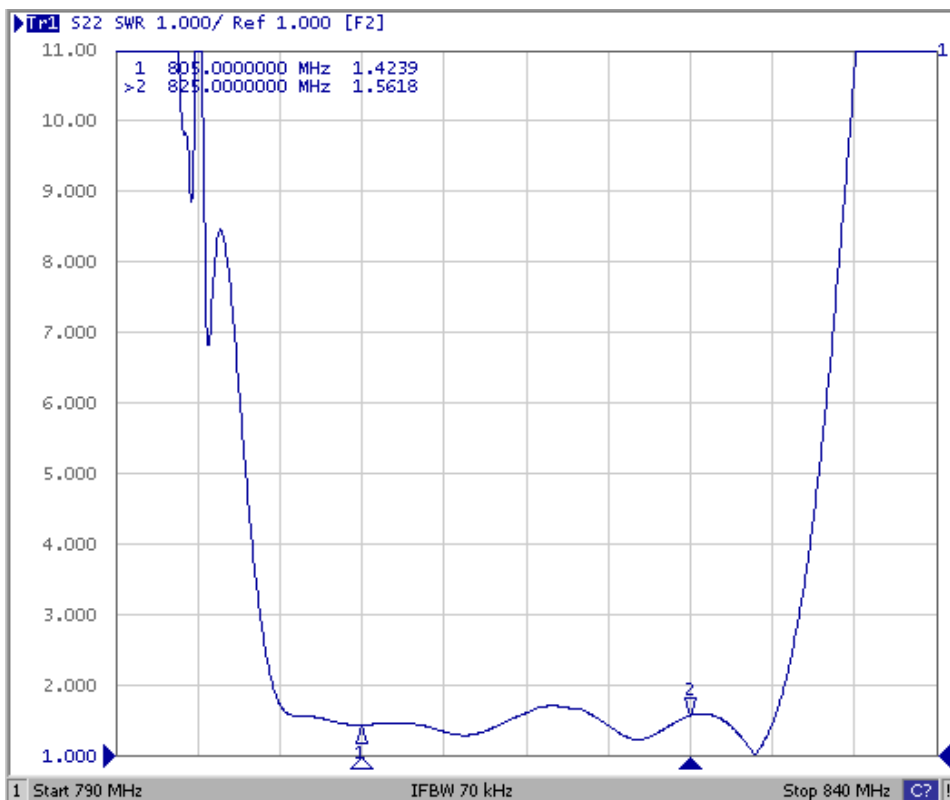

SAW Filter 815.0MHz
Part No: MP03357

Model: TA1082A
Rev No: 1

E. OUTLINE DRAWING:

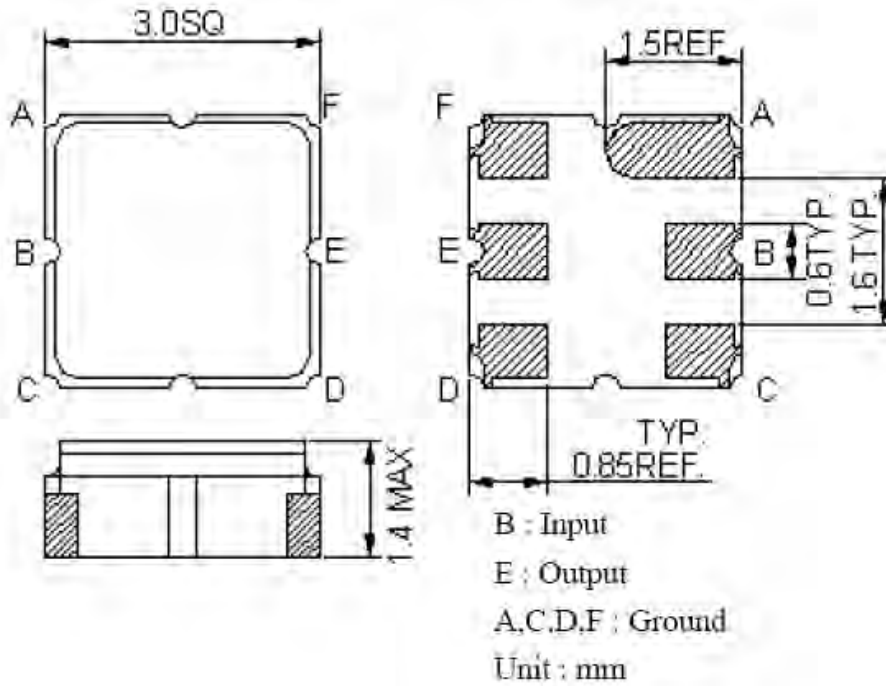

F. PCB FOOTPRINT:

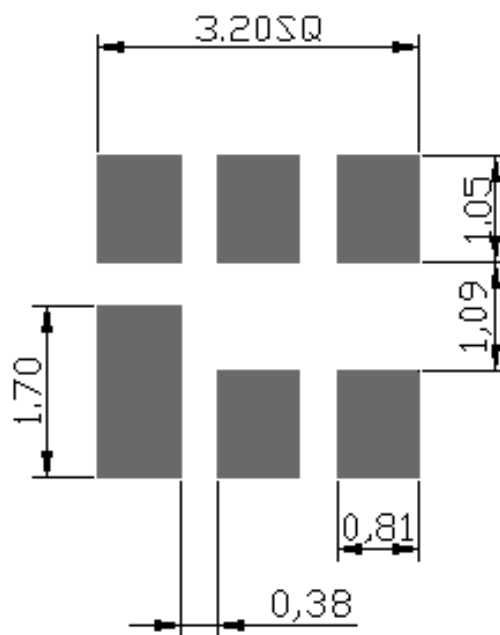

SAW Filter 815.0MHz
Part No: MP03357

Model: TA1082A
Rev No: 1

G. PACKING:

1. REEL DIMENSION

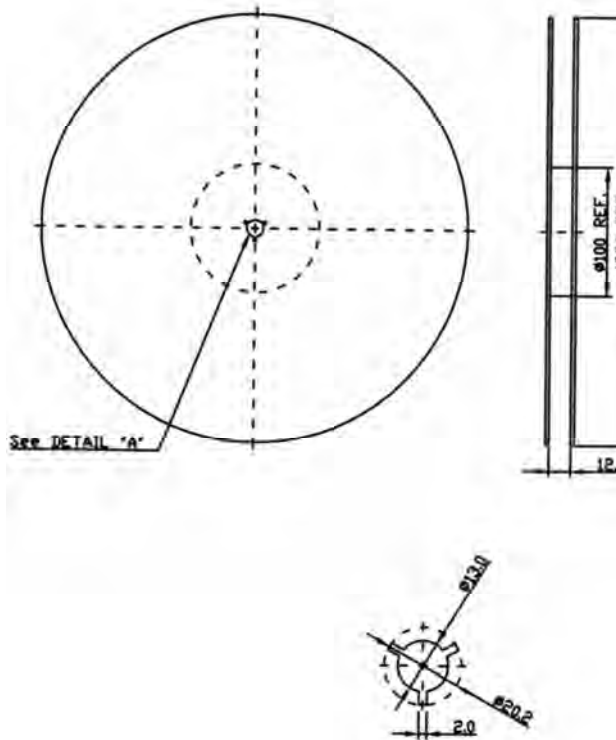

2. TAPE DIMENSION

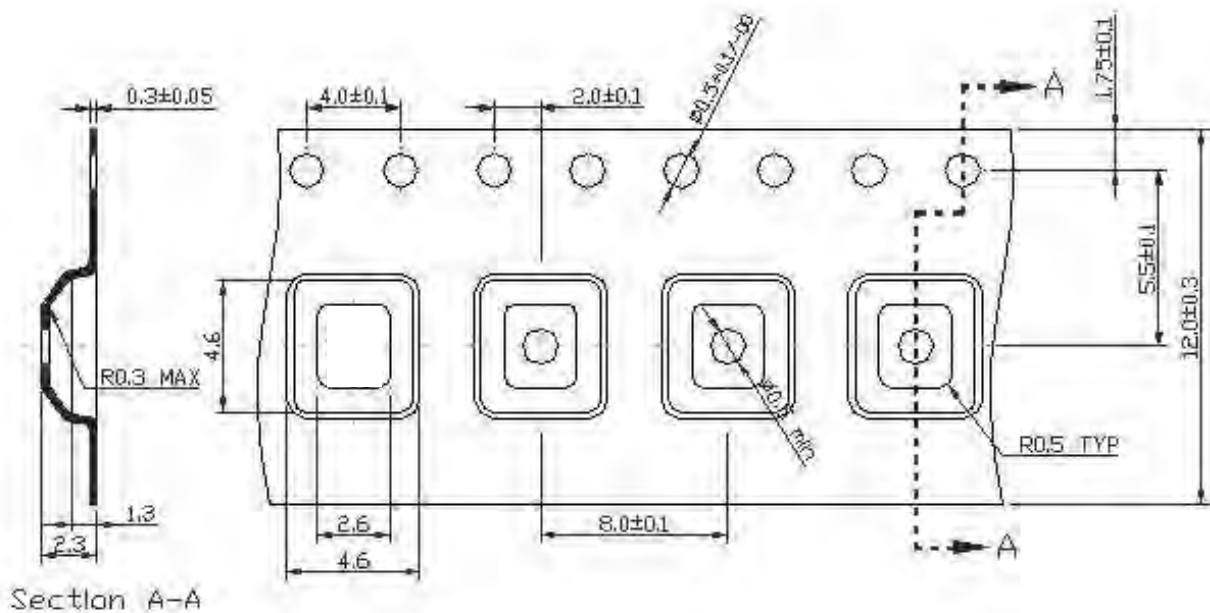

SAW Filter 815.0MHz
Part No: MP03357

Model: TA1082A
Rev No: 1

H. RECOMMENDED REFLOW PROFILE:

