

**SAW Filter 533.33MHz**  
**Part No: MP02138**

**Model: TB0264A**  
**Rev No: 2**

**A. MAXIMUM RATING:**

1. Input Power Level: 10dBm
2. Operating Temperature: -40°C to 85°C
3. Storage Temperature: -40°C to 85°C

**B. ELECTRICAL CHARACTERISTICS:**

| Item                                       | Unit | Min. | Typ.   | Max. | Note |
|--|------|------|--------|------|------|
| Center frequency Fc                        | MHz  | -    | 533.33 | -    | -    |
| Insertion Loss IL                          | dB   | -    | 8.3    | 9    | -    |
| Passband width BW3                         | MHz  | 4.5  | 8.3    | -    | -    |
| Passband width BW35                        | MHz  | -    | 17     | -    | -    |
| Amplitude Ripple in Fc ± 1MHz              | dB   | -    | 0.8    | 1    | -    |
| Group delay ripple in Fc ± 1MHz            | nS   | -    | 65     | 100  | -    |
| Phase Linearity in Fc ± 1MHz               | deg  | -    | 2      | 4    | -    |
| Attenuation: (Reference level from Min IL) |      |      |        |      |      |
| 10MHz to 504MHz                            | dB   | 40   | 50     | -    | -    |
| 504MHz to 521.34MHz                        | dB   | 30   | 45     | -    | -    |
| 545.34MHz to 560MHz                        | dB   | 30   | 45     | -    | -    |
| 560MHz to 1000MHz                          | dB   | 40   | 50     | -    | -    |

**C. MEASUREMENT CIRCUIT:**

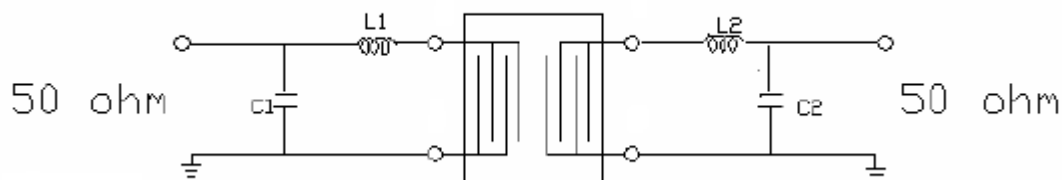

Input L1 = 10nH, C1 = 10pF

Output L2 = 10nH, C2 = 8pF

**SAW Filter 533.33MHz**  
**Part No: MP02138**

**Model: TB0264A**  
**Rev No: 2**

**D. FREQUENCY CHARACTERISTICS:**

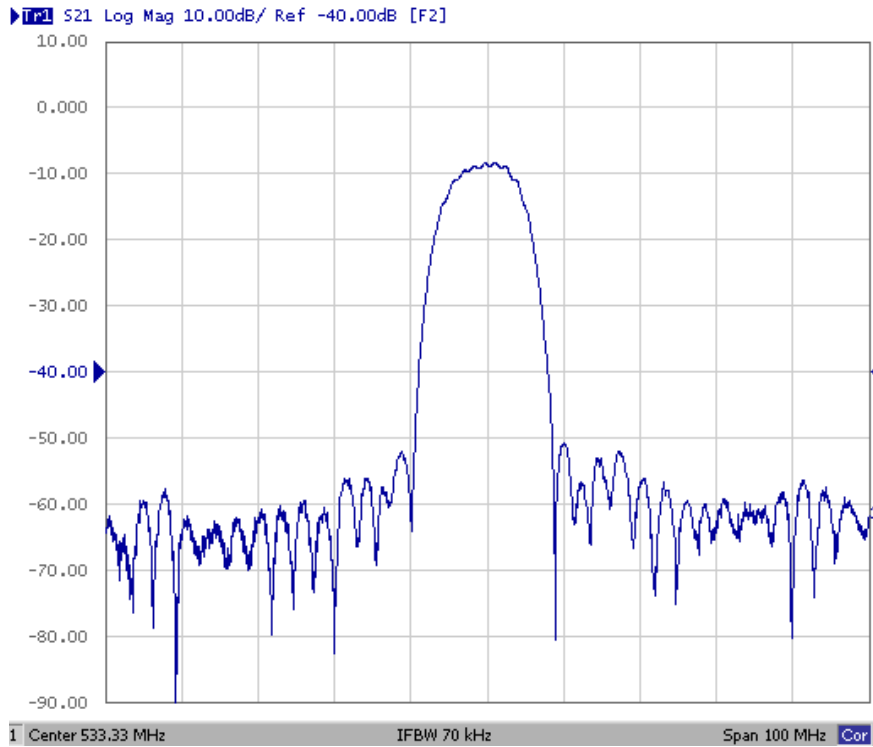

Fig. 1. S21 Response Horizontal: 10MHz/Div, Vertical: 10dB/Div

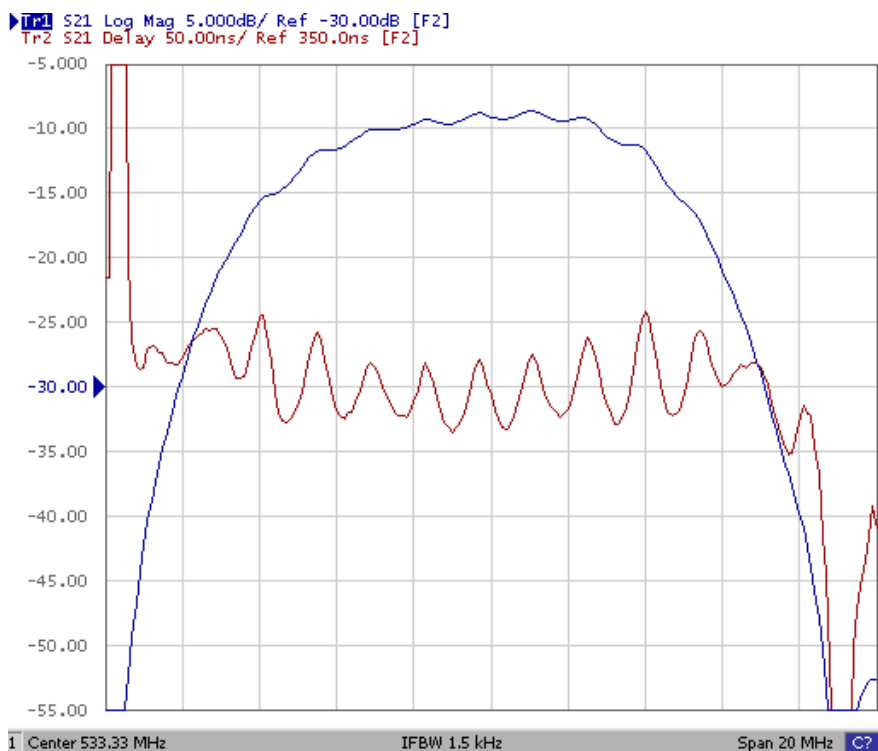

Fig. 2. Horizontal: 2MHz/Div Vertical: 5dB/Div, Vertical: 50ns/Div



**SAW Filter 533.33MHz**  
**Part No: MP02138**

**Model: TB0264A**  
**Rev No: 2**

**G. PACKING:**

**REEL DIMENSION**

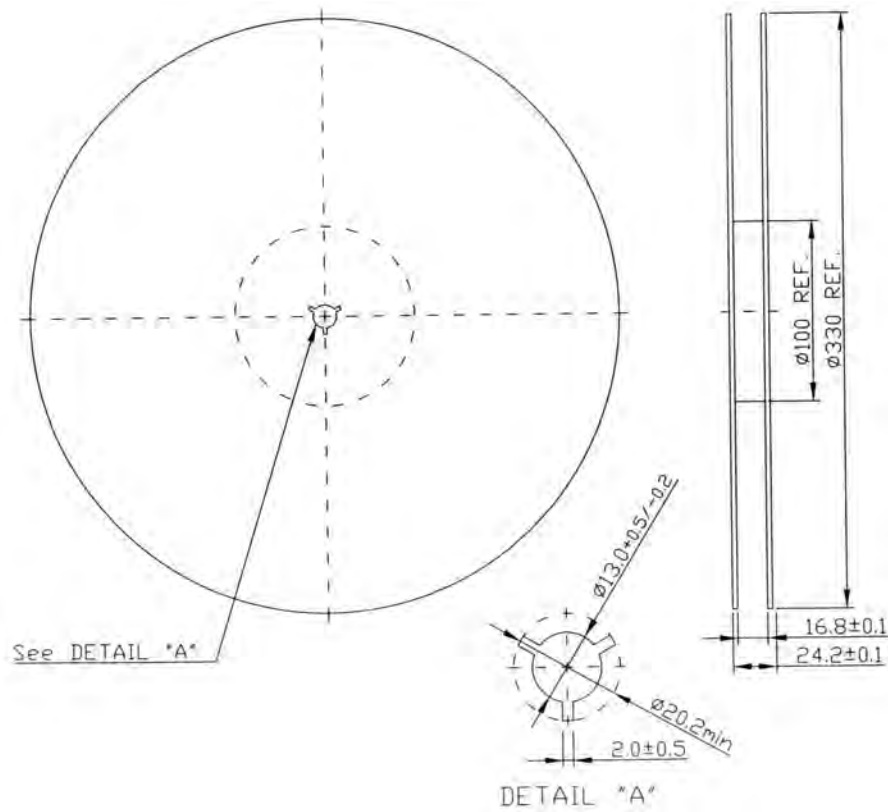

**TAPE DIMENSION**

