

**SAW Filter 390MHz**  
**Part No: MP01620**

**Model: TA0376A**  
**Rev No: 1**

**A. MAXIMUM RATING:**

1. DC voltage: 12V
2. Operating Temperature: -35°C to +85°C
3. Storage Temperature: -45°C to +85°C

**B. ELECTRICAL CHARACTERISTICS:**

Item	Min.	Typ.	Max.	Note
Center frequency Fc (MHz)	389.9	390	390.1	1
Minimum IL (389.82 ~ 390.22MHz) (dB) IL min	-	2.4	4.0	
Pass band (relative to IL min)				
389.77 ~ 390.2MHz (dB)	-	1.5	3.0	1
389.71 ~ 390.26 MHz (dB)	-	2.0	6.0	
Pass bandwidth (relative to IL min) BW3 (kHz)	500	1100	-	
Attenuation (relative to IL min) (dB)				
10 ~ 345MHz (dB)	45	50	-	
345 ~ 370MHz (dB)	40	45	-	
370 ~ 388.94MHz (dB)	15	20	-	1
391.5 ~ 410MHz (dB)	8	12	-	
410 ~ 475MHz (dB)	35	40	-	
475 ~ 1000MHz (dB)	45	55	-	
Impedance at Fc				
Input $Z_{IN} = R_{IN} // C_{IN}$	344Ω // 4.9pF			
Output $Z_{OUT} = R_{OUT} // C_{OUT}$	344Ω // 4.9pF			

Note 1: The standard definitions is in JIS C 6703

**SAW Filter 390MHz**  
**Part No: MP01620**

**Model: TA0376A**  
**Rev No: 1**

**C. FREQUENCY CHARACTERISTICS:**

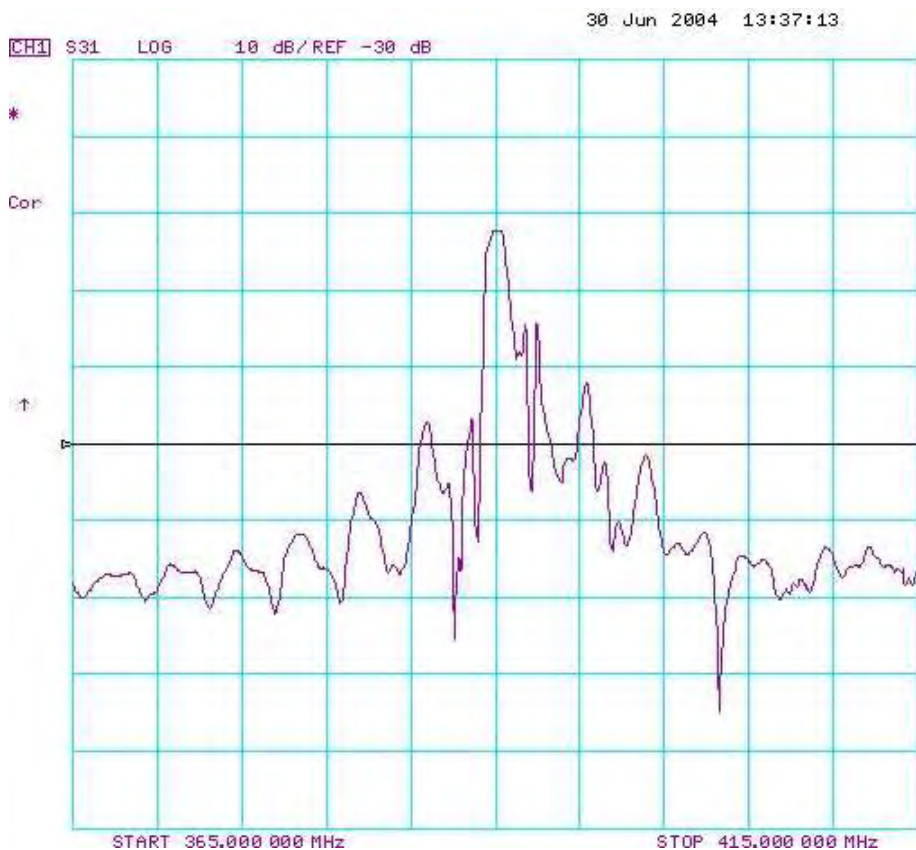

**SAW Filter 390MHz**  
**Part No: MP01620**

**Model: TA0376A**  
**Rev No: 1**

**D. MEASUREMENT CIRCUIT:**

HP Network analyzer

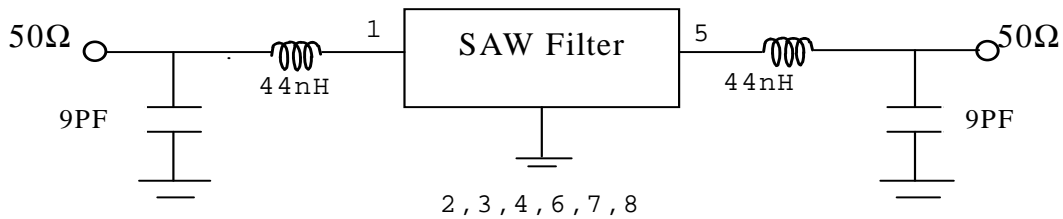

**E. OUTLINE DRAWING:**

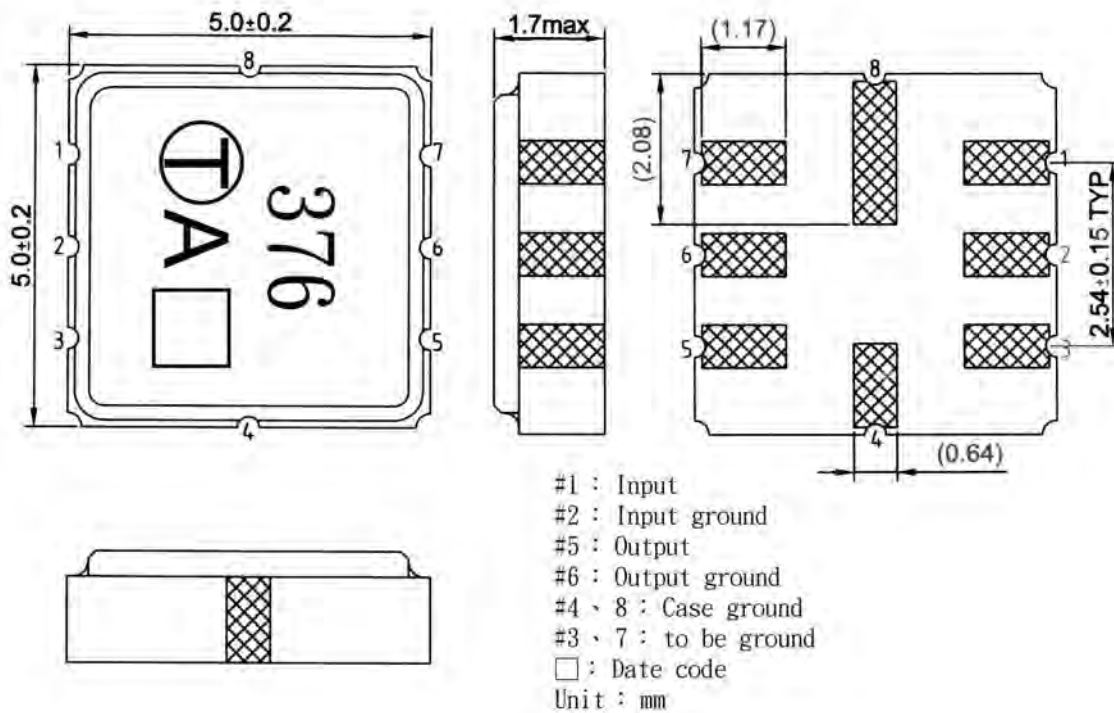

**SAW Filter 390MHz**  
**Part No: MP01620**

**Model: TA0376A**  
**Rev No: 1**

**F. PACKING:**

1. REEL DIMENSION

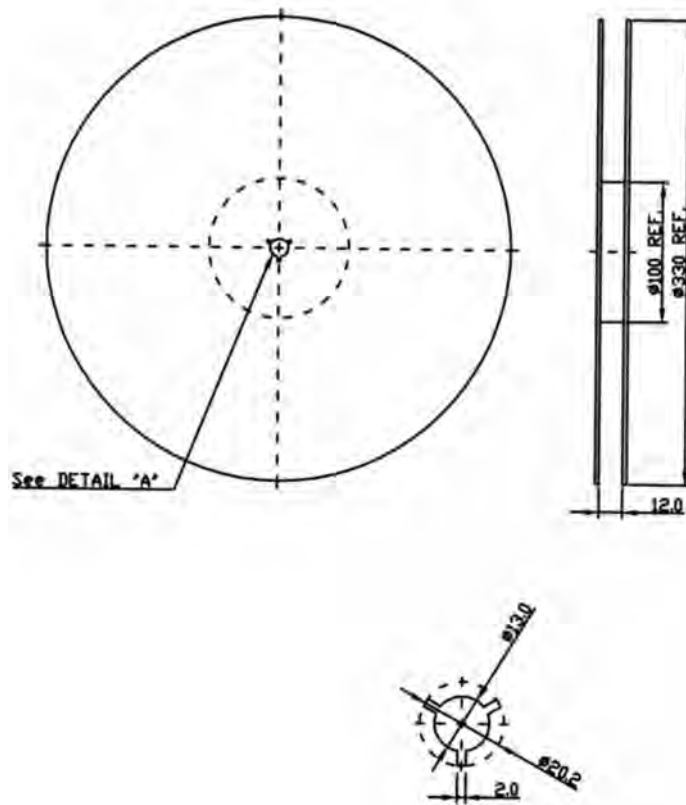

2. TAPE DIMENSION

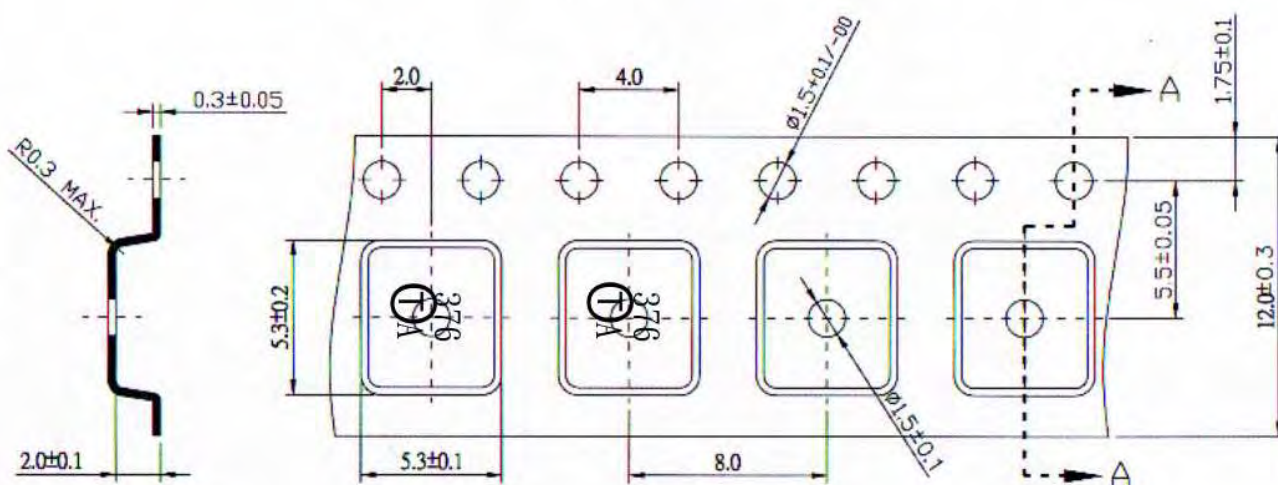

Section A-A