SAW Filter 947.5MHz
Part No: MP01417

Model: TA0373A
Rev No: 1

A. MAXIMUM RATING:

1. Input Power Level: 10dBm
2. DC voltage: 3V
3. Operating Temperature: 15°C to +35°C
4. Storage Temperature: -40°C to +85°C

B. ELECTRICAL CHARACTERISTICS:

Item	Unit	Min.	Typ.	Max.
Center Frequency F_c	MHz	-	947.5	-
Insertion Loss 935 ~ 960MHz	dB	-	2.9	4.3
Ripple 935 ~ 960MHz	dB	-	1.2	2.4
Absolute Attenuation				
800 ~ 900MHz	dB	40	47	-
1050 ~ 1095MHz	dB	40	47	-
Source impedance Z_s	Ω	-	50	-
Load impedance Z_L	Ω	-	50	-

Note: No matching network required for operation at 50 Ω

SAW Filter 947.5MHz
Part No: MP01417

Model: TA0373A
Rev No: 1

C. FREQUENCY CHARACTERISTICS:

Inband

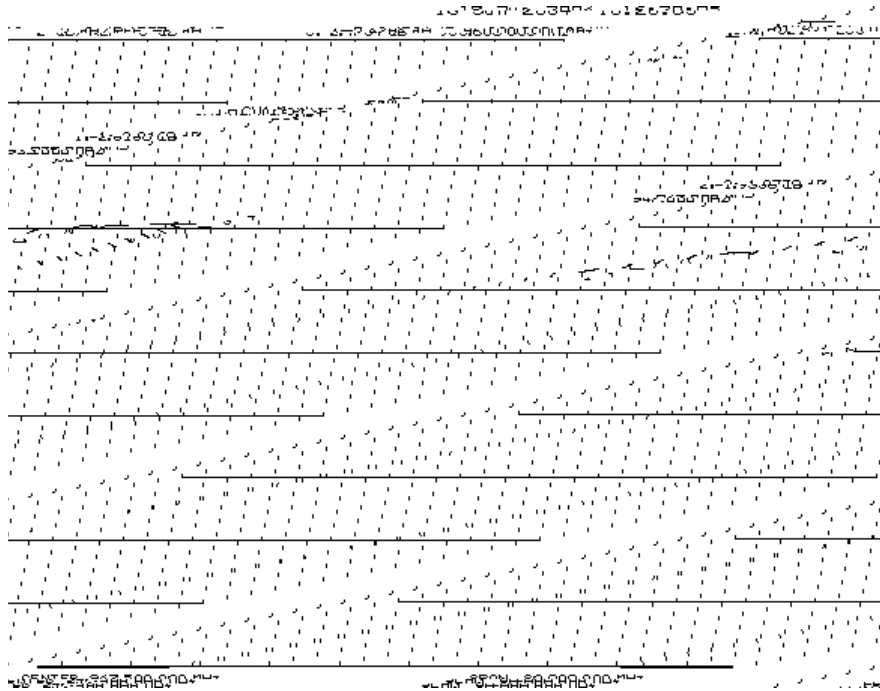

Wideband

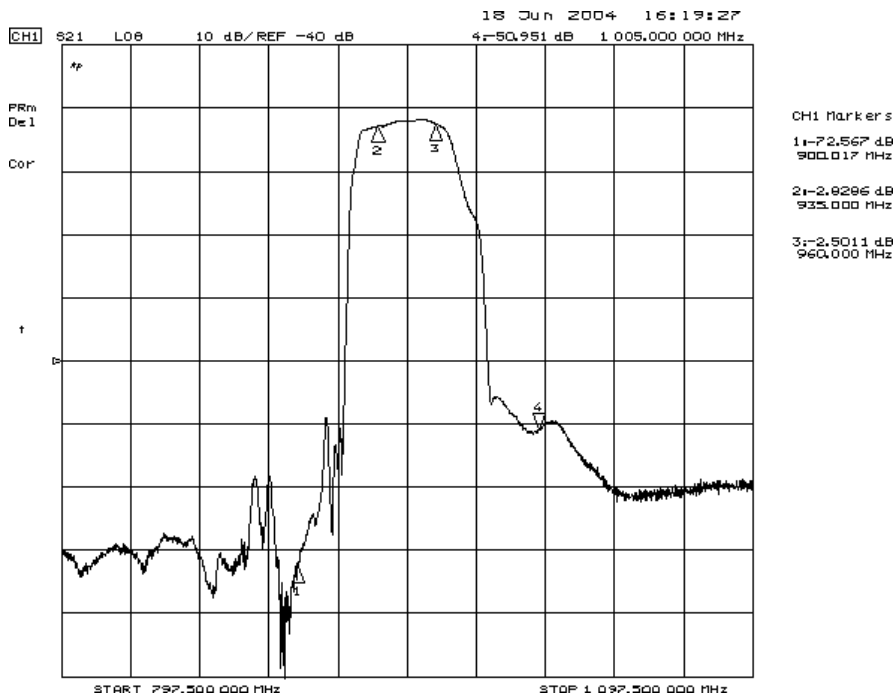

SAW Filter 947.5MHz
Part No: MP01417

Model: TA0373A
Rev No: 1

Group delay

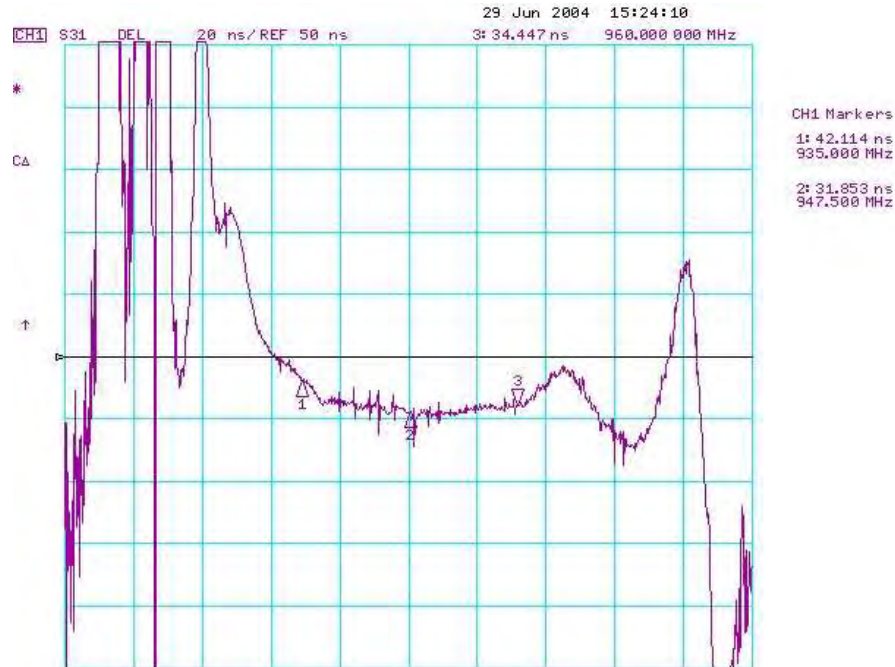

D. MEASUREMENT CIRCUIT:

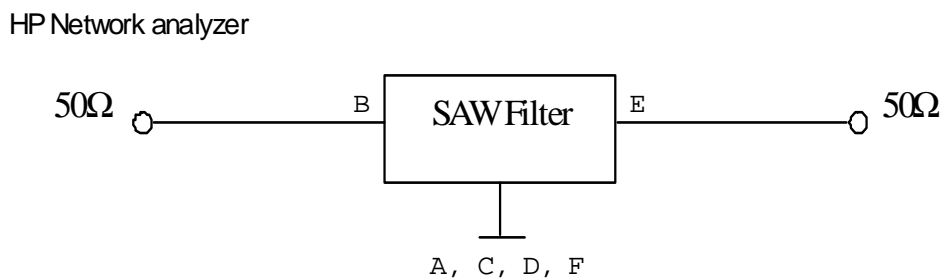

SAW Filter 947.5MHz
Part No: MP01417

Model: TA0373A
Rev No: 1

E. OUTLINE DRAWING:

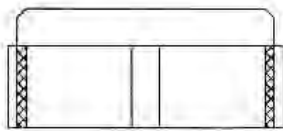
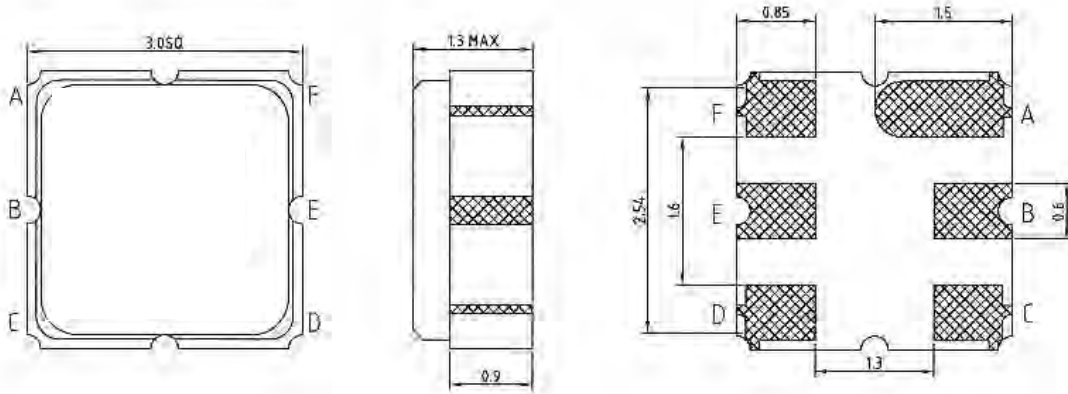

B: Input
 E: Output
 A, C, D, F: Ground
 Unit: mm

F. PCB FOOTPRINT:

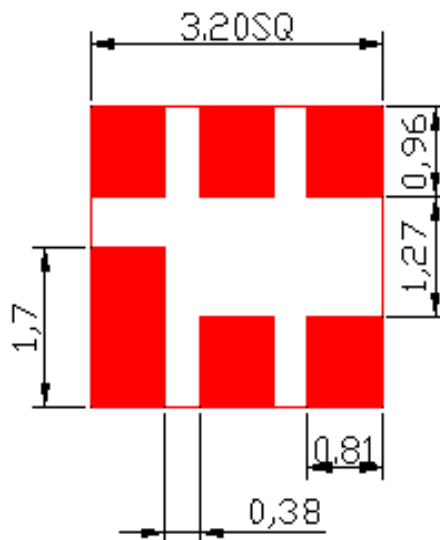

SAW Filter 947.5MHz
Part No: MP01417

Model: TA0373A
Rev No: 1

G. PACKING:

1. REEL DIMENSION

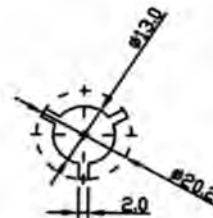
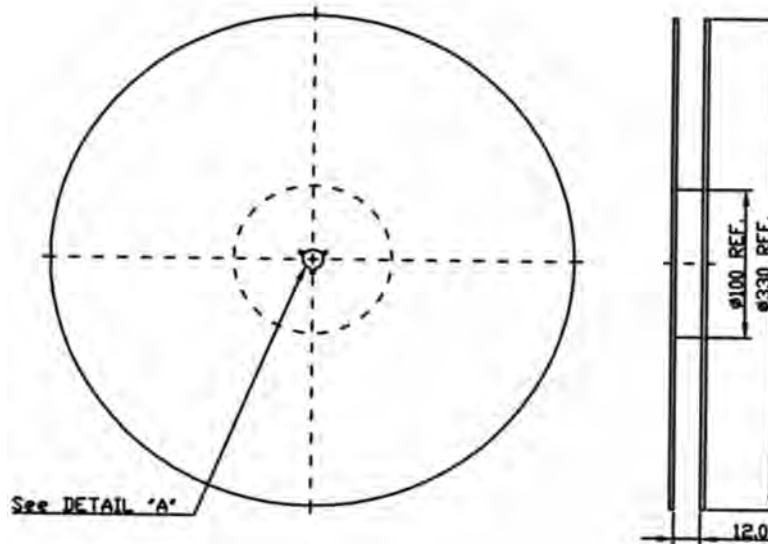

2. TAPE DIMENSION

