

210.380MHz SAW Filter

Model: TB0124A

Part No: MA09577

REV NO.: 2

A. MAXIMUM RATING:

1. Input Power Level: 10 dBm
2. DC voltage: 0 V
3. Operating Temperature: -30°C to +70°C
4. Storage Temperature: -30°C to +70°C

B. ELECTRICAL CHARACTERISTICS:

Item	Unit	Min.	Typical.	Max.	Note
Center frequency, Fc	MHz	-	210.38	-	
Insertion Loss, IL at Fc	dB	-	9.5	10.5	
Ripple at fc-0.30 ... fc+0.30 MHz	dB	-	0.6	1.2	
Phase Linearity in Fc±0.63MHz (RMS)	Deg	-	2.	3.5	
Attenuation:(Reference level from Min IL)					
Fc-0.63 ... Fc+0.63MHz	dB		3.9	5	
Fc-100 ... Fc- 50MHz	dB	57	74	-	
Fc-50 ... Fc-30MHz	dB	50	70	-	
Fc-30 ... Fc-10MHz	dB	40	60	-	
Fc-10 ... Fc-1.25 MHz	dB	25	30	-	
Fc-1.25 MHz	dB	25	30	-	
Fc+1.25 MHz	dB	29	32	-	
Fc+1.25 ... Fc+10 MHz	dB	29	32	-	
Fc+10 ... Fc+30 MHz	dB	38	56	-	
Fc+30 ... Fc+50 MHz	dB	43	65	-	
Fc+50 ... Fc+100 MHz	dB	50	70	-	

210.380MHz SAW Filter
Part No: MA09577

Model: TB0124A
REV NO.: 2

C. OUTLINE DRAWING:

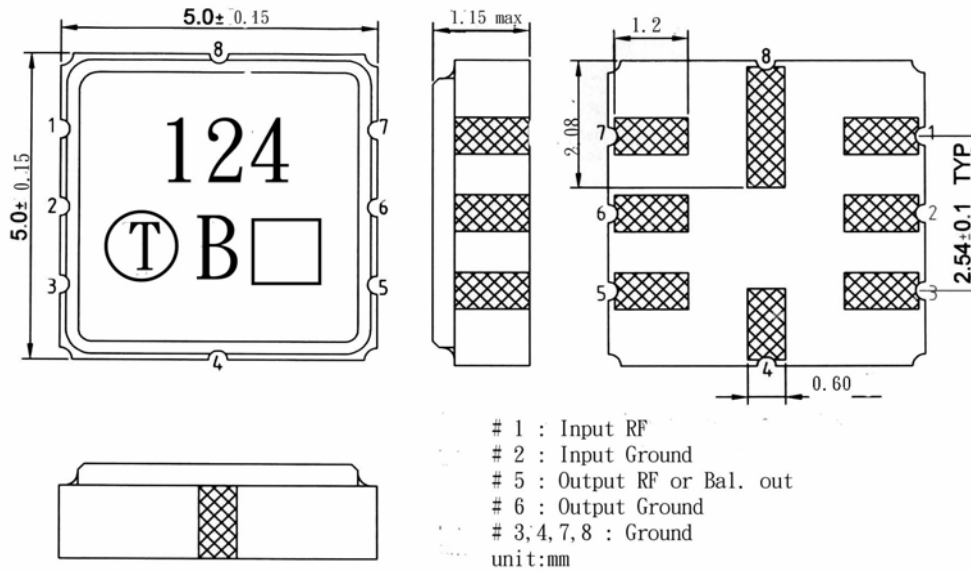

D. MATCHING CIRCUIT:

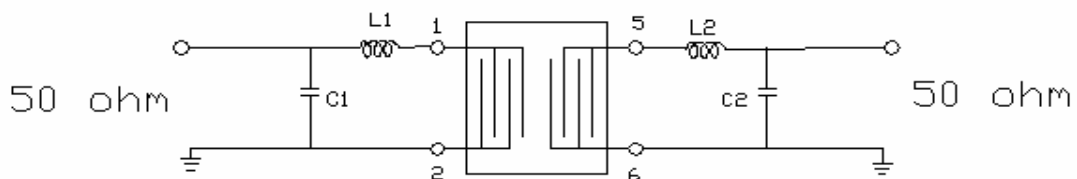

C1=20pF L1=120nH
 L2=120nH C2=27pF

210.380MHz SAW Filter
Part No: MA09577

Model: TB0124A
REV NO.: 2

E.FREQUENCY CHRACTERISTICS:

(1) Frequency response



Fig-1 S21 Response Horizontal: 1MHz/Div. Vertical: 10dB/Div

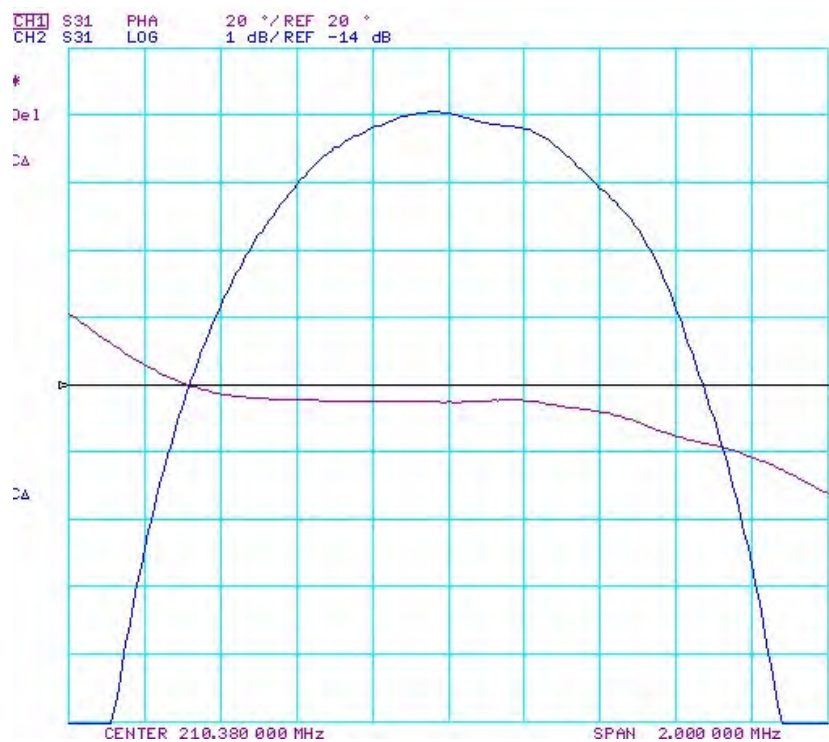

Fig-2 Phase Linearity Horizontal:0.2MHz/Div. Vertical: 1 dB/Div Vertical: 20 deg/Div

210.380MHz SAW Filter
Part No: MA09577

Model: TB0124A
REV NO.: 2

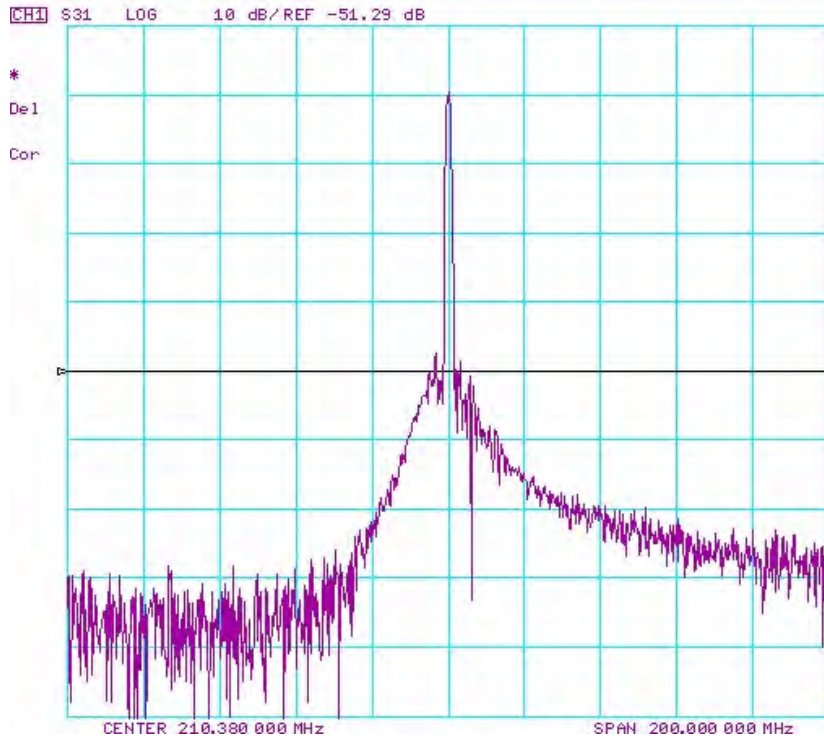

Fig-3 S21 Response Horizontal: 20MHz/Div. Vertical: 10dB/Div

210.380MHz SAW Filter
Part No: MA09577

Model: TB0124A
REV NO.: 2

F. PACKING:

1. REEL DIMENSION

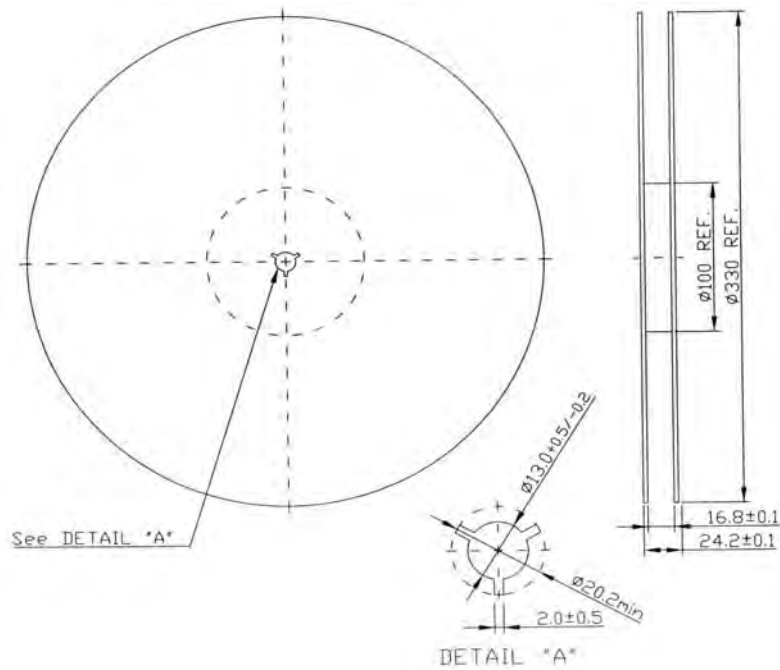

2. TAPE DIMENSION

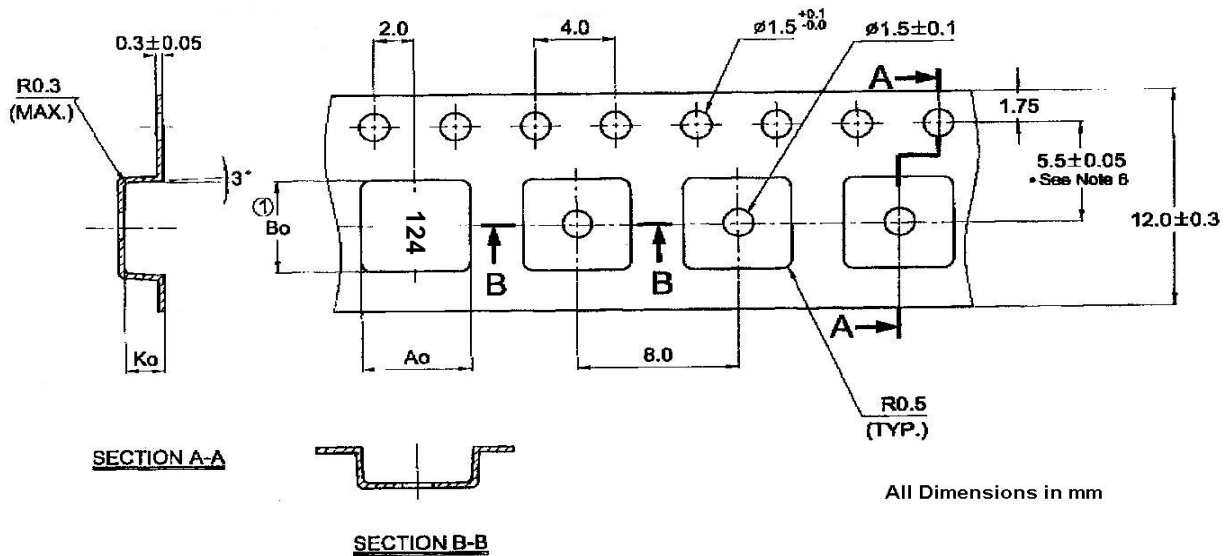

$A_o = 5.30 \pm 1$ mm
 $B_o = 5.30 + 0.2 / - 0.0$ mm
 $K_o = 2.0 \pm 0.1$ mm