

SAW Filter 475.0MHz

Model: TA0568A

Part No: MA07762

Rev No: 1

A. MAXIMUM RATING:

1. Input Power Level: 10dBm
2. DC voltage: 3V
3. Operating Temperature: 0°C to +50°C
4. Storage Temperature: -40°C to +85°C

B. ELECTRICAL CHARACTERISTICS:

Item	Unit	Min.	Typ.	Max.
Center frequency Fc	MHz	-	475	-
Insertion Loss 469 ~ 481MHz IL	dB	-	2.1	3.3
Ripple 469 ~ 481MHz	MHz	-	0.7	1.7
Absolute Attenuation: (Reference level from 0dB)				
Fc -45 to Fc -100MHz	dB	38	60	-
Fc +45 to Fc +55MHz	dB	30	58	-
Fc +55 to Fc +100MHz	dB	40	58	-
Source impedance Zs	Ω	-	50	-
Load impedance Z _L	Ω	-	50	-

C. MEASUREMENT CIRCUIT:

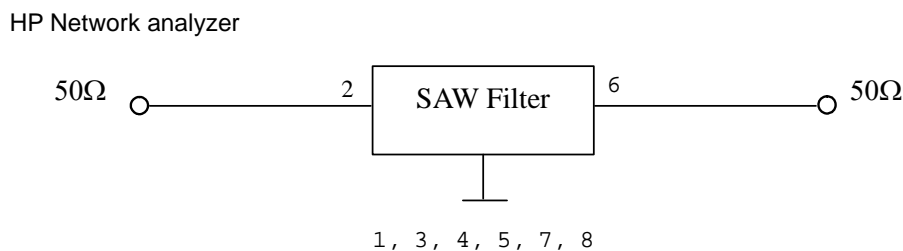

SAW Filter 475.0MHz
Part No: MA07762

Model: TA0568A
Rev No: 1

D. FREQUENCY CHARACTERISTICS:

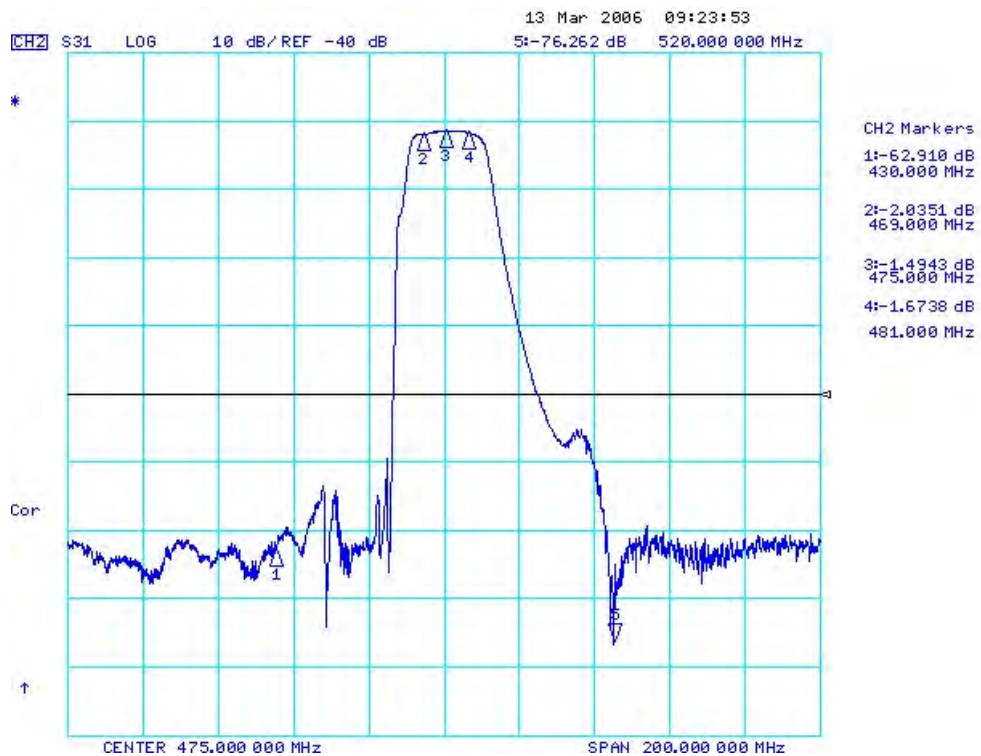

SAW Filter 475.0MHz
Part No: MA07762

Model: TA0568A
Rev No: 1

E. OUTLINE DRAWING:

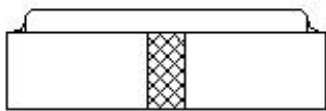
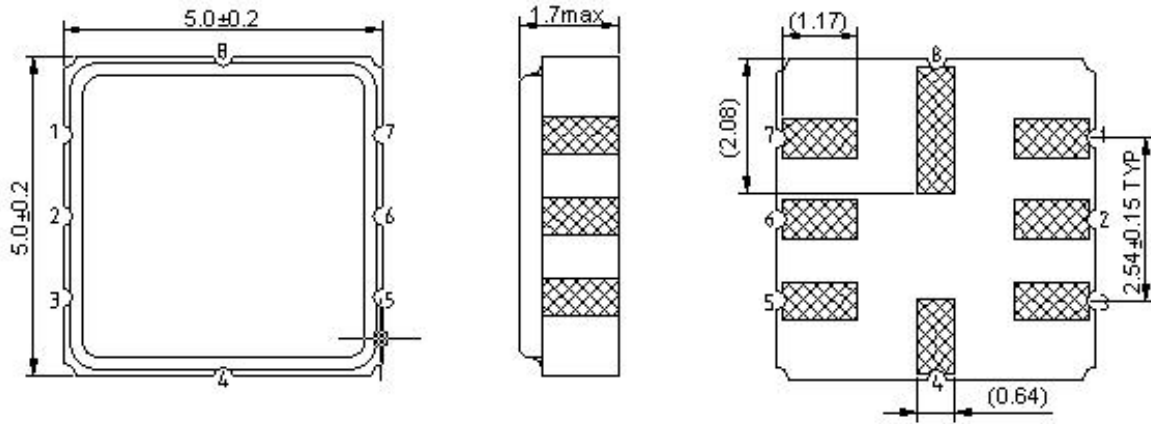

2: Input
 6: Output
 1, 3, 4, 5, 7, 8: Ground
 Unit: mm

F. PCB FOOTPRINT:

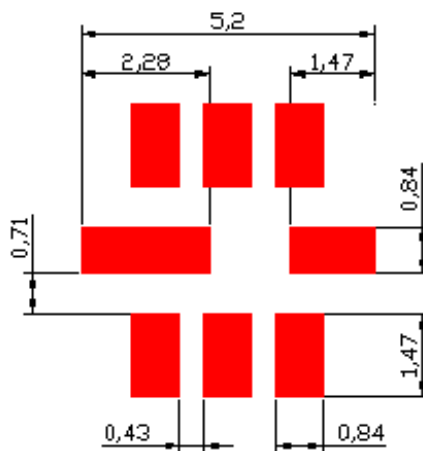

SAW Filter 475.0MHz
Part No: MA07762

Model: TA0568A
Rev No: 1

G. PACKING:

1. Reel Dimension

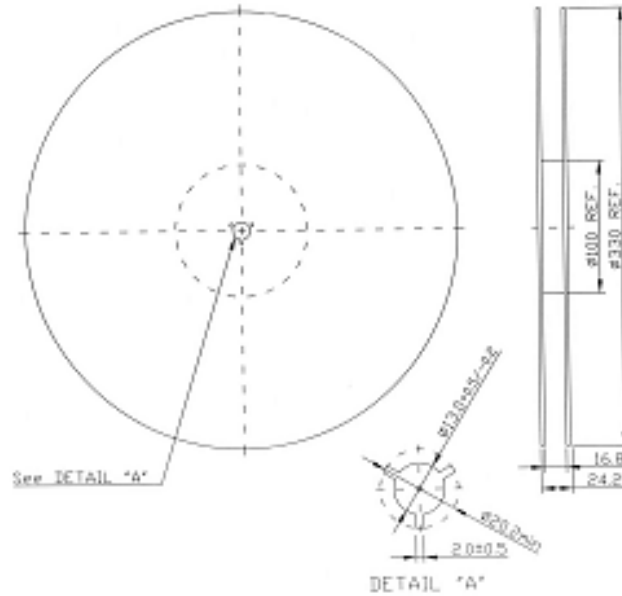

2. Tape Dimension

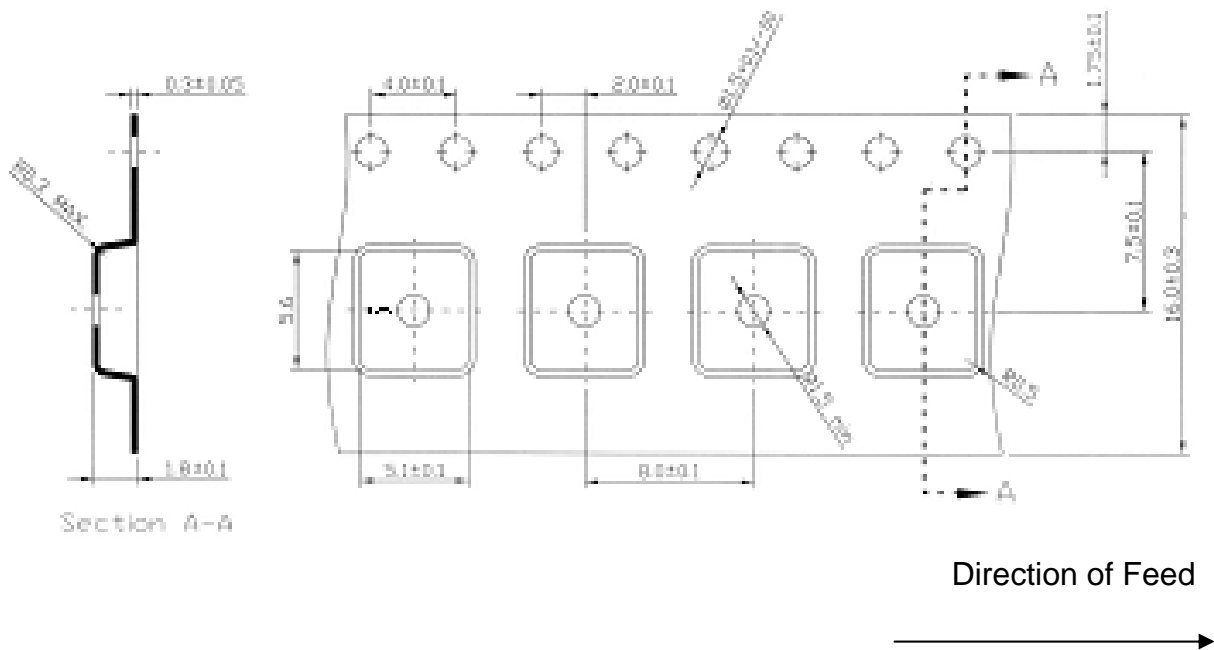

SAW Filter 475.0MHz
Part No: MA07762

Model: TA0568A
Rev No: 1

H. RECOMMENDED REFLOW PROFILE:

