

**SAW Filter 462.0MHz**  
**Part No: MP08138**

**Model: TA1677A**  
**Rev No: 1**

**A. MAXIMUM RATING:**

Electrostatic Sensitive Device (ESD)

1. Input Power Level: 10dBm
2. DC Voltage: 5V
3. Operating Temperature: -30°C to +70°C
4. Storage Temperature: -40°C to +85°C

**B. ELECTRICAL CHARACTERISTICS:**

Item	Unit	Min.	Typ.	Max.
Center frequency Fc MHz		-	462	-
1dB Bandwidth MHz	dB	20	29	-
VSWR	dB		1.6	2.0
Insertion loss 452 ~ 472MHz	dB	-	2.0	3.3
Attenuation (reference from 0dB)				
10 ~ 165MHz	dB	35	51	-
225 ~ 380MHz	dB	30	55	-
380 ~ 396MHz	dB	25	53	-
396 ~ 418MHz	dB	15	51	-
508 ~ 528MHz	dB	15	35	-
528 ~ 540MHz	dB	25	46	-
540 ~ 663MHz	dB	30	47	-
663 ~ 850MHz	dB	27	41	-
Source impedance Z <sub>S</sub>	Ω	-	50	-
Load impedance Z <sub>L</sub>	Ω	-	50	-

**SAW Filter 462.0MHz**  
**Part No: MP08138**

**Model: TA1677A**  
**Rev No: 1**

**C. FREQUENCY CHARACTERISTICS:**

1. Wideband response: (span 840MHz)

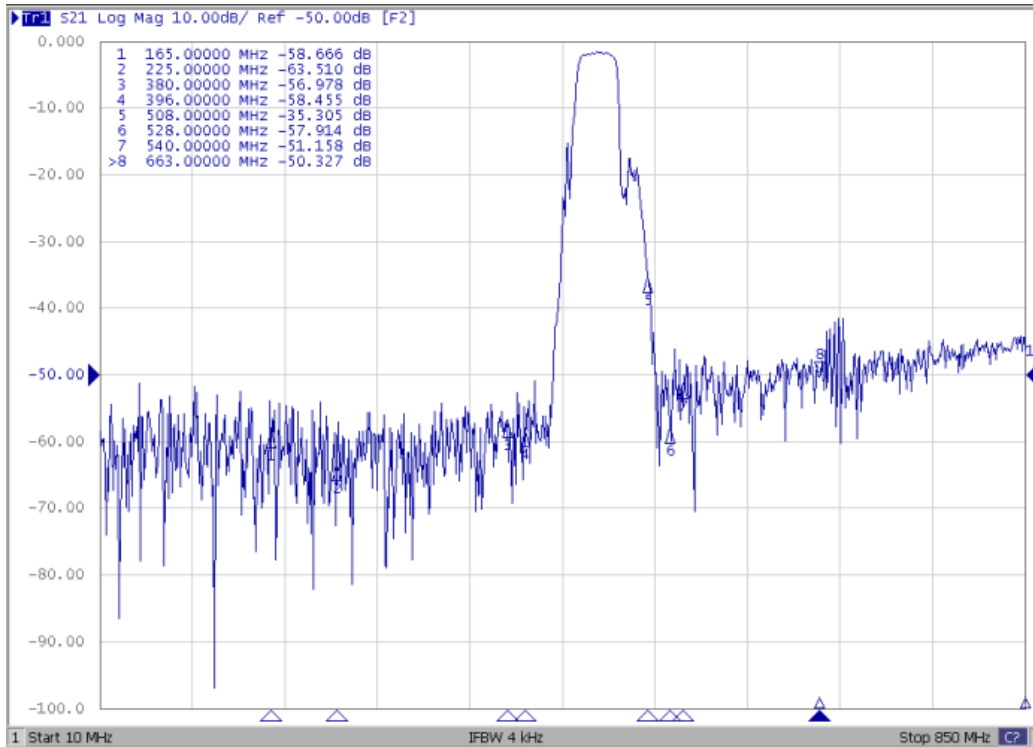

2. S21 response: (span 200MHz)

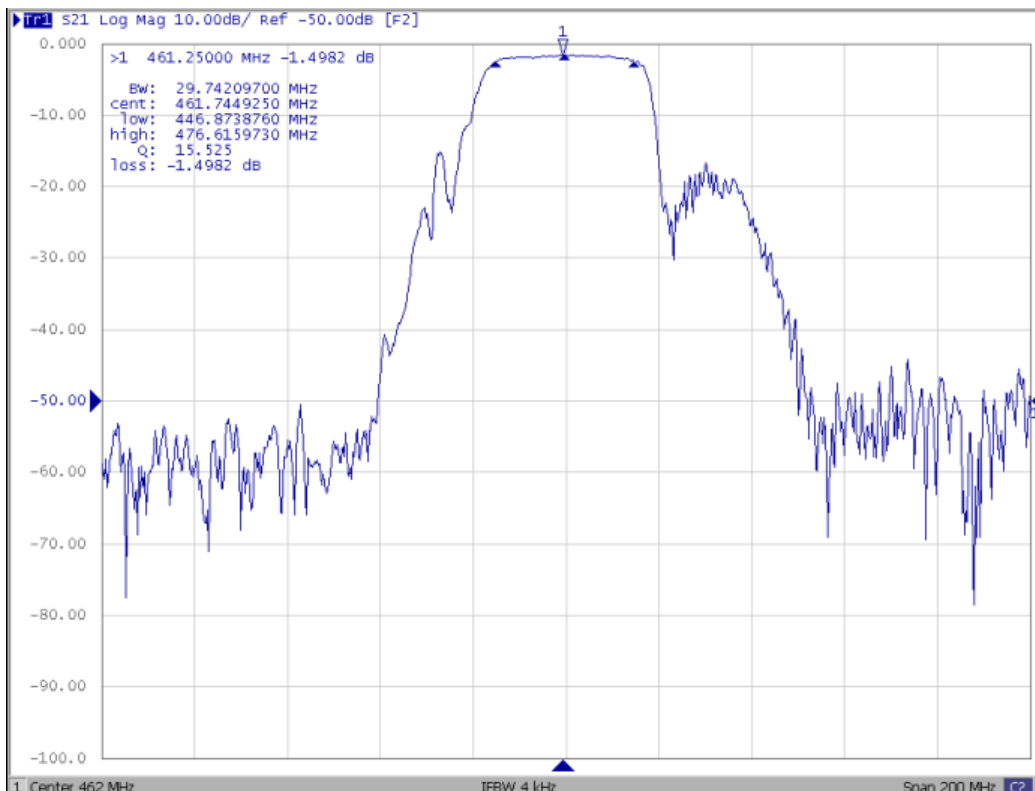

**SAW Filter 462.0MHz**  
**Part No: MP08138**

**Model: TA1677A**  
**Rev No: 1**

3. Passband response: (span 50MHz)

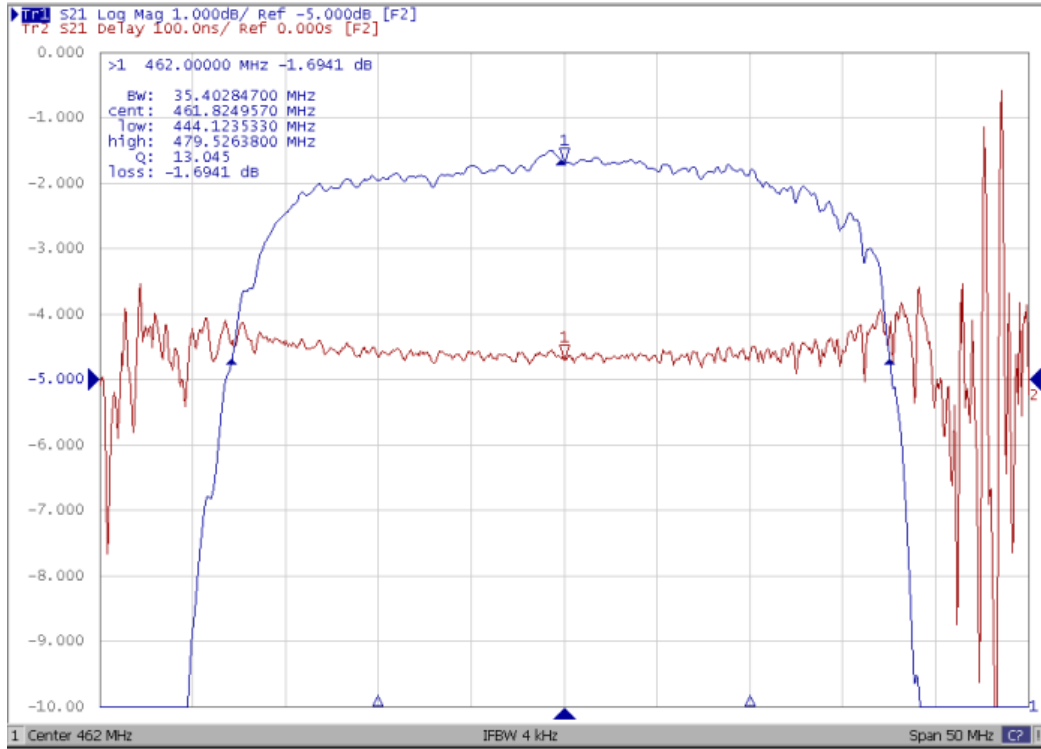

4. S11 & S22 VSWR: (span 50MHz)

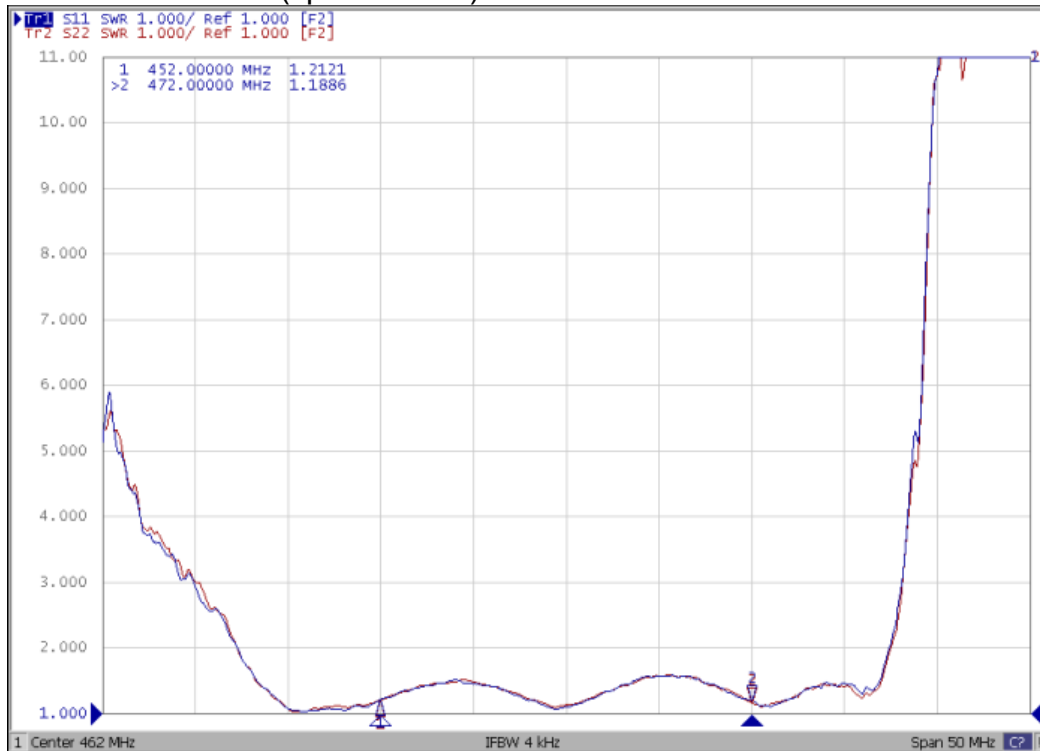

**SAW Filter 462.0MHz**

**Model: TA1677A**

**Part No: MP08138**

**Rev No: 1**

**D. MEASUREMENT CIRCUIT:**

HP Network analyzer

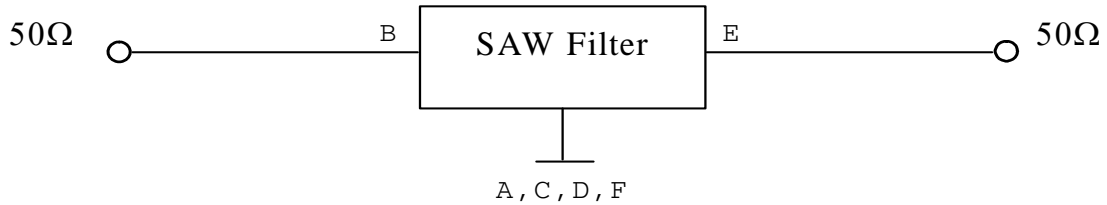

**E. OUTLINE DRAWING:**

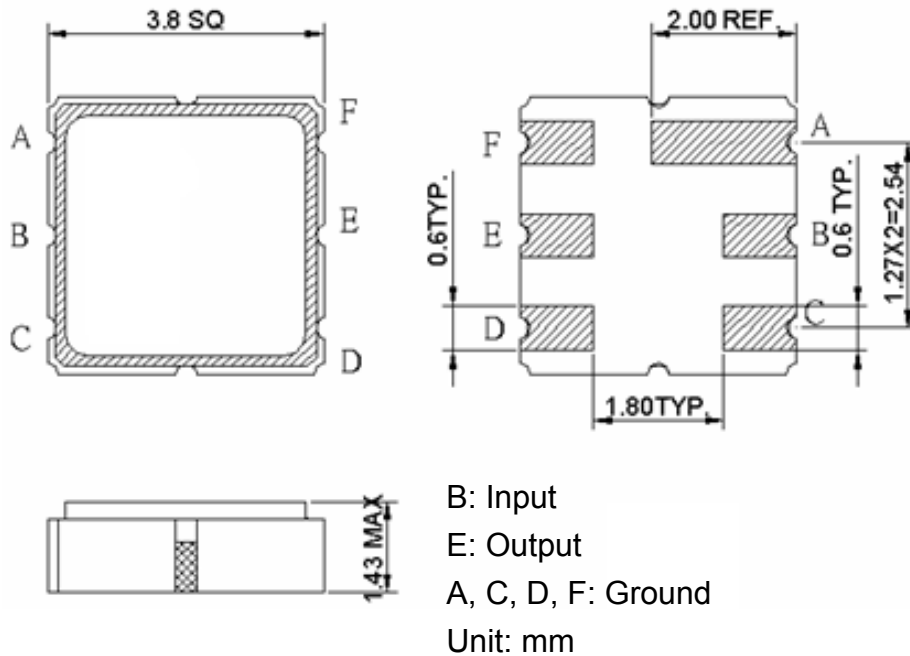

**F. PCB FOOTPRINT:**

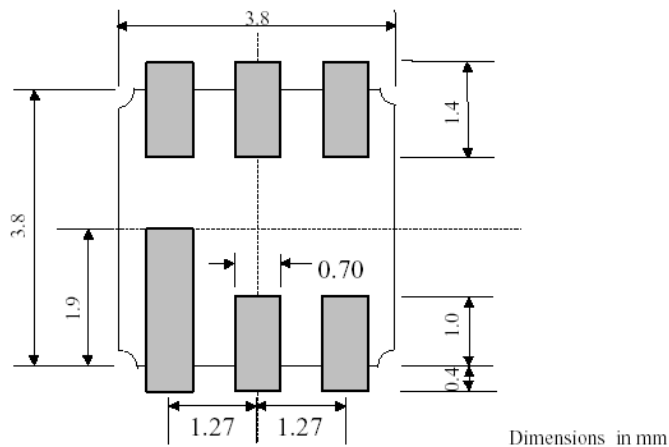

**SAW Filter 462.0MHz**  
**Part No: MP08138**

**Model: TA1677A**  
**Rev No: 1**

**G. PACKING:**

1. Reel Dimension

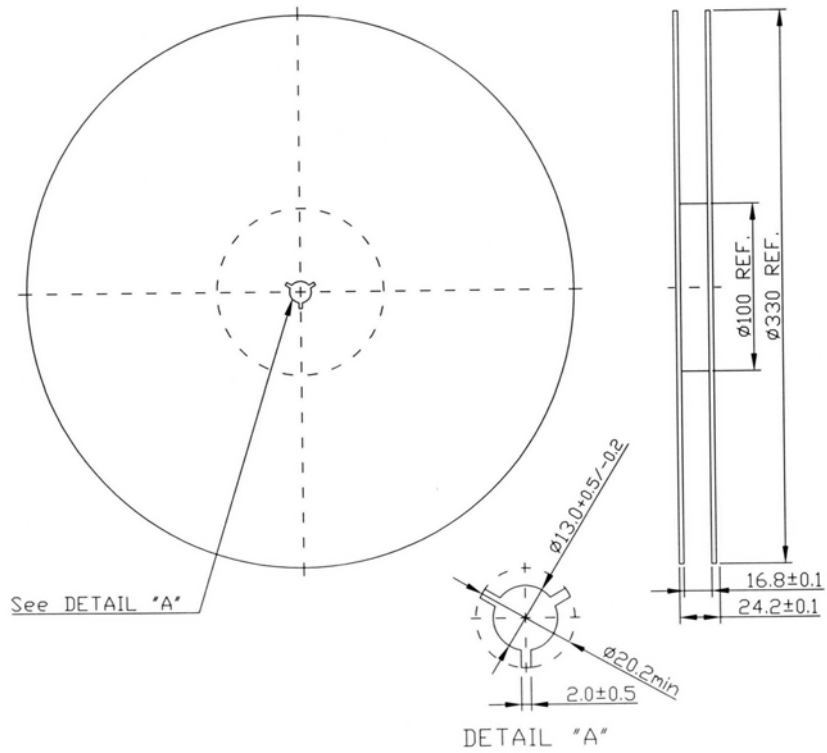

2. Tape Dimension

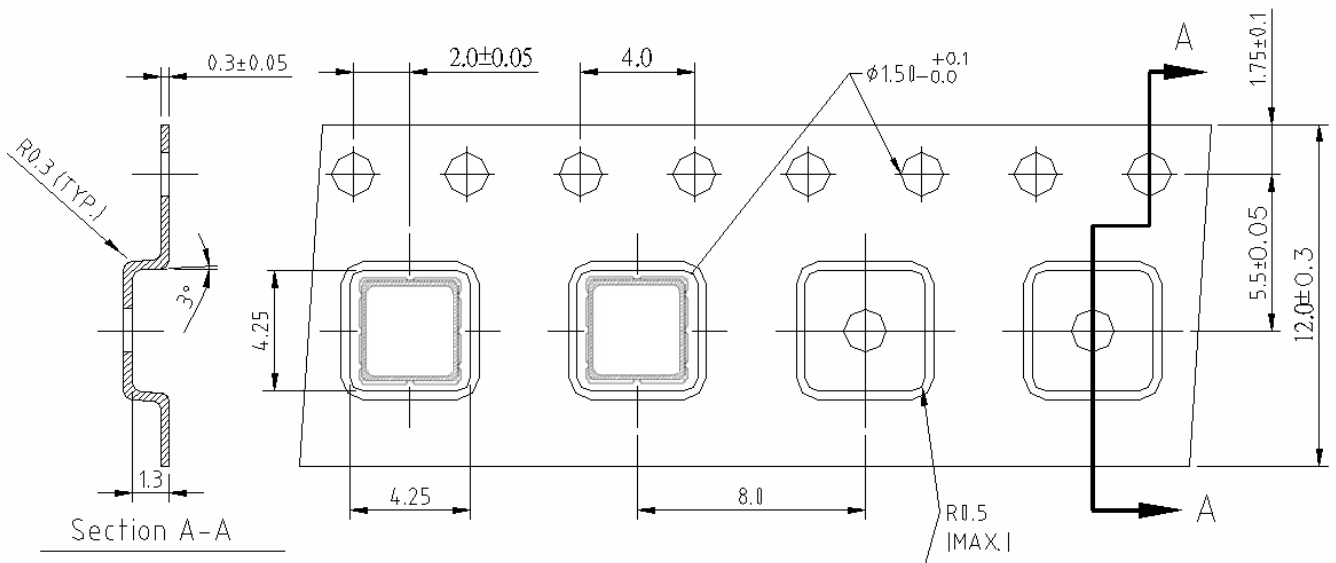

**SAW Filter 462.0MHz**  
**Part No: MP08138**

**Model: TA1677A**  
**Rev No: 1**

**H. RECOMMENDED REFLOW PROFILE:**

