

SAW Filter 1330.0MHz
Part No: MA07340

Model: TA0375A
Rev No: 1

A. MAXIMUM RATING:

1. Input Power Level: 10dBm
2. DC voltage: 3V
3. Operating Temperature: -25°C to +85°C
4. Storage Temperature: -40°C to +85°C

B. ELECTRICAL CHARACTERISTICS:

Balanced to balanced operation

Terminating source impedance: $Z_S = 100\Omega$

Terminating load impedance: $Z_L = 100\Omega$

Item	Unit	Min.	Typ.	Max.
Center Frequency F_c	MHz	-	1330	-
Insertion Loss 1326 ~ 1334MHz	dB	-	3.2	4.5
Absolute Group delay 1330MHz	ns		34	60
Group delay variation $F_c \pm 4$ MHz	ns		8	35
Phase variation $F_c \pm 4$ MHz	Deg		4	25
Amplitude ripple (p-p) $F_c \pm 4$ MHz	dB		0.5	2.0
Rejection (reference to IL)				
$F_c -30$ MHz	dB	8	29	-
$F_c +30$ MHz	dB	7	18	-
$F_c -60$ MHz	dB	30	52	-
$F_c +60$ MHz	dB	30	38	-
$F_c -140$ MHz	dB	30	47	-
$F_c +140$ MHz	dB	30	42	-
$F_c -250$ MHz	dB	35	44	-
$F_c +250$ MHz	dB	35	44	-

SAW Filter 1330.0MHz
Part No: MA07340

Model: TA0375A
Rev No: 1

C. FREQUENCY CHARACTERISTICS:

Transfer Function

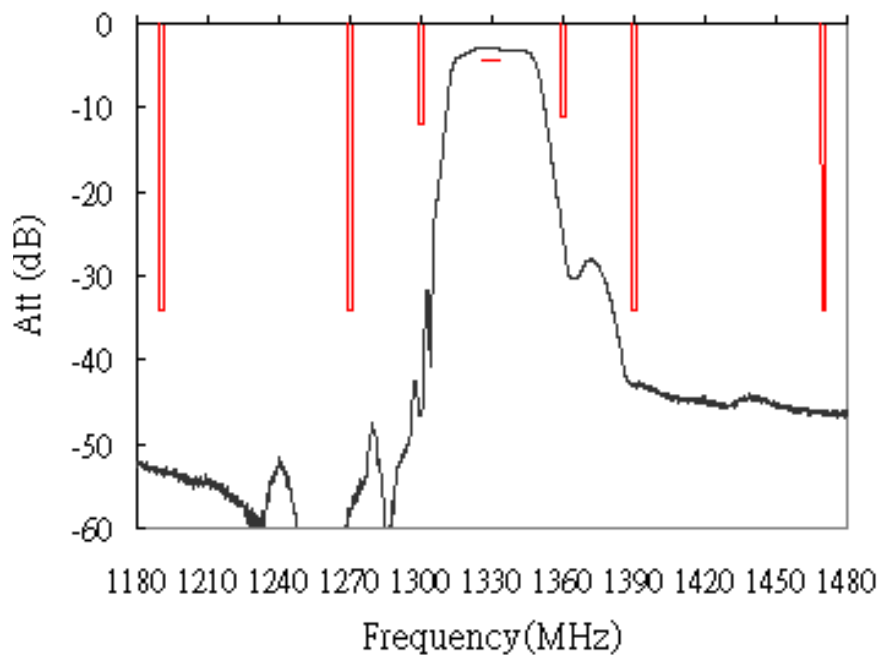
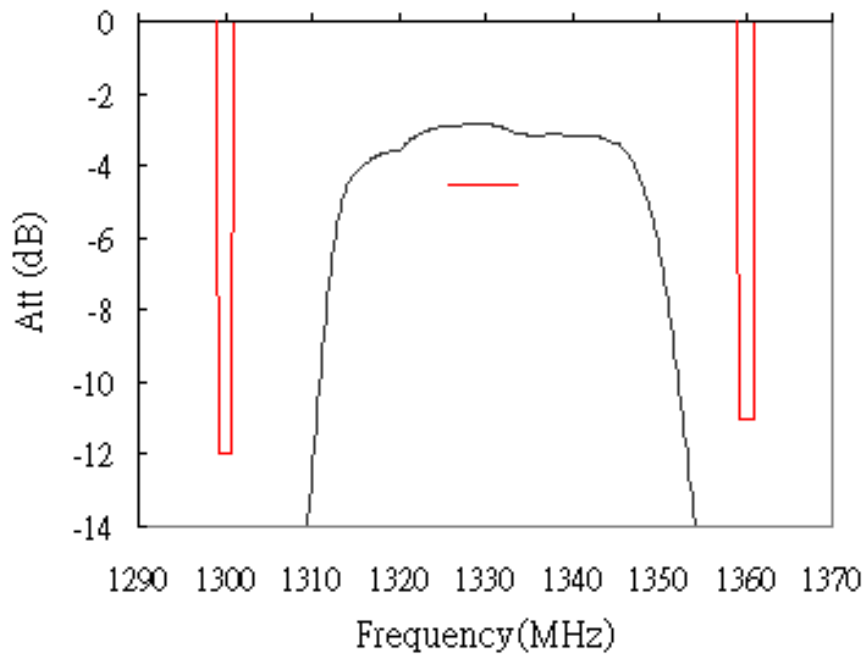

SAW Filter 1330.0MHz
Part No: MA07340

Model: TA0375A
Rev No: 1

Phase Variation

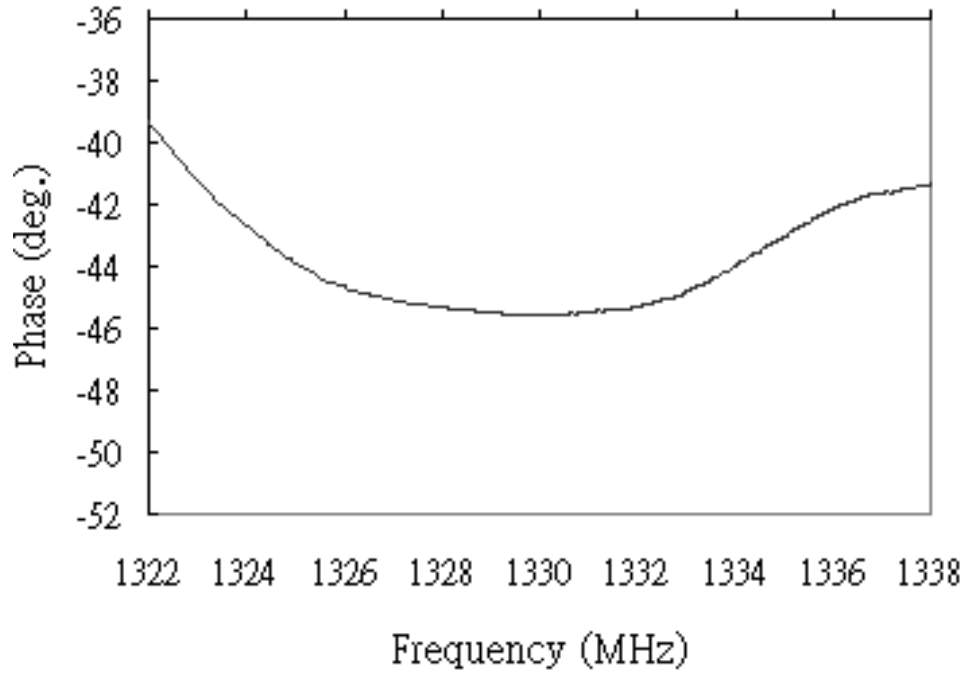

Group Delay

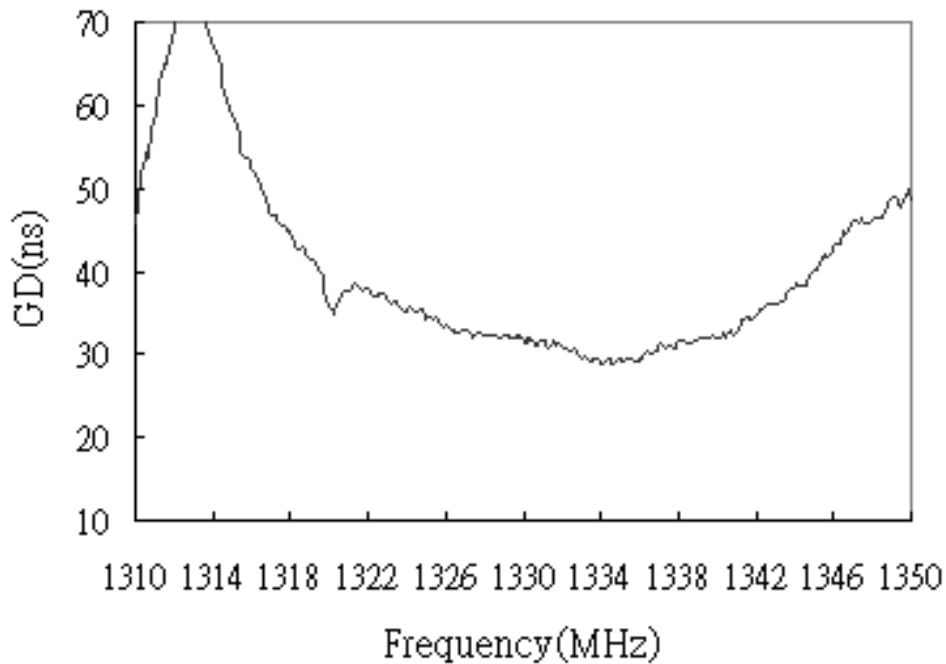

SAW Filter 1330.0MHz
Part No: MA07340

Model: TA0375A
Rev No: 1

D. MEASUREMENT CIRCUIT:

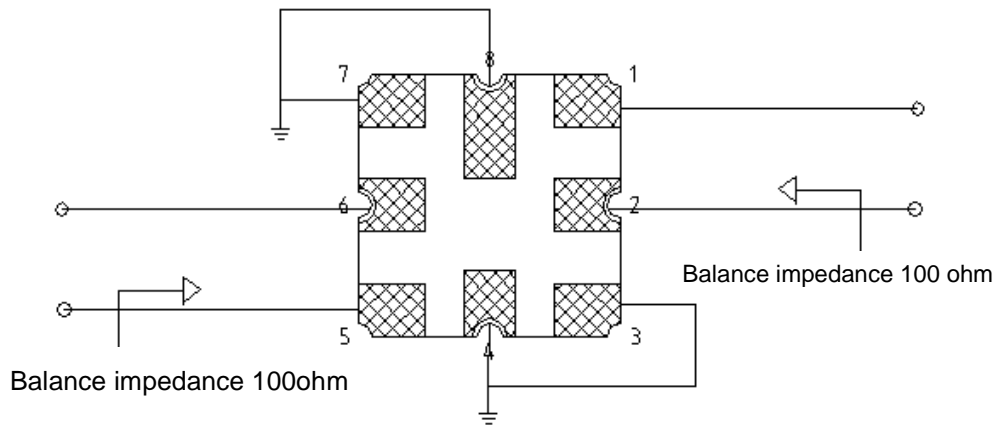

E. OUTLINE DRAWING:

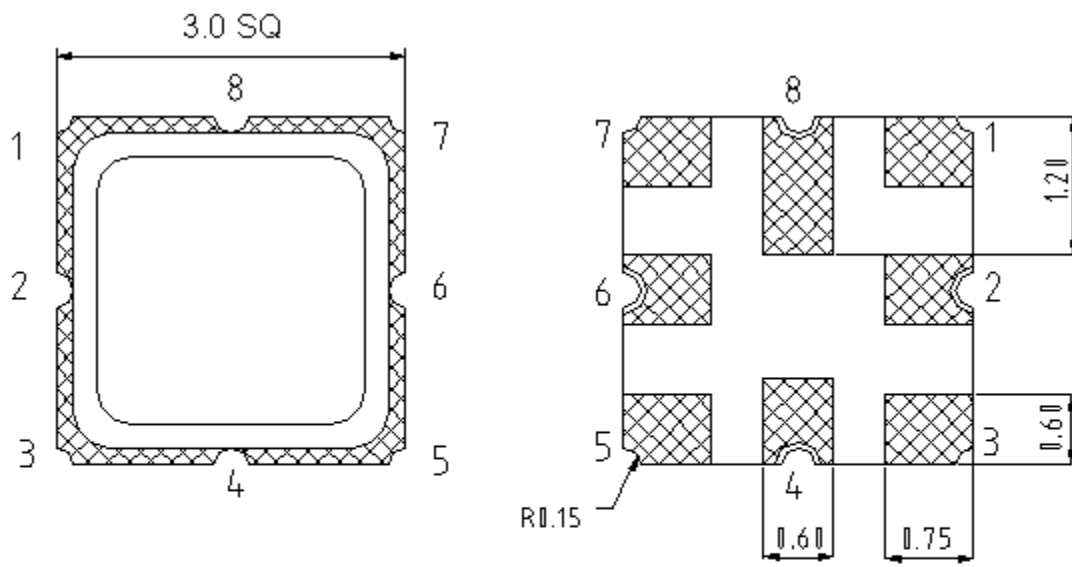

1, 2: Balanced Input
 5, 6: Balanced Output
 3, 4, 7, 8: Ground
 Unit: mm

SAW Filter 1330.0MHz
Part No: MA07340

Model: TA0375A
Rev No: 1

F. PACKING:

1. REEL DIMENSION

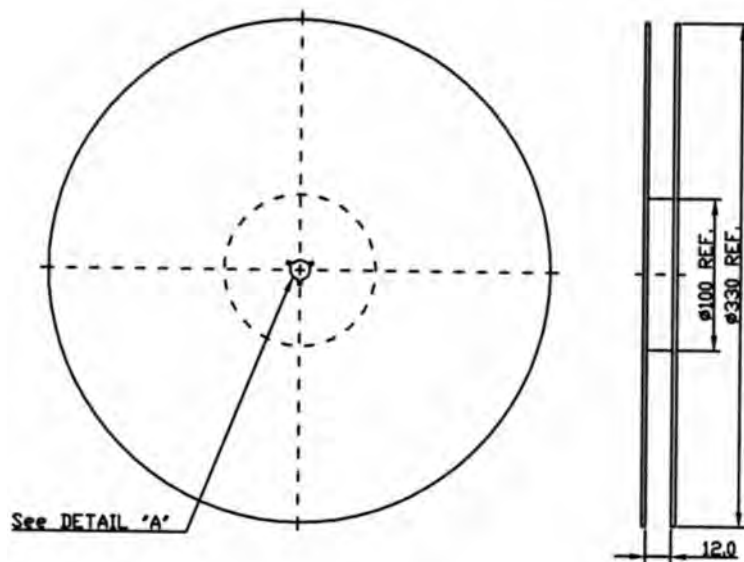

2. TAPE DIMENSION

