

SAW Filter 159.16250MHz
Part No: MA06510

Model: TA0395A
Rev No: 3

A. MAXIMUM RATING:

1. Input Power Level: 20dBm
2. DC voltage: 5V
3. Operating Temperature: -30°C to +70°C
4. Storage Temperature: -40°C to +85°C

B. ELECTRICAL CHARACTERISTICS:

Item	Unit	Min.	Typ.	Max.
Center Frequency Fc	MHz	-	159.1625	-
Insertion Loss 156.3 ~ 162.025MHz IL	dB	-	2.3	3.8
Attenuation (Reference from 0dB)				
Fc -50 ~ Fc -30MHz	dB	42	57	-
Fc -30 ~ Fc -15MHz	dB	36	55	-
Fc +30 ~ Fc +50MHz	dB	42	55	-
Source impedance Z _S	Ω	-	50	-
Load impedance Z _L	Ω	-	50	-

SAW Filter 159.16250MHz
Part No: MA06510

Model: TA0395A
Rev No: 3

C. FREQUENCY CHARACTERISTICS:

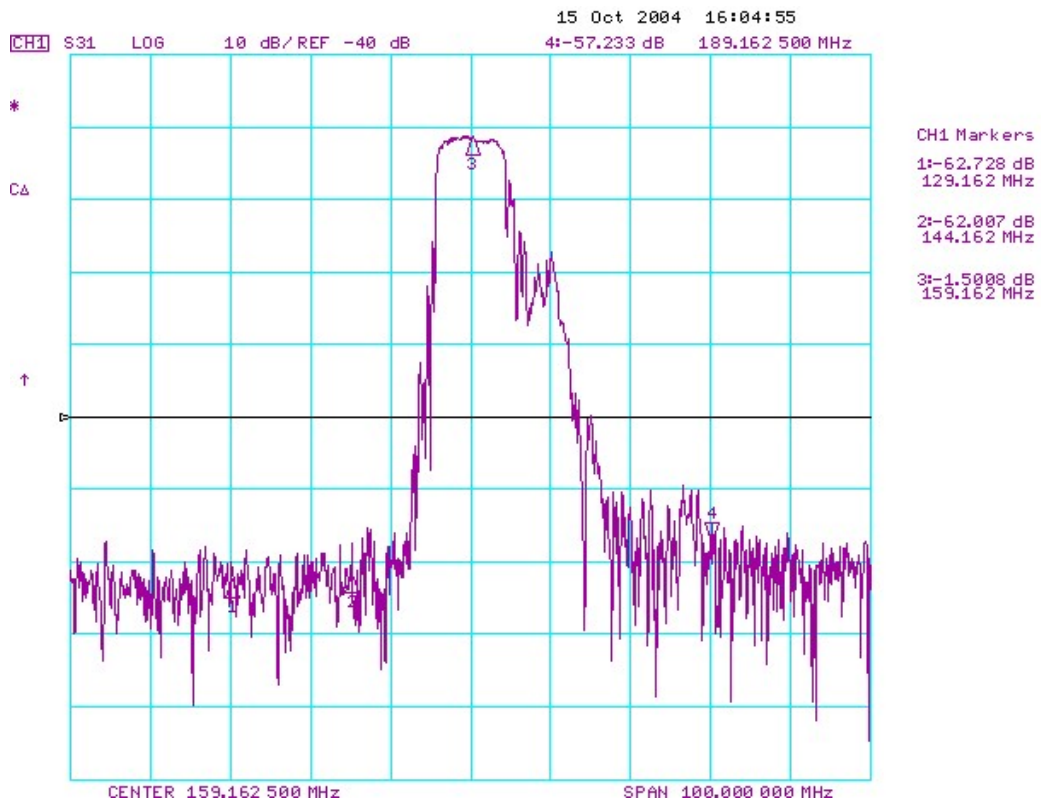

SAW Filter 159.16250MHz
Part No: MA06510

Model: TA0395A
Rev No: 3

D. MEASUREMENT CIRCUIT:

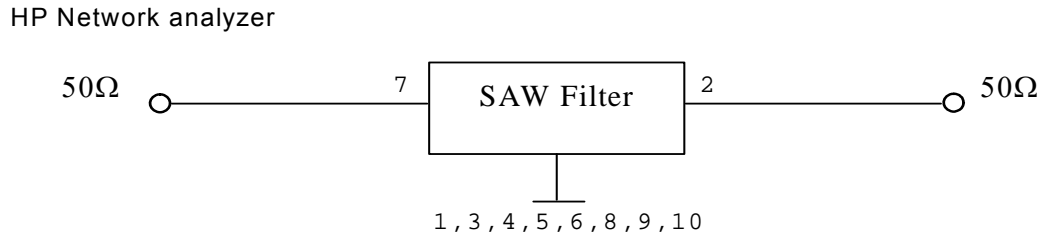

E. OUTLINE DRAWING:

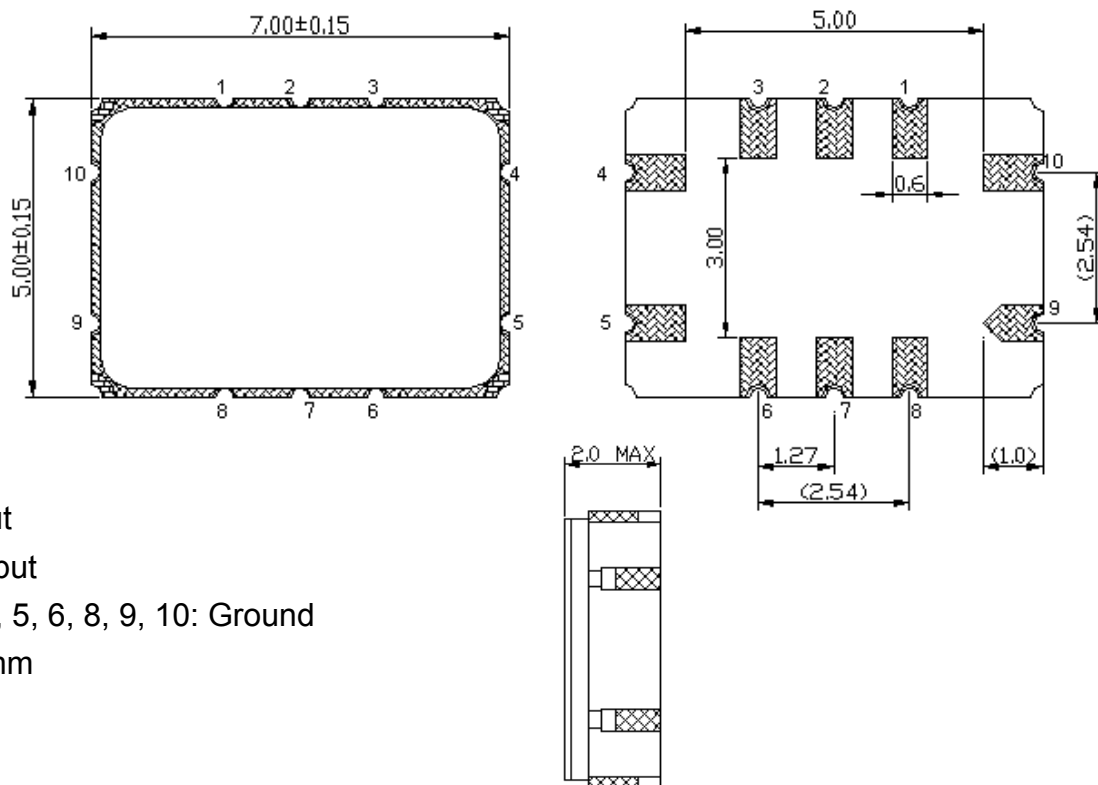

7: Input
 2: Output
 1, 3, 4, 5, 6, 8, 9, 10: Ground
 Unit: mm

SAW Filter 159.16250MHz
Part No: MA06510

Model: TA0395A
Rev No: 3

F. PCB FOOTPRINT:

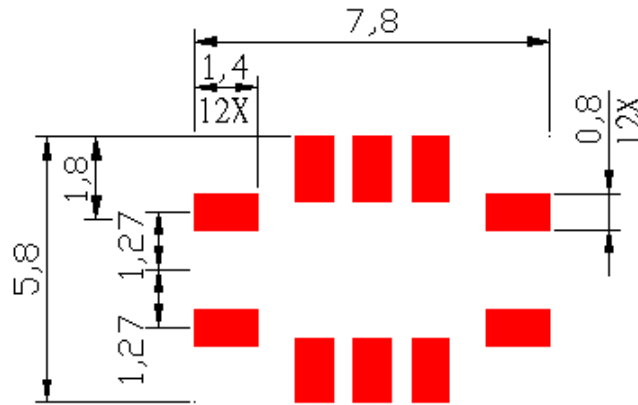

SAW Filter 159.16250MHz
Part No: MA06510

Model: TA0395A
Rev No: 3

G. PACKING:

1. Reel Dimension

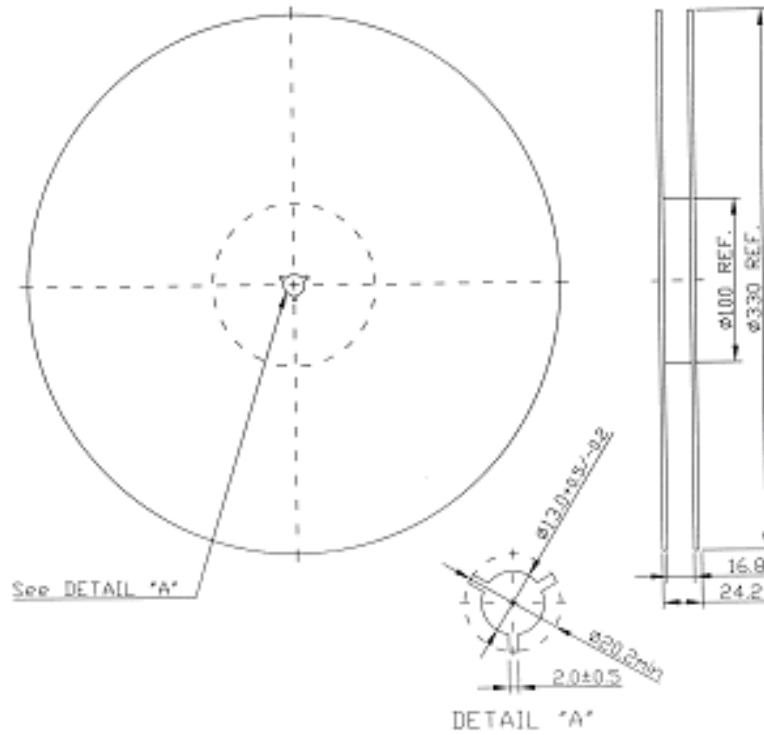

2. Tape Dimension

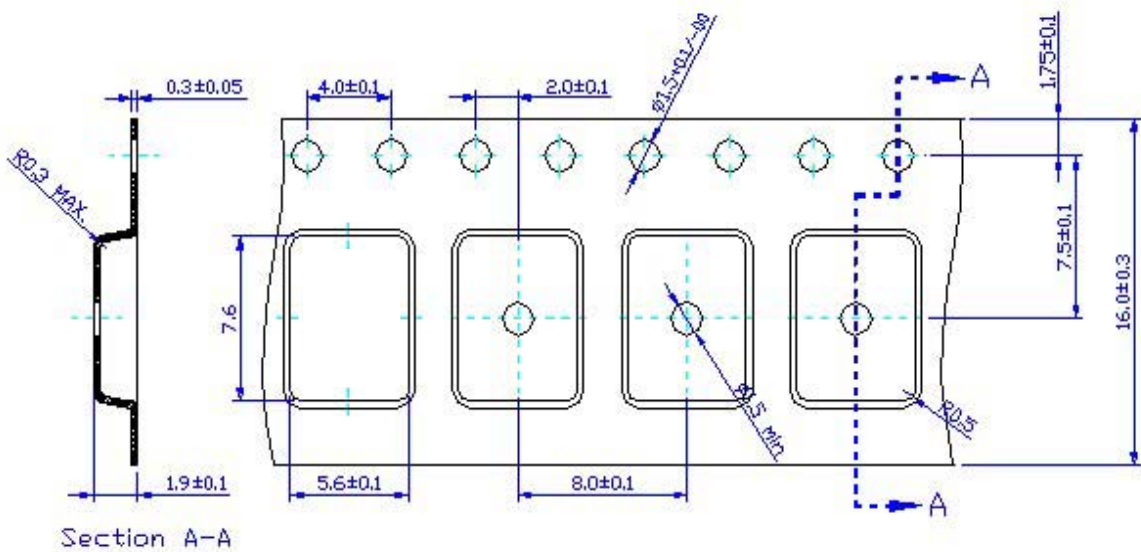

SAW Filter 159.16250MHz
Part No: MA06510

Model: TA0395A
Rev No: 3

H. RECOMMENDED REFLOW PROFILE:

