

374.0 MHz SAW Filter

Model: TB0151A

Part No: MA05701

REV NO.: 3

A. MAXIMUM RATING:

1. Input Power Level: 10 dBm
2. Operating Temperature: -10°C to 85°C
3. Storage Temperature: -40°C to 85°C

B. ELECTRICAL CHARACTERISTICS:

Item	Unit	Min.	Type.	Max.
Center frequency, Fc	MHz	-	374	-
Insertion Loss, IL (From Min IL)	dB	-	7.5	9
Passband width, BW3	MHz	14	15	-
Amplitude Ripple in Fc±4MHz	dB	-	0.5	1
Group delay ripple in Fc±4MHz	nS	-	57	100
Attenuation:(Reference level from Min IL)				
Rejection: 279-346MHz	dB	40	49	-
Rejection: 346-357MHz	dB	40	46	-
Rejection: 357-360.5MHz	dB	35	43	-
Rejection: 387.5-391MHz	dB	25	38	-
Rejection: 391-425MHz	dB	30	44	-
Rejection: 425-469MHz	dB	40	46	-

374.0 MHz SAW Filter
Part No: MA05701

Model: TB0151A
REV NO.: 3

B. FREQUENCY CHARACTERISTICS:

1. Wide band of Response:

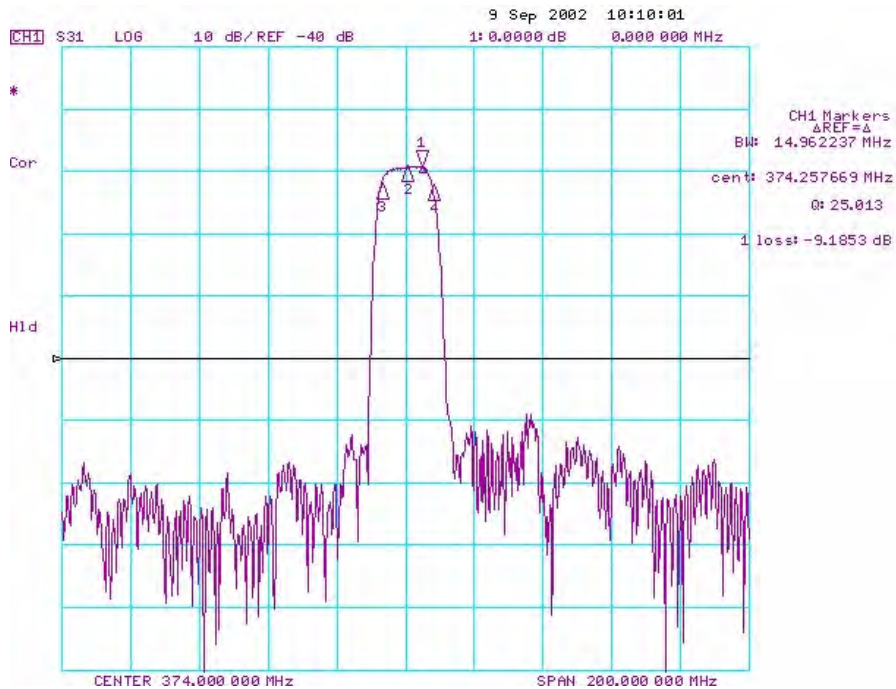

Fig-1 S21 Response Horizontal: 20MHz/Div. Vertical: 10dB/Div. Ref: -40dB

2. Group Delay and Ripple

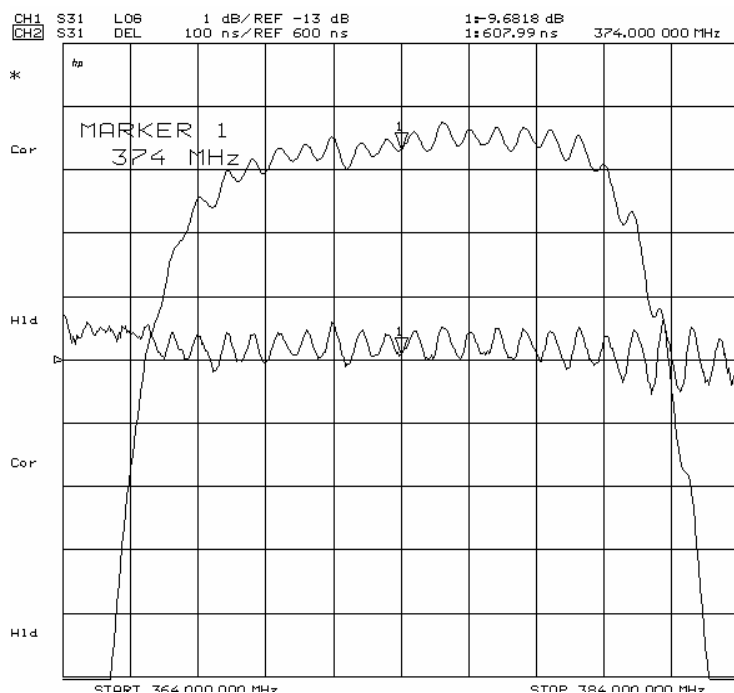

Fig-2 S21 Response. Horizontal: 3 MHz/Div Vertical: 1dB/Div, Ref: -13dB.
 Vertical 2: 100nS/Div, Ref: 600nS

374.0 MHz SAW Filter

Model: TB0151A

Part No: MA05701

REV NO.: 3

D. MEASUREMENT CIRCUIT:

(1) 50Ω unbalanced:

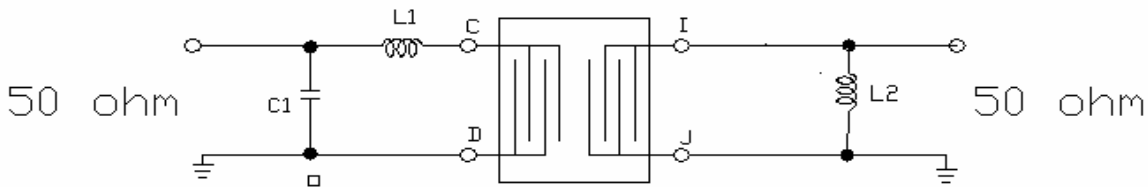

L1=8nH, L2=15nH
 C1=10pF

E. OUTLINE DRAWING:

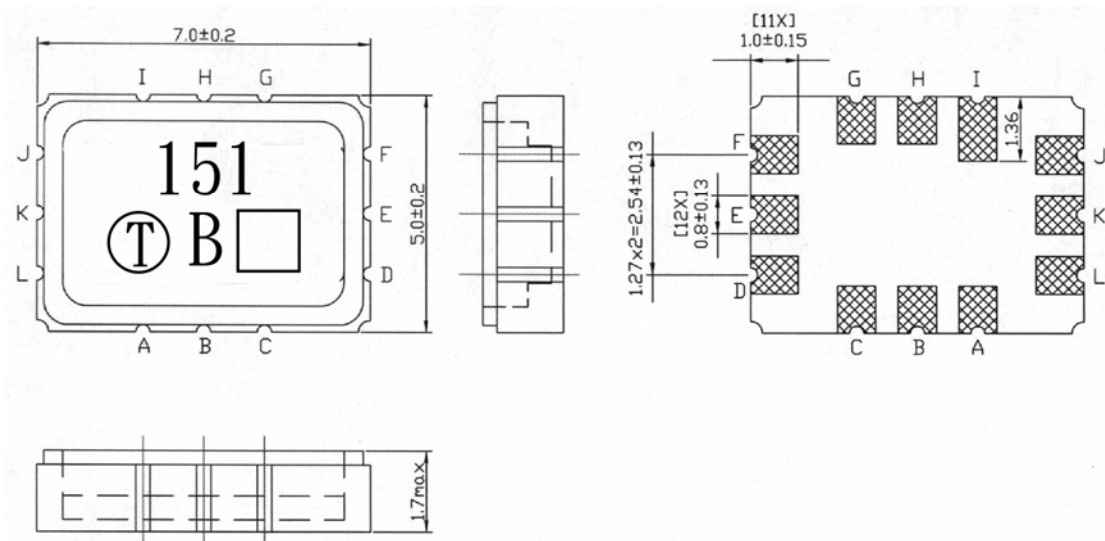

- Pin C: Input
 - Pin D: Input Ground
 - Pin I : Output
 - Pin J: Output Ground
 - A,G,E,F,K,L case ground
 - B,H to be ground
- Unit: mm

374.0 MHz SAW Filter
Part No: MA05701

Model: TB0151A
REV NO.: 3

F. PACKING:

1. REEL DIMENSION

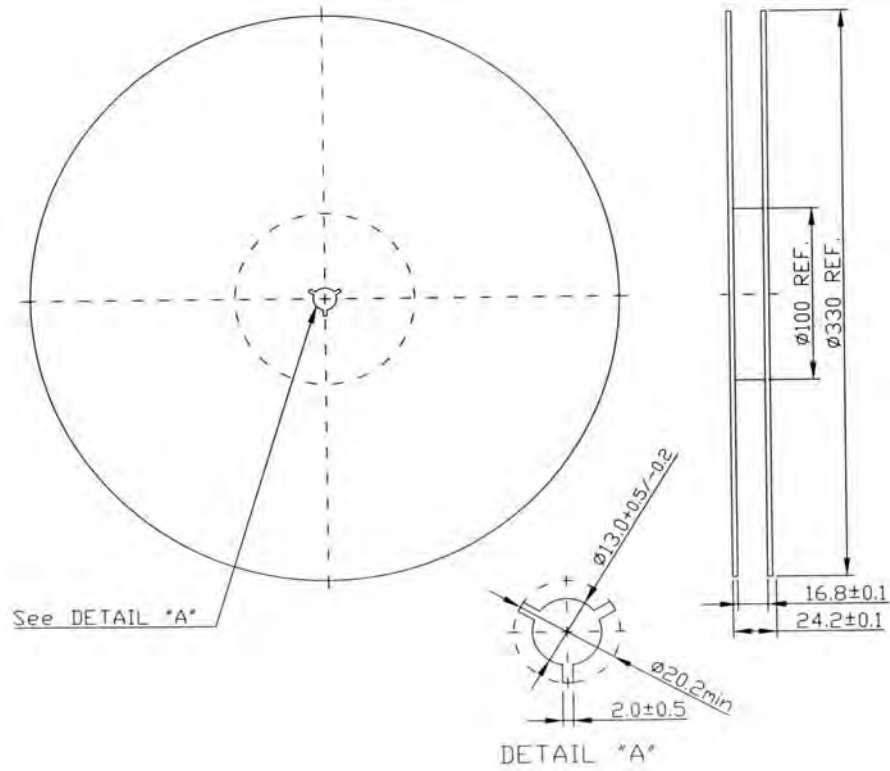

2. TAPE DIMENSION

