

SAW Filter 243.0 MHz

Model: TB0208A

Part No: MA05479

REV NO.: 1

A. MAXIMUM RATING:

1. Input Power Level: 10 dBm
2. DC Voltage : 15V
3. Operating Temperature: -25°C to 60°C
4. Storage Temperature: -30°C to 70°C

B. ELECTRICAL CHARACTERISTICS:

Item	Unit	Min.	Typ.	Max.	Note
Center frequency, Fc	MHz	-	243	-	1
Minimum Insertion Loss, (Fc ±25KHz) IL	dB	-	3.7	6.0	1
Passband Ripple (Fc ±25KHz)	dB	-	0.2	1.0	1
Group delay ripple (Fc ±25KHz), GD	μs	-	0.5	2.0	1
Attenuation:(Reference level from Min IL)					
Fc - 115 to Fc - 1 MHz	dB	50	63	-	-
Fc - 1 to Fc - 0.6 MHz	dB	42	64	-	-
Fc - 0.6 to Fc - 0.4 MHz	dB	29	68	-	-
Fc + 0.4 to Fc + 0.6 MHz	dB	29	64	-	-
Fc + 0.6 to Fc + 1 MHz	dB	42	63	-	-
Fc + 1 to Fc + 115 MHz	dB	50	55	-	-

Note1. The standard definitions is in JIS C 6703

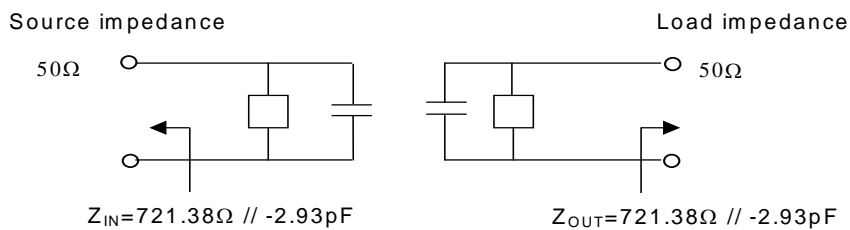

SAW Filter 243.0 MHz

Model: TB0208A

Part No: MA05479

REV NO.: 1

C. OUTLINE DRAWING:

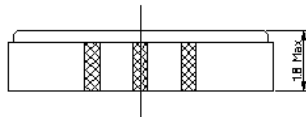
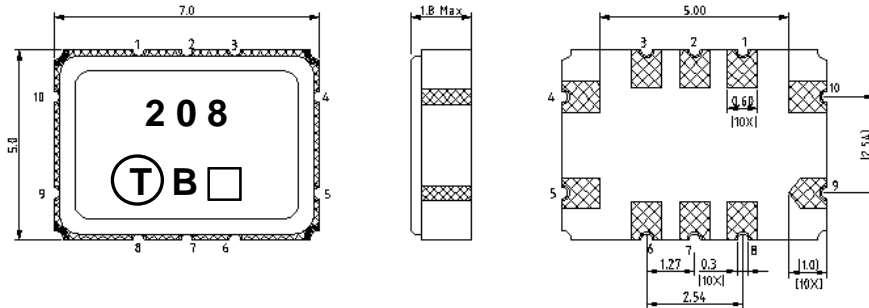

Pin configuration

#9 Input

#4 Output

#10 Balance input or input ground

#5 Balance output or output ground

#1,2,3,6,7,8 To be grounded

Date code

Unit mm

D. MEASUREMENT CIRCUIT:

50 Ohm Test circuit (single-ended / single-ended)

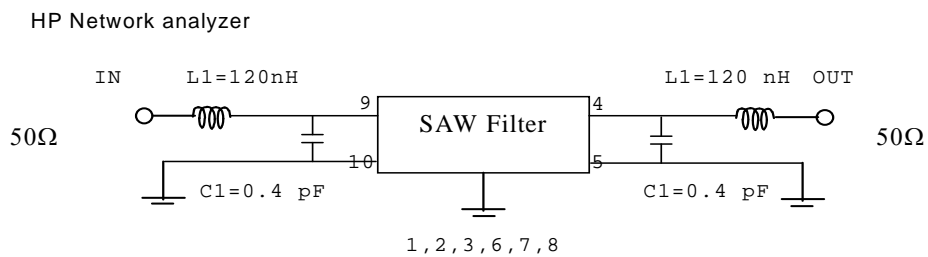

SAW Filter 243.0 MHz
Part No: MA05479

Model: TB0208A
REV NO.: 1

E. FREQUENCY CHARACTERISTICS:

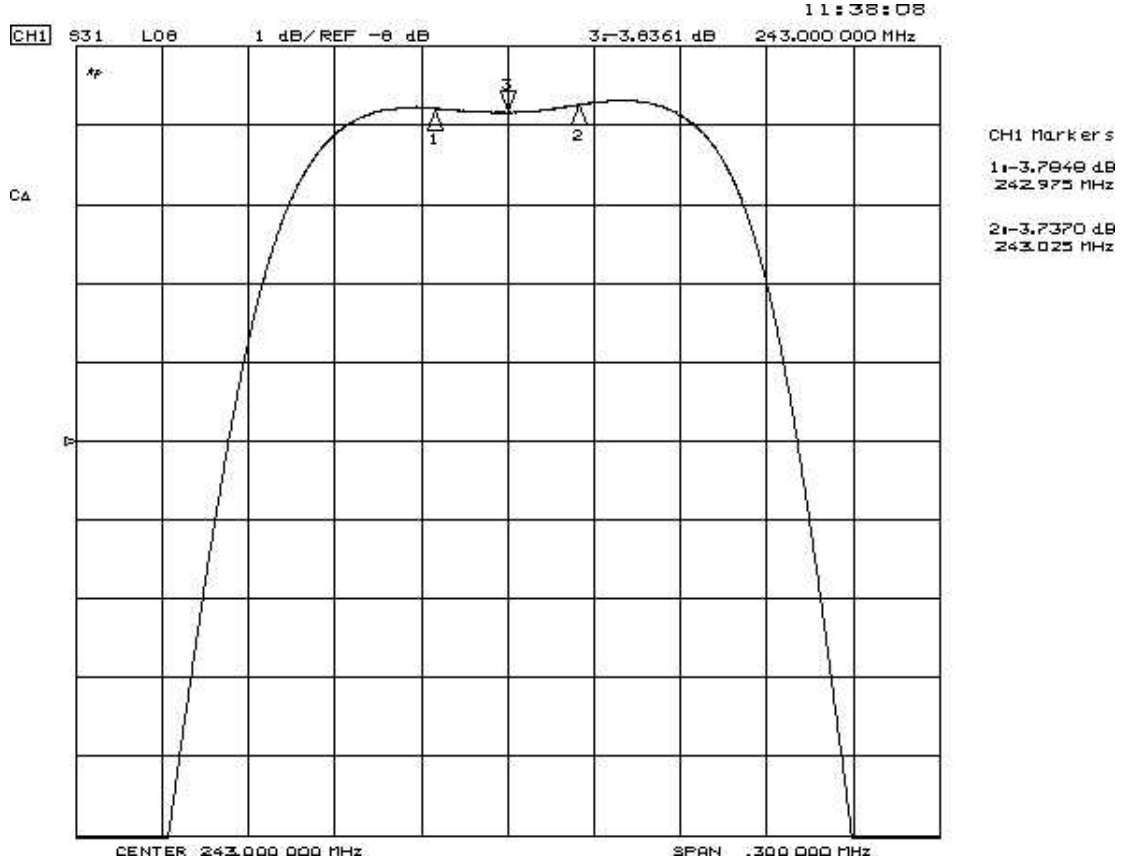
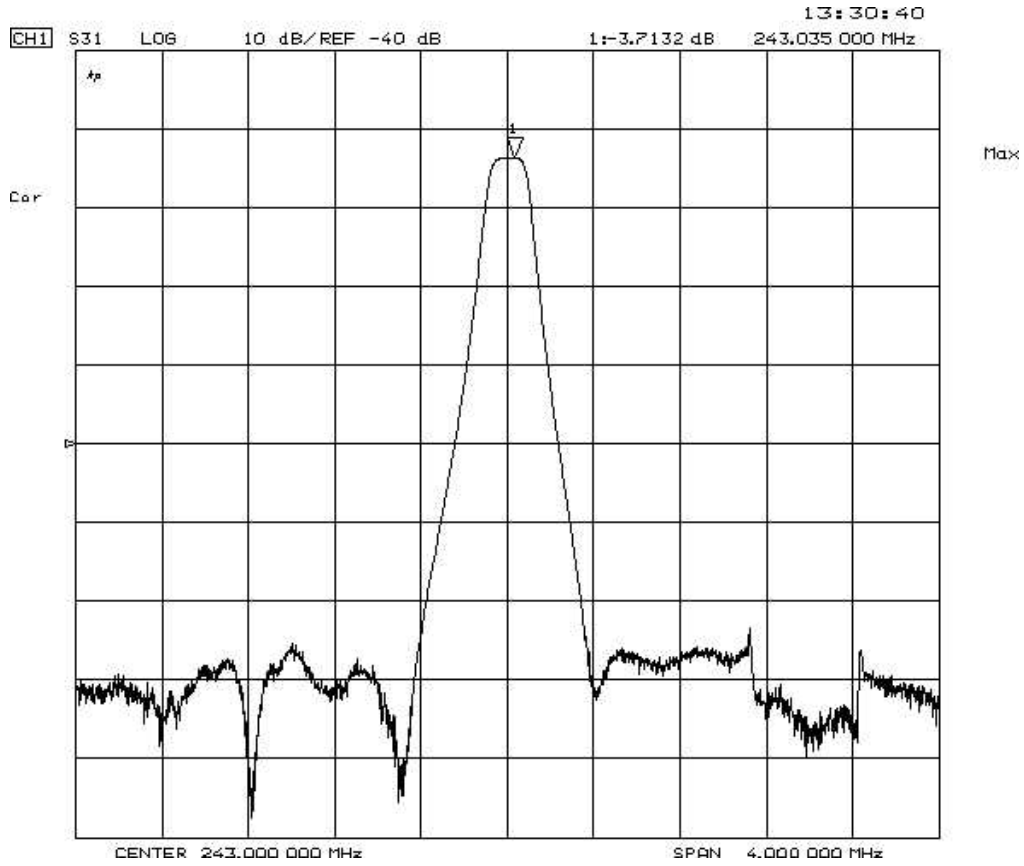

SAW Filter 243.0 MHz
Part No: MA05479

Model: TB0208A
REV NO.: 1

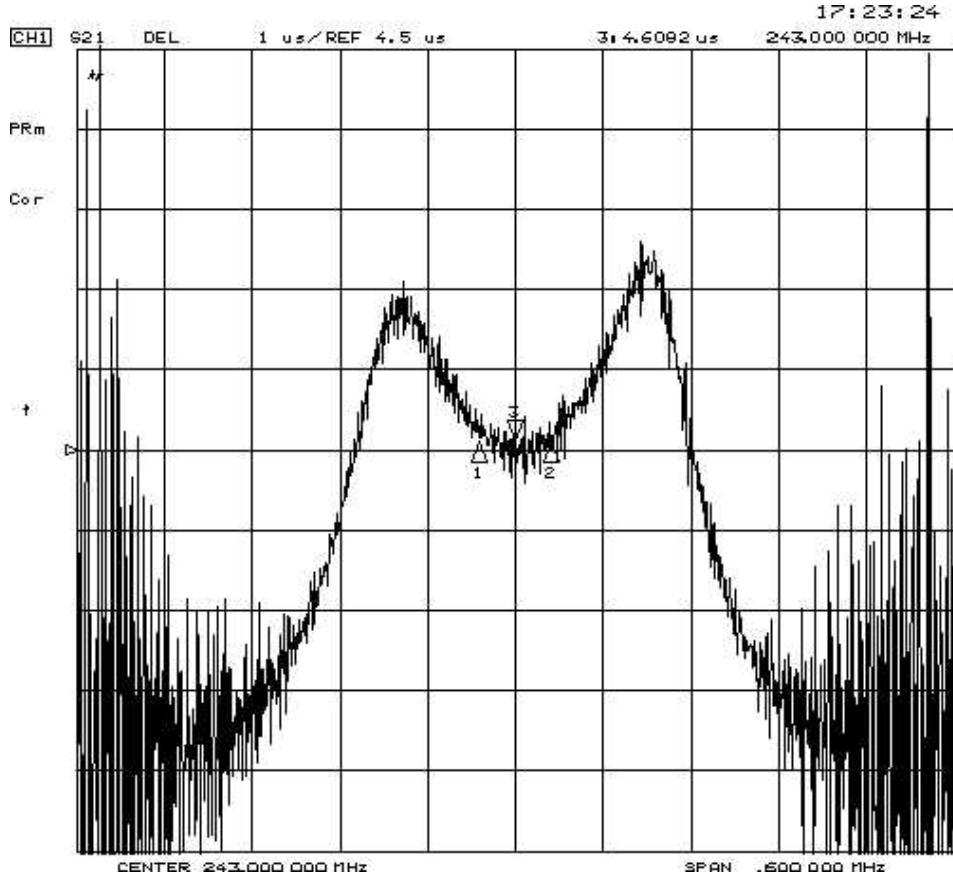
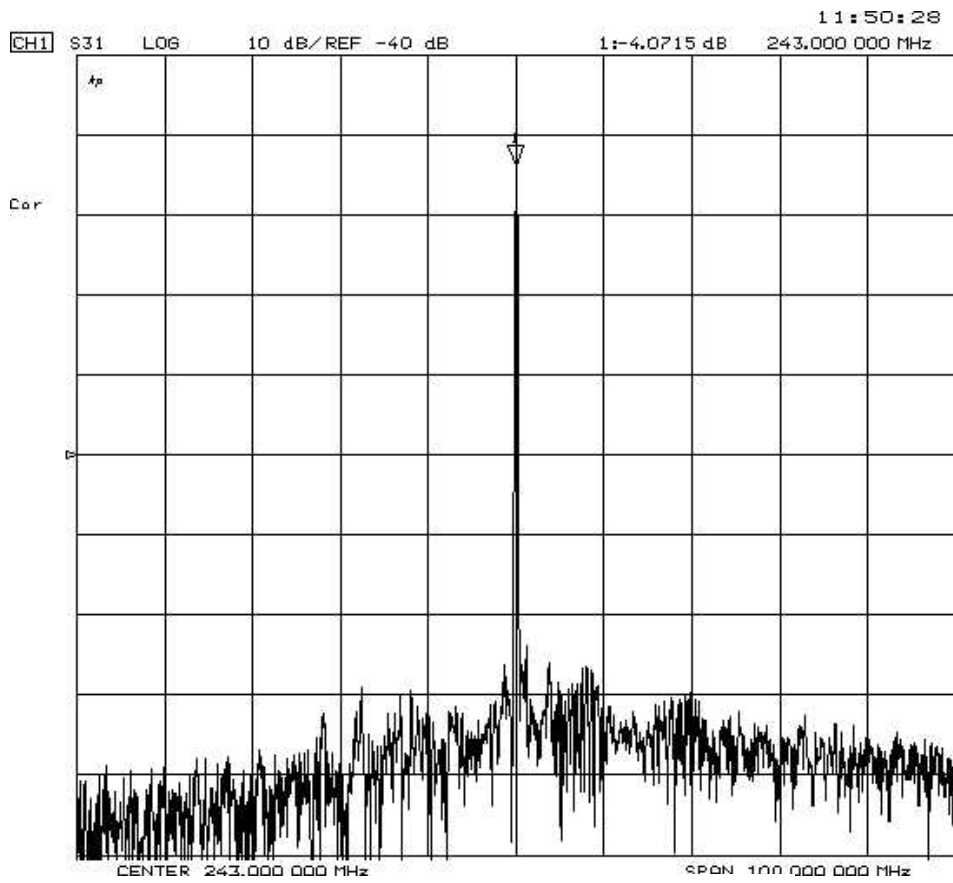

SAW Filter 243.0 MHz
Part No: MA05479

Model: TB0208A
REV NO.: 1

F. PACKING:

1. REEL DIMENSION

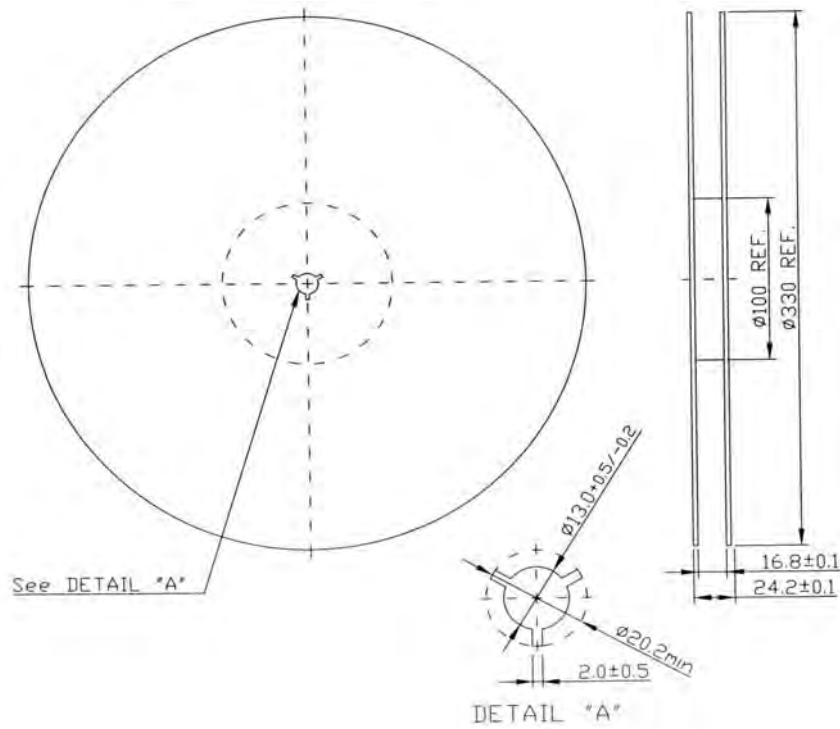

2. TAPE DIMENSION

