380 MHz IF SAW Filter**Model: TB0122A****Part No: MA05380****REV NO.: 4**

A. MAXIMUM RATING:

1. Input Power Level: 10 dB_m
2. DC voltage: 0 V
3. Operating Temperature: -30°C to +70°C
4. Storage Temperature: -30°C to +70°C

B. ELECTRICAL CHARACTERISTICS:

Item	Unit	Min.	Typical.	Max.	Note
Center frequency, F_c	MHz	-	380	-	
Insertion Loss, IL	dB	-	9.7	11	
Passband width, BW₃	MHz	4.8	7.81		
Phase Linearity in F _c 2MHz (RMS)	Deg	-	1.7	3	
Attenuation:(Reference level from Min IL)					
360-373 MHz	dB	28	38	-	
387-400 MHz	dB	28	36	-	
Ultimate Rejection	dB		50	-	
Substrate Material	LiTaO ₃				

380 MHz IF SAW Filter
Part No: MA05380

Model: TB0122A
REV NO.: 4

C. OUTLINE DRAWING:

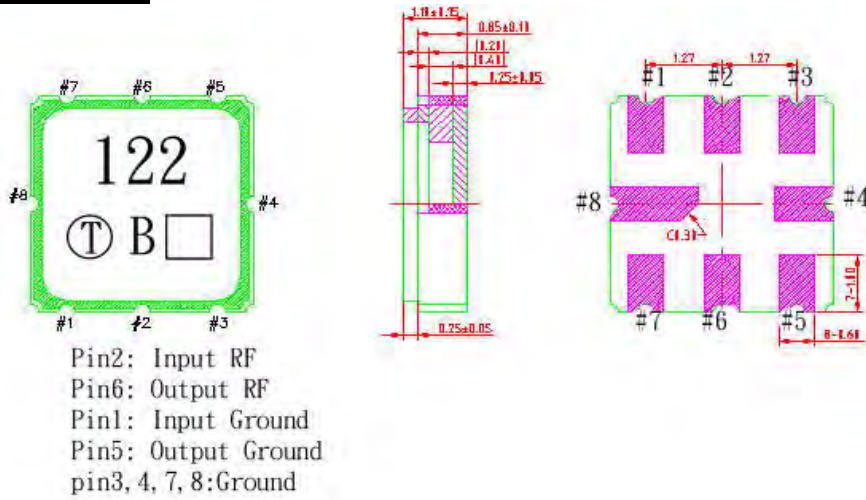

D. MATCHING CIRCUIT:

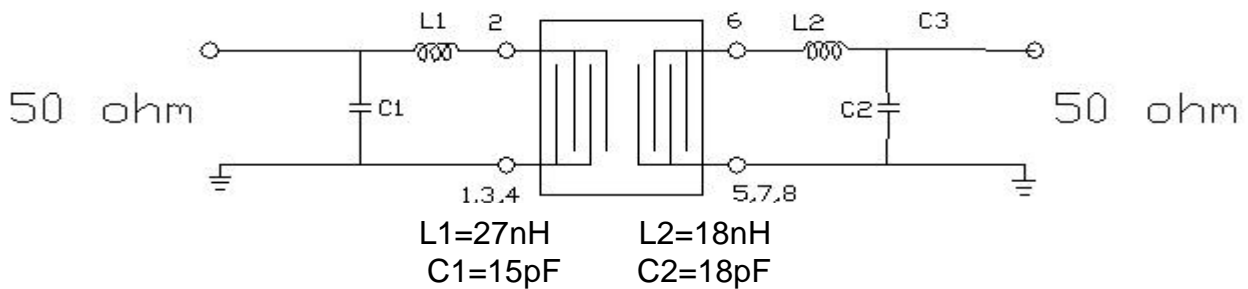

380 MHz IF SAW Filter
Part No: MA05380

Model: TB0122A
REV NO.: 4

E. FREQUENCY CHARACTERISTICS:

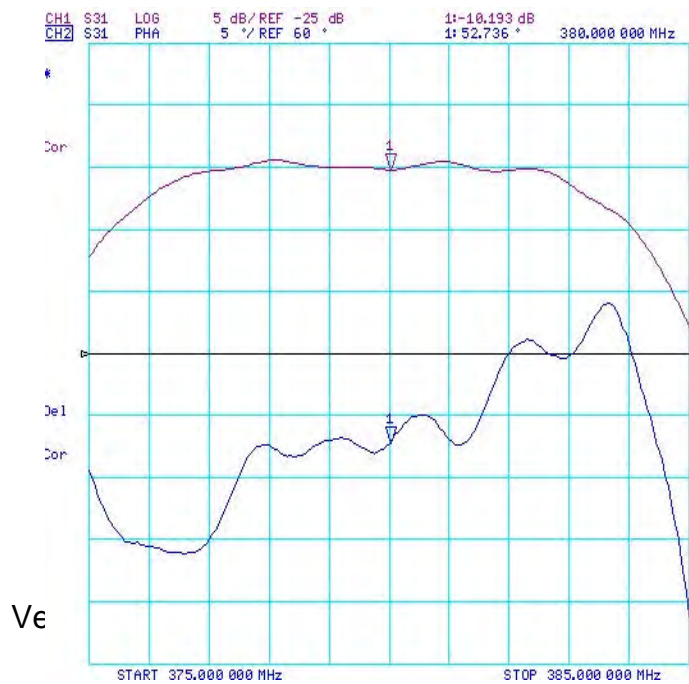

380 MHz IF SAW Filter
Part No: MA05380

Model: TB0122A
REV NO.: 4

F. PACKING:

1. REEL DIMENSION

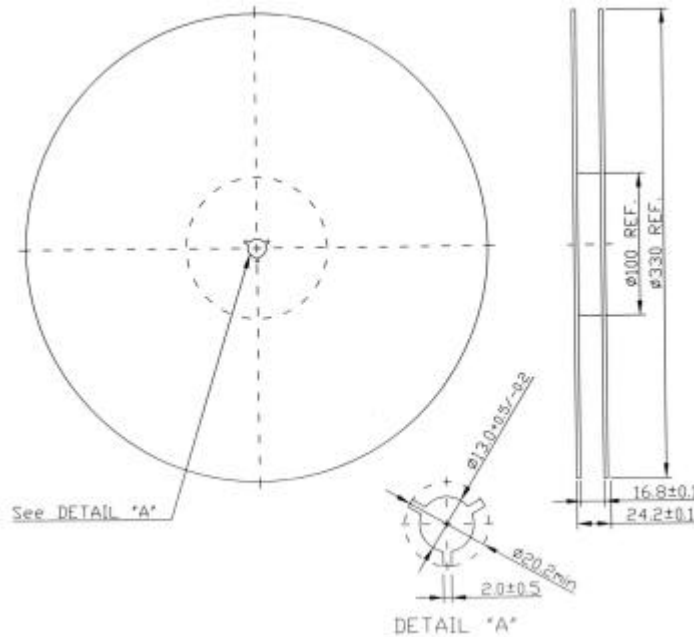

2. TAPE DIMENSION

