

SAW Filter 173.225MHz

Model: TB0223A

Part No: MA05237

REV NO.: 1.1

A. MAXIMUM RATING:

1. Input Power Level: 0 dBm
2. DC Voltage : 5V
3. Operating Temperature: -40°C to 85°C
4. Storage Temperature: -50°C to 95°C

B. ELECTRICAL CHARACTERISTICS:

Item	Unit	Min.	Type.	Max.	Note
Center frequency, Fc	MHz	-	173.225	-	1
Minimum Insertion Loss, (Fc 13KHz) IL	dB	-	2.9	4.2	1
Passband Ripple (Fc 13KHz)	dB	-	0.05	0.5	1
Group delay ripple (Fc 13KHz), GD	s	-	0.7	2.5	1
Attenuation:(Reference level from Min IL)					
Fc - 4 to Fc - 0.92 MHz	dB	50	54	-	
Fc - 0.92 to Fc - 0.31 MHz	dB	30	60	-	-
Fc + 0.31 to Fc + 0.92 MHz	dB	30	60	-	-
Fc + 0.92 to Fc + 4 MHz	dB	50	54	-	-

Note1. The standard definitions is in JIS C 6703

SAW Filter 173.225MHz
Part No: MA05237

Model: TB0223A
REV NO.: 1.1

C. OUTLINE DRAWING:

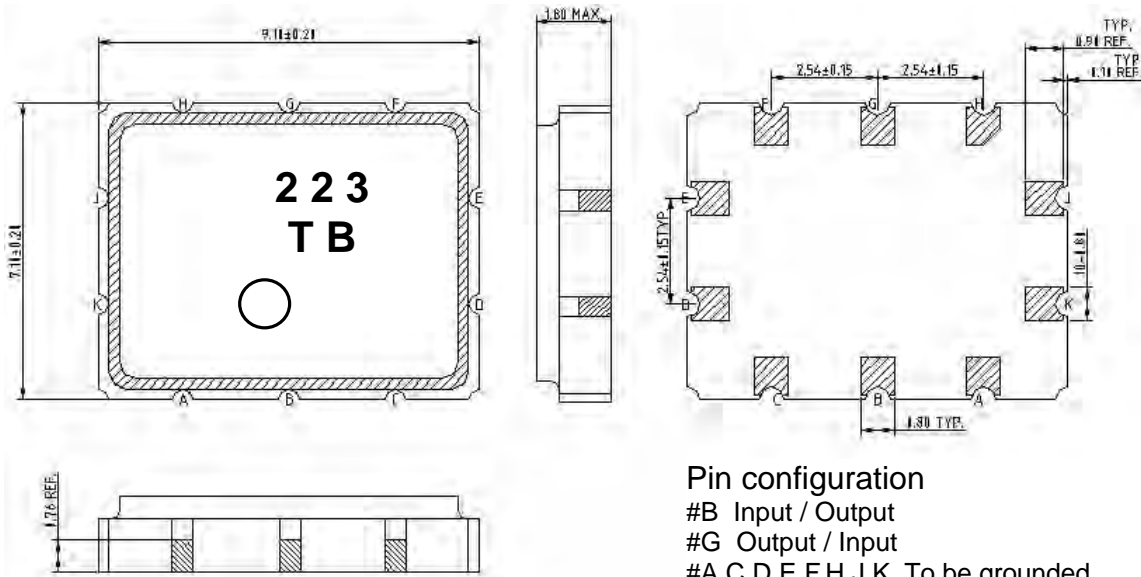

Pin configuration
 #B Input / Output
 #G Output / Input
 #A,C,D,E,F,H,J,K To be grounded

Unit mm

D. MEASUREMENT CIRCUIT:

50 Ohm Test circuit (single-ended / single-ended)

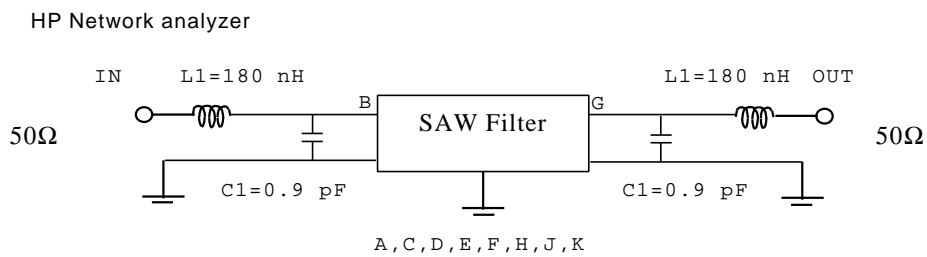

SAW Filter 173.225MHz
Part No: MA05237

Model: TB0223A
REV NO.: 1.1

E. FREQUENCY CHARACTERISTICS:

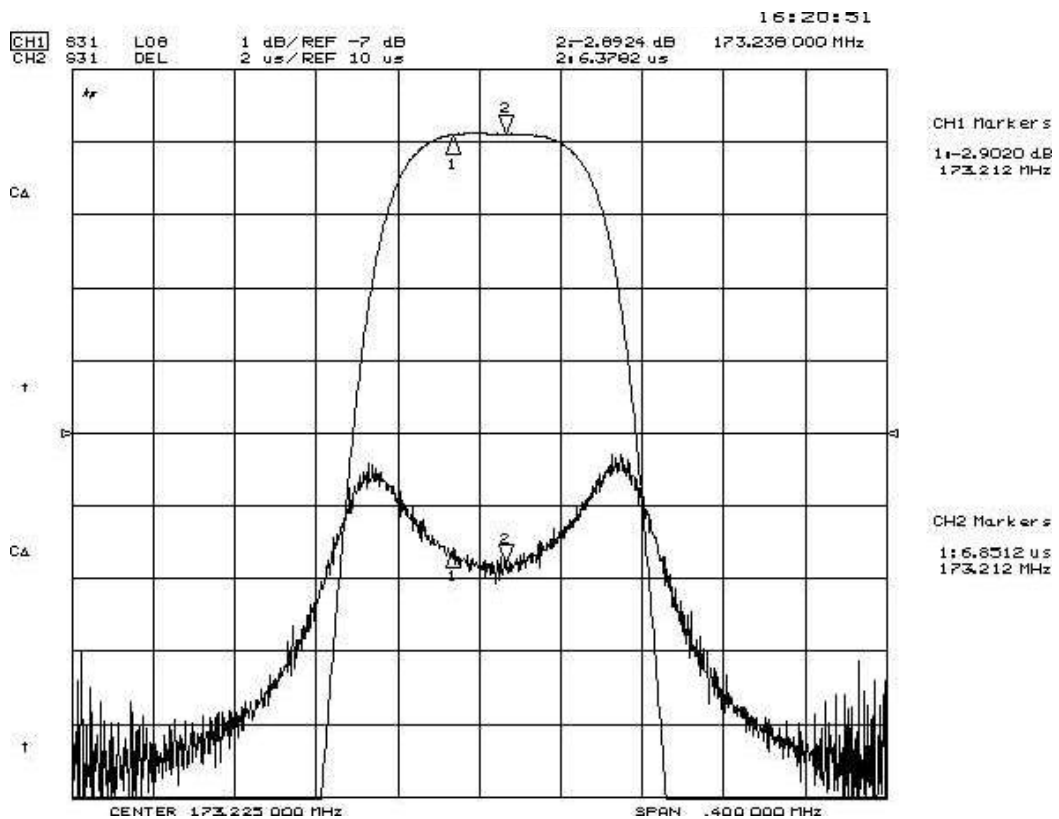
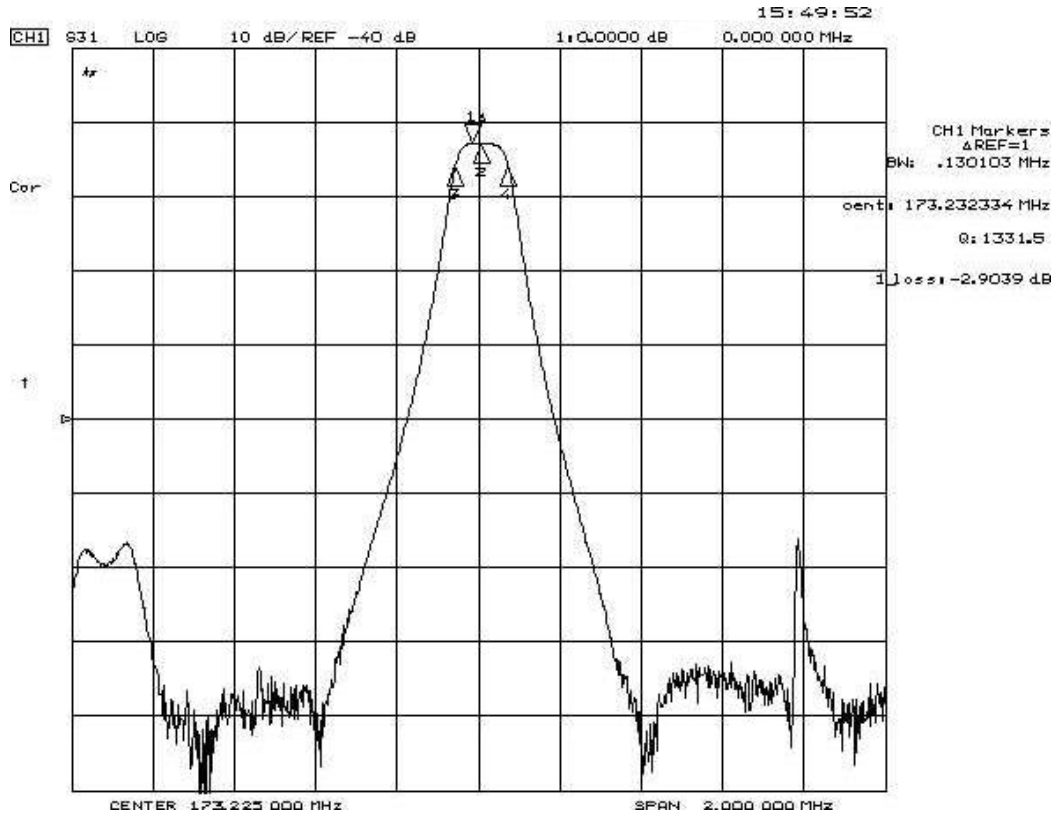

SAW Filter 173.225MHz
Part No: MA05237

Model: TB0223A
REV NO.: 1.1

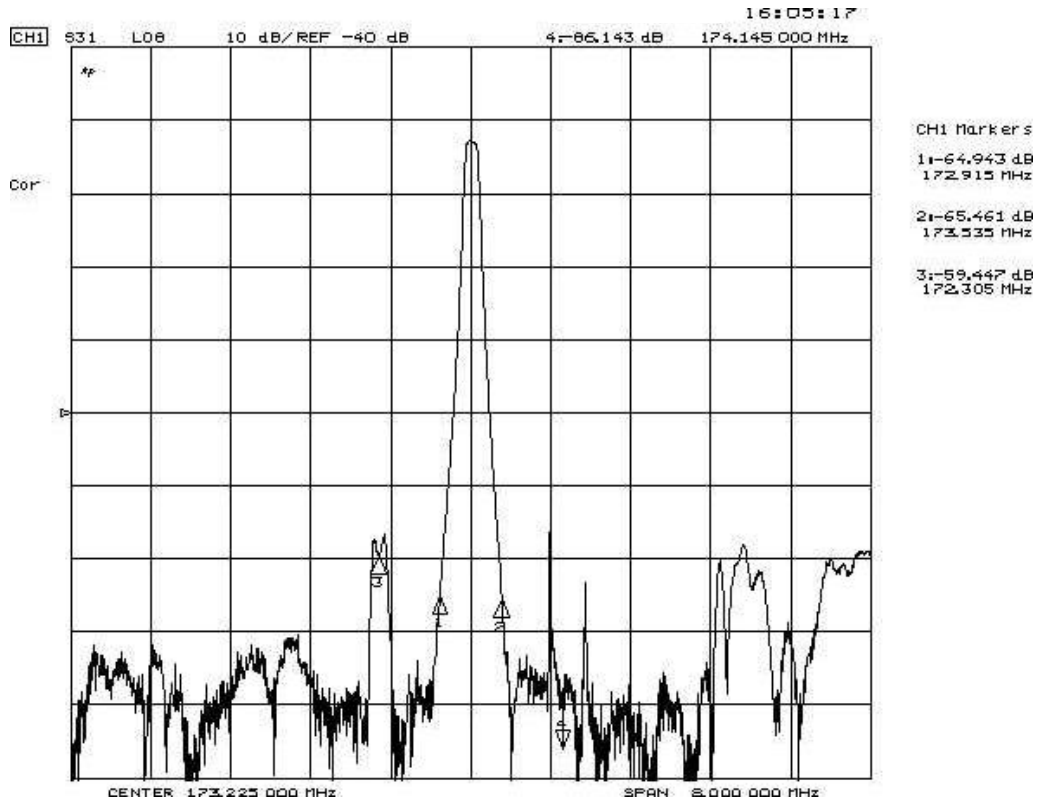

SAW Filter 173.225MHz
Part No: **MA05237**

Model: **TB0223A**
REV NO.: 1.1

F. PACKING:

1. REEL DIMENSION

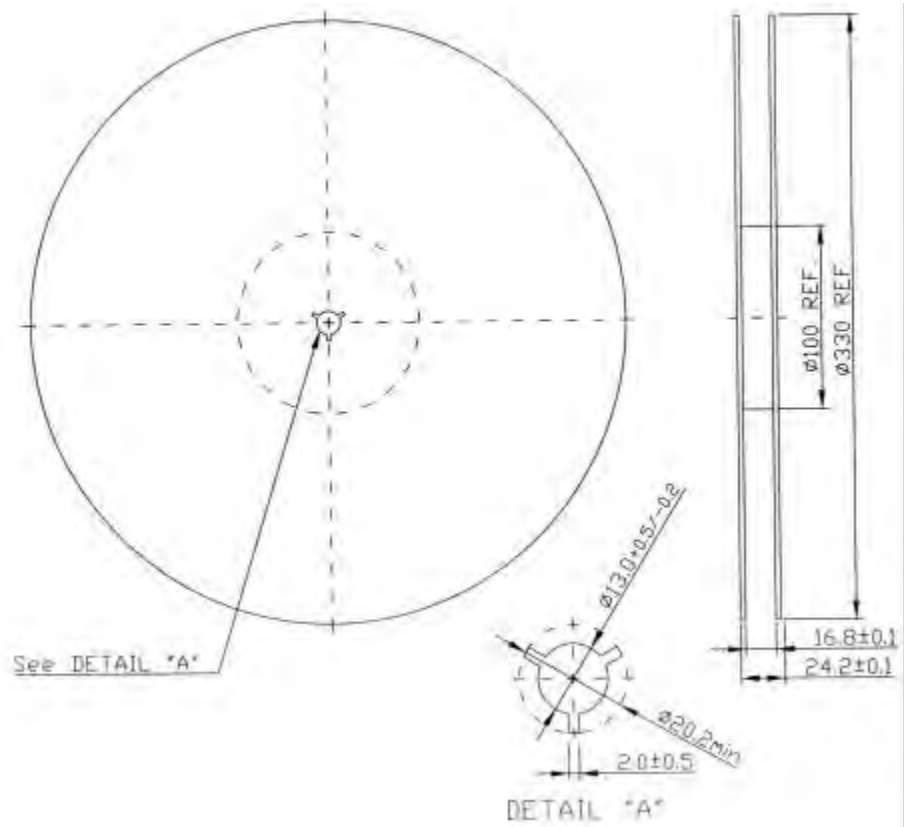

2. TAPE DIMENSION

