

**1090MHz SAW Filter**

**Model: TA1090EC**

**Part No: MA04282**

**REV NO.: 1**

**A. MAXIMUM RATING:**

1. Input Power Level: 10 dBm
2. DC voltage: 0 V
3. Operating Temperature: -30°C to +85°C
4. Storage Temperature: -40°C to +85°C

**B. ELECTRICAL CHARACTERISTICS:**

Characteristics (at 25°C)	Min.	Typ.	Max.
<b>Center frequency</b> <b>F<sub>c</sub></b> (dB)	-	1090	-
<b>Insertion loss</b> within 1075 ~1105 MHz <b>IL</b> (dB)	-	2.3	3.0
<b>Amplitude ripple</b> (p-p) within 1085 ~ 1095 MHz (dB)	-	0.25	0.5
<b>Attenuation</b> (Reference level from 0 dB)			
DC ~ 970 MHz (dB)	25.0	30	-
1150 ~ 1300 MHz (dB)	25.0	33.5	-
<b>VSWR</b> within 1075 ~1105 MHz	-	1.8	2.1
<b>Source impedance</b> Z <sub>s</sub> (Ω)	-	50	-
<b>Load impedance</b> Z <sub>L</sub> (Ω)	-	50	-

Note1. No matching network required for operation at 50 Ω

**1090MHz SAW Filter**  
**Part No: MA04282**

**Model: TA1090EC**  
**REV NO.: 1**

**C. FREQUENCY CHARACTERISTICS:**

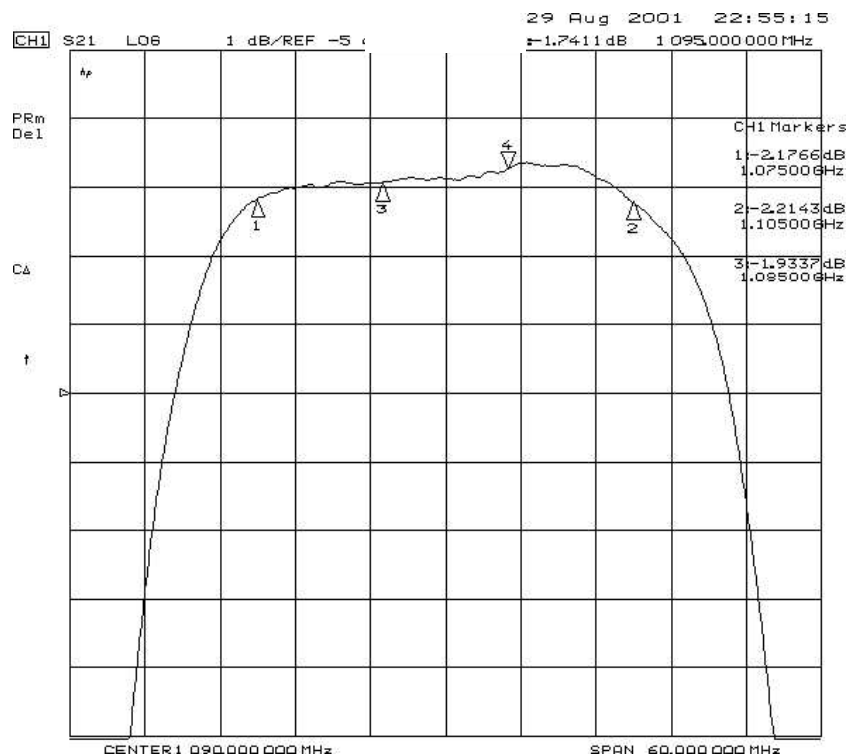
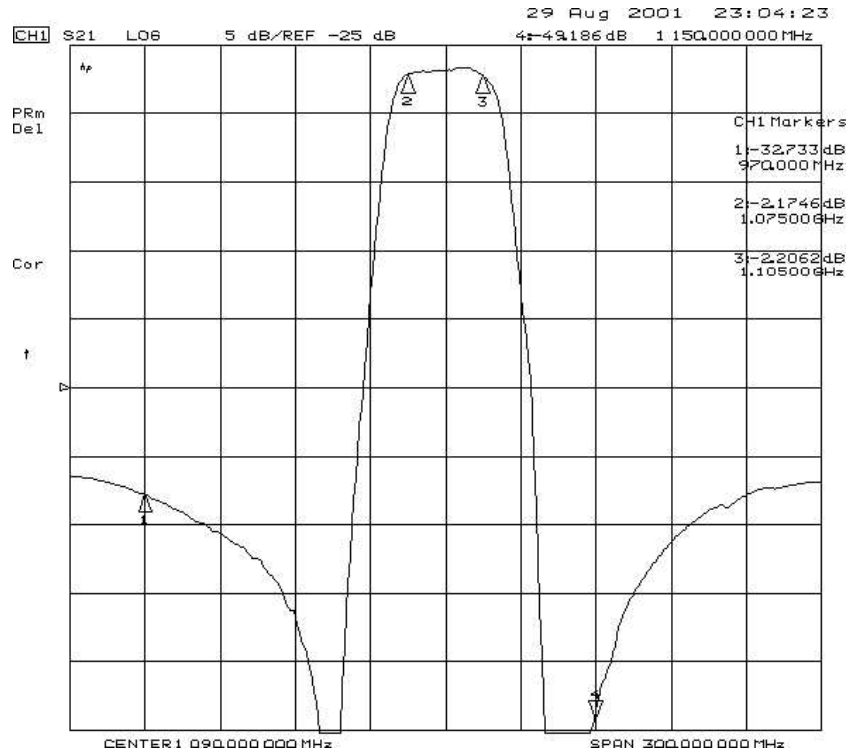

**1090MHz SAW Filter**  
**Part No: MA04282**

**Model: TA1090EC**  
**REV NO.: 1**

**(wideband)**

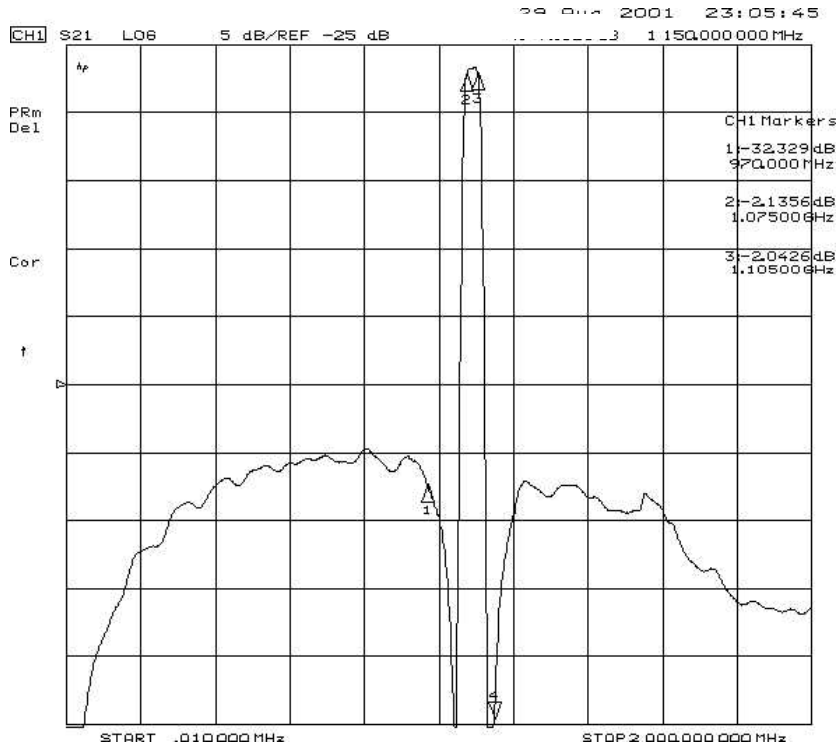

**D. REFLECTIONS FUNCTIONS:**

**Smith Chart**

**VSWR**

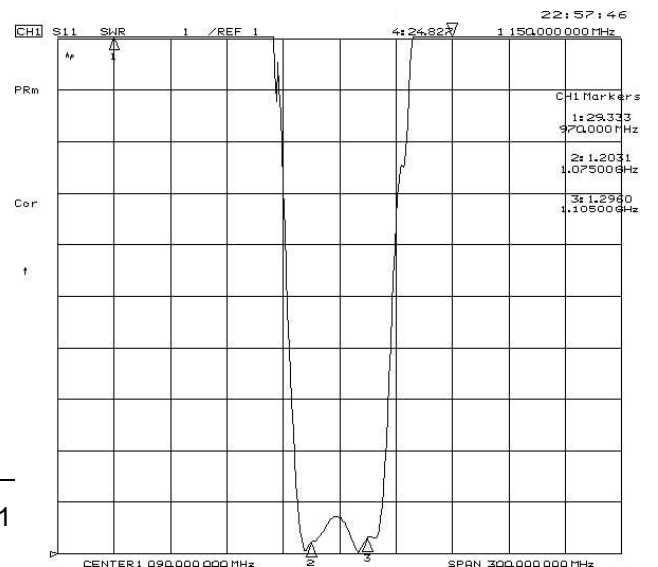
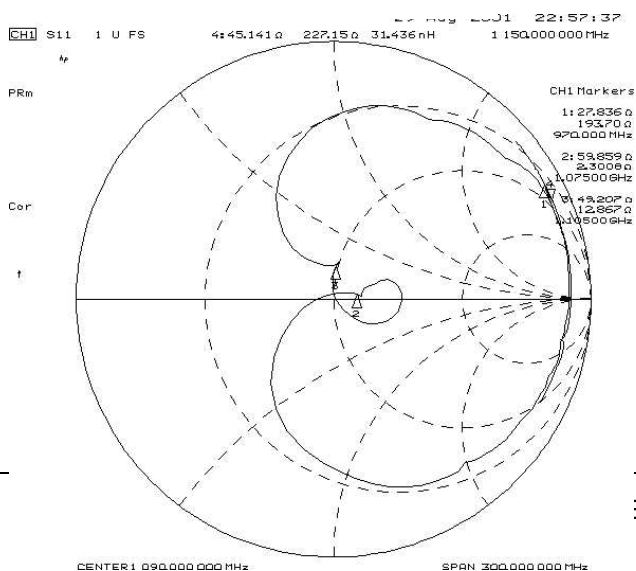

:C v1

Tel: +44 1460 256 100  
Fax: +44 1460 256 101  
www.golledge.com



**Golledge Electronics Ltd**  
Eaglewood Park, ILMINSTER  
Somerset, TA19 9DQ, UK

---

**1090MHz SAW Filter**

**Model: TA1090EC**

**Part No: MA04282**

**REV NO.: 1**

---

**1090MHz SAW Filter**  
**Part No: MA04282**

**Model: TA1090EC**  
**REV NO.: 1**

**E. MEASUREMENT CIRCUIT:**

HP Network analyzer

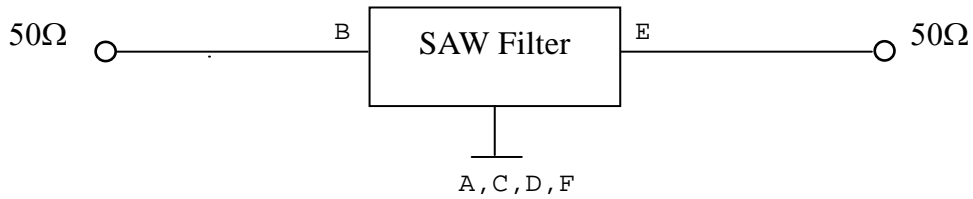

**F. OUTLINE DRAWING:**

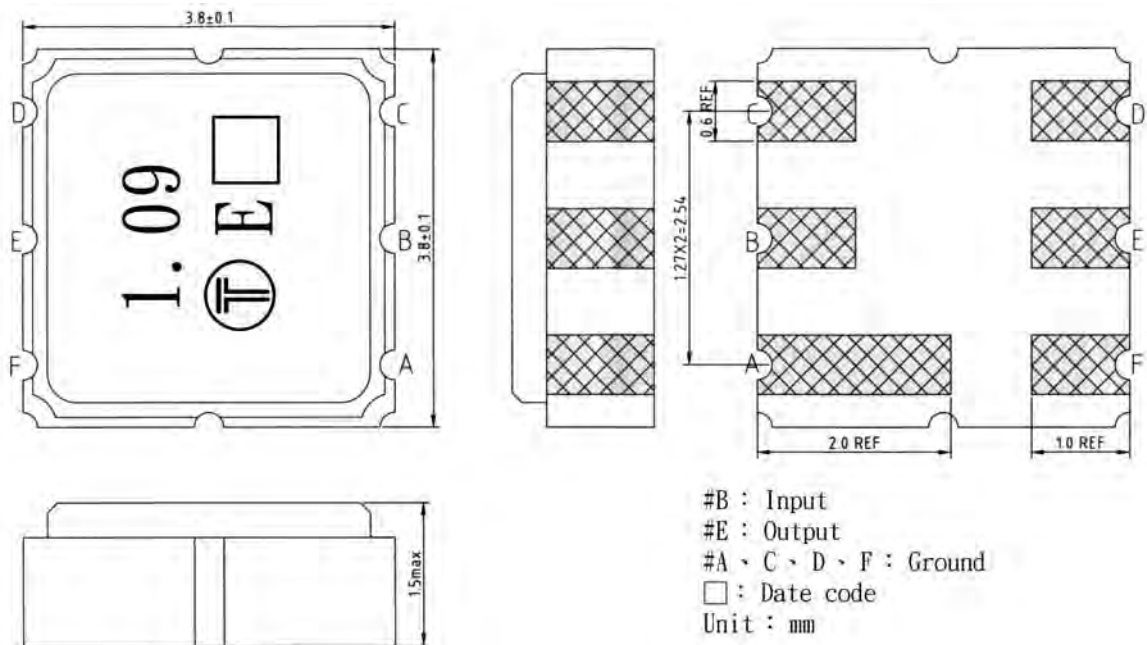

**1090MHz SAW Filter**  
Part No: **MA04282**

Model: **TA1090EC**  
REV NO.: 1

**G. PACKING:**

1. REEL DIMENSION

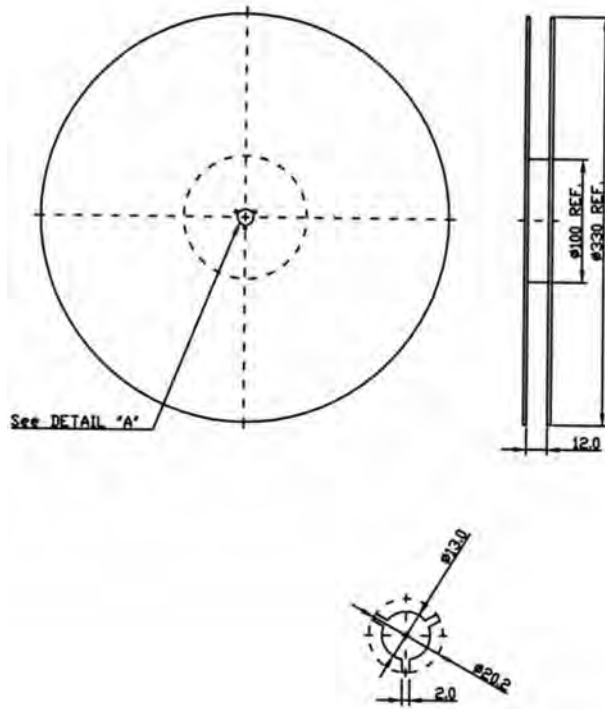

2. TAPE DIMENSION

